

FINI	DATE
SURVEY	BY
REVISIONS	
PLOTTED	
TEMP. LIT.	
AREAS	
CHECKED	
NO.	

ORIGINAL	DATE
SURVEY	BY
REVISIONS	
PLOTTED	
TEMP. LIT.	
AREAS	
CHECKED	
NO.	

* PARK ROADS	F.A.P.	SECTION	COUNTY	TOTAL	SHEET
** SFWA PARK ROADS 2003-1	RTE.	**	***	SHEETS	NO.
*** MOULTRIE AND SHELBY	STA.	TO STA.		310	233
CONTRACT NO. 74155					

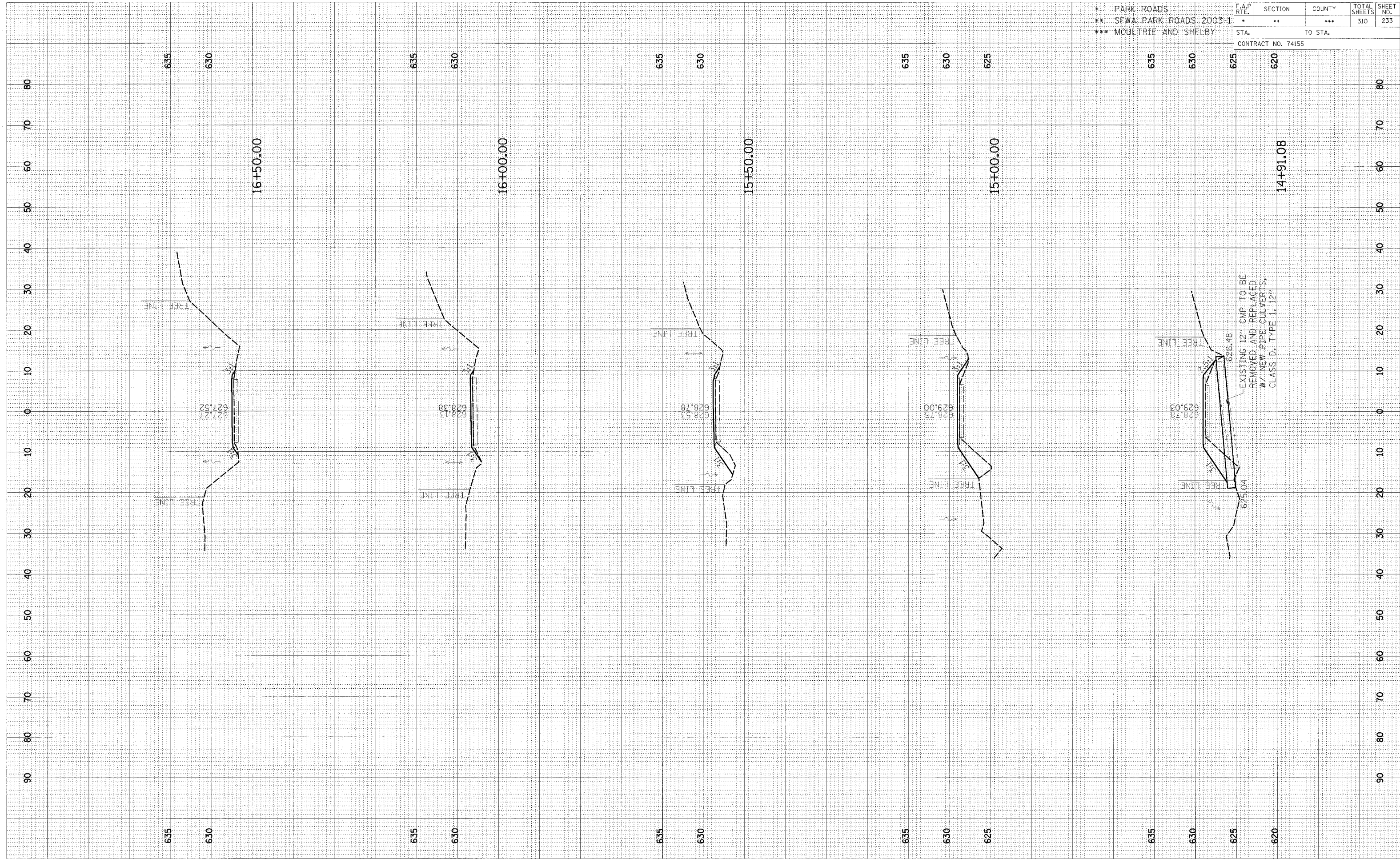

EXISTING 12" CMP TO BE
REMOVED AND REPLACED
W/ NEW PIPE CULVERTS,
CLASS D, TYPE 1, 12"

CROSS SECTION, KASKASKIA, TOWNSHIP ROAD 140 TO PARKING LOTS 54, 55, 56, 58, 58A & 58B, STA 14+91.08 TO STA 16+50.00