

DATE	
BY	
PROJECT	
NO. OF SHEETS	
DATE	
BY	
PROJECT	
NO. OF SHEETS	
DATE	
BY	
PROJECT	
NO. OF SHEETS	

DATE	
BY	
PROJECT	
NO. OF SHEETS	
DATE	
BY	
PROJECT	
NO. OF SHEETS	
DATE	
BY	
PROJECT	
NO. OF SHEETS	

* PARK ROADS
 ** SFWA PARK ROADS 2003-1
 *** MOULTRIE AND SHELBY

F.A.P. RTE.	SECTION	COUNTY	TOTAL SHEETS	SHEET NO.
*	**	***	310	240
STA.		TO STA.		
CONTRACT NO. 74155				

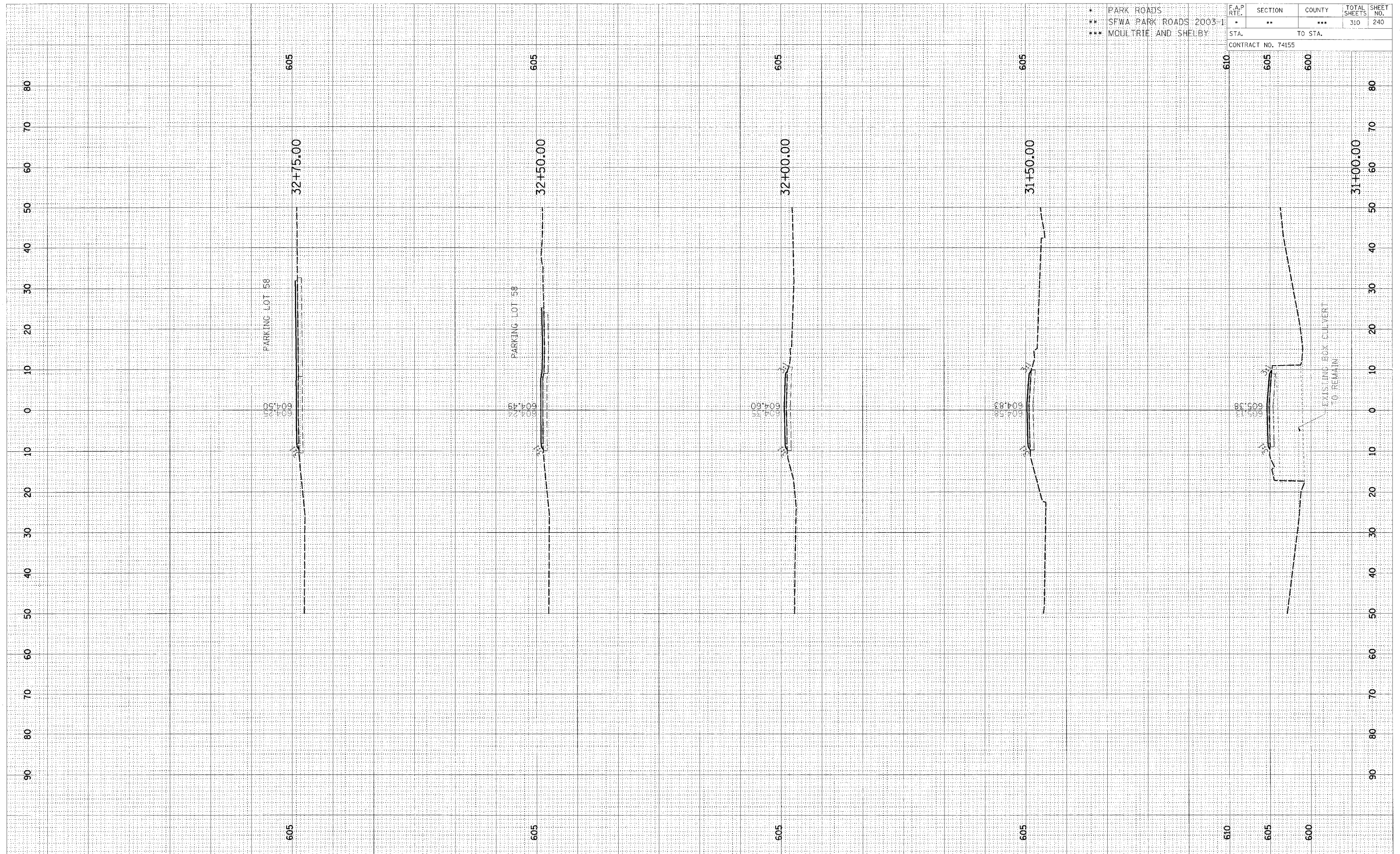

CROSS SECTION, KASKASKIA, TOWNSHIP ROAD 140 TO PARKING LOTS 54, 55, 56, 58, 58A & 58B, STA 31+00.00 TO STA 32+75.00