

FINAL	SURVEYED	DATE
SHEET	BY	
NOTE BOOK	TEMPLATE	
NO.	AREAS	CHECKED

ORIGINAL	SURVEYED	DATE
SHEET	BY	
NOTE BOOK	TEMPLATE	
NO.	AREAS	CHECKED

* PARK ROADS	F.A.P. RTE.	SECTION	COUNTY	TOTAL SHEETS	SHEET NO.
** SFWA PARK ROADS 2003-1	*	**	***	310	246
*** MOULTRIE AND SHELBY	STA.	TO STA.			
CONTRACT NO. 74155					

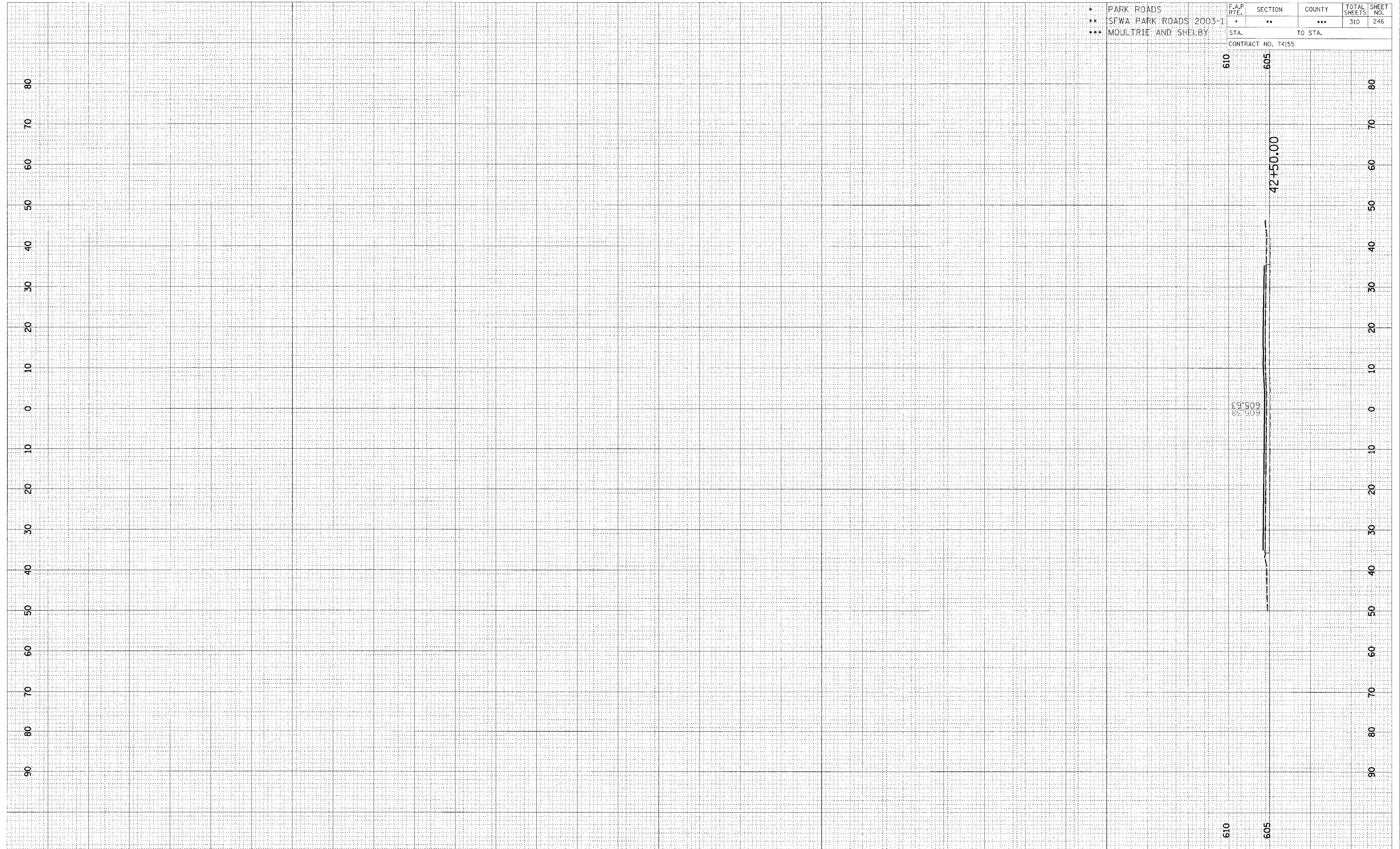

CROSS SECTION, KASKASKIA, TOWNSHIP ROAD 140 TO PARKING LOTS 54, 55, 56, 58, 58A & 58B, STA 42+50.00