

FINAL	REVISION	DATE
SURVEY	PLOTTED	
NOTE BOOK	TEMP. DATE	
NO.	AREAS	CHECKED

ORIGINAL	DATE
SURVEY	
NOTE BOOK	
NO.	

* PARK ROADS	F.A.P. RTE.	SECTION	COUNTY	TOTAL SHEETS	SHEET NO.
** SFWA PARK ROADS 2003-1	*	**	***	310	282
*** MOULTRIE AND SHELBY	STA.	TO STA.			
CONTRACT NO. 74155					

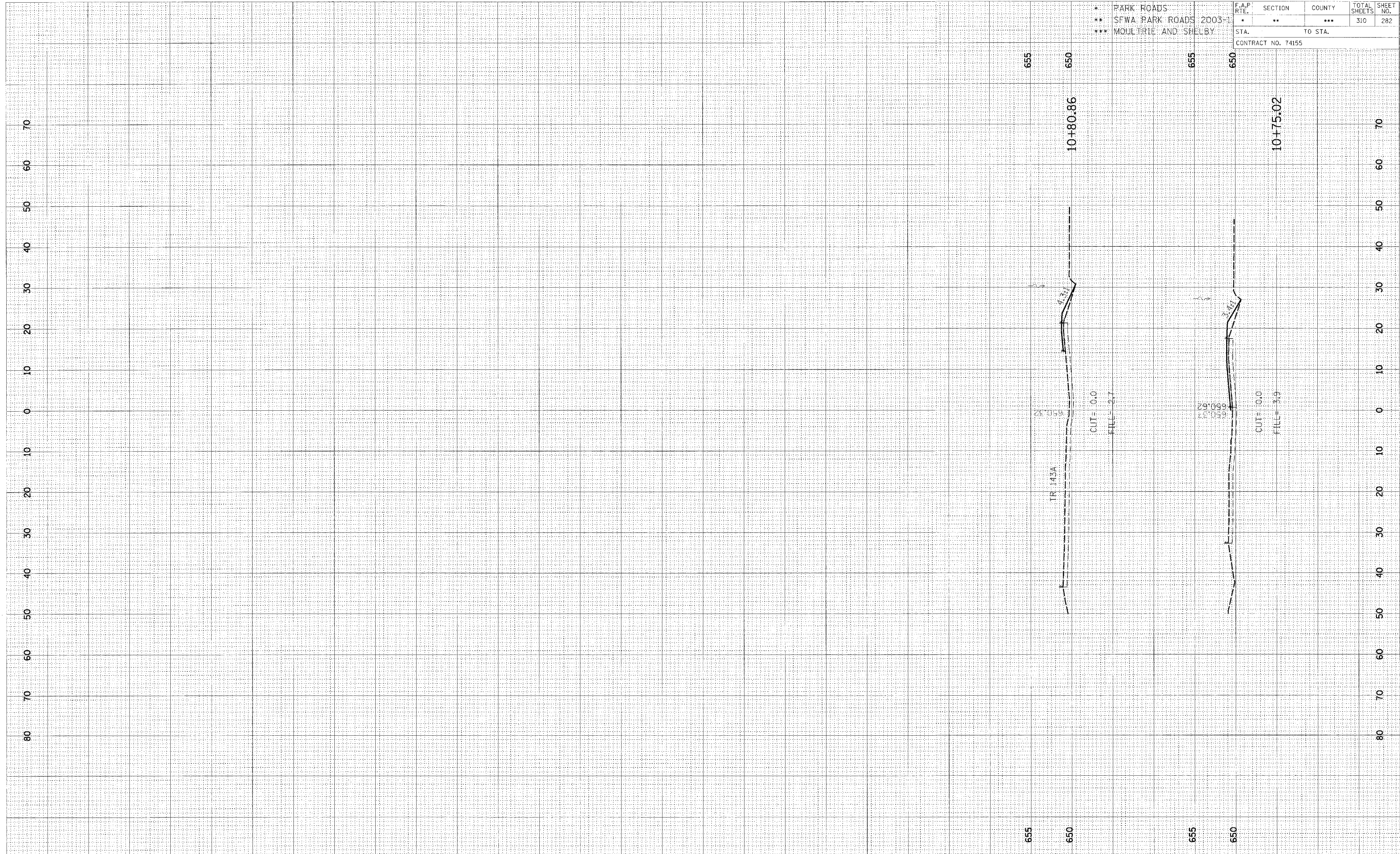

CROSS SECTION, KASKASKIA, PARK ROAD TO PARKING LOT 70, STA 10+75.02 TO STA 10+80.86