

FINAL	REVISIONS	DATE
SURVEY	NO. 1	
NOTE BOOK	NO. 1	
AREAS CHECKED		

ORIGINAL	DATE
SURVEY	
NOTE BOOK	
AREAS CHECKED	

* PARK ROADS
 ** SFWA PARK ROADS 2003-1
 *** MOULTRIE AND SHELBY

F.A.P. RTE.	SECTION	COUNTY	TOTAL SHEETS	SHEET NO.
*	**	***	310	298
STA.		TO STA.		
CONTRACT NO. 74155				

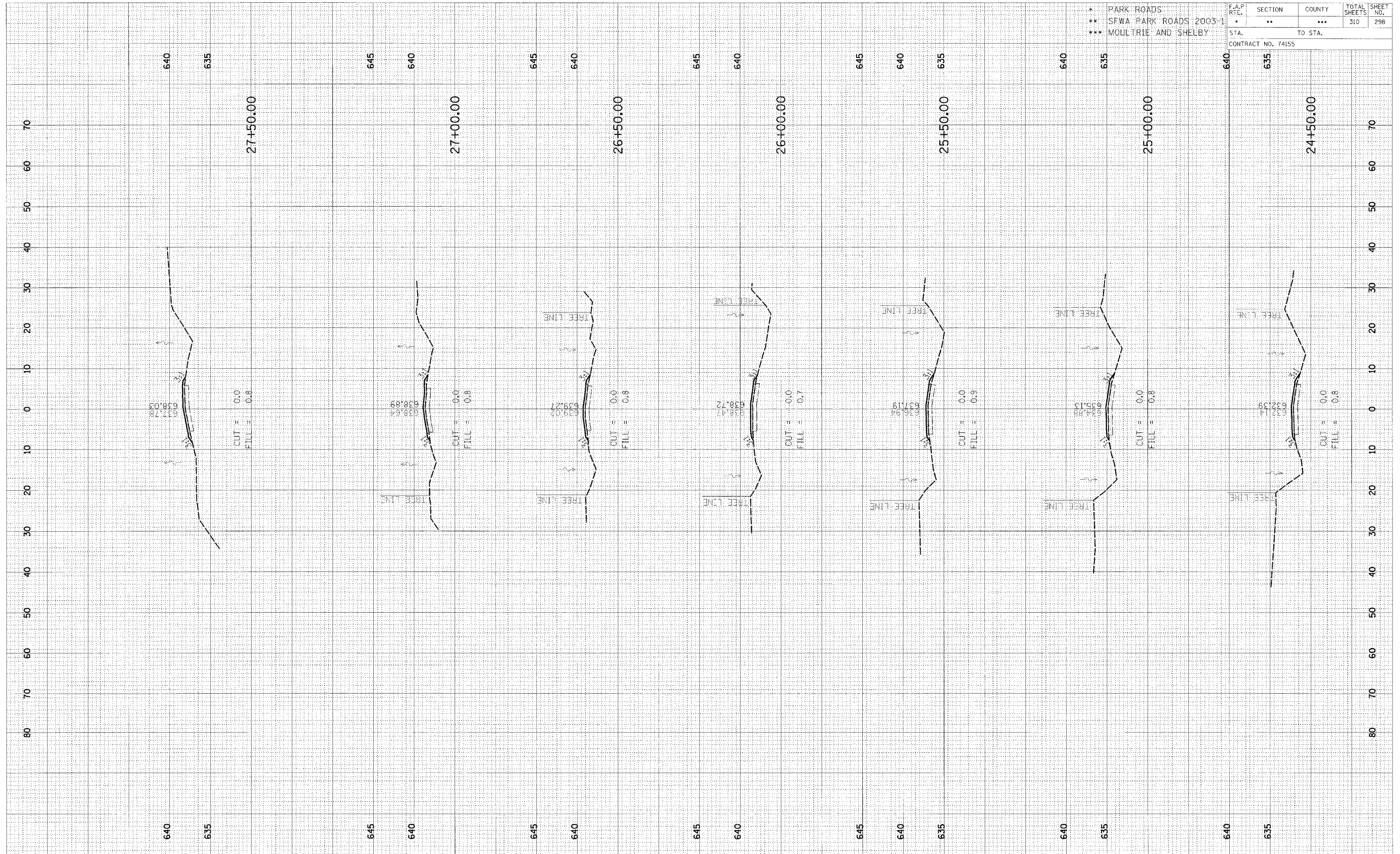

CROSS SECTION, KASKASKIA, PARK ROAD TO PARKING LOTS 72 & 74, STA 24+50.00 TO STA 27+50.00