

5/19/2006
c:\proj\cts\74161\1\03406pa.dgn

CONTRACT NO. 74161

F.A.P. RTE.	SECTION	COUNTY	TOTAL SHEETS	SHEET NO.
116		RICHLAND	43	34
STA.		TO STA.		
FED. ROAD DIST. NO.		ILLINOIS FED. AID PROJECT		
* (123Z, 124Z)TS-2,RS-3				

CITY OF OLNEY PARK

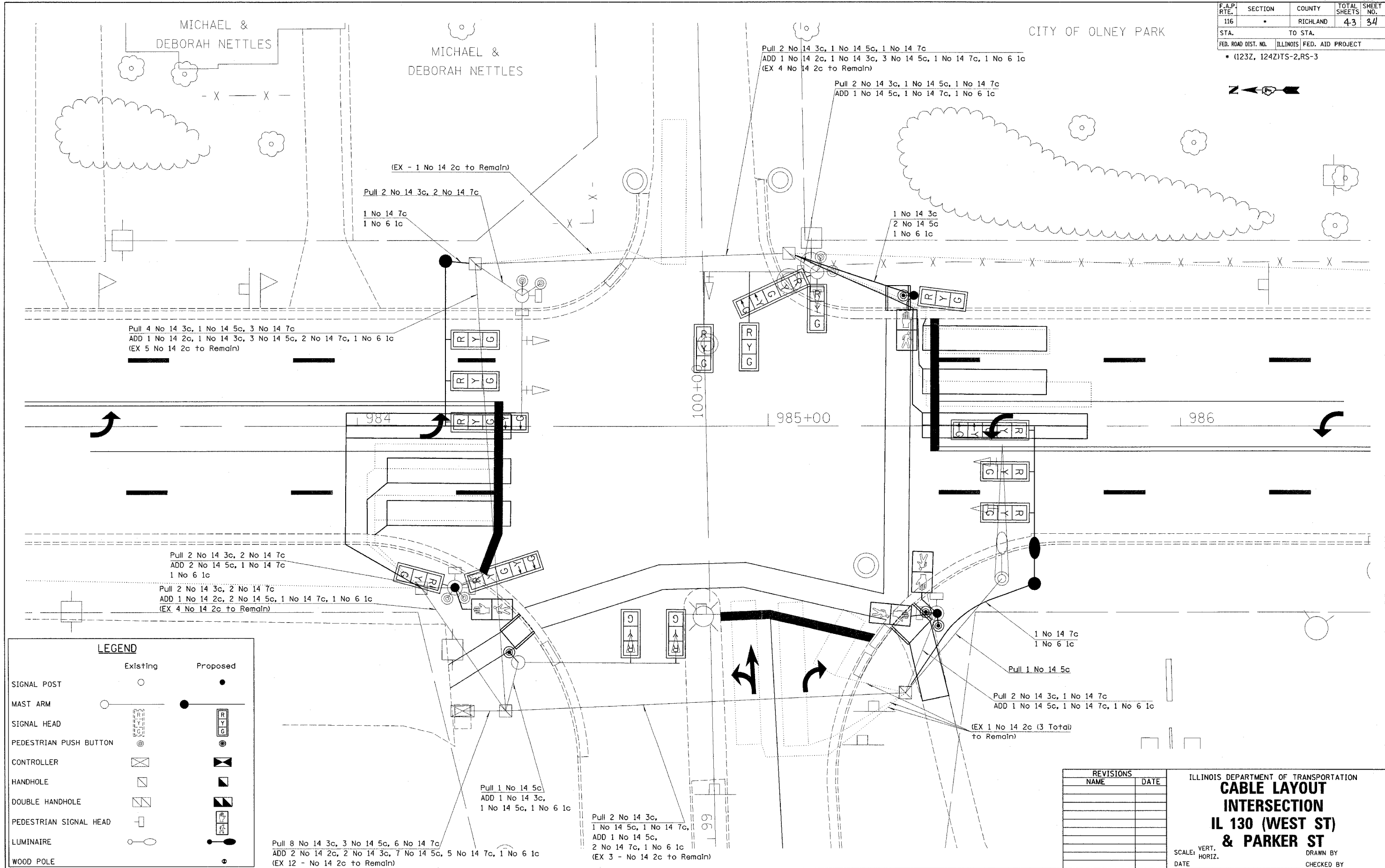
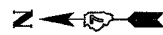

LEGEND

	Existing	Proposed
SIGNAL POST	○	●
MAST ARM	○—	●—
SIGNAL HEAD	[Symbol]	[Symbol]
PEDESTRIAN PUSH BUTTON	[Symbol]	[Symbol]
CONTROLLER	[Symbol]	[Symbol]
HANDHOLE	[Symbol]	[Symbol]
DOUBLE HANDHOLE	[Symbol]	[Symbol]
PEDESTRIAN SIGNAL HEAD	[Symbol]	[Symbol]
LUMINAIRE	[Symbol]	[Symbol]
WOOD POLE	[Symbol]	[Symbol]

REVISIONS	
NAME	DATE

ILLINOIS DEPARTMENT OF TRANSPORTATION
CABLE LAYOUT INTERSECTION
IL 130 (WEST ST) & PARKER ST
 SCALE: VERT. _____
 DATE _____ HORIZ. _____
 DRAWN BY _____
 CHECKED BY _____

PLOT DATE = 5/19/2006
 PLOT NAME = 03406pa.dgn
 PLOT SCALE = 850/1000
 USER NAME = dhrst