

5/19/2006
c:\projc\ts74161\d\03406pa.dgn

CONTRACT NO. 74161

F.A.P. RTE.	SECTION	COUNTY	TOTAL SHEETS	SHEET NO.
116	*	RICHLAND	43	40
STA.		TO STA.		
FED. ROAD DIST. NO.		ILLINOIS FED. AID PROJECT		
* (123Z, 124Z)TS-2,RS-3				

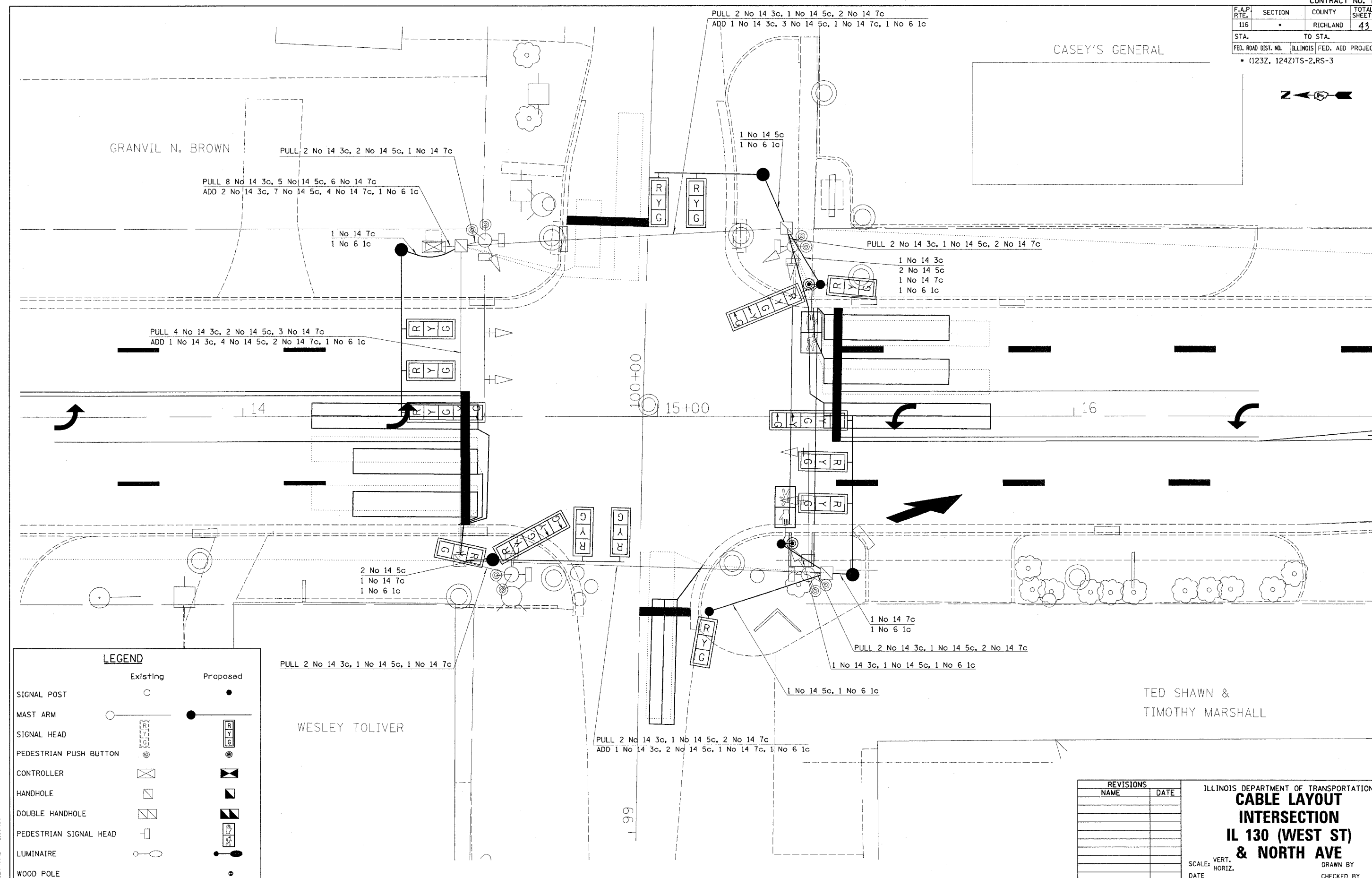

LEGEND

	Existing	Proposed
SIGNAL POST	○	●
MAST ARM	○—	●—
SIGNAL HEAD		
PEDESTRIAN PUSH BUTTON		
CONTROLLER		
HANDHOLE		
DOUBLE HANDHOLE		
PEDESTRIAN SIGNAL HEAD		
LUMINAIRE		
WOOD POLE		

REVISIONS	
NAME	DATE

ILLINOIS DEPARTMENT OF TRANSPORTATION
CABLE LAYOUT INTERSECTION
IL 130 (WEST ST) & NORTH AVE

SCALE: VERT. _____
HORIZ. _____

DATE _____ DRAWN BY _____
CHECKED BY _____

PLOT DATE = #/##/####
FILE NAME = #FILE#
PLOT SCALE = #SCALE#
USER NAME = #USER#