

F.A.I. RTE.	SECTION	COUNTY	TOTAL SHEETS	SHEET NO.
70		FAYETTE	5	1

• D7 BIT RESURF 2007-1

STATE OF ILLINOIS
DEPARTMENT OF TRANSPORTATION
DIVISION OF HIGHWAYS

**PROPOSED
HIGHWAY PLANS**

FAI ROUTE 70
SECTION D-7 BIT RESURF 2007-1
PROJECT

FAYETTE COUNTY
RESURFACING OF RAMPS AT BROWNSTOWN WEIGH STATION

C-97-103-06

D-97-061-06

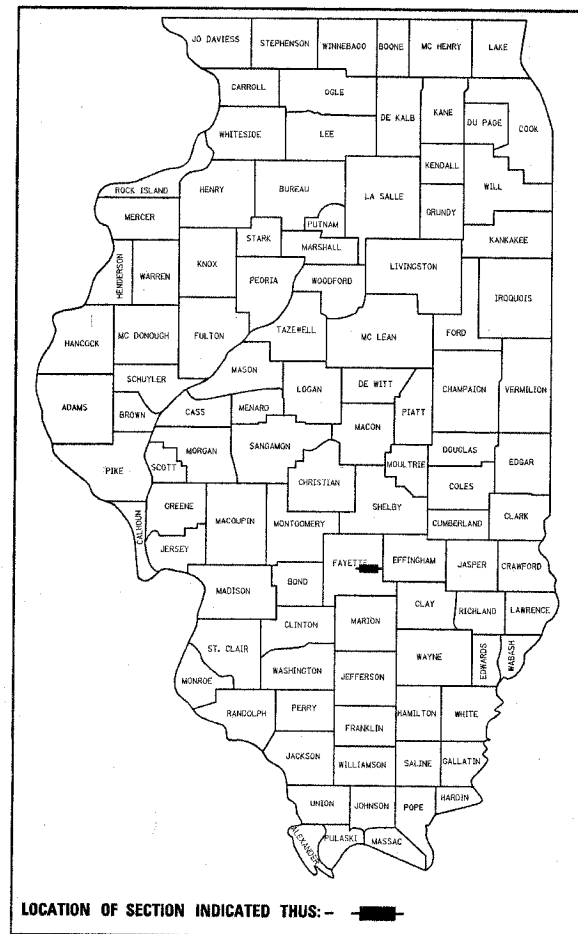

FOR INDEX OF SHEETS, SEE SHEET NO. 2

OMISSION = 877+47 TO 907+84

STATION EQUATION
22+62.87 BK = 900+07.73 AH

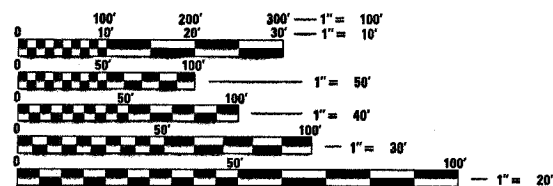
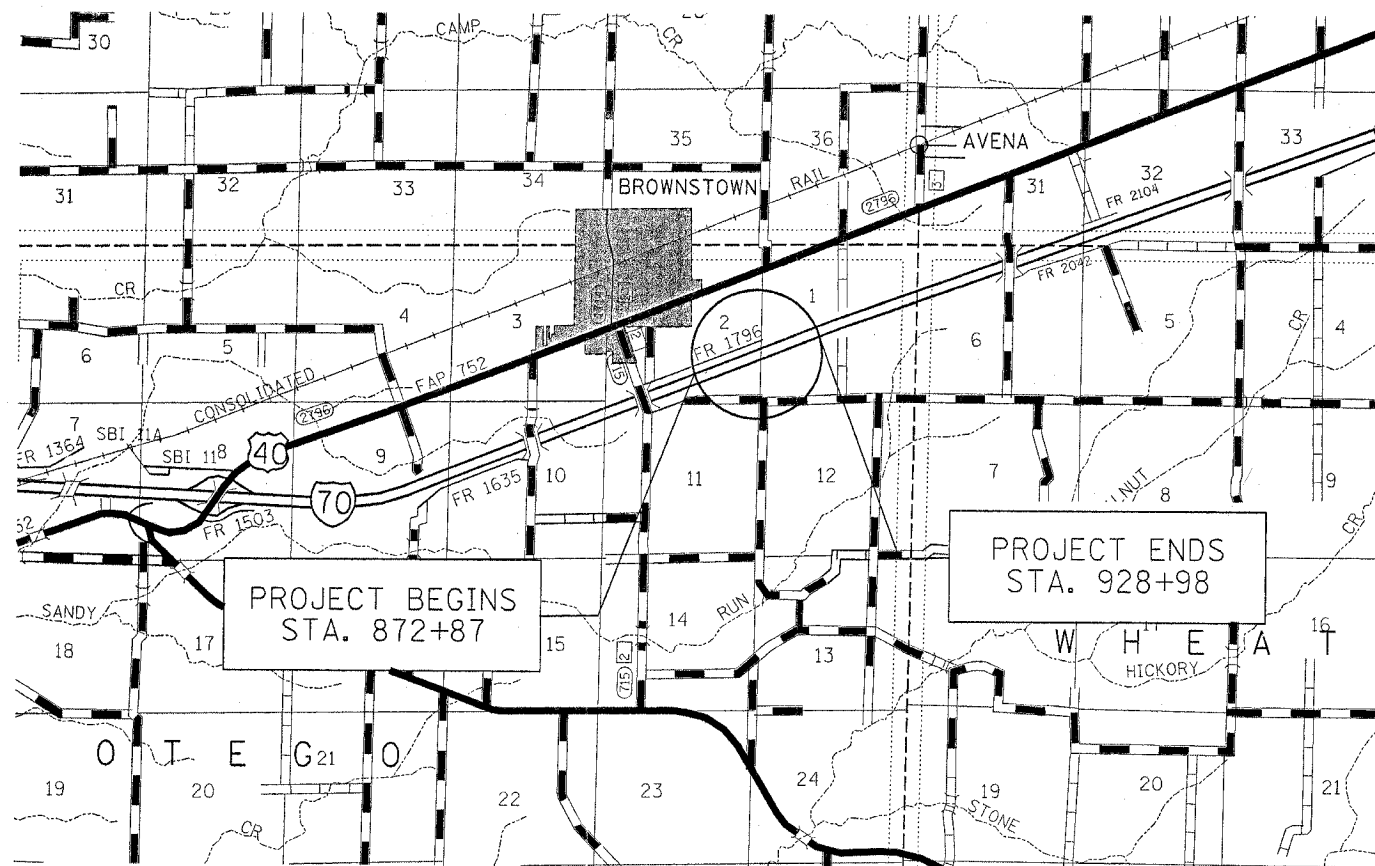

FULL SIZE PLANS HAVE BEEN PREPARED USING STANDARD ENGINEERING SCALES. REDUCED SIZED PLANS WILL NOT CONFORM TO STANDARD SCALES. IN MAKING MEASUREMENTS ON REDUCED PLANS, THE ABOVE SCALES MAY BE USED.

J.U.L.I.E.
JOINT UTILITY LOCATION INFORMATION FOR EXCAVATION
1-800-892-0123

GROSS LENGTH = 5613.14 FEET 1.06 MILES
NET LENGTH = 2574.00 FEET 0.49 MILES

CONTRACT NO. 74188

STATE OF ILLINOIS
DEPARTMENT OF TRANSPORTATION
DIVISION OF HIGHWAYS

SUBMITTED May 19, 20 06
Christ M. Reed
DEPUTY DIRECTOR OF HIGHWAYS, REGION ENGINEER

June 30, 20 06
Mike Sine
ENGINEER OF DESIGN AND ENVIRONMENT

June 30, 20 06
Milton Sear
DIRECTOR OF HIGHWAYS, CHIEF ENGINEER

**PRINTED BY THE AUTHORITY
OF THE STATE OF ILLINOIS**

PROJECT ENGINEER: MARK DAUGHERTY
SQUAD LEADER: JOYCE HEMMEN
DESIGNER: JOYCE HEMMEN
TELEPHONE: (217) 342-3951 EXT. 313

F.A.I. RTE.	SECTION	COUNTY	TOTAL SHEETS	SHEET NO.
70	*	FAYETTE	5	2
STA.		TO STA.		
FED. ROAD DIST. NO.	ILLINOIS	FED. AID PROJECT		

* 07 BIT RESURF 2007-1

GENERAL NOTES

THIS SECTION SHALL BE CONSTRUCTED IN ACCORDANCE WITH THE PLANS; THE "STANDARD SPECIFICATIONS FOR ROAD AND BRIDGE CONSTRUCTION" ADOPTED JANUARY 1, 2002; THE "SUPPLEMENTAL SPECIFICATIONS AND RECURRING SPECIAL PROVISIONS" INDICATED ON THE CHECK SHEET, AND "THE SPECIAL PROVISIONS" INCLUDED IN THIS PROPOSAL.

THE WORK INCLUDED IN THIS SECTION CONSISTS OF THE REMOVAL OF THE EXISTING BITUMINOUS SURFACE AND THE PLACEMENT OF BITUMINOUS BINDER AND SURFACE COURSES ON THE WEIGH STATION RAMPS AT INTERSTATE 70 NEAR BROWNSTOWN AND ANY OTHER WORK NECESSARY TO COMPLETE THIS SECTION.

THE MATERIAL THAT IS REMOVED BITUMINOUS SURFACE REMOVAL WILL BECOME THE PROPERTY OF THE DEPARTMENT AND SHALL BE TRANSPORTED AND STOCKPILED AT THE VANDALIA YARD, NORTH OF VANDALIA OFF US ROUTE 51. THE CONTRACTOR SHALL CONTACT THE IDOT BUREAU OF OPERATIONS TO COORDINATE THE DELIVERY OF THIS MATERIAL.

THE CONTRACTOR WILL PROVIDE INTERNET ACCESSIBILITY TO THE BITUMINOUS PLANT REPORTS CAN BE E-MAILED TO THE DISTRICT HEADQUARTERS. THIS WORK SHALL BE INCLUDED IN THE COST OF ALL BITUMINOUS ITEMS.

THE CONTRACTOR WILL BE REQUIRED TO USE EITHER RC-70 OR SS-1HP AS THE BITUMINOUS MATERIALS PRIME COAT.

THE TOTAL QUANTITY OF THERMOPLASTIC PAVEMENT MARKING, LINE 4" CONSISTS OF 1463 FT. OF YELLOW AND 3815 FT. OF WHITE AND THE TOTAL QUANTITY OF THERMOPLASTIC PAVEMENT MRKING, LINE 8" CONSISTS OF 360 FT. OF WHITE.

THE FOLLOWING BITUMINOUS CONCRETE BINDER CSE., SUPERPAVE, IL-19.0, N105 MIXTURE REQUIREMENTS ARE APPLICABLE TO THIS PROJECT:

MIXTURE USE(S):	BINDER COURSE
PG GRADE:	SBS PG 76-22
RAP%:	0%
DESIGN AIR VOIDS:	4.0% @ NDESIGN = 105
MIXTURE COMPOSITION:	IL-19.0
FRICTION AGGREGATE:	N/A

THE FOLLOWING POLYMERIZED BITUMINOUS CONCRETE SURFACE COURSE, SUPERPAVE, MIXTURE D, N90 MIXTURE REQUIREMENTS ARE APPLICABLE TO THIS PROJECT:

MIXTURE USE(S):	SURFACE COURSE
AC/PG:	SBS PG 76-22
RAP%: (MAX)	0%
DESIGN AIR VOIDS:	4.0% @ NDESIGN = 105
MIXTURE COMPOSITION: (GRADATION MIXTURE)	IL-9.5
FRICTION AGGREGATE:	MIXTURE D

INDEX OF SHEETS INDEX OF SHEETS

SHEET NO.	DESCRIPTION
1	COVER SHEET
2	GENERAL NOTES & INDEX OF SHEETS
3	SUMMARY OF QUANTITIES
4	TYPICAL SECTIONS
5	PLAN SHEET

THE FOLLOWING STANDARDS ARE A PART OF THESE PLANS AND ARE INCLUDED AFTER SHEET NUMBER 38

STD. NO.	DESCRIPTION
000001-04	STANDARD SYMBOLS, ABBREVIATIONS, PATTERNS
001006	DECIMAL OF AN INCH AND OF A FOOT
701400-02	APPROACH TO LANE CLOUSER, FREEWAY/EXPRESSWAY
701401-03	LANE CLOSURE, FREEWAY/EXPRESSWAY
701426-02	LANE CLOSURE, MULTILANE, INTERMITTENT OR MOVING OPERATIONS
702001-06	TRAFFIC CONTRL DEVICES

PLOT DATE = 5/18/2006
 FILE NAME = c:\p-re\p-re\74188\06\06186-02.dwg
 PLOT SCALE = 100.0000 / IN
 USER NAME = hammerje

REVISIONS	
NAME	DATE

ILLINOIS DEPARTMENT OF TRANSPORTATION

INDEX OF SHEETS AND GENERAL NOTES

SCALE: VERT. DRAWN BY
 DATE: HORIZ. CHECKED BY

F.A.I. RTE.	SECTION	COUNTY	TOTAL SHEETS	SHEET NO.
70	*	FAYETTE	5	3

STA.	TO STA.
FED. ROAD DIST. NO.	ILLINOIS FED. AID PROJECT

* D7 BIT RESURF 2007-1

SUMMARY OF QUANTITIES

SUMMARY OF QUANTITIES			TOTAL QUANTITIES	CONSTRUCTION TYPE CODE		
CODE NO	ITEM	UNIT		1000		
40600100	BITUMINOUS MATERIALS (PRIME COAT)	GALLON	459	459		
44000007	BITUMINOUS SURFACE REMOVAL 2"	SQ YD	2801	2801		
44000030	BITUMINOUS SURFACE REMOVAL (VARIABLE DEPTH)	SQ YD	1875	1875		
67100100	MOBILIZATION	L SUM	1	1		
70100800	TRAFFIC CONTROL AND PROTECTION, STANDARD 701401	L SUM	1	1		
70100800	TRAFFIC CONTROL AND PROTECTION, STANDARD 701401	L SUM	1	1		
* 78000200	THERMOPLASTIC PAVEMENT MARKING - LINE 4"	FOOT	5278	5278		
* 78000500	THERMOPLASTIC PAVEMENT MARKING - LINE 8"	FOOT	360	360		
* 78100100	RAISED REFLECTIVE PAVEMENT MARKER	EACH	6	6		
X4066530	POLYMERIZED BITUMINOUS CONCRETE SURFACE COURSE, SUPERPAVE, MIX "D", N105	TON	514	514		
X4066660	POLYMERIZED BITUMINOUS CONCRETE BINDER COURSE, SUPERPAVE, IL-19.0, N105	TON	289	289		

* SPECIALTY ITEMS

PLOT DATE = 5/18/2006
 FILE NAME = c:\projects\74188\drawings\summary.dwg
 PLOT SCALE = 1/8" = 1' IN
 USER NAME = hennings

Rev

REVISIONS	
NAME	DATE

ILLINOIS DEPARTMENT OF TRANSPORTATION

SUMMARY OF QUANTITIES

SCALE: VERT.
 DATE HORIZ.

DRAWN BY
 CHECKED BY

F.A.I. RTE.	SECTION	COUNTY	TOTAL SHEETS	SHEET NO.
70		FAYETTE	5	4
STA.		TO STA.		
FED. ROAD DIST. NO.		ILLINOIS FED. AID PROJECT		
• D7 BIT RESURF 2007-1				

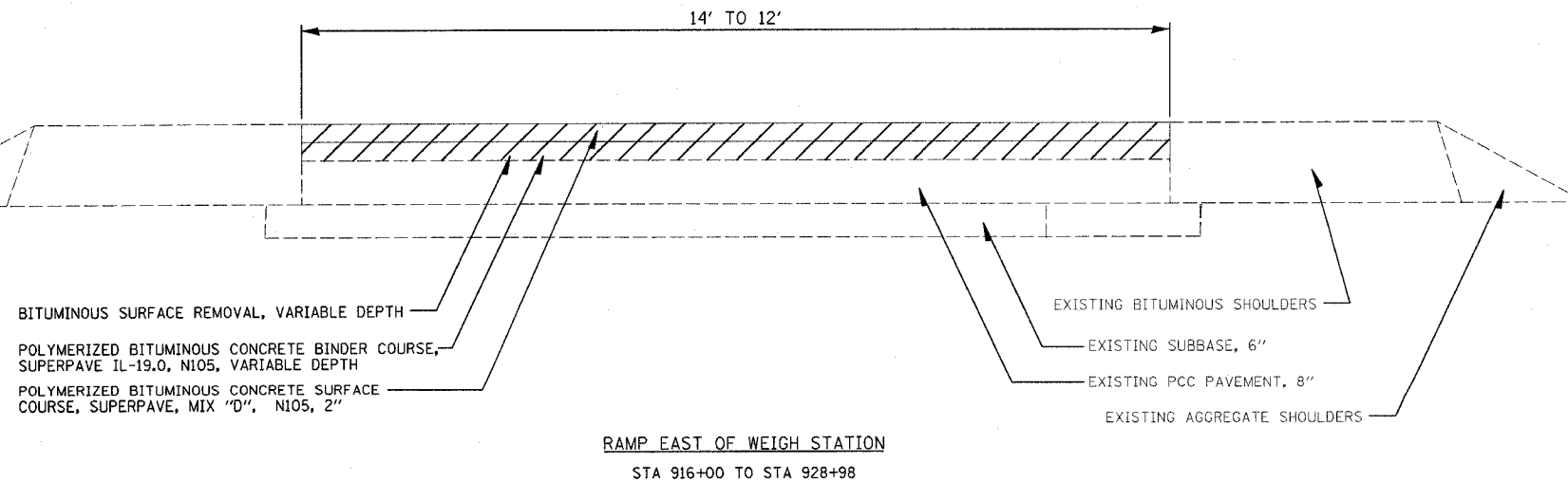
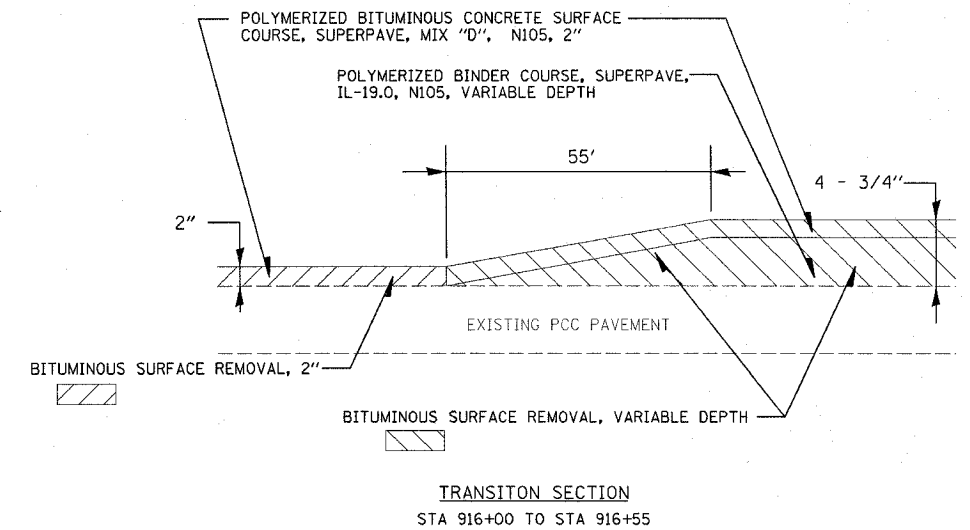
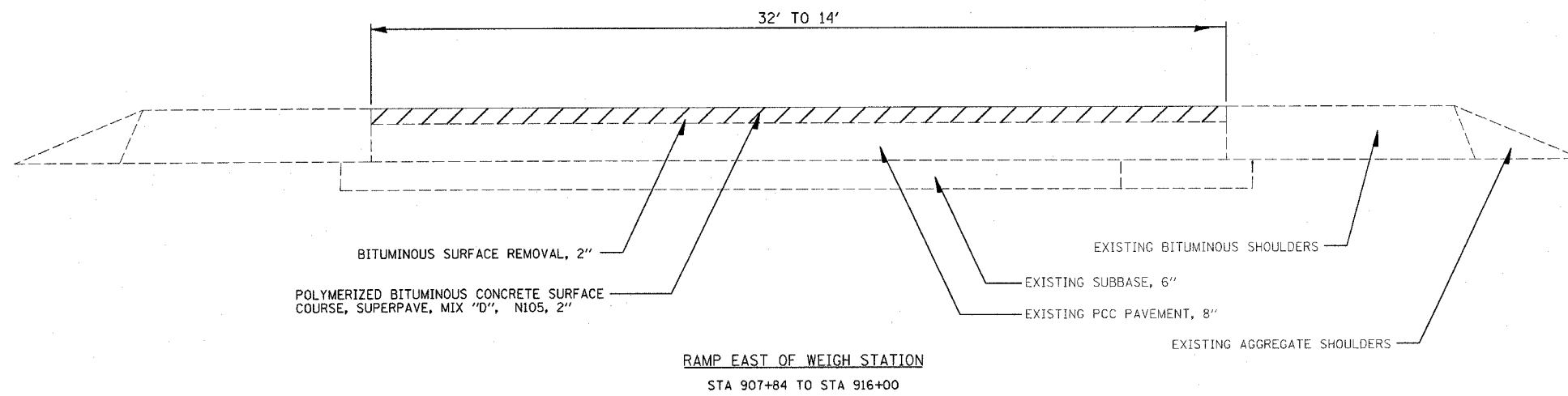
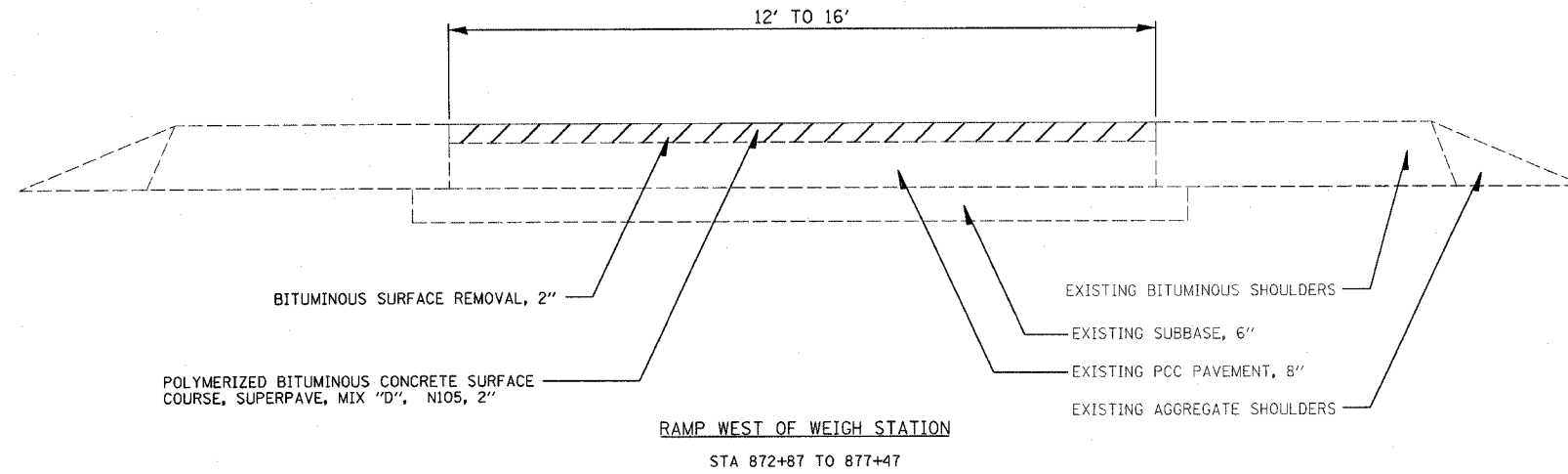

PLOT DATE = 5/15/2006
 FILE NAME = 74188.dwg
 PLOT SCALE = 1/8" = 1'-0"
 USER NAME = hammerj

REVISIONS	
NAME	DATE

ILLINOIS DEPARTMENT OF TRANSPORTATION

**TYPICAL SECTIONS
&
DETAIL**

SCALE: VERT.
HORIZ.
DATE

DRAWN BY
CHECKED BY

F.A.I. RTE.	SECTION	COUNTY	TOTAL SHEETS	SHEET NO.
70		FAYETTE	5	5
STA.	TO STA.			
FED. ROAD DIST. NO.	ILLINOIS	FED. AID PROJECT		
• D7 BIT RESURF 2007-1				

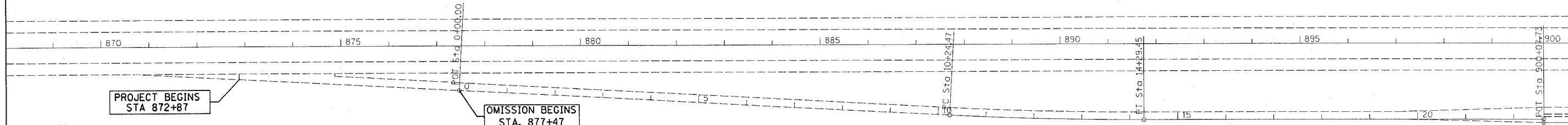

EXIST. CURVE WEIGHA-1
 PI STA. = 12+27.01
 $\Delta = 3^\circ 02' 15''$ (LT)
 $D = 0^\circ 45' 00''$
 $R = 7,639.44'$
 $T = 202.54'$
 $L = 404.99'$
 $E = 2.68'$
 $e = \text{-----}$
 $T.R. = \text{-----}$
 $S.E. RUN = \text{-----}$
 P.C. STA. = 10+24.47
 P.T. STA. = 14+29.45

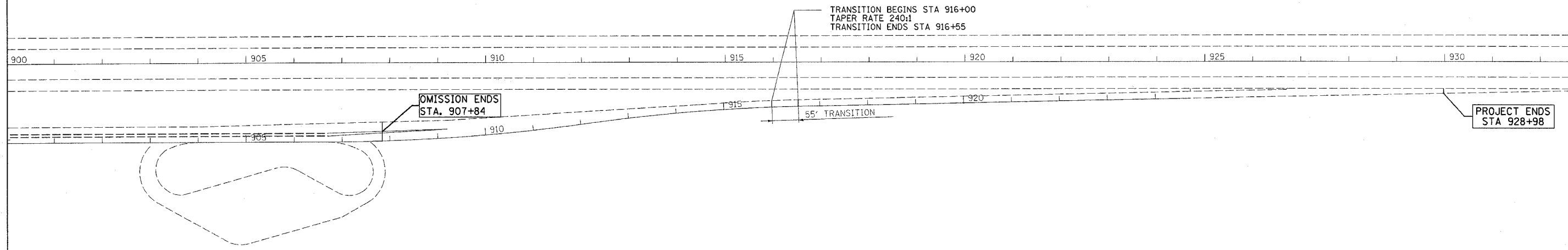

PLOT DATE = 5/18/2006
 FILE NAME = c:\p\c\p\74188\4188.dwg
 PLOT SCALE = 1/8"=1'-0"
 USER NAME = hammerj

REVISIONS	
NAME	DATE

ILLINOIS DEPARTMENT OF TRANSPORTATION

PLAN SHEET

SCALE: VERT. _____
 HORIZ. _____

DRAWN BY _____
 CHECKED BY _____