

FAP ROUTE	SECTION	COUNTY	TOTAL SHEETS	SHEET NO
42	2BR	WASHINGTON	33	7
STA.	TO STA.			
EXISTING CONDITIONS:				

CONTRACT NO. 76389

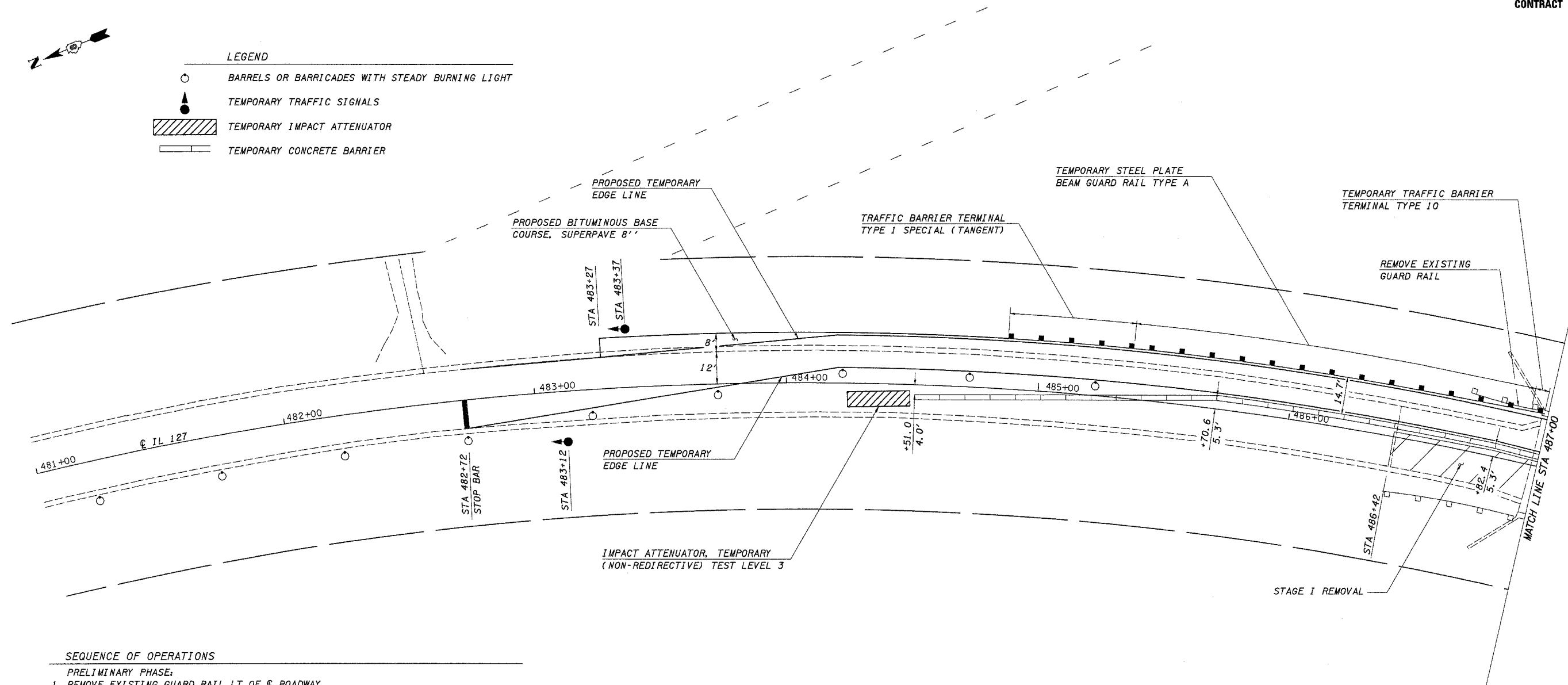

LEGEND	
	BARRELS OR BARRICADES WITH STEADY BURNING LIGHT
	TEMPORARY TRAFFIC SIGNALS
	TEMPORARY IMPACT ATTENUATOR
	TEMPORARY CONCRETE BARRIER



SEQUENCE OF OPERATIONS

PRELIMINARY PHASE:

1. REMOVE EXISTING GUARD RAIL LT OF ϕ ROADWAY.
2. CONSTRUCT EMBANKMENT AND BITUMINOUS BASE COURSE SUPERPAVE, 8" LT STA 483+27 TO STA 486+96 AND LT STA 487+50 TO STA 491+23.
3. TO STA 486+98 AND LT STA 487+48 TO STA 489+61.
4. ESTABLISH ONE-LANE, TWO-WAY TRAFFIC IN NORTHBOUND LANE AND INSTALL WORK ZONE TRAFFIC CONTROL DEVICES AND TEMPORARY CONCRETE BARRIER AS SHOWN ON THIS PLAN AND STANDARD 701321.

STAGE 1:

1. REMOVE STAGE 1 PORTION OF EXISTING STRUCTURE, PAVEMENT AND GUARD RAIL.
2. CONSTRUCT STAGE 1 PORTION OF PROPOSED STRUCTURE AND APPROACH PAVEMENT.
3. MILL SOUTHBOUND LANE; CONSTRUCT EMBANKMENT AND BITUMINOUS BASE COURSE SUPERPAVE, 8" RT STA 483+27 TO STA 486+51 AND RT STA 487+98 TO STA 491+23.
4. RESURFACE SOUTHBOUND LANE.
5. CONSTRUCT SOUTHBOUND BITUMINOUS AND EARTH SHOULDER.
6. INSTALL PROPOSED GUARD RAIL AND TERMINALS ON STAGE 1 PORTION OF PROPOSED STRUCTURE.

NOTES

TEMPORARY CONCRETE BARRIER ON THE APPROACH ROADWAY SHALL BE PLACED PARALLEL TO THE ϕ OF IL 127. TEMPORARY CONCRETE BARRIER WITHIN THE LIMITS OF THE PROPOSED STRUCTURE SHALL BE PLACED PARALLEL TO THE ϕ OF THE PROPOSED STRUCTURE.

OFFSETS REFER TO THE DISTANCE FROM THE ϕ OF IL 127 TO THE FACE OF THE TEMPORARY CONCRETE BARRIER.

EXISTING EARTH SHOULDERS SHALL BE WIDENED AS SHOWN ON STANDARD 630301 AT ALL PROPOSED TRAFFIC BARRIER TERMINAL TYPE 1 SPECIAL (TANGENT) LOCATIONS.

SEE STANDARD 701321 FOR DETAILS NOT SHOWN.

TEMPORARY RUMBLE STRIPS SHALL BE INSTALLED ON EACH APPROACH AS DETAILED ON STANDARD 701321.

IF THE CONTRACTOR ELECTS TO DELAY BITUMINOUS RESURFACING UNTIL AFTER STAGE CONSTRUCTION IS COMPLETE, TEMPORARY RAMPS AND AGGREGATE PRIME COAT WILL BE REQUIRED. THE COST OF THESE ITEMS WILL NOT BE PAID FOR SEPERATELY BUT SHALL BE INCLUDED IN THE COST OF THE VARIOUS RESURFACING ITEMS.

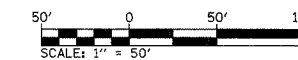

STAGE I CONSTRUCTION

FAP ROUTE 42 (IL 127)
SECTION 2BR
WASHINGTON COUNTY

CUMMINS ENGINEERING CORPORATION

JOB #: 2158
FILE: Stage1
DATE: 3/17/05

PLAN	DATE
SURVEYED	
DESIGNED	
CHECKED	
BY	
DATE	
NO.	

DATE: TIME*
DGN-SPEC
*REF-TO: 06/06/05, LV-2-3, 5-14, 21, 23, 25, 27, 30, 38, 56, 59, 61
*REF-FILE: 06/06/05, LV-2-66