

F.A.P. RTE.	SECTION	COUNTY	TOTAL SHEETS	SHEET NO.
600	34RS-2	ST. CLAIR	39	20
STA. 92+50.00		TO STA. 97+50.00		
FED. ROAD DIST. NO. ILLINOIS FED. AID PROJECT				

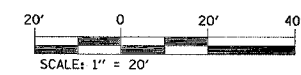
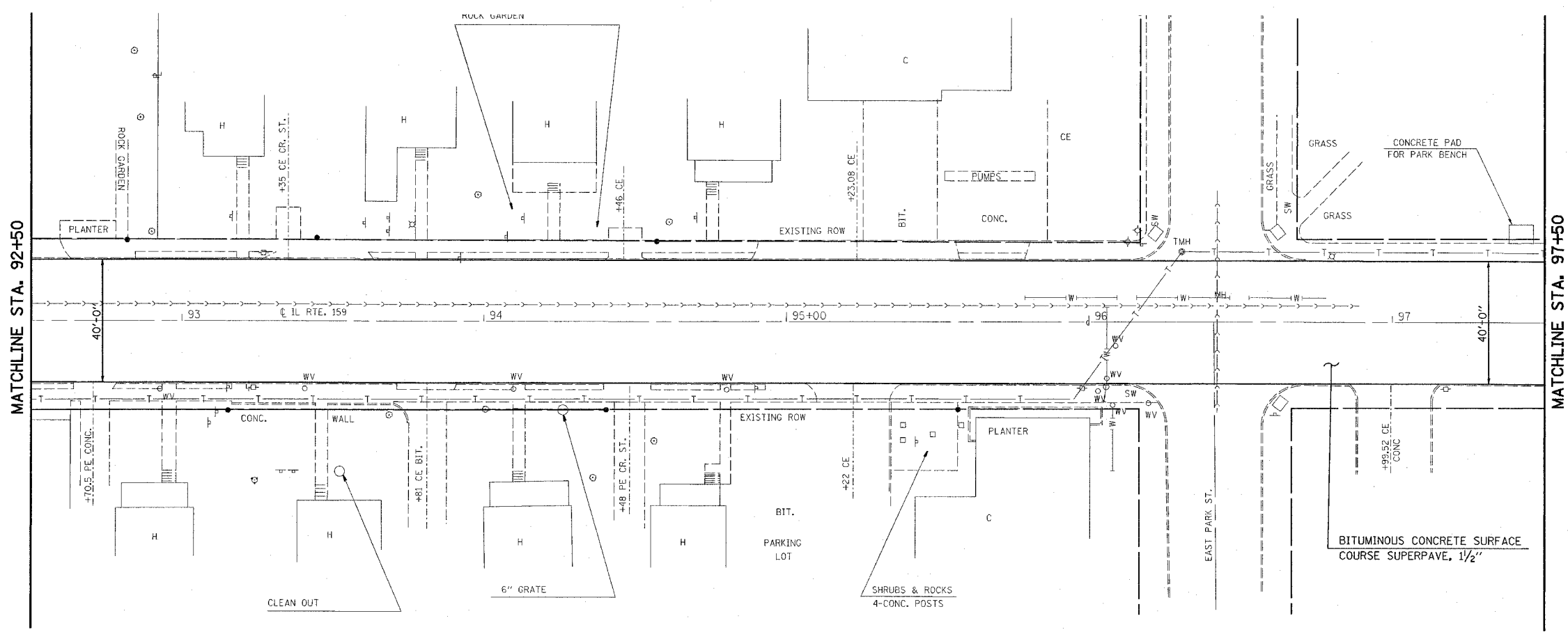

DATE	ILLINOIS DEPARTMENT OF TRANSPORTATION
	PLAN VIEW
	FAP ROUTE 600
	SECTION 34RS-2
	MADISON COUNTY
	SCALE: VERT. 1" = 20'
	HORIZ. 1" = 40'
	DATE
	DRAWN BY
	CHECKED BY

PLOT DATE = 5/15/2006
 FILE NAME = o:\projects\ed7188\plan\plan1009a.dgn
 USER NAME = dirmahony