

F.A.P. RTE.	SECTION	COUNTY	TOTAL SHEETS	SHEET NO.
312	1221-4	RANDOLPH	21	8
STA.	TO STA.			
FED. ROAD DIST. NO.	ILLINOIS	FED. AID PROJECT		

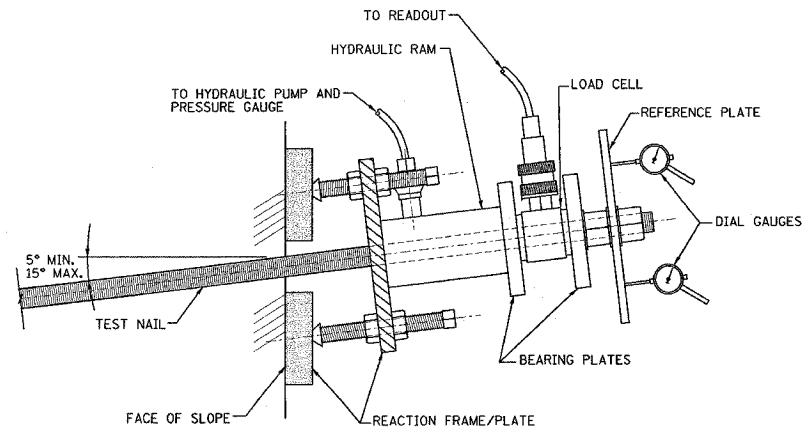
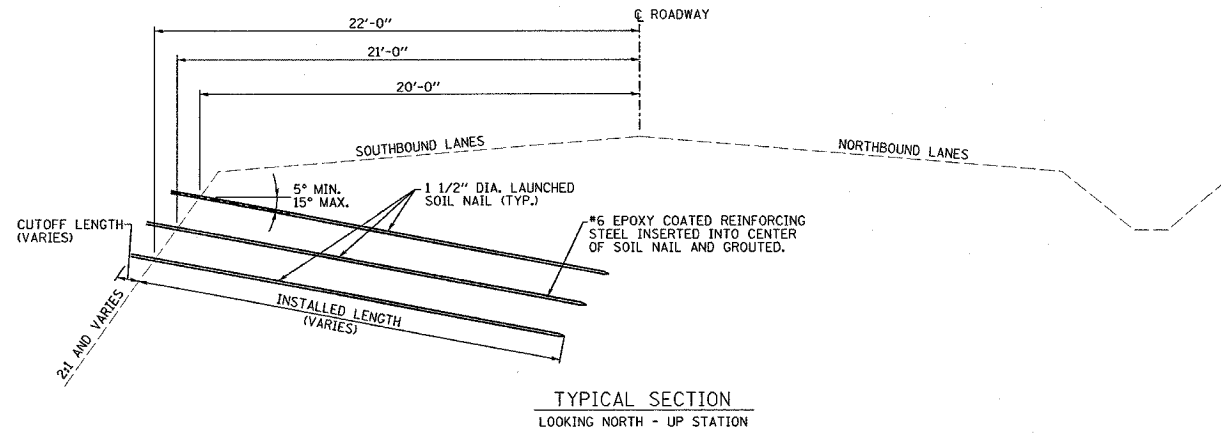
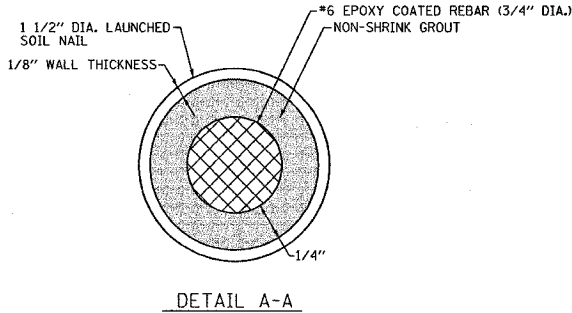
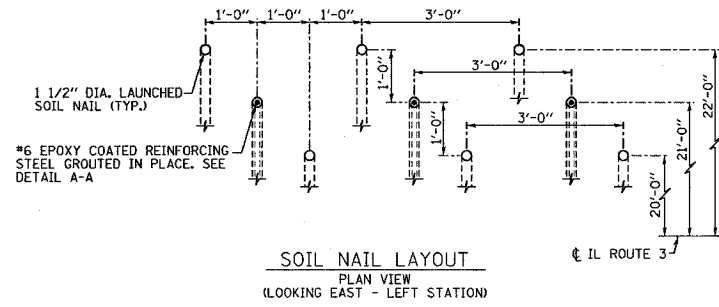

**PULLOUT TESTING DETAIL**  
 \* ACTUAL SETUP TO BE SUBMITTED BY CONTRACTOR PRIOR TO COMMENCING WORK (SEE SPECIAL PROVISION FOR LAUNCHED SOIL NAILS)

REVISIONS	
NAME	DATE

ILLINOIS DEPARTMENT OF TRANSPORTATION  
**DETAILS**  
 FAP ROUTE 312 (IL 003)  
 SECTION 1221-4  
 RANDOLPH COUNTY

SCALE: VERT. \_\_\_\_\_  
 HORIZ. \_\_\_\_\_  
 DATE \_\_\_\_\_  
 DRAWN BY \_\_\_\_\_  
 CHECKED BY \_\_\_\_\_

PLAN	NO.	DATE
SURVEYED	BY	
PLANNED	BY	
DESIGNED	BY	
CHECKED	BY	
IN CHARGE	BY	
DATE		

5/17/2006  
 5/19/2006  
 REF.  
 REF.