

F.A.P. RTE.	SECTION	COUNTY	TOTAL SHEETS	SHEET NO.
312	122I-4	RANDOLPH	21	1

STATE OF ILLINOIS

DEPARTMENT OF TRANSPORTATION

DIVISION OF HIGHWAYS

PLANS FOR PROPOSED FEDERAL AID HIGHWAY

F.A.P. ROUTE 312 (IL ROUTE 3)

SECTION 122I-4

PROJECT: NHF-0312(030)

RANDOLPH COUNTY

SLOPE STABILITY IMPROVEMENTS,

SOIL NAILING

C-98-027-05

INDEX OF SHEETS

1. COVER SHEET
2. GENERAL NOTES, COMMITMENTS, AND STANDARDS
3. SUMMARY OF QUANTITIES
- 4.-7. PLAN SHEETS
8. DETAILS
- 9.-21. CROSS SECTIONS



PROJECT ENGINEER: WENDA SOUTHERLAND (618)346-3159
 SQUAD LEADER: GREG HANCOCK (618)346-3195

MICROFILMED _____
 REEL NUMBER _____
 AWARDED _____
 RESIDENT ENGINEER _____
 AS BUILT CHANGES WERE MADE
 ON THE FOLLOWING SHEETS

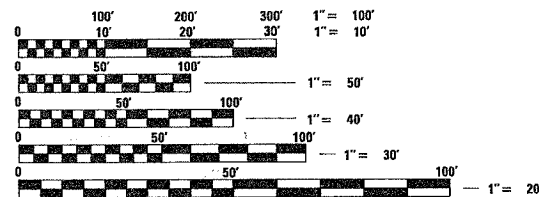

FULL SIZE PLANS HAVE BEEN PREPARED USING STANDARD ENGINEERING SCALES, REDUCED SIZED PLANS WILL NOT CONFORM TO STANDARD SCALES, IN MAKING MEASUREMENTS ON REDUCED PLANS, THE ABOVE SCALES MAY BE USED.

J.U.L.I.E.
 JOINT UTILITY LOCATION INFORMATION FOR EXCAVATION
 1-800-892-0123

CONTRACT NO. 76859

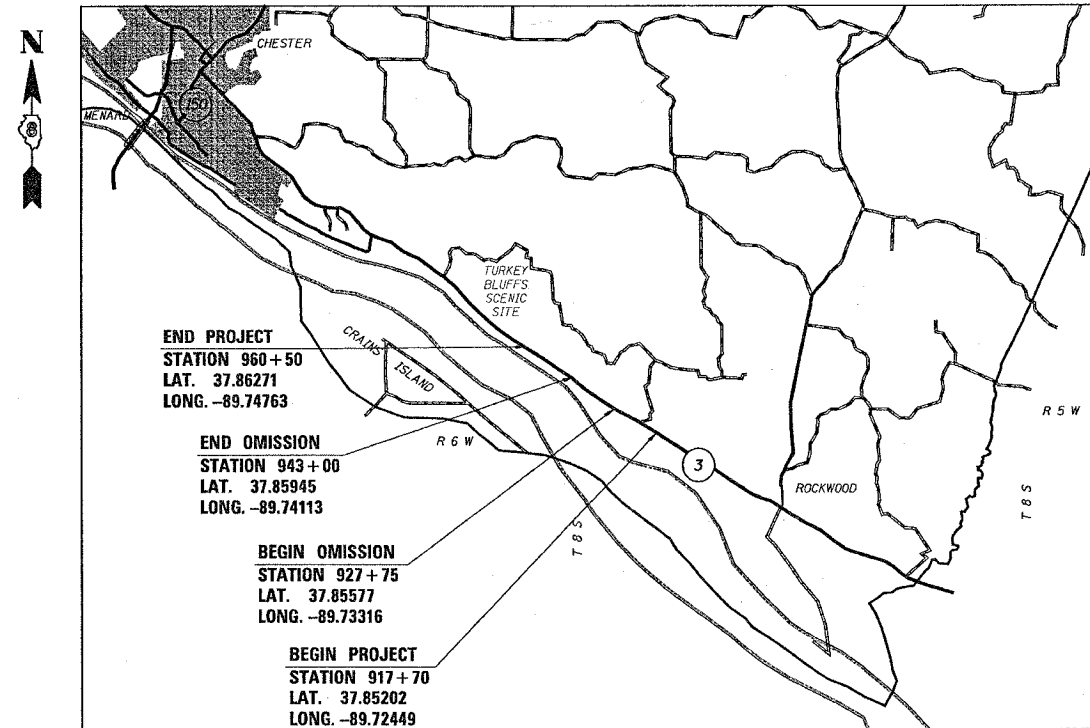

PROJECT LENGTH: 0.81 MILES (4280 FT.)
 GROSS LENGTH: 0.81 MILES (4280 FT.)
 NET LENGTH: 0.52 MILES (2755 FT.)

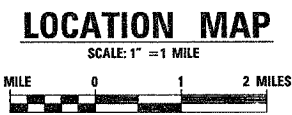

ADT	
2006	2600
S.U.	6.7%
M.U.	8.6%

STATE OF ILLINOIS
 DEPARTMENT OF TRANSPORTATION
 DIVISION OF HIGHWAYS

SUBMITTED May 19, 2006

Max Lami
 DEPUTY DIRECTOR OF HIGHWAYS
 REGION FIVE ENGINEER

June 30, 2006
Mike Hine
 ENGINEER OF DESIGN AND ENVIRONMENT

June 30, 2006
Milton P. Seas, P.E.
 DIRECTOR, DIVISION OF HIGHWAYS

PRINTED BY THE AUTHORITY
 OF THE STATE OF ILLINOIS

SUMMARY OF QUANTITIES

F.A.P. RTE.	SECTION	COUNTY	TOTAL SHEETS	SHEET NO.
312	1221-4	RANDOLPH	21	3
STA.		TO STA.		
FED. ROAD DIST. NO.		ILLINOIS FED. AID PROJECT		

SUMMARY OF QUANTITIES			RURAL 80% FED 20% STATE TOTAL QUANTITIES	CONSTRUCTION TYPE CODE		
CODE NO	ITEM	UNIT		Y009		
50800205	REINFORCEMENT BARS, EPOXY COATED	POUND	27,607	27,607		
67100100	MOBILIZATION	L SUM	1	1		
70100450	TRAFFIC CONTROL AND PROTECTION, STANDARD 701201	L SUM	1	1		
X0325453	LAUNCHED SOIL NAILS	EACH	2755	2755		
X0325451	NON-SHRINK GROUT	CU FT	330	330		
X0325452	PULLOUT TESTING	EACH	31	31		

SUMMARY OF QUANTITIES				CONSTRUCTION TYPE CODE		
CODE NO	ITEM	UNIT	TOTAL QUANTITIES			

5/18/2006
 c:\projects\76859\plan\76859.dgn
 -REF-

F.A.P. RTE.	SECTION	COUNTY	TOTAL SHEETS	SHEET NO.
312	1221-4	RANDOLPH	21	4
STA.		TO STA.		
FED. ROAD DIST. NO.		ILLINOIS FED. AID PROJECT		



PLANS DRAWN FROM MICROFILM
FIELD VERIFY EXISTING CONDITIONS

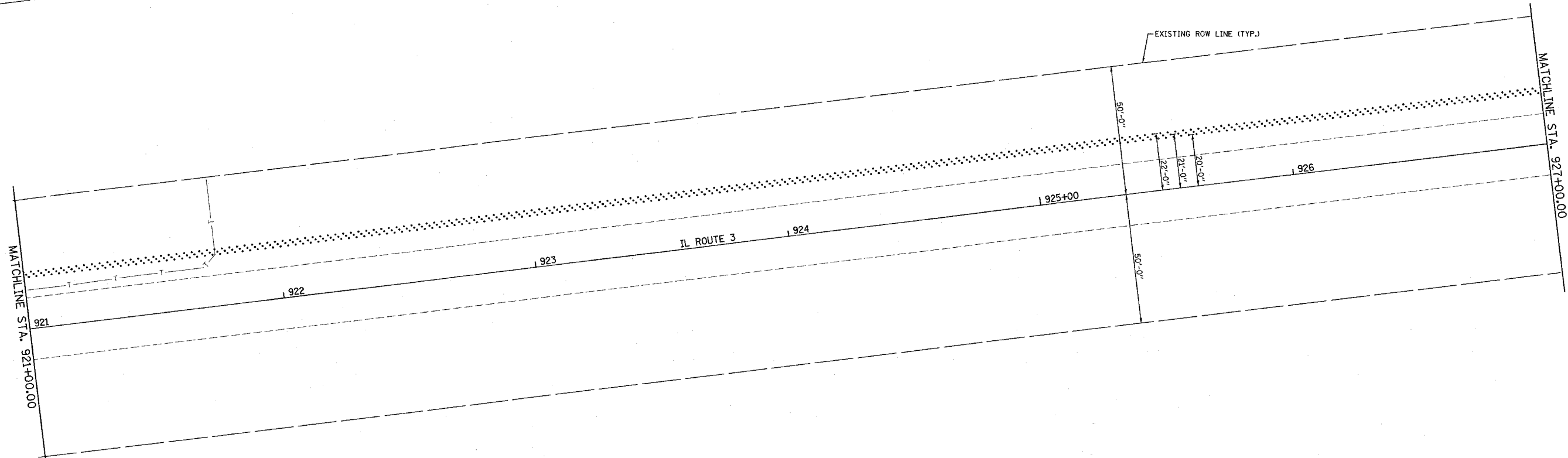
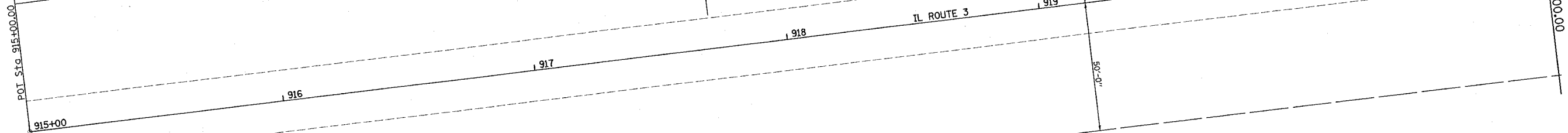

PLAN	SURVEYED	DATE
	NOTE BOOK	
	ALIGNED	
	CHECKED	
	BY	
	NO.	

REVISIONS	
NAME	DATE

ILLINOIS DEPARTMENT OF TRANSPORTATION
PLAN VIEW
FAP ROUTE 312 (IL 003)
SECTION 1221-4
RANDOLPH COUNTY

SCALE: VERT. _____
HORIZ. _____
DATE _____ DRAWN BY _____
CHECKED BY _____

5/18/2006
5/18/2006
5/18/2006
5/18/2006

F.A.P. RTE.	SECTION	COUNTY	TOTAL SHEETS	SHEET NO.
312	1221-4	RANDOLPH	21	5
STA. 927+00.00		TO STA. 933+00.00		
FED. ROAD DIST. NO.		ILLINOIS FED. AID PROJECT		

PLANS DRAWN FROM MICROFILM
FIELD VERIFY EXISTING CONDITIONS

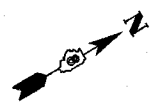

PLAN	SURVEYED	DATE
	PLOTTED	
	NOTED	
	BY	
	NO. OF STA. CHECKED	
	CADD FILE NAME	

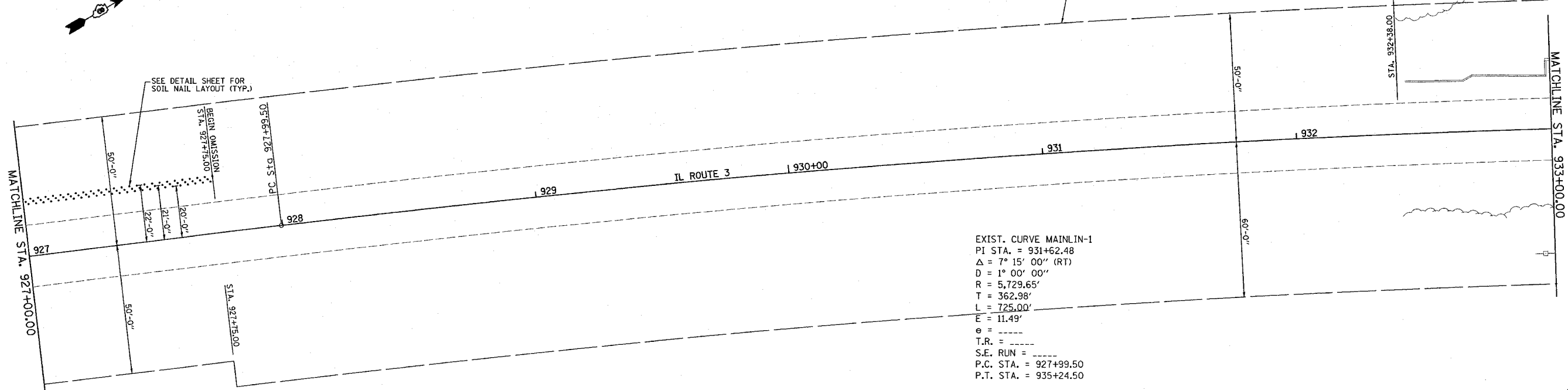

EXIST. CURVE MAINLIN-1
 PI STA. = 931+62.48
 $\Delta = 7^\circ 15' 00''$ (RT)
 $D = 1^\circ 00' 00''$
 $R = 5,729.65'$
 $T = 362.98'$
 $L = 725.00'$
 $E = 11.49'$
 $e = \text{-----}$
 $T.R. = \text{-----}$
 $S.E. RUN = \text{-----}$
 $P.C. STA. = 927+99.50$
 $P.T. STA. = 935+24.50$

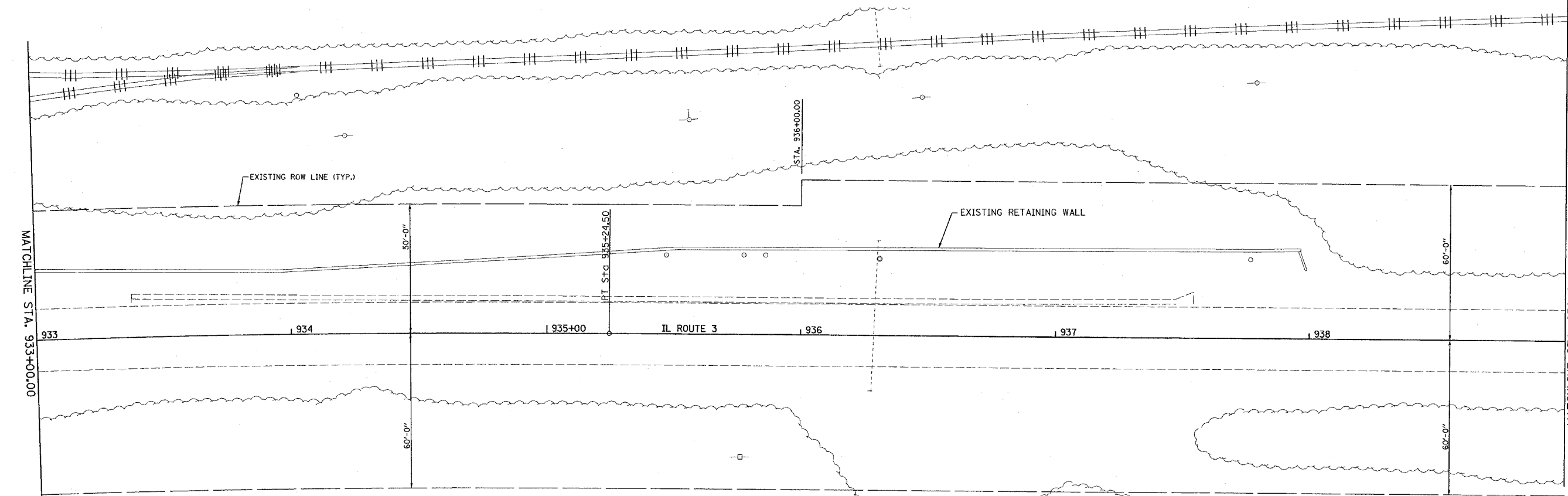

REVISIONS	
NAME	DATE

ILLINOIS DEPARTMENT OF TRANSPORTATION
PLAN VIEW
 FAP ROUTE 312 (IL 003)
 SECTION 1221-4
 RANDOLPH COUNTY

SCALE: VERT. _____
 HORIZ. _____
 DATE _____
 DRAWN BY _____
 CHECKED BY _____

PLOT DATE: 5/18/2006

DATE: 5/18/2006
 PROJECT: VANDERBILT UNIVERSITY
 REF: _____

F.A.P. RTE.	SECTION	COUNTY	TOTAL SHEETS	SHEET NO.
312	1221-4	RANDOLPH	21	6
STA.	TO STA.			
FED. ROAD DIST. NO.	ILLINOIS	FED. AID PROJECT		

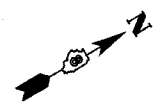

PLAN	DATE
BY	
REVISIONS	
PLOTTED	
ALIGNED	
CHECKED	
NO.	

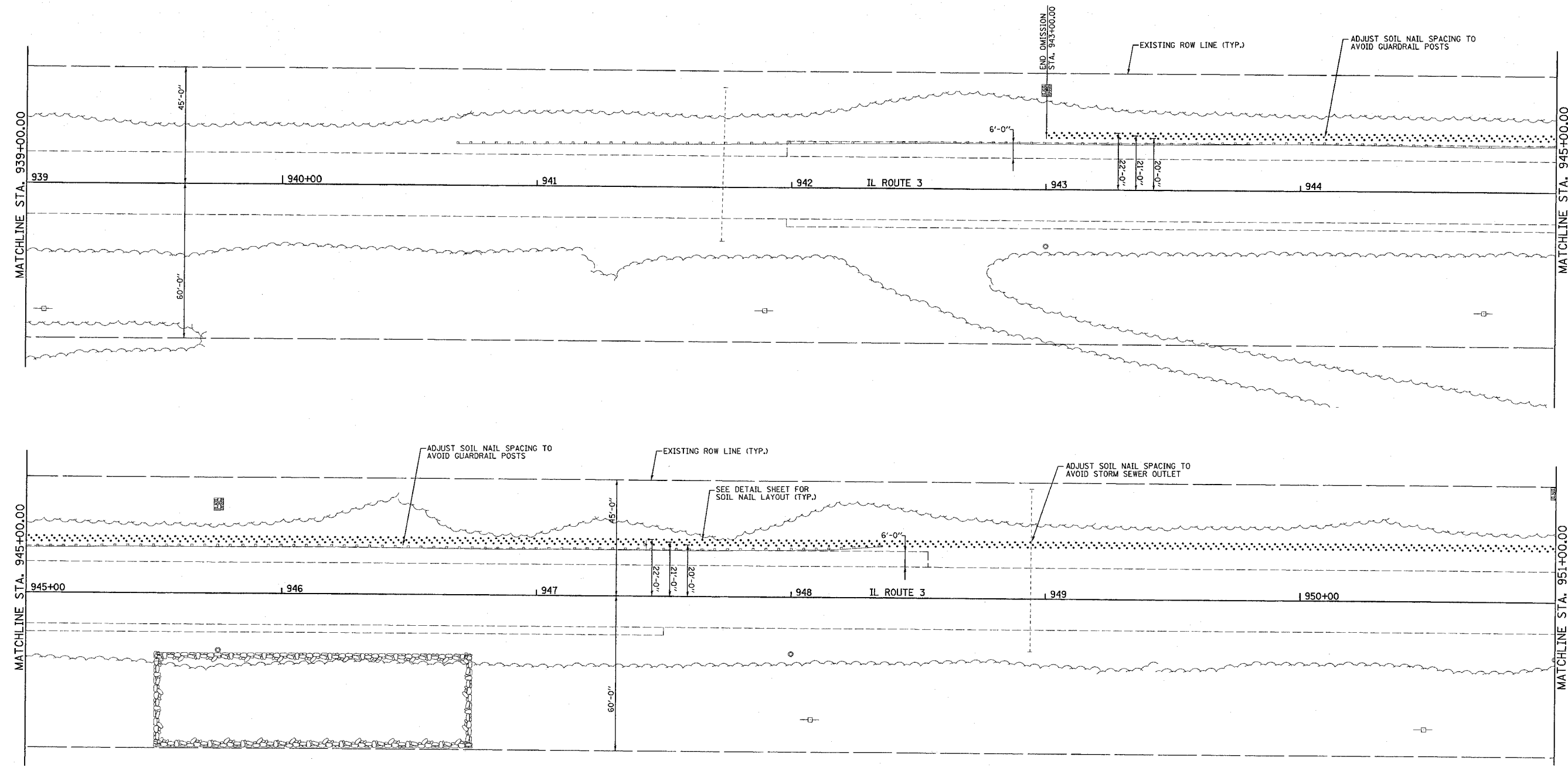

5/18/2006
 ca:\projects\76859\plan\plan\76859.dgn
 REF

REVISIONS	
NAME	DATE

ILLINOIS DEPARTMENT OF TRANSPORTATION
PLAN VIEW
 FAP ROUTE 312 (IL 003)
 SECTION 1221-4
 RANDOLPH COUNTY

SCALE: VERT. _____
 HORIZ. _____

DATE _____ DRAWN BY _____
 CHECKED BY _____

F.A.P. RTE.	SECTION	COUNTY	TOTAL SHEETS	SHEET NO.
312	122I-4	RANDOLPH	21	7
STA. TO STA.				
FED. ROAD DIST. NO.			ILLINOIS FED. AID PROJECT	

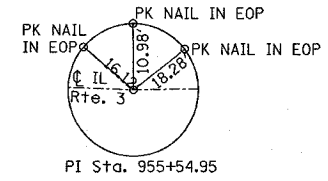

PLAN	DATE
SURREYED	
NOTE BOOK	
RT. OF WAY CHECKED	
NO. _____	DATE FILE NAME

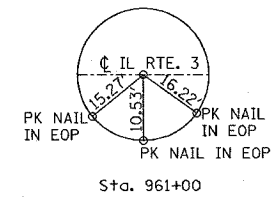
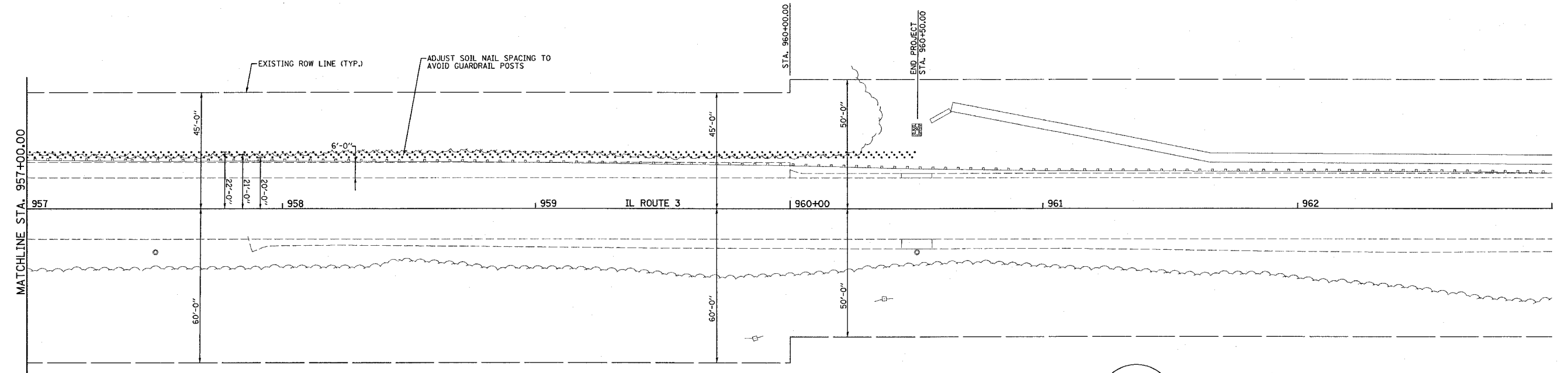
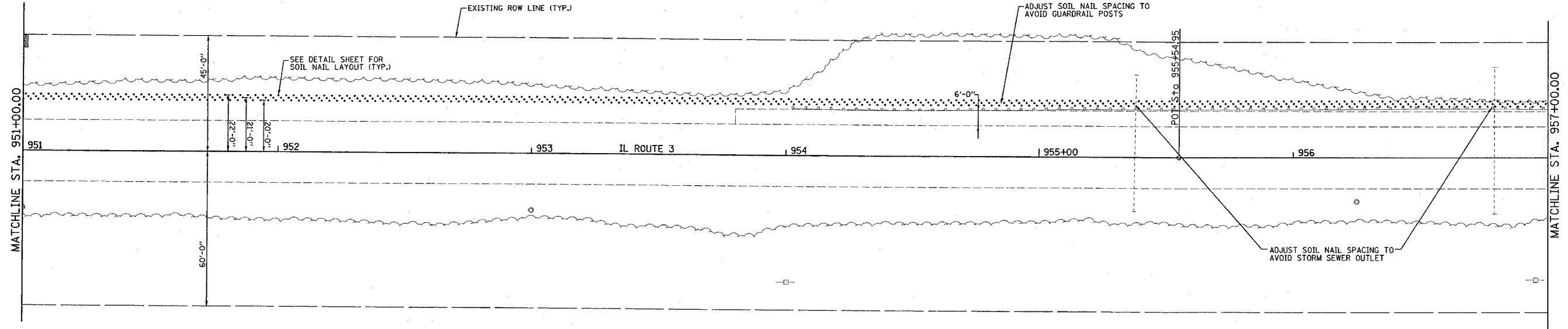

REVISIONS	
NAME	DATE

ILLINOIS DEPARTMENT OF TRANSPORTATION
PLAN VIEW
 FAP ROUTE 312 (IL 003)
 SECTION 122I-4
 RANDOLPH COUNTY

SCALE: VERT. _____
 HORIZ. _____
 DATE _____
 DRAWN BY _____
 CHECKED BY _____

*DRAWN BY: 5/18/2006
 *REF: 5/18/2006
 *REF: 5/18/2006
 *REF: 5/18/2006

F.A.P. RTE.	SECTION	COUNTY	TOTAL SHEETS	SHEET NO.
312	1221-4	RANDOLPH	21	8
STA.		TO STA.		
FED. ROAD DIST. NO.		ILLINOIS FED. AID PROJECT		

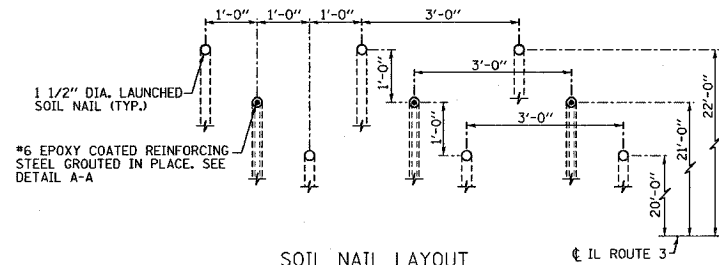

SOIL NAIL LAYOUT
PLAN VIEW
(LOOKING EAST - LEFT STATION)

CL IL ROUTE 3

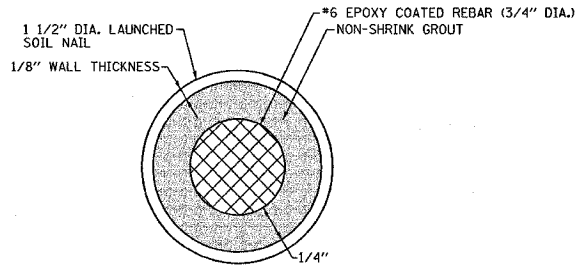

DETAIL A-A

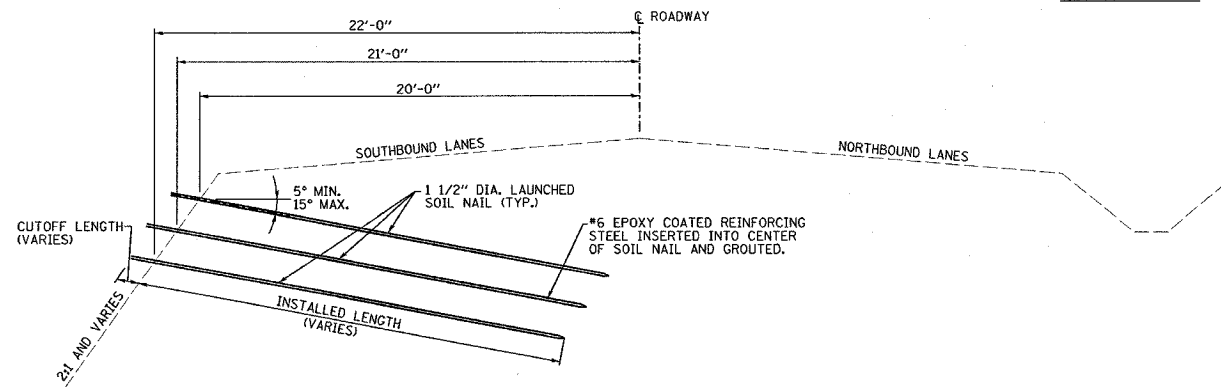

TYPICAL SECTION
LOOKING NORTH - UP STATION

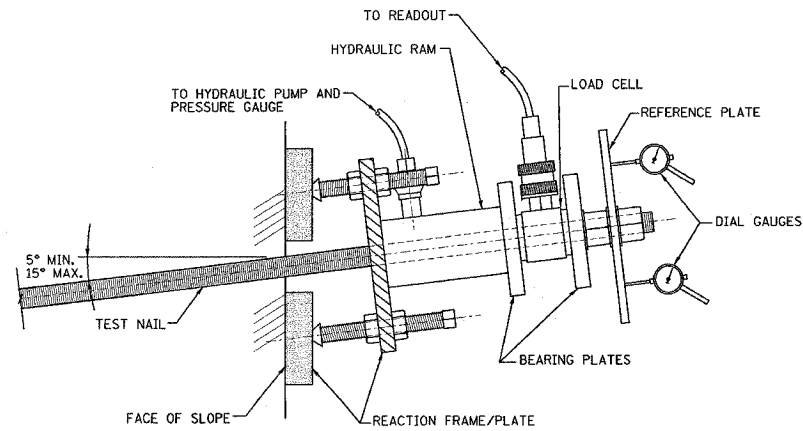

PULLOUT TESTING DETAIL
* ACTUAL SETUP TO BE SUBMITTED BY CONTRACTOR PRIOR TO COMMENCING WORK (SEE SPECIAL PROVISION FOR LAUNCHED SOIL NAILS)

REVISIONS	
NAME	DATE

ILLINOIS DEPARTMENT OF TRANSPORTATION
DETAILS
FAP ROUTE 312 (IL 003)
SECTION 1221-4
RANDOLPH COUNTY

SCALE: VERT. _____
HORIZ. _____
DATE _____ DRAWN BY _____
CHECKED BY _____

PLAN	SURVEYED	DATE
NO.	FILED	
	BY	
	DATE	
	BY	
	DATE	
	BY	
	DATE	

5/17/2006
5/17/2006
5/17/2006
5/17/2006

FINAL	SURVEYED	BY	DATE
SURVEY	PLOTTED		
NOTE BOOK	TEMPLATE		
NO.	AREAS CHECKED		

ORIGINAL	SURVEYED	BY	DATE
SURVEY	PLOTTED		
NOTE BOOK	TEMPLATE		
NO.	AREAS CHECKED		

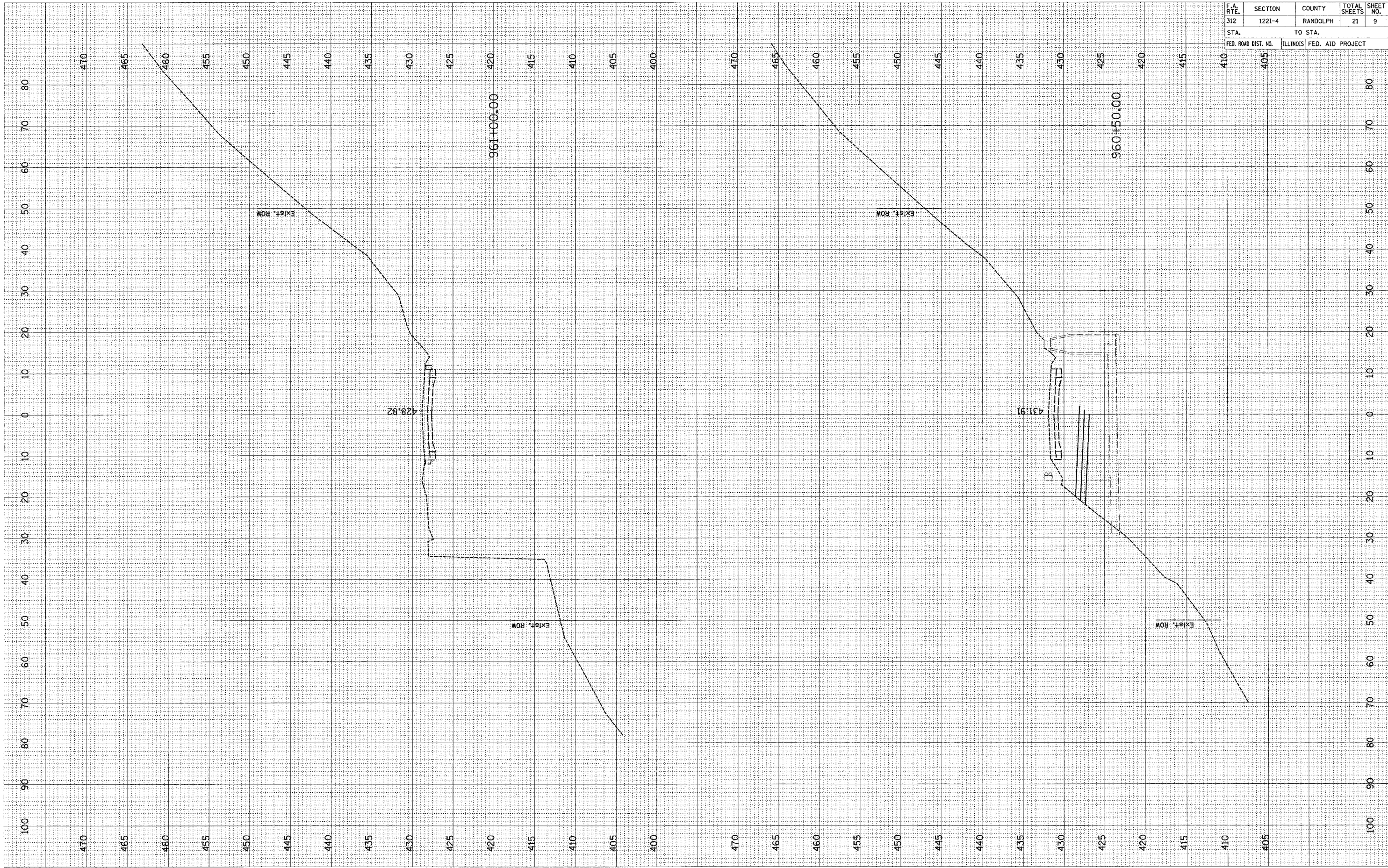

F.A. DIST. NO.	SECTION	COUNTY	TOTAL SHEETS	SHEET NO.
312	1221-4	RANDOLPH	21	9
STA.	TO STA.			
FED. ROAD DIST. NO.	ILLINOIS	FED. AID PROJECT		

FINAL	SURVEYED	DATE
SURVEY	BY	
NOTE BOOK		
TEMPLATE		
AREAS		
CHECKED		
NO.		

ORIGINAL	SURVEYED	DATE
SURVEY	BY	
NOTE BOOK		
TEMPLATE		
AREAS		
CHECKED		
NO.		

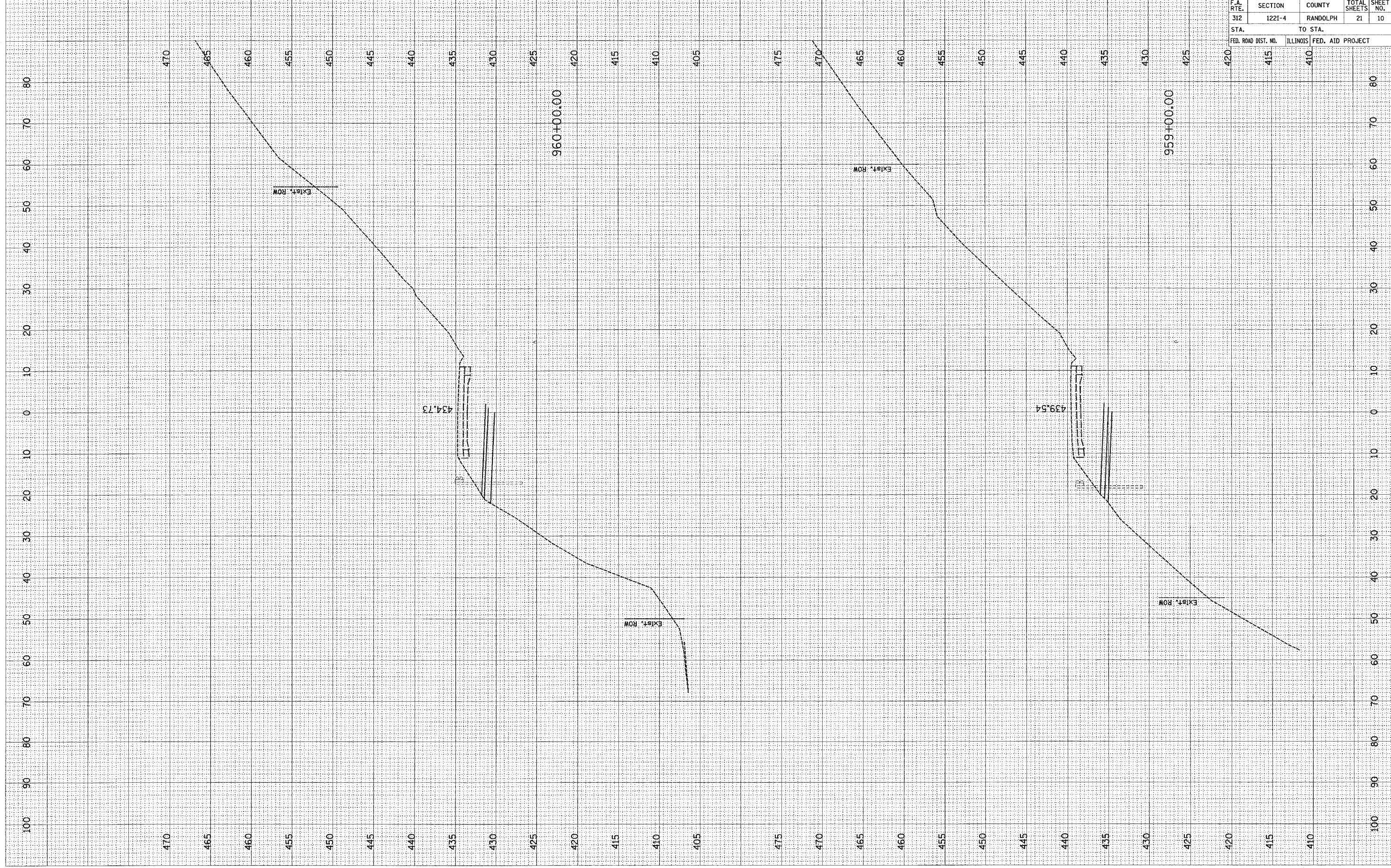

F.A. RTE.	SECTION	COUNTY	TOTAL SHEETS	SHEET NO.
312	1221-4	RANDOLPH	21	10
STA.	TO STA.			
FED. ROAD DIST. NO.	ILLINOIS	FED. AID PROJECT		
415	410			

FINAL SURVEY BY DATE
 SURVEYED BY _____
 NOTE BOOK NO. _____
 TEMPLATE _____
 AREAS CHECKED _____
 AREAS CHECKED _____

ORIGINAL SURVEY BY DATE
 SURVEYED BY _____
 NOTE BOOK NO. _____
 TEMPLATE _____
 AREAS CHECKED _____
 AREAS CHECKED _____

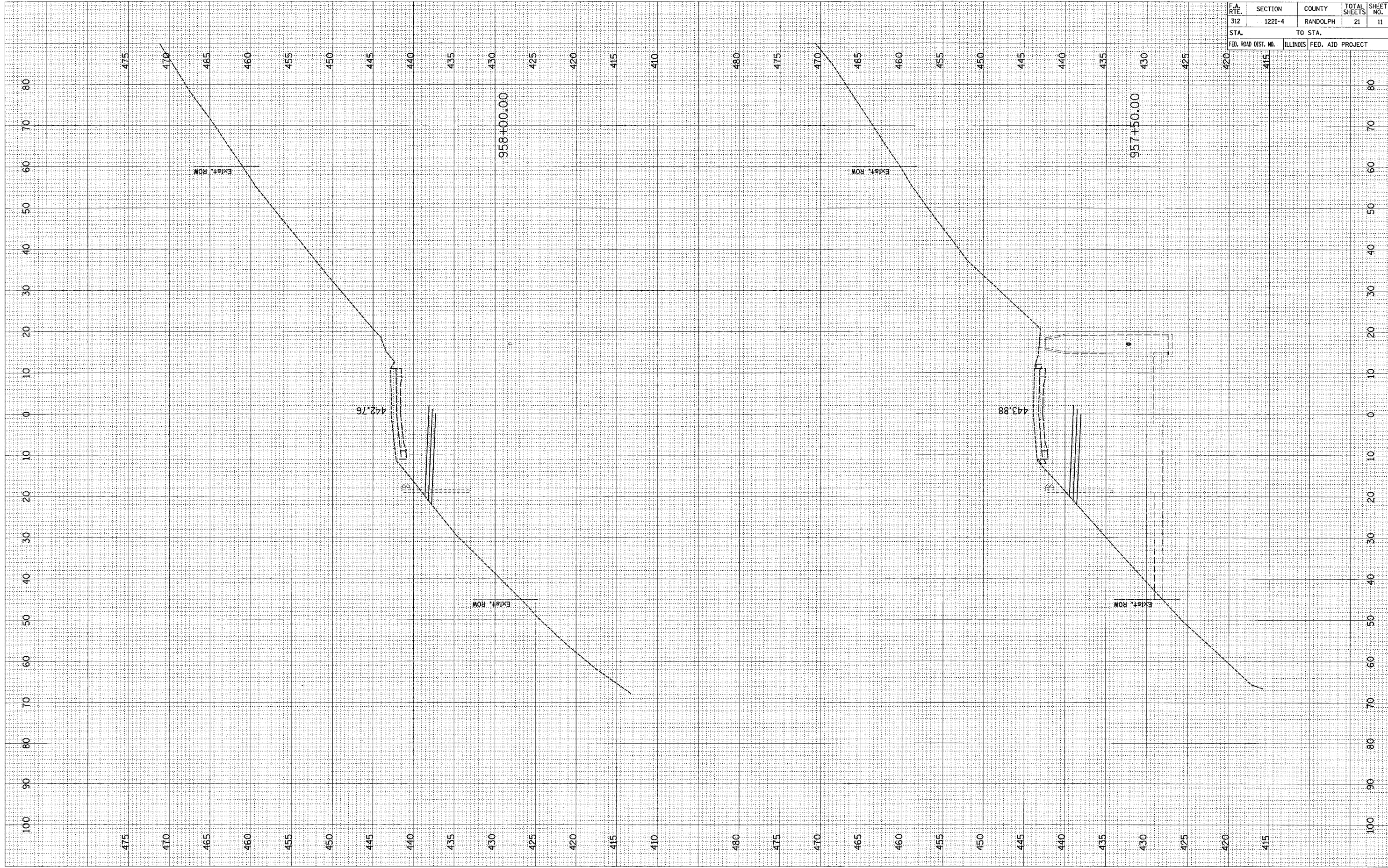

F.A. RTE.	SECTION	COUNTY	TOTAL SHEETS	SHEET NO.
312	1221-4	RANDOLPH	21	11
STA.		TO STA.		
FED. ROAD DIST. NO.		ILLINOIS FED. AID PROJECT		

FINAL	SUPERVISOR	DATE
SURVEY	PLOTTED	BY
NOTE BOOK	TEMPLATE	
NO.	AREAS	CHECKED

ORIGINAL	SUPERVISOR	DATE
SURVEY	PLOTTED	BY
NOTE BOOK	TEMPLATE	
NO.	AREAS	CHECKED

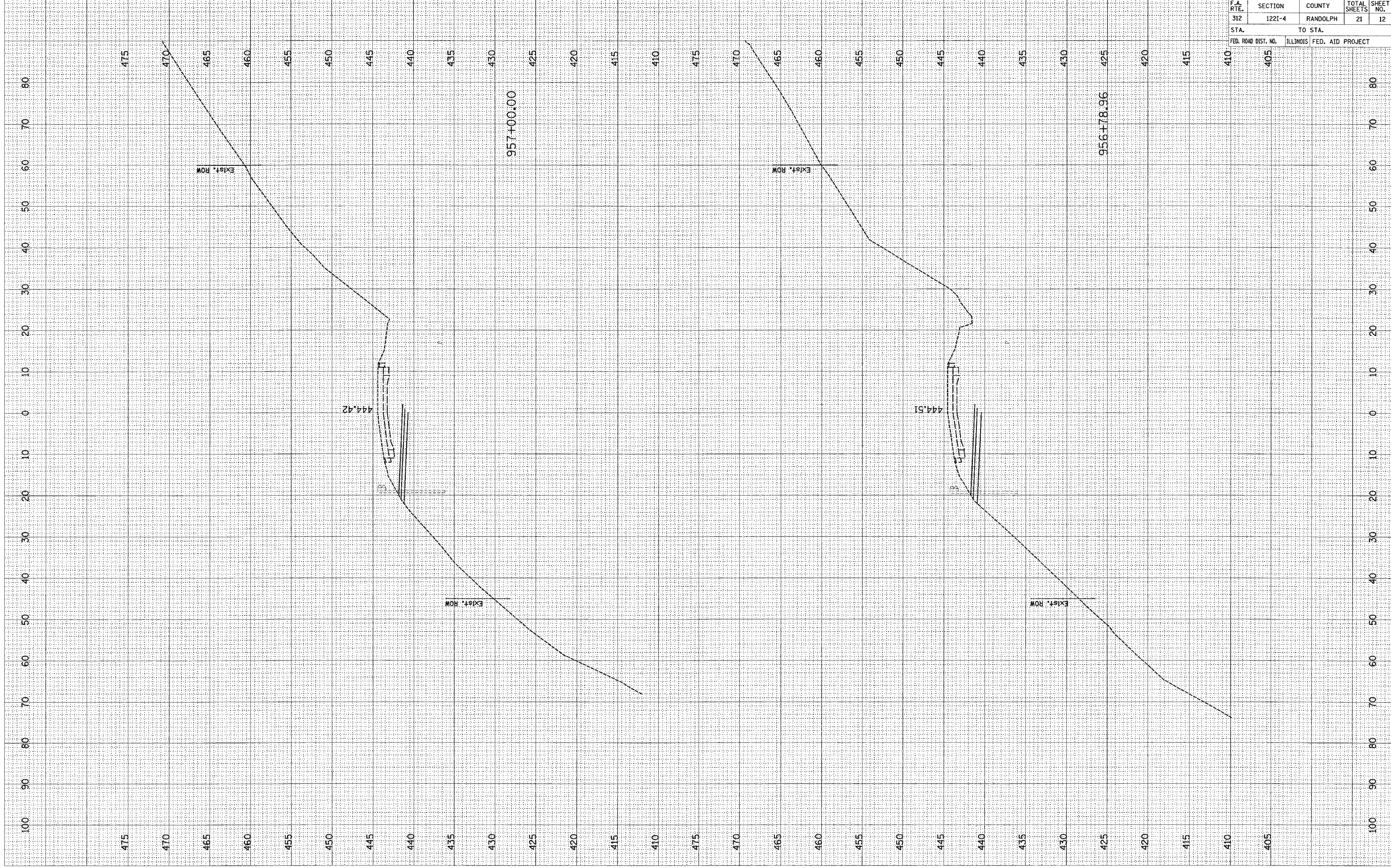

F.A. RTE.	SECTION	COUNTY	TOTAL SHEETS	SHEET NO.
312	1221-4	RANDOLPH	21	12
STA.	TO STA.			
FED. ROAD DIST. NO.	ILLINOIS	FED. AID PROJECT		

FINAL SURVEY	SURVEYED	BY	DATE
NOTE BOOK	PLOTTED		
NO.	AREAS		
	CHECKED		

ORIGINAL SURVEY	SURVEYED	BY	DATE
NOTE BOOK	PLOTTED		
NO.	AREAS		
	CHECKED		

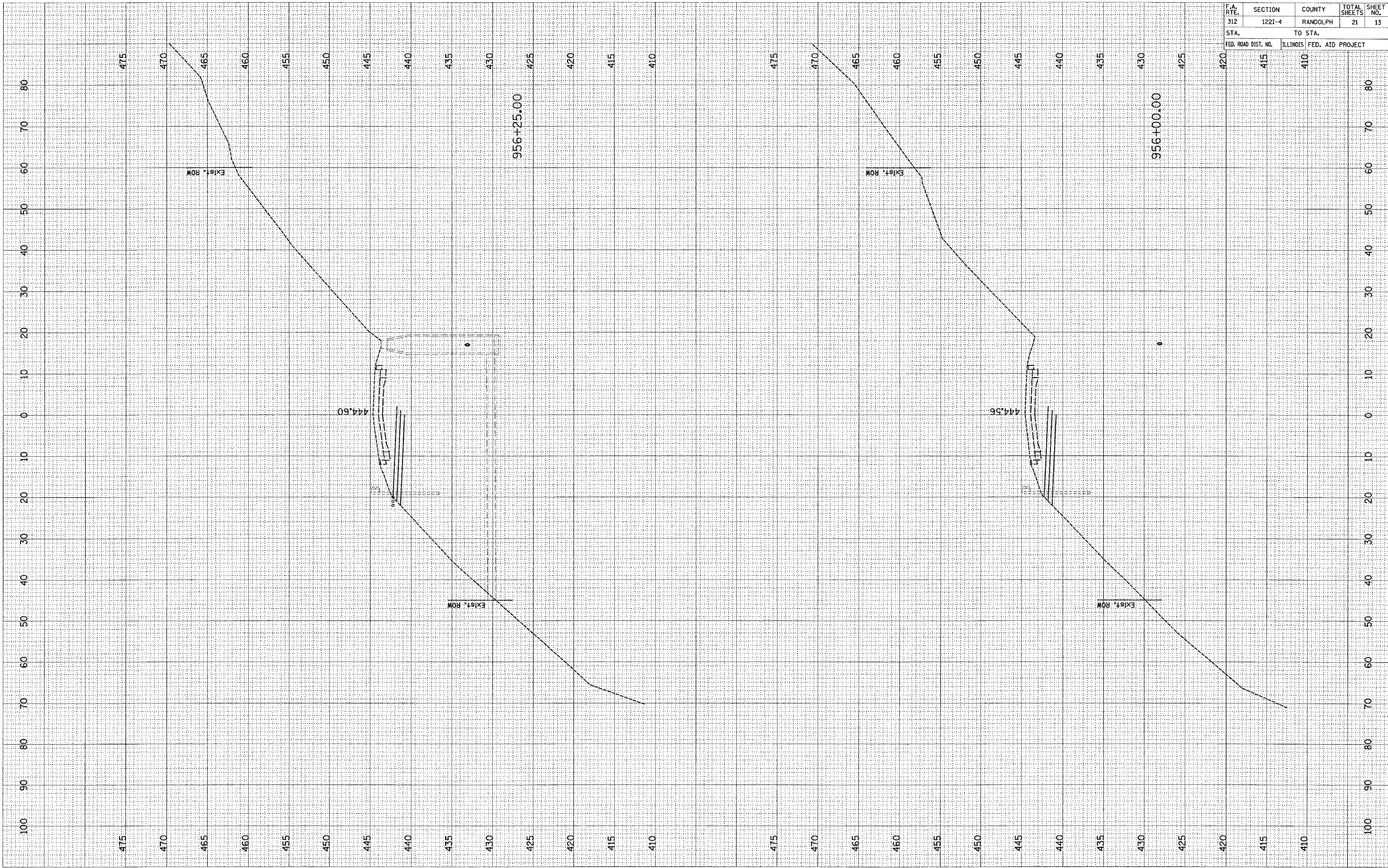

F.A. RTE.	SECTION	COUNTY	TOTAL SHEETS	SHEET NO.
312	1221-4	RANDOLPH	21	13
STA.	TO STA.			
FED. ROAD DIST. NO.	ILLINOIS	FED. AID PROJECT		

FINAL SURVEY	SURVEYED	DATE
NOTE BOOK	TEMPLATE	BY
AREAS	CHECKED	
NO.		

ORIGINAL SURVEY	SURVEYED	DATE
NOTE BOOK	TEMPLATE	BY
AREAS	CHECKED	
NO.		

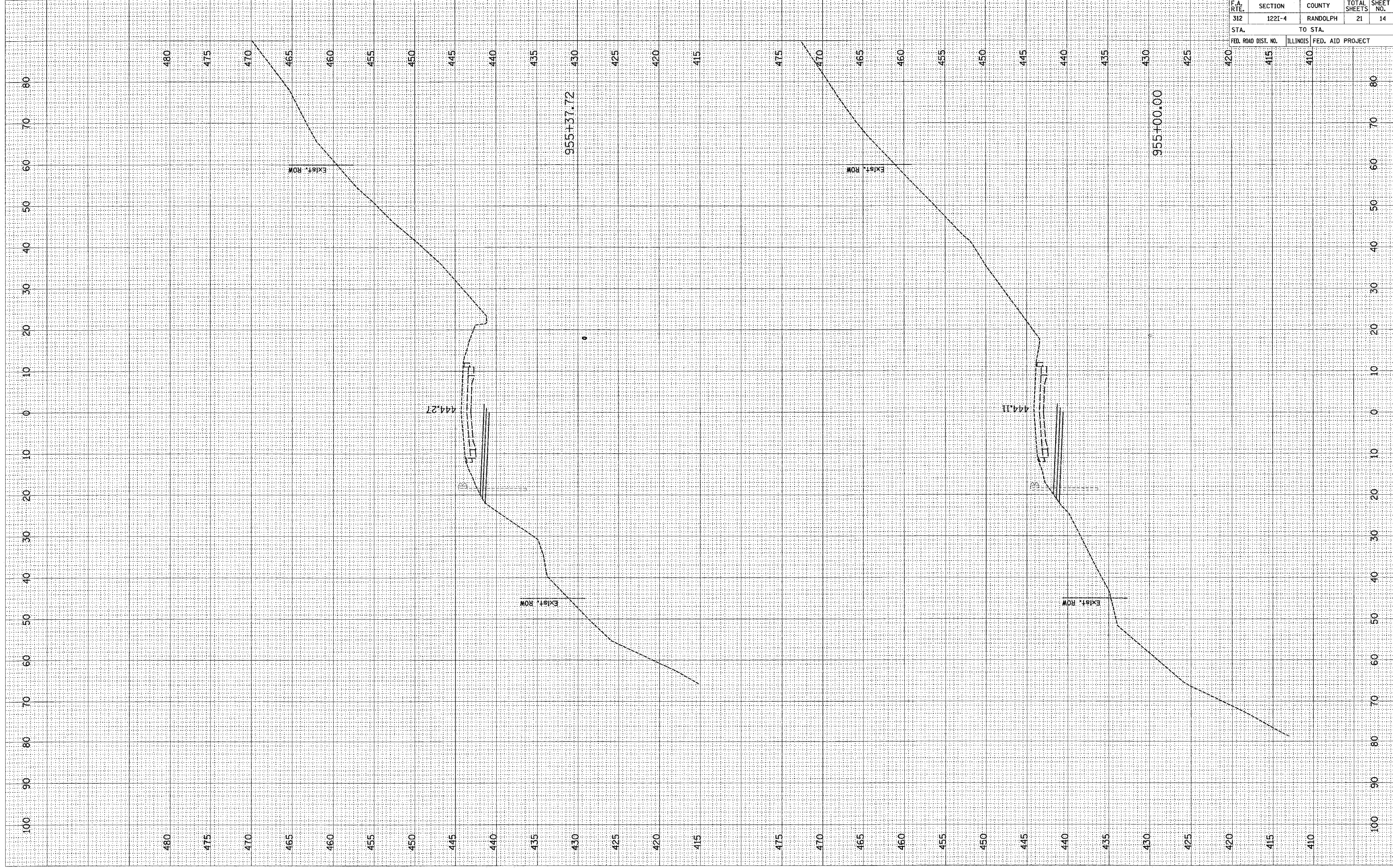

F.A. RTE.	SECTION	COUNTY	TOTAL SHEETS	SHEET NO.
312	1221-4	RANDOLPH	21	14
STA.	TO STA.			
FED. ROAD DIST. NO.	ILLINOIS	FED. AID PROJECT		
415	410			

FINAL SURVEY	SURVEYED	BY	DATE
NOTE BOOK	TEMPERATURE		
NO.	AREAS CHECKED		

ORIGINAL SURVEY	SURVEYED	BY	DATE
NOTE BOOK	TEMPERATURE		
NO.	AREAS CHECKED		

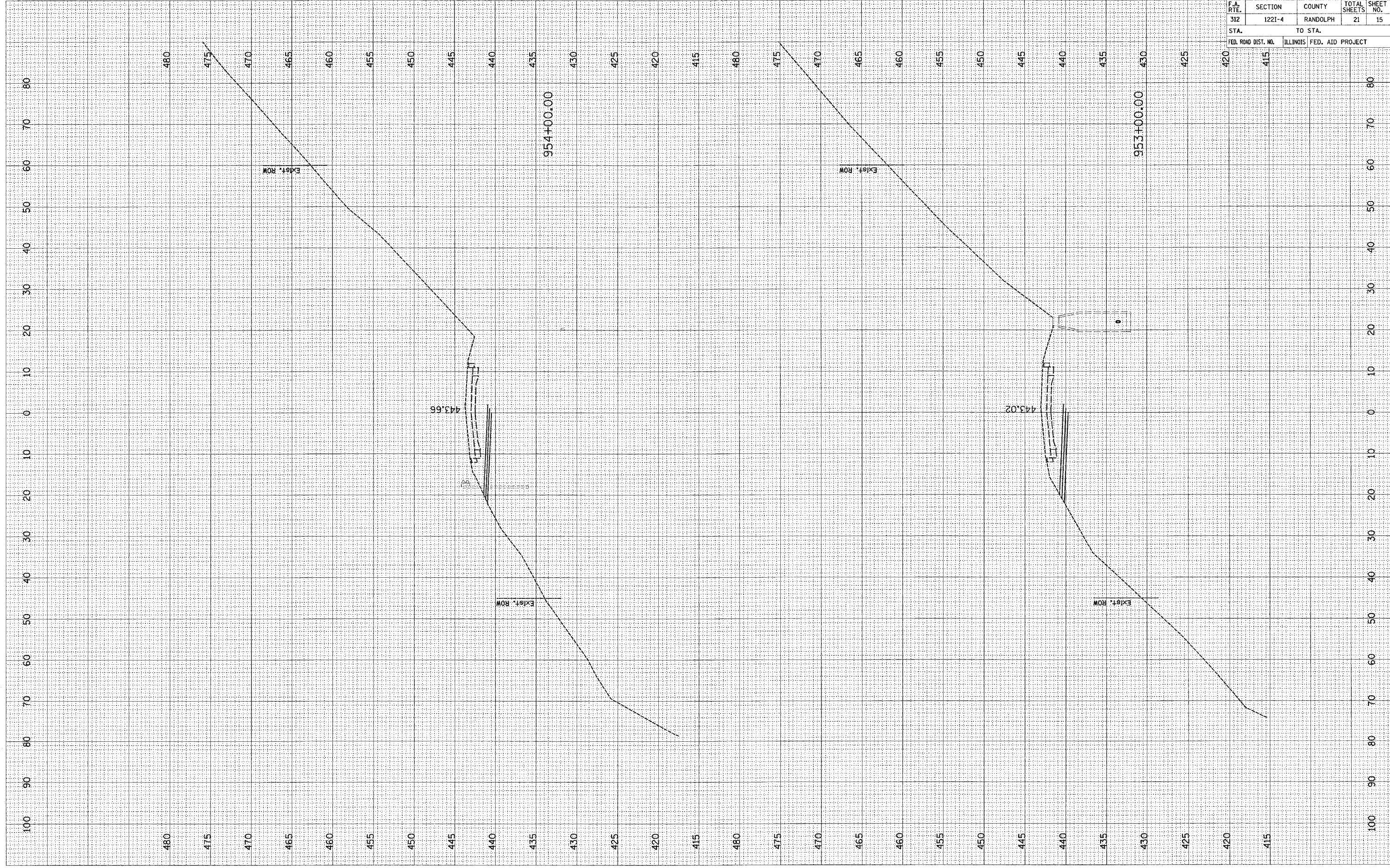

F.A. R.T.E.	SECTION	COUNTY	TOTAL SHEETS	SHEET NO.
312	1221-4	RANDOLPH	21	15
STA.	TO STA.			
FED. ROAD DIST. NO.	ILLINOIS	FED. AID PROJECT		

FINAL SURVEYED SURVEY BY DATE
 NOTE BOOK SURVEYOR'S NAME
 AREAS CHECKED

ORIGINAL SURVEYED SURVEY BY DATE
 NOTE BOOK SURVEYOR'S NAME
 AREAS CHECKED

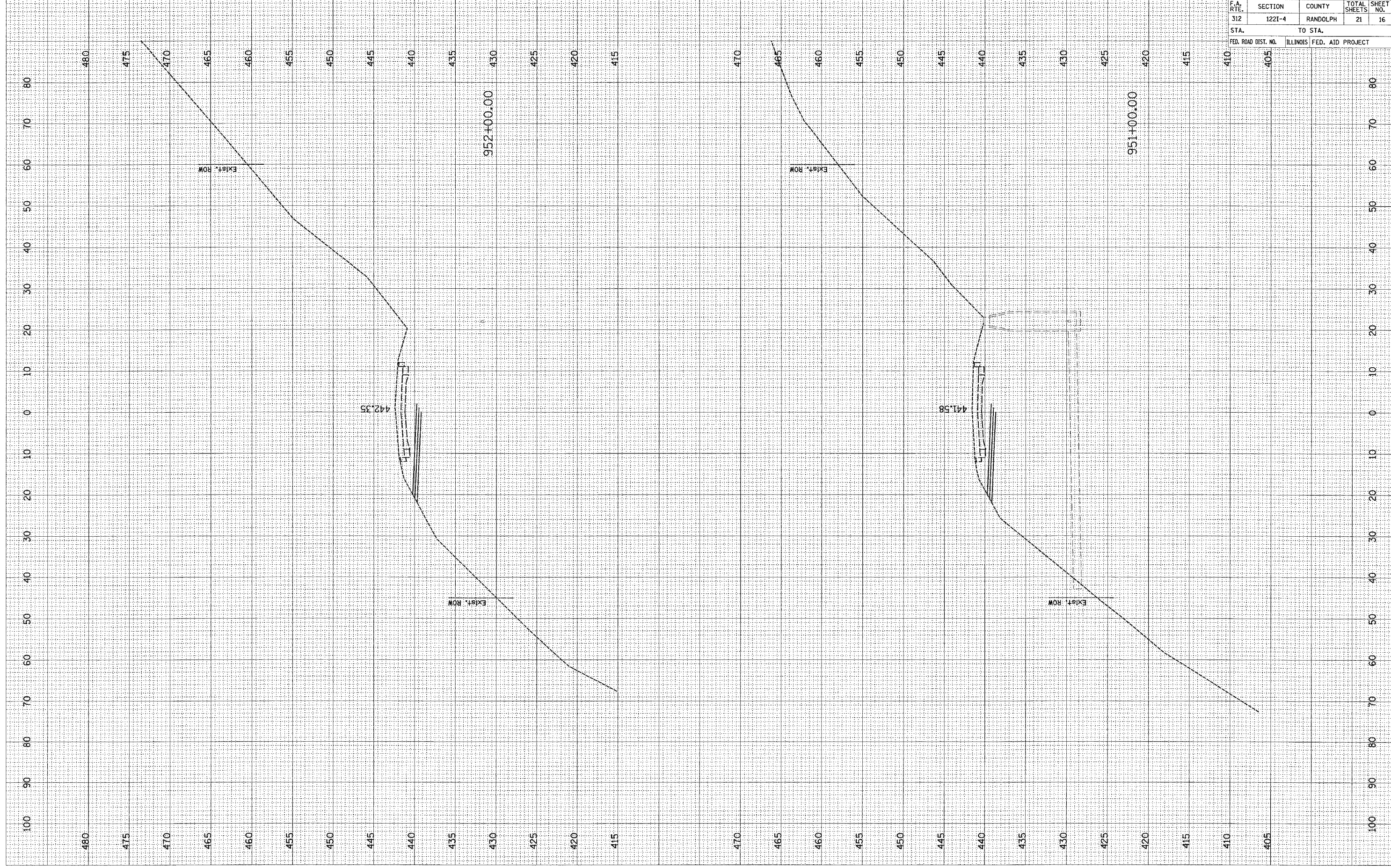

F.A. RTE.	SECTION	COUNTY	TOTAL SHEETS	SHEET NO.
312	1221-4	RANDOLPH	21	16
STA.		TO STA.		
FED. ROAD DIST. NO.		ILLINOIS	FED. AID PROJECT	

FINAL SURVEY
 SURVEYED BY _____ DATE _____
 NOTE BOOK NO. _____
 TEMPLATE AREAS CHECKED _____
 AREAS CHECKED _____

ORIGINAL SURVEY
 SURVEYED BY _____ DATE _____
 NOTE BOOK NO. _____
 TEMPLATE AREAS CHECKED _____
 AREAS CHECKED _____

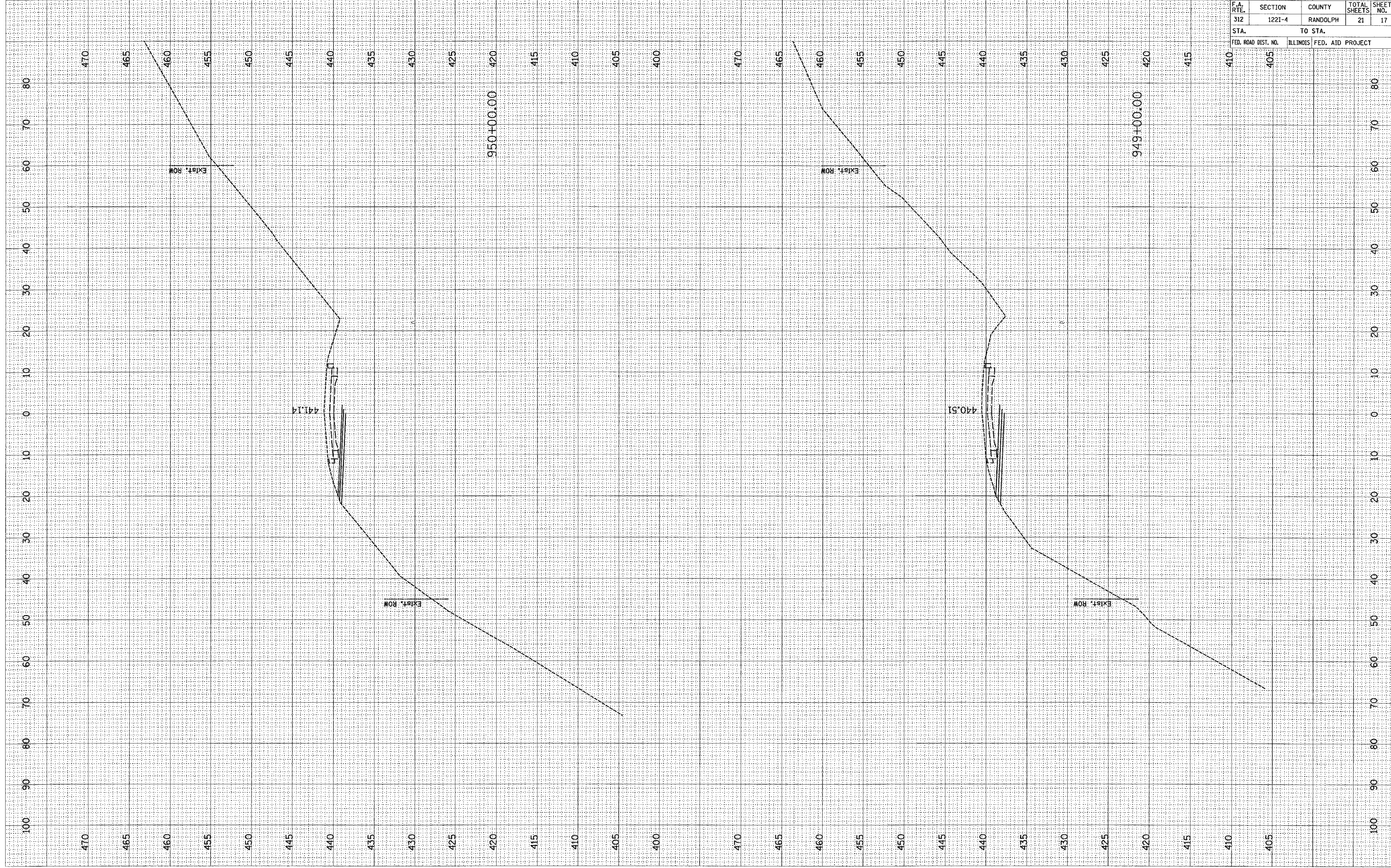

F.A. RT.	SECTION	COUNTY	TOTAL SHEETS	SHEET NO.
312	1221-4	RANDOLPH	21	17
STA. TO STA.		ILLINOIS FED. AID PROJECT		
410	405			

FINAL SURVEY SURVEYED BY DATE
 PLOTTED BY DATE
 NOTE BOOK NO. _____
 AREAS CHECKED _____

ORIGINAL SURVEY SURVEYED BY DATE
 PLOTTED BY DATE
 NOTE BOOK NO. _____
 AREAS CHECKED _____

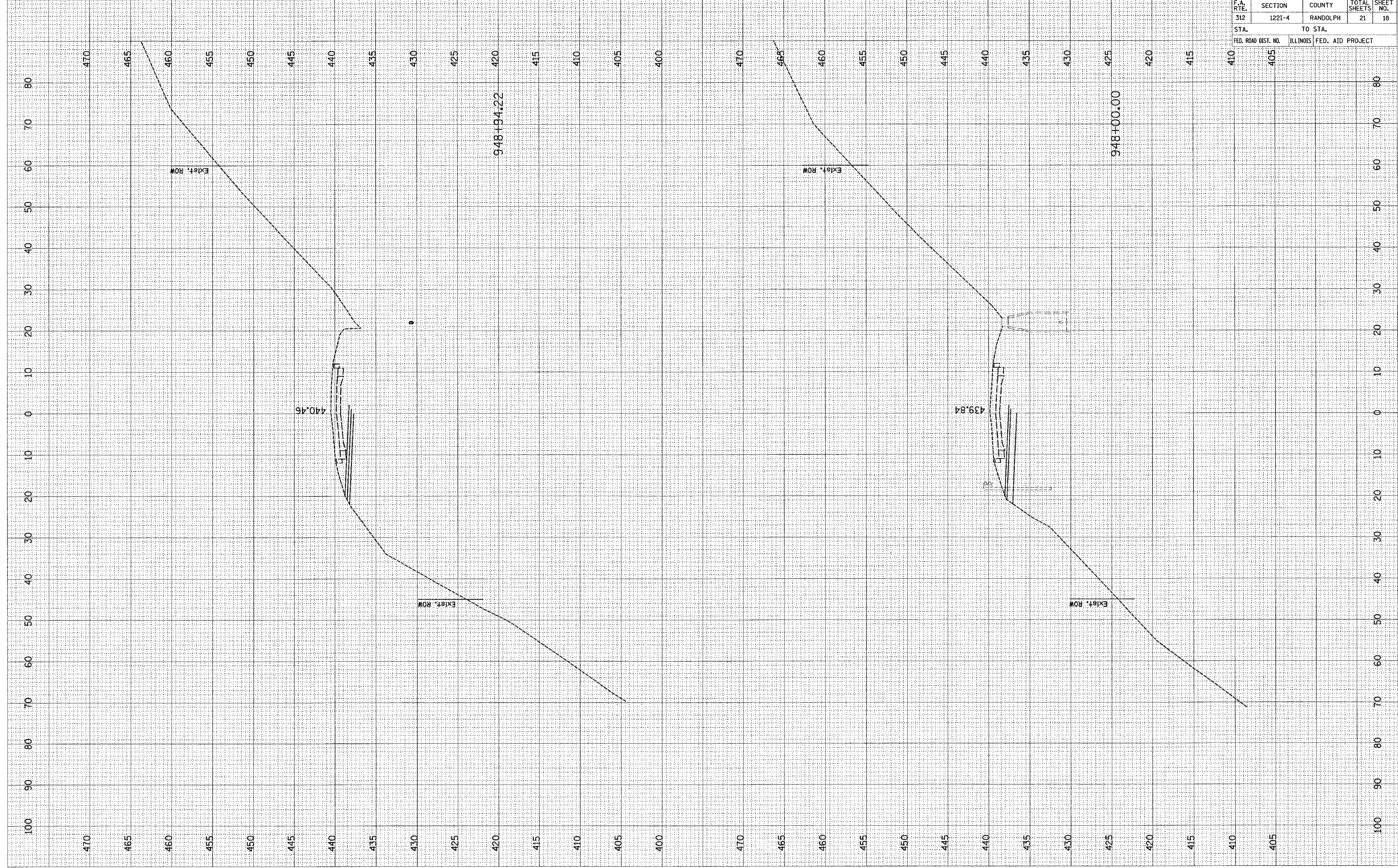

F.A. RTE.	SECTION	COUNTY	TOTAL SHEETS	SHEET NO.
312	1221-4	RANDOLPH	21	18
STA. TO STA.		ILLINOIS FED. AID PROJECT		

FINAL SURVEYED BY DATE
 SURVEY NO. _____
 NOTE BOOK NO. _____
 TEMPLATE NO. _____
 AREAS CHECKED _____
 AREAS CHECKED _____

ORIGINAL SURVEYED BY DATE
 SURVEY NO. _____
 NOTE BOOK NO. _____
 TEMPLATE NO. _____
 AREAS CHECKED _____
 AREAS CHECKED _____

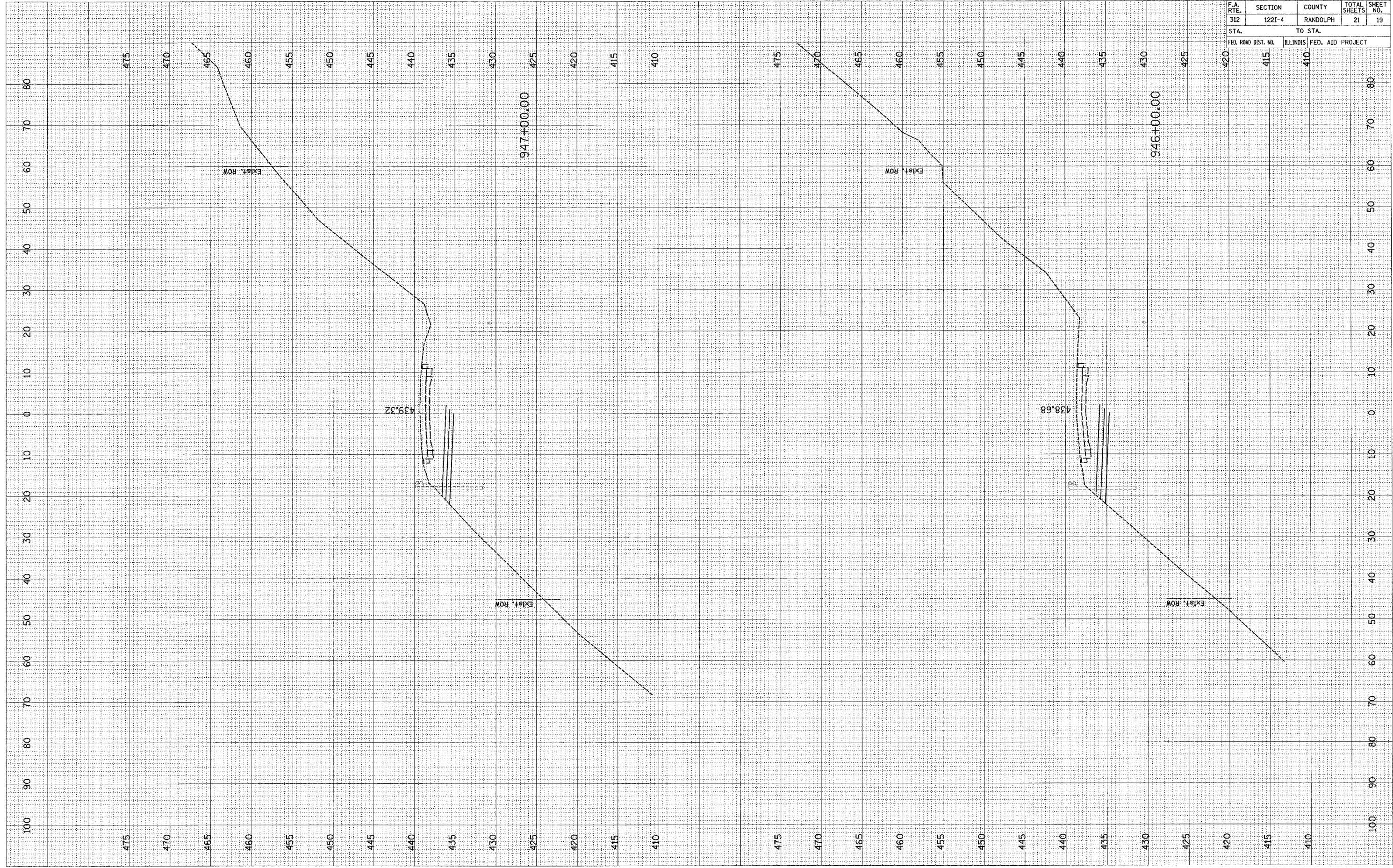

F.A. RTE.	SECTION	COUNTY	TOTAL SHEETS	SHEET NO.
312	122I-4	RANDOLPH	21	19
STA. TO STA.		ILLINOIS FED. AID PROJECT		
420	415	410		

FINAL SURVEY
 SURVEYED BY _____ DATE _____
 NOTE BOOK _____
 TEMPLATE _____
 AREAS _____
 AREAS CHECKED _____

ORIGINAL SURVEY
 SURVEYED BY _____ DATE _____
 NOTE BOOK _____
 TEMPLATE _____
 AREAS _____
 AREAS CHECKED _____

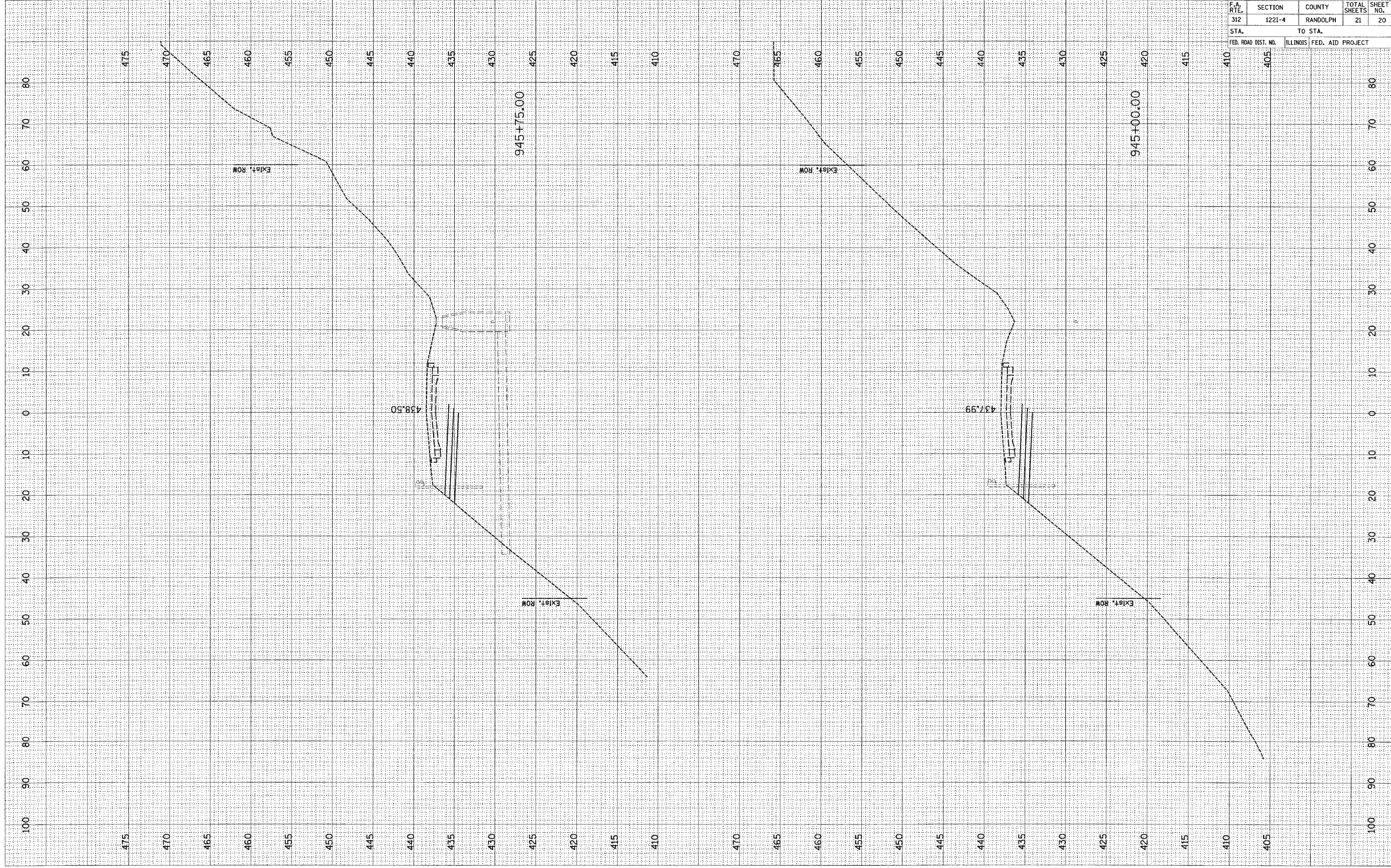

F.A. RT. NO.	SECTION	COUNTY	TOTAL SHEETS	SHEET NO.
312	1221-4	RANDOLPH	21	20
STA.	TO STA.			
FED. ROAD DIST. NO.	ILLINOIS	FED. AID PROJECT		
410	405			

FINAL SURVEYED SURVEY PLOTTED SURVEY NOTE BOOK NO. BY DATE

ORIGINAL SURVEYED SURVEY PLOTTED SURVEY NOTE BOOK NO. BY DATE

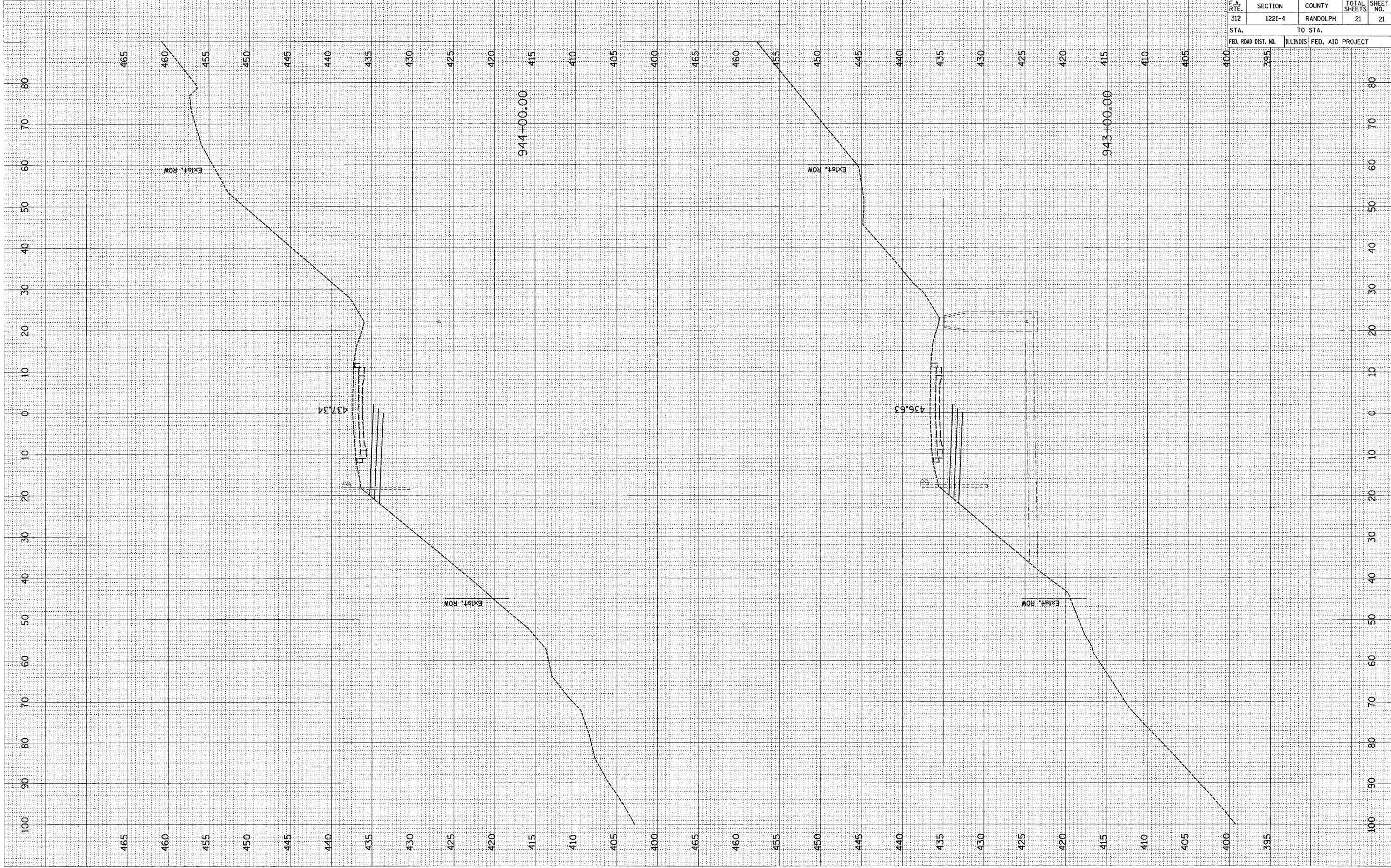

F.A. RTE.	SECTION	COUNTY	TOTAL SHEETS	SHEET NO.
312	1221-4	RANDOLPH	21	21
STA.		TO STA.		
FED. ROAD DIST. NO.		ILLINOIS FED. AID PROJECT		