

F.A.P. RTE.	SECTION	COUNTY	TOTAL SHEETS	SHEET NO.
789	68-BR-1	MADISON	24	7
STA. 93+00.00		TO STA.102+50.00		
FED. ROAD DIST. NO. ILLINOIS FED. AID PROJECT				
CONTRACT NO. 76896				

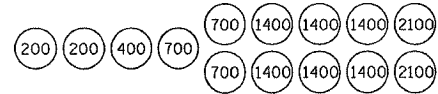

SAND MODULE IMPACT ATTENUATOR LAYOUT (IF OPTION USED)

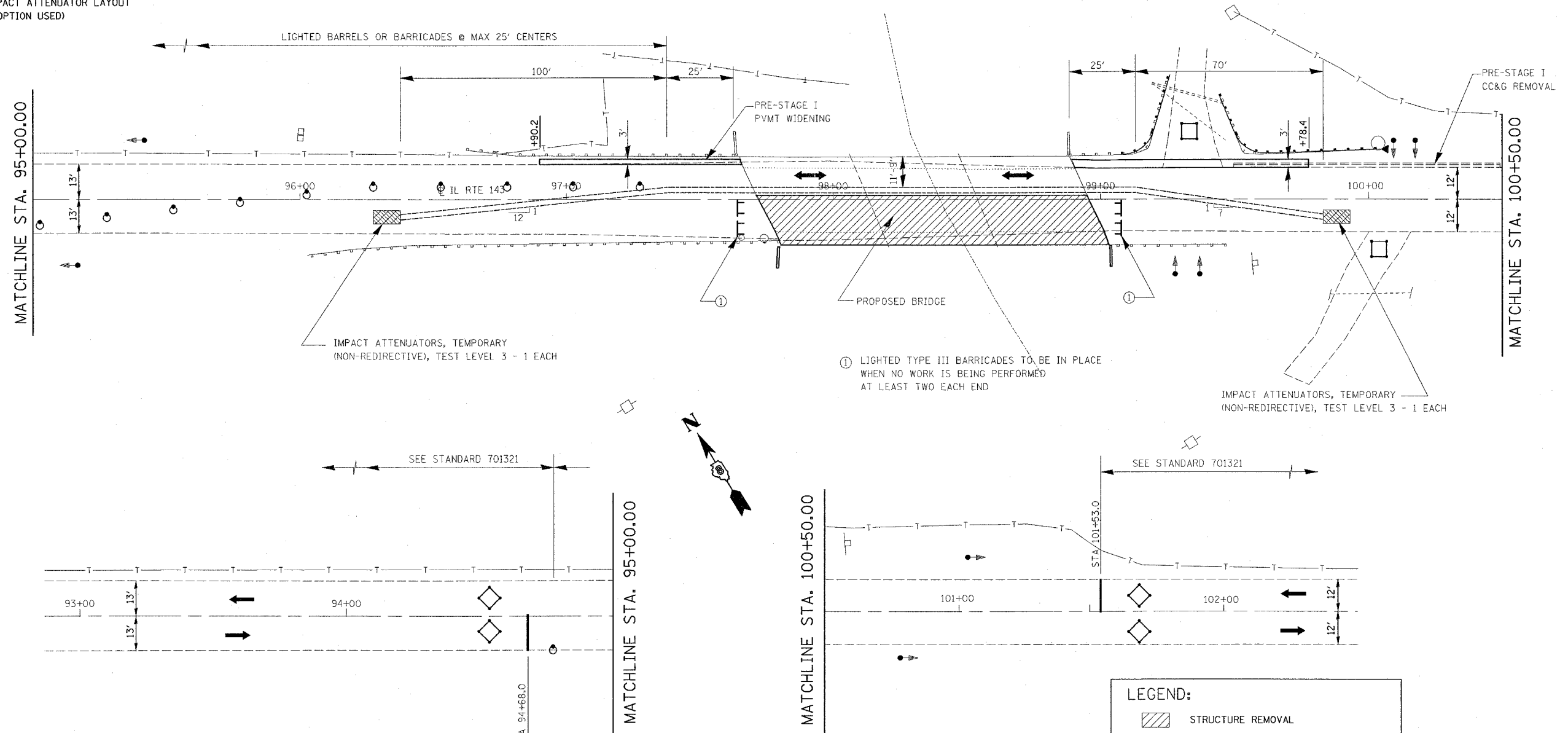

PRE-STAGE I CONSTRUCTION:

- PRE-STAGE I CONSTRUCTION SHALL CONSIST OF THE REMOVAL OF EXISTING CURB AND GUTTER, REMOVAL AND RE-ERECTION OF EXISTING GUARDRAILS, AND CONSTRUCTION OF THE 3' PAVEMENT WIDENING ON THE NORTHEAST AND NORTHWEST CORNERS OF THE STRUCTURE. TRAFFIC CONTROL SHALL BE IN ACCORDANCE WITH TRAFFIC CONTROL AND PROTECTION, STANDARD 701326.

STAGE I CONSTRUCTION:

- STAGE I CONSTRUCTION SHALL CONSIST OF STAGE I REMOVAL OF THE EXISTING SUPERSTRUCTURE, AND STAGE I CONSTRUCTION OF THE REPLACEMENT STRUCTURE. STAGE I CONSTRUCTION SHALL BE DONE ACCORDING TO STAGE CONSTRUCTION AS DETAILED IN THE BRIDGE PLANS. TRAFFIC CONTROL SHALL BE IN ACCORDANCE WITH THE APPLICABLE PORTIONS OF STANDARD 701321 AND AS DETAILED IN THE STAGE CONSTRUCTION PLANS. THIS TRAFFIC CONTROL SHALL BE PAID FOR AS TRAFFIC CONTROL AND PROTECTION 701321 (SPECIAL).

NOTES:

- THE CONTRACTOR SHALL MAINTAIN ACCESS TO PRIVATE AND FIELD ENTRANCES LOCATED WITHIN THE LIMITS OF THE PROJECT.
- TRAFFIC CONTROL & PROTECTION, STANDARD 701321 (SPECIAL) INCLUDES BOTH STAGE I & II AND ANY ADDITIONAL SIGNING OR TRAFFIC CONTROL DEVICES SHOWN ON THE STAGE CONSTRUCTION PLANS.
- THE FINAL BITUMINOUS WEARING SURFACE MUST BE IN PLACE ON THE STRUCTURE PRIOR TO OPENING A LANE TO TRAFFIC.
- REFER TO PLAN AND PROFILE SHEET TO DETERMINE LIMITS OF MILLING AND RESURFACING AREA.
- ALL ADDITIONAL TRAFFIC SIGNAL HEADS, LOOP DETECTORS AND ASSOCIATED EQUIPMENT REQUIRED TO MAINTAIN ACCESS AT THE FIELD AND DRIVEWAY ENTRANCES SHALL BE INCLUDED IN THE COST OF "TEMPORARY BRIDGE TRAFFIC SIGNALS"
- THERE ARE TWO ENTRANCES WITHIN THE LIMITS OF THIS PROJECT. THE PRIVATE ENTRANCE IS LOCATED AT STATION 99+34.00 AND THE FIELD ENTRANCE AT STATION 100+13.45. THE CONTRACTOR SHOULD KEEP THEM OPEN DURING STAGE CONSTRUCTION.

LEGEND:

	STRUCTURE REMOVAL
	TEMPORARY CONCRETE BARRIER
	IMPACT ATTENUATOR
	INDUCTION LOOP DETECTOR
	DRUM WITH STEADY BURNING LIGHT
	SIGNALIZED TWO-WAY TRAFFIC LANE
	TEMPORARY BRIDGE TRAFFIC SIGNAL
	TYPE III BARRICADE

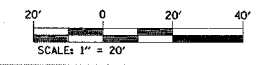

REVISIONS	
NAME	DATE

ILLINOIS DEPARTMENT OF TRANSPORTATION
STAGE I CONSTRUCTION
 FAP ROUTE 789
 SECTION 68-BR-1
 MADISON COUNTY

SCALE: VERT. 1" = 20'
 HORIZ. 1" = 40'

DATE: _____ DRAWN BY: _____
 CHECKED BY: _____

PLOT DATE = 5/15/2006
 FILE NAME = c:\p\proj\va\68br1\plan\br1stg1a.dgn
 PLOT SCALE = 20/8000 / IN.
 REFERENCE = 41814