

STATE OF ILLINOIS  
DEPARTMENT OF TRANSPORTATION

ROUTE NO.	SECTION	COUNTY	TOTAL SHEETS	SHEET NO.
F.A.P. 789	68-BR-1	MADISON	11	11
FED. ROAD DIST. NO. 7	ILLINOIS	FED. AID PROJECT-		

Contract #76896

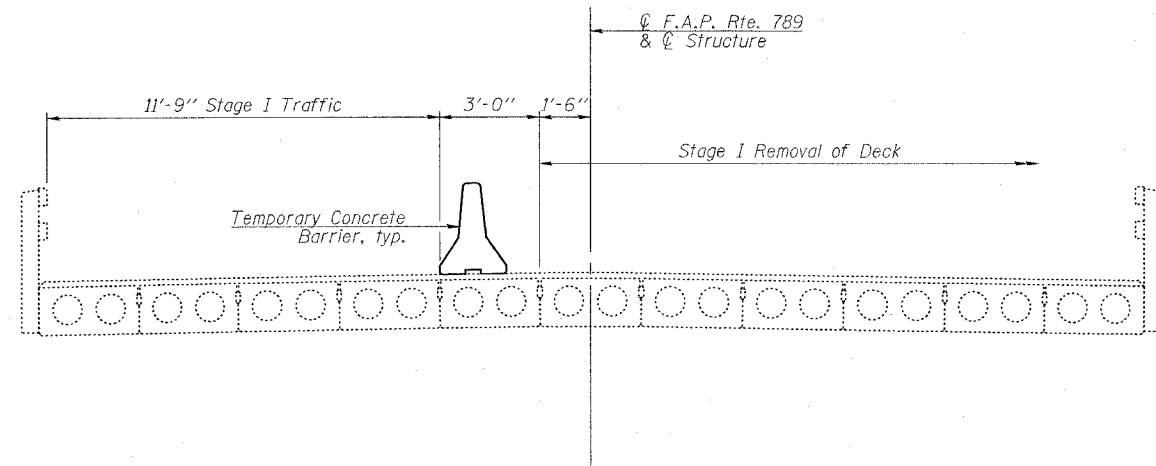

**STAGE I REMOVAL**

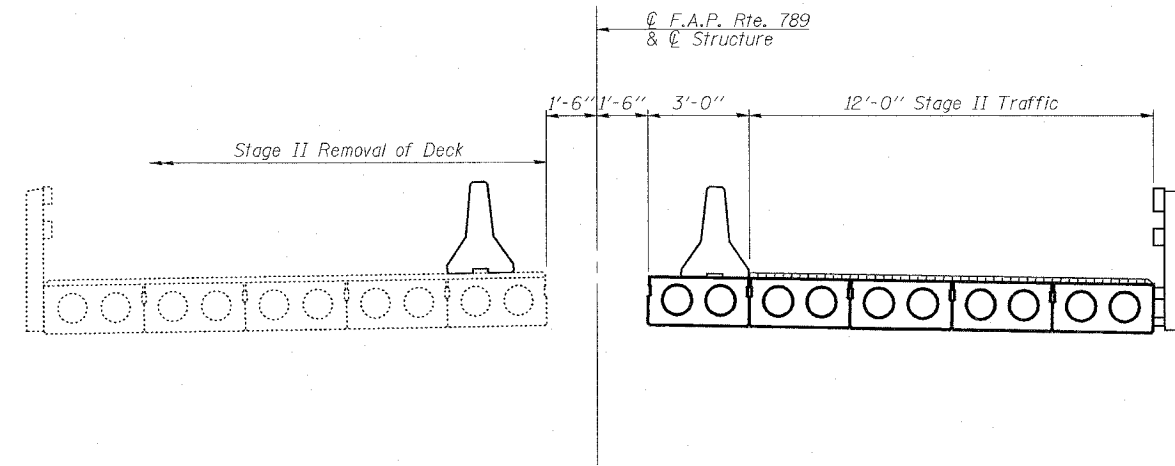

**STAGE II REMOVAL**

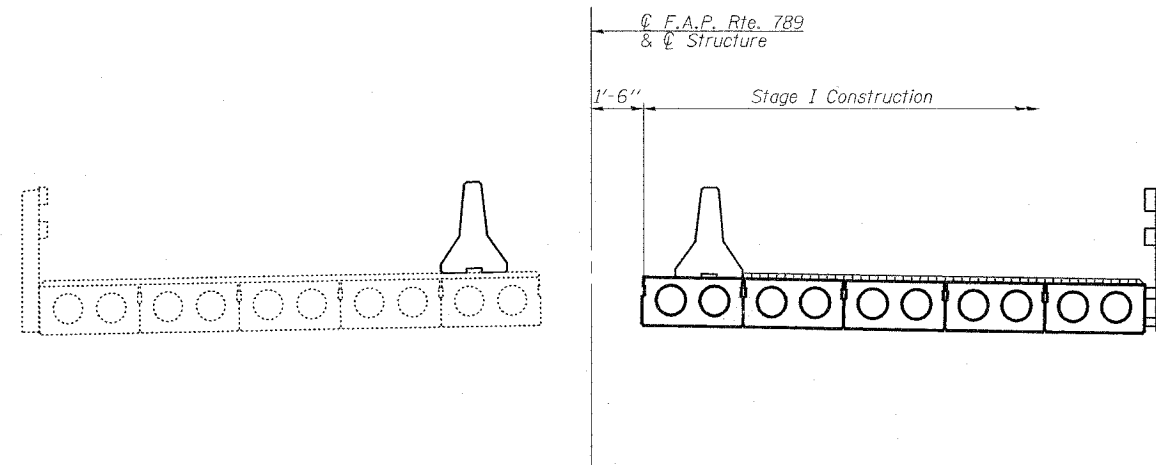

**STAGE I CONSTRUCTION**

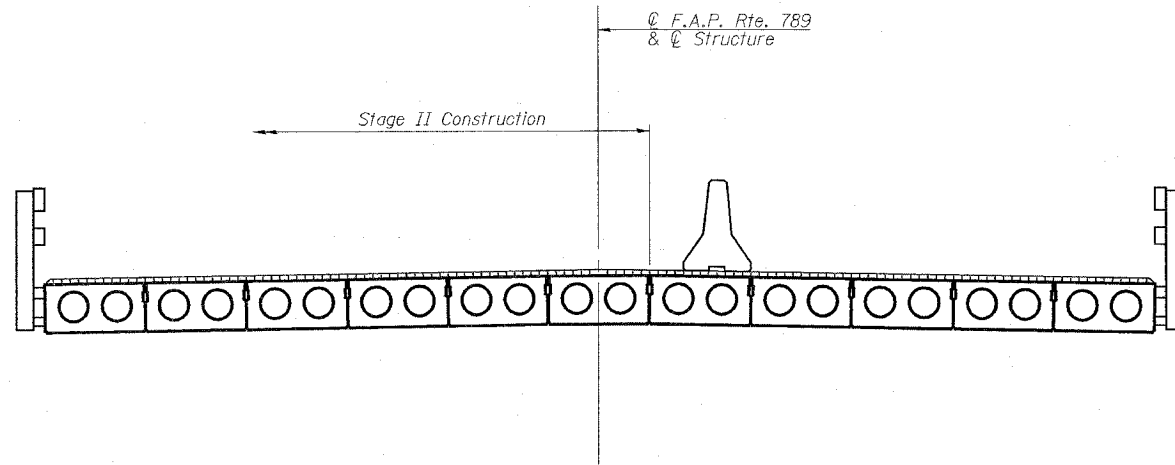

**STAGE II CONSTRUCTION**

**GENERAL NOTES CONT.**

If the contractor's procedure for existing beam removal or placement of new beams involves placement of cranes or other heavy equipment on new beams, a detailed procedure shall be submitted to the Engineer for approval. The procedure shall include calculations, prepared and sealed by an Illinois Licensed Structural Engineer, verifying that the equipment and procedure used will not overstress the new beams. To distribute load to multiple beams and protect the concrete, in all cases a double layer mat of heavy timbers shall be used at all times under crane tracks or wheels and any outriggers in the down position. If necessary, shims shall be used under the crane mat to ensure uniform contact with the underlying beams. Prior to placement of the timber mats the following shall be done: placement and tightening of transverse tie assemblies, grouting and curing the dowel rods 24 hours minimum and grouting and curing the shear keys. A temporary means of lateral restraint will be required for fascia beams at expansion ends of beams to prevent movement of the beams.

Repair of the abutments and piers shall be completed prior to placement of the new deck beams.

Notes:  
All sections are looking East.  
For quantity of Temporary Concrete Barrier, see roadway plans.  
For details of Temporary Concrete Barrier, see sheet 3 of 12.

DESIGNED	EML
CHECKED	NJM
DRAWN	EML
CHECKED	NJM

**HORNER & SHIFRIN, INC.**  
ENGINEERS ■ ARCHITECTS ■ PLANNERS

**STAGE CONSTRUCTION DETAILS**  
**F.A.P. ROUTE 789 - SECTION 68-BR-1**  
**MADISON COUNTY**  
**STATION 98+33.25**  
**STRUCTURE NO. 060-0150**