

STATE OF ILLINOIS
DEPARTMENT OF TRANSPORTATION

ROUTE NO.	SECTION	COUNTY	TOTAL SHEETS	SHEET NO.
-	-	-	03	3A
FED. ROAD DIST. NO. 7	ILLINOIS	FED. AID PROJECT		

SHEET NO. 3A
39 SHEETS

Contract #76899

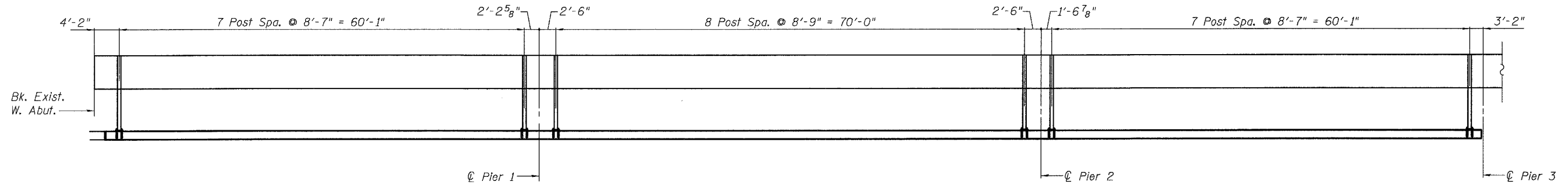

RAIL POST SPACING SPANS 1-3

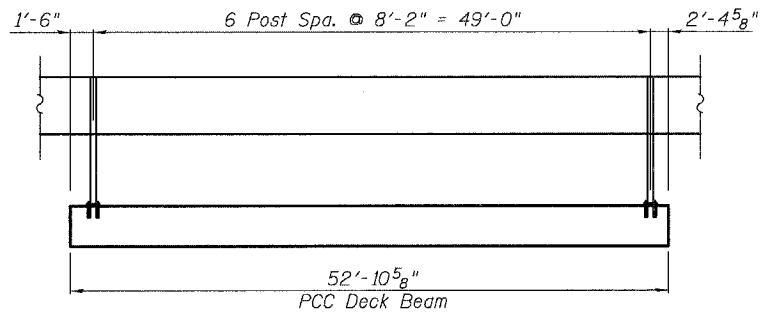

RAIL POST SPACING SPANS 4-14

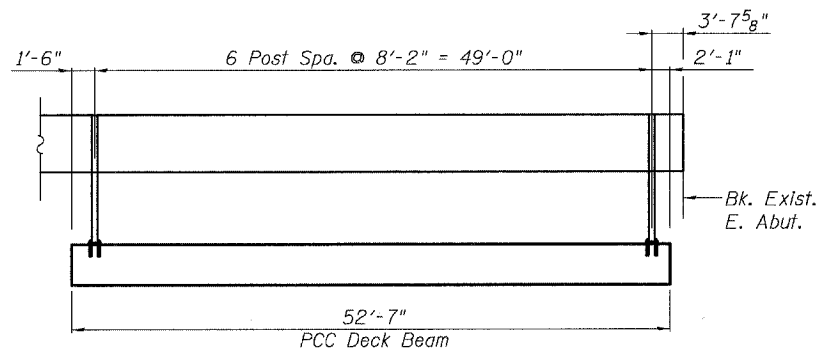

RAIL POST SPACING SPAN 15

- Notes:
- See sheet 9 of 39 for Temporary Bridge Rail details.
 - Spans 4-15 shall have the threaded inserts precast into the PPC Deck Beams.

TEMPORARY BRIDGE RAIL POST SPACING
OLD U.S. ROUTE 50 OVER
SHOAL CREEK
F.A.S. ROUTE 1780 - SECTION 24-BR-
CLINTON COUNTY
STA. 102+51.47
STRUCTURE NO. 014-0062

PLOT DATE = 05/15/2006
FILE NAME = h:\p\25004\technical\production\structural\sn 014-0062\final.plans\0052-10-tempbrldgerailsh15t.dgn
PLOT SCALE = 0:1.0000 : 1' / IN.
USER NAME = USER\$