

ROUTE	SECTION	COUNTY	TOTAL SHEETS	SHEET NO.
•	**	***	52	32
STA.		TO STA.		
FED. ROAD DIST. NO.	ILLINOIS	FED. AID PROJECT		
•	FAI 55/70	CONTRACT# 76973		
**	DIST 8 ITS 2006-2			
***	MADISON & ST. CLAIR & CITY OF ST. LOUIS, MO			

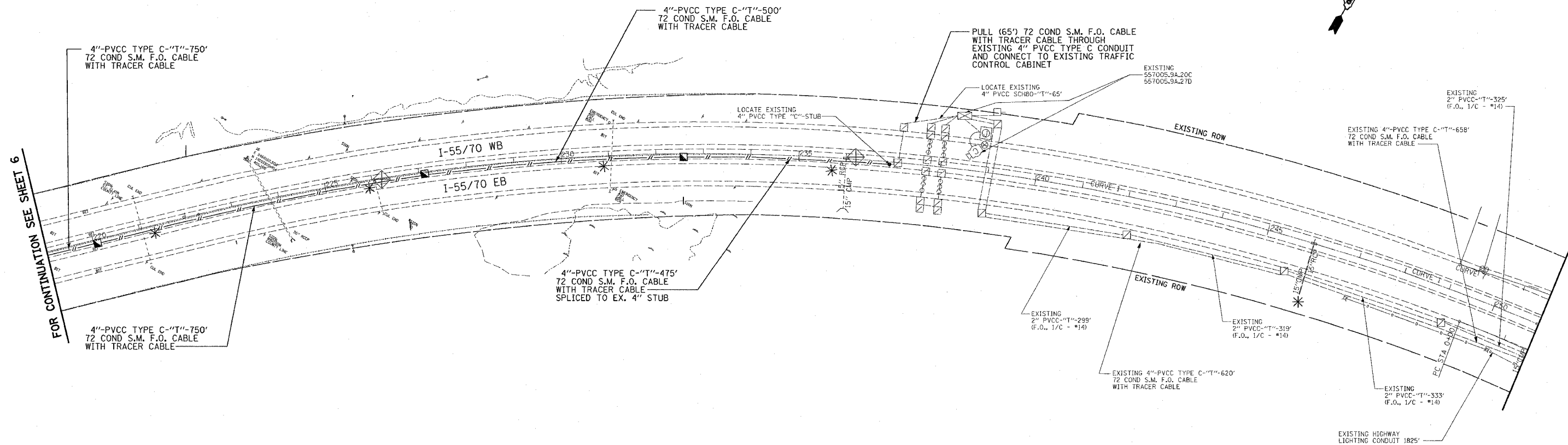

FOR CONTINUATION SEE SHEET 6

\* LOCATE CULVERT / DRAINS  
VERIFY DEPTH, TRENCH OVER  
OR TRENCH AROUND PER FIELD  
ENGINEER'S RECOMMENDATION.

SHEET 17 OF 18

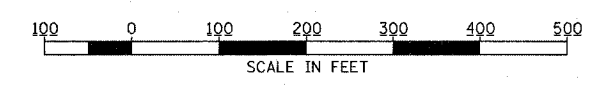

REVISIONS	
NAME	DATE

ILLINOIS DEPARTMENT OF TRANSPORTATION  
LOCATION 557005.9A.20C(EX.)  
LOCATION 557005.9A.27D(EX.)  
FAI 55/70  
SECTION DIST 8 ITS 2006-2  
MADISON AND ST. CLAIR COUNTY  
AND ST. LOUIS, MO  
DATE 5/23/2006

PLOT DATE = 5/23/2006  
FILE NAME = c:\pvc\projects\edl\557005\electrical\stap\1151606.dgn  
PLOT SCALE = 1/8\"/>