

F.A. R.T.E.	SECTION	COUNTY	TOTAL SHEETS	SHEET NO.
	05-00194-00-RP	COOK	58	28
STA.		TO STA.		
FED. ROAD DIST. NO.		ILLINOIS	FED. AID PROJECT	

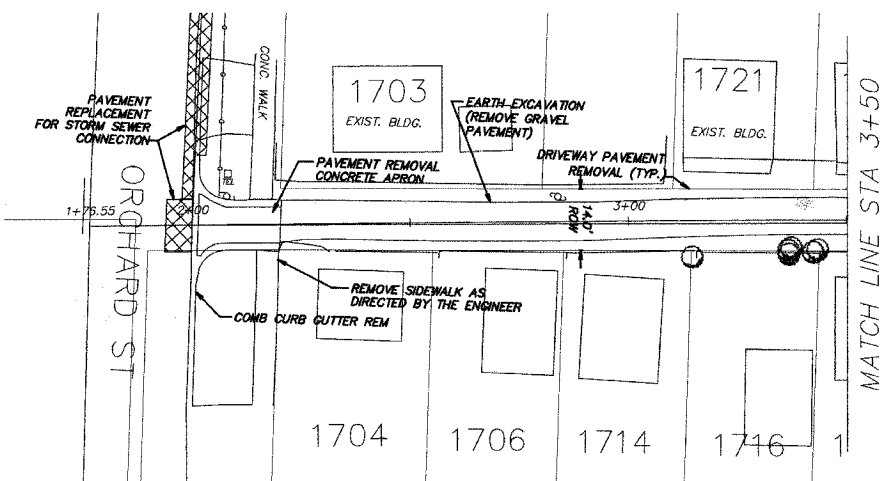

EXISTING

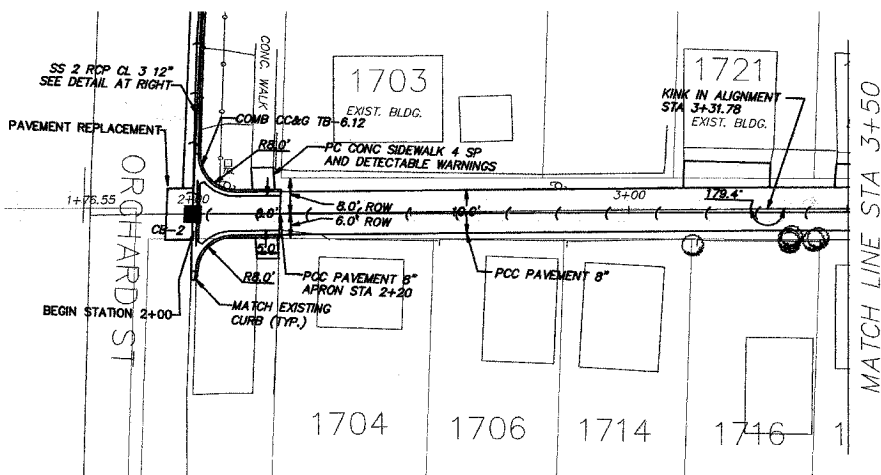

PROPOSED

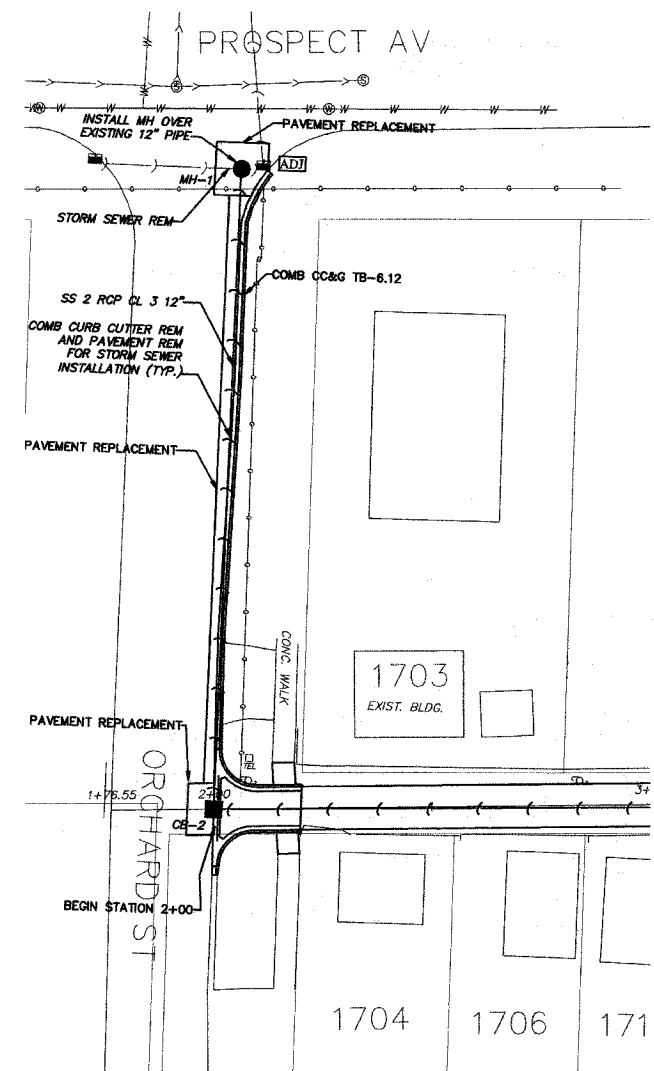

STORM SEWER DETAIL

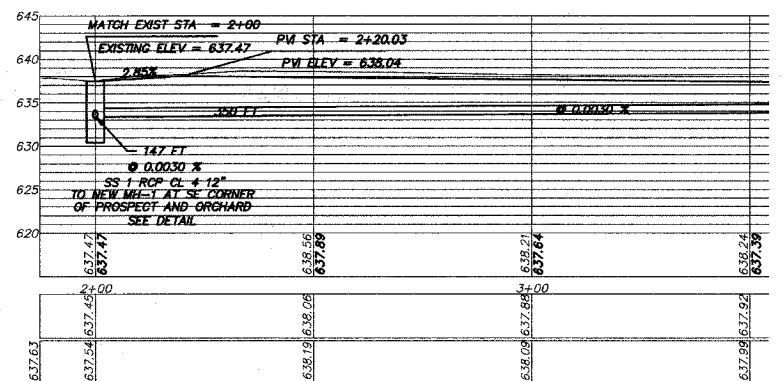

PROPOSED STRUCTURE DATA:
 MH-1 MH TY A 4 FT DIA
 ROUND FRAME CLOSED LID
 STA-2+08 147'-L
 (SE CORNER PROSPECT/ORCHARD)
 RIM-636.80
 INV.-632.81 (S)
 INV.-632.60 (E-W)
 INSTALL NEW MH OVER EXISTING PIPE

CB-2 CB TY A 4 FT DIA
 ROUND FRAME AND OPEN LID
 STA-2+00
 RIM-637.47
 INV.-633.35 (E)
 INV.-633.25 (N)

REVISIONS	
NAME	DATE

ILLINOIS DEPARTMENT OF TRANSPORTATION
 CITY OF DES PLAINES - ALLEY IMPROVEMENTS
 PROSPECT - STOCKTON ALLEY
 ORCHARD TO MAPLE

PLAN AND PROFILE

STA 2+00 TO 3+50

SCALE: VERT. 1" = 5'
 HORIZ. 1" = 20'

DATE 2-17-06 DRAWN BY BLS
 CHECKED BY AJD

PLOT DATE: 2/15/2006 9:06:17 PM
 FILE NAME: W:\ENGINEERING\LAND PROJECTS 2006\05030305-104 ALLEY.DWG\050305-104 ALLEY.DWG
 PLOT SCALE: 1" = 20'
 USER NAME: JDOODLES