

F.A.S. RTE.	SECTION	COUNTY	TOTAL SHEETS	SHEET NO.
1373	00-00058-00-RS	COOK	113	20
STA.		TO STA.		
FED. ROAD DIST. NO.		ILLINOIS FED. AID PROJECT		
CONTRACT No: 83861				

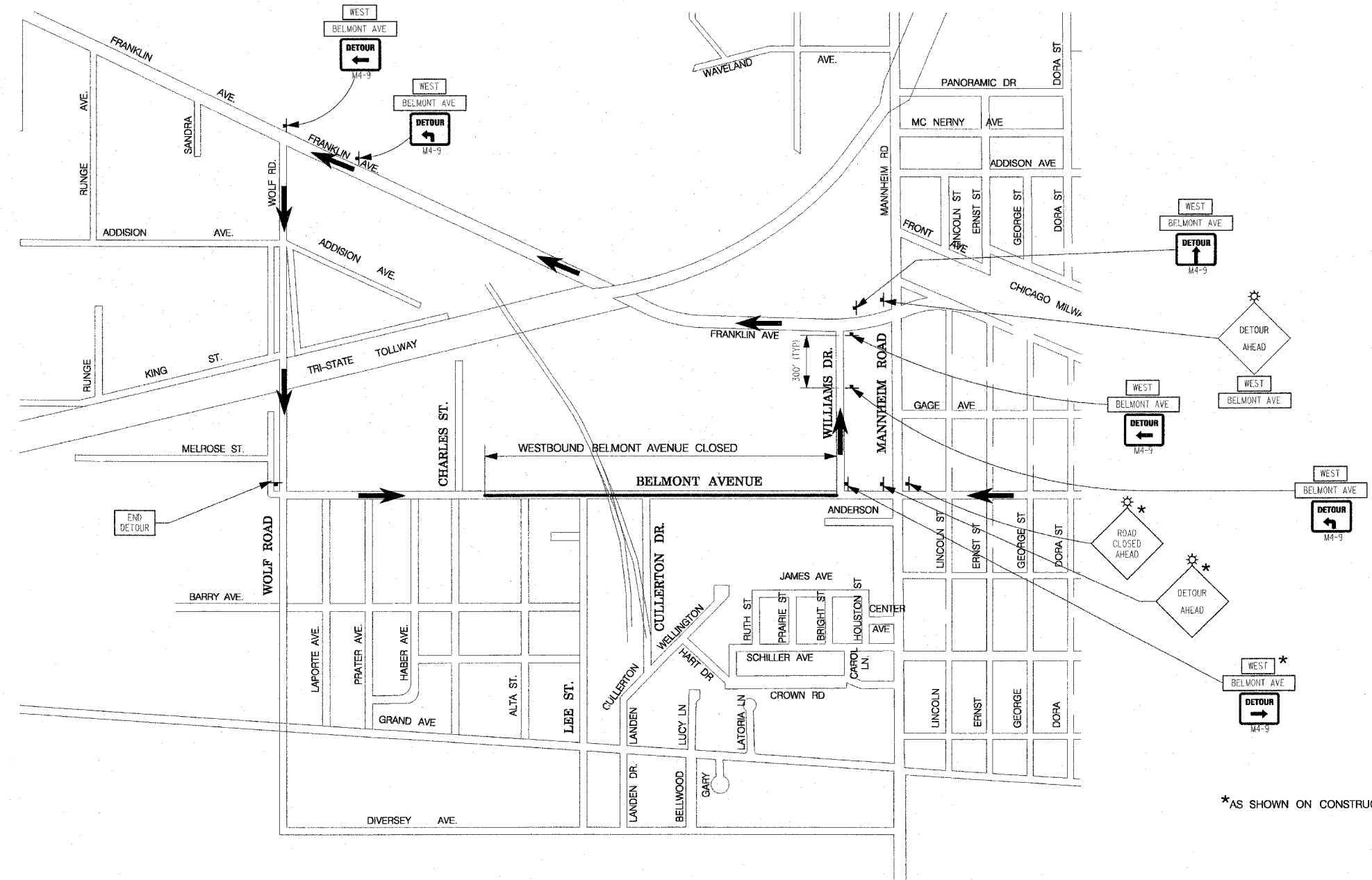
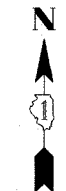

\*AS SHOWN ON CONSTRUCTION STAGING PLANS.

NOTE:  
 DETOUR ROUTE TO BE IN EFFECT FOR THE DURATION OF STAGE I B THROUGH STAGE III.  
 NORMAL TRAFFIC PATTERNS TO BE RESUMED UPON COMPLETION OF PERMANANT PAVEMENT MARKING.  
 DETOUR ROUTE SHALL NOT REMAIN IN OPERATION DURING WINTER MONTHS.

REVISIONS	
NAME	DATE

ILLINOIS DEPARTMENT OF TRANSPORTATION

**DETOUR PLAN**

SCALE: VERT.    DRAWN BY MJK  
 HORIZ.        CHECKED BY BOC  
 DATE 4/6/06

c:\f14300\plans\sheets\F14300mtp101.dgn  
 5/24/2006  
 5:20:34 PM