

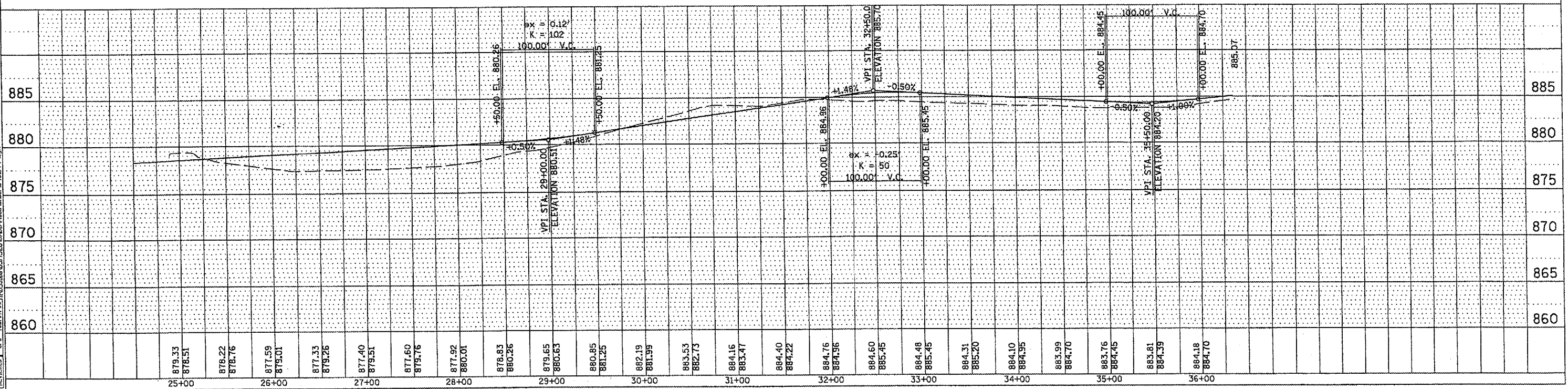

Hanson Professional Services Inc.
 Copyright Hanson Professional Services Inc. 2006

LAYOUT: MRR 12/20/05 (mwh)
 DRAWN: MRR 05/03/06 05:47:00 05/06 06:29 PM
 REVISION: CPS 05/17/06 14:05:00 05/16/06 05:12:26 CAD/Drawn/Sheet/02-PP-007

F.A. RTE.	SECTION	COUNTY	TOTAL SHEETS	SHEET NO.
	05-00001-01-PV	DEKALB	38	6
STA. 24+51.83		TO STA. 36+39.33		
C#87319 ILLINOIS FED. AID PROJECT				

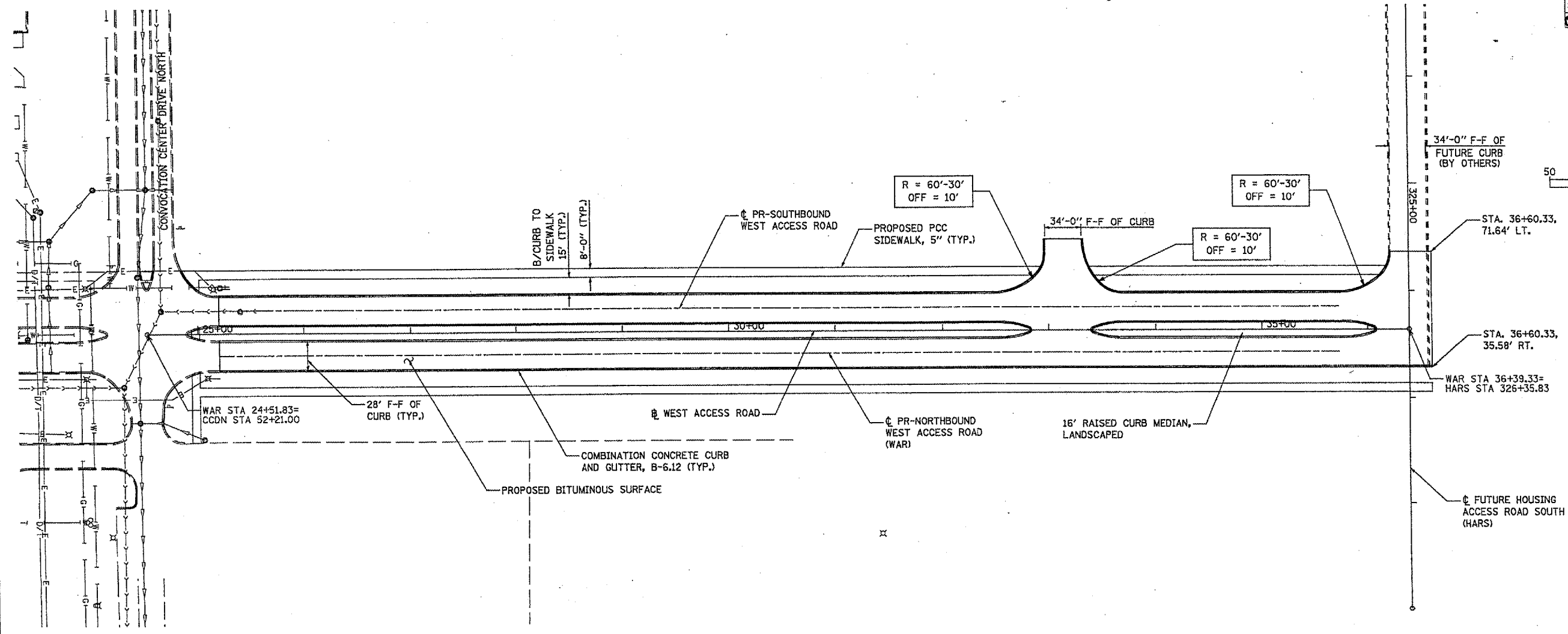
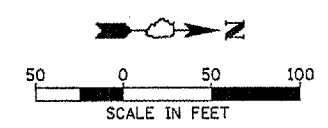

WEST ACCESS ROAD