

F.A. RTE.	SECTION	COUNTY	TOTAL SHEETS	SHEET NO.
	05-00001-01-PV	DEKALB	38	17
STA.	TO STA.			
C# 87319	ILLINOIS		FED. AID PROJECT	

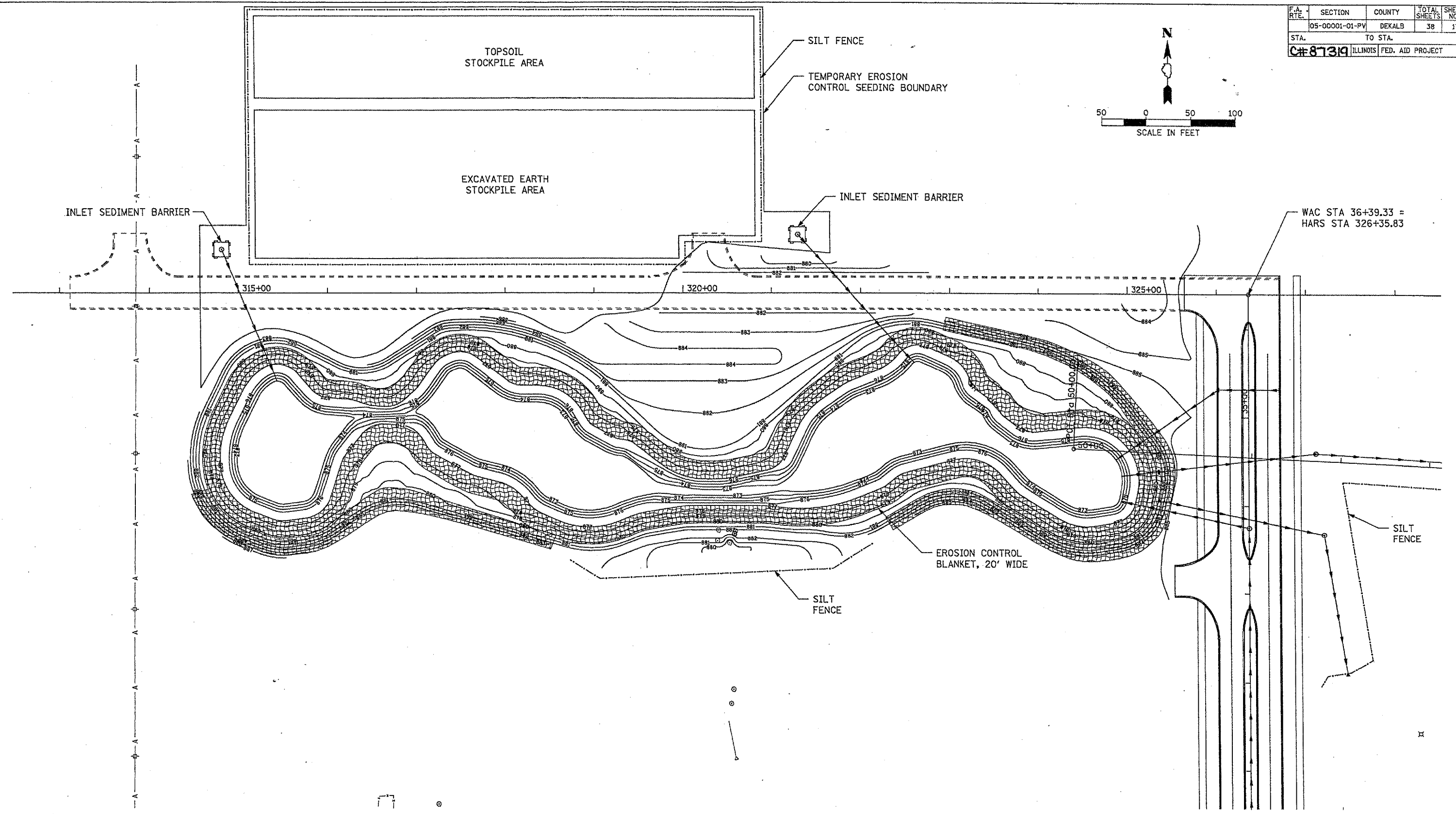
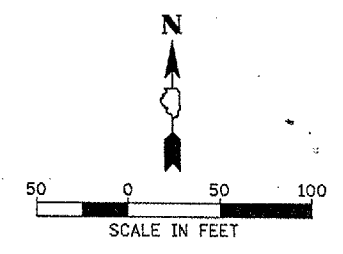

LAYOUT: MWH 02/24/06  
 DRAWN: MWH 05/03/06  
 REVIEWED: CPS 05/17/06  
 Hanson Professional Services Inc.  
 Copyright Hanson Professional Services Inc. 2006

LEGEND:

	SILT FENCE
	EROSION CONTROL BLANKET
	INLET SEDIMENT BARRIER

REVISIONS	
NAME	DATE

ILLINOIS DEPARTMENT OF TRANSPORTATION  
 SECTION 05-00001-01-PV  
 DEKALB COUNTY  
 NORTHERN ILLINOIS UNIVERSITY WEST ACCESS ROAD

**TEMPORARY EROSION CONTROL PLAN**

SCALE: AS SHOWN  
 DATE: 05/18/06

DRAWN BY: MWH  
 CHECKED BY: CRC