

F.A.U. ROUTE	CONTRACT NO.	COUNTY	TOTAL SHEET
534B	07330	DEKALB	140
STATE SECTION	05-00180-00-WR		59
TEMPORARY TRAFFIC SIGNALS			
F.H.W.A. REG.5 ILLINOIS PROJECT #HPP-2295(001)			

**TEMPORARY CONTROLLER SEQUENCE**

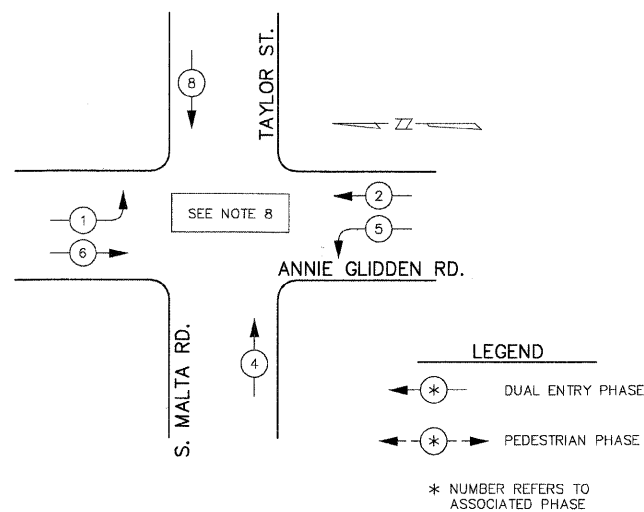

**TEMPORARY TRAFFIC SIGNAL PHASE DESIGNATION DIAGRAM**

**TEMPORARY TRAFFIC SIGNAL EMERGENCY VEHICLE PREEMPTION SEQUENCE**

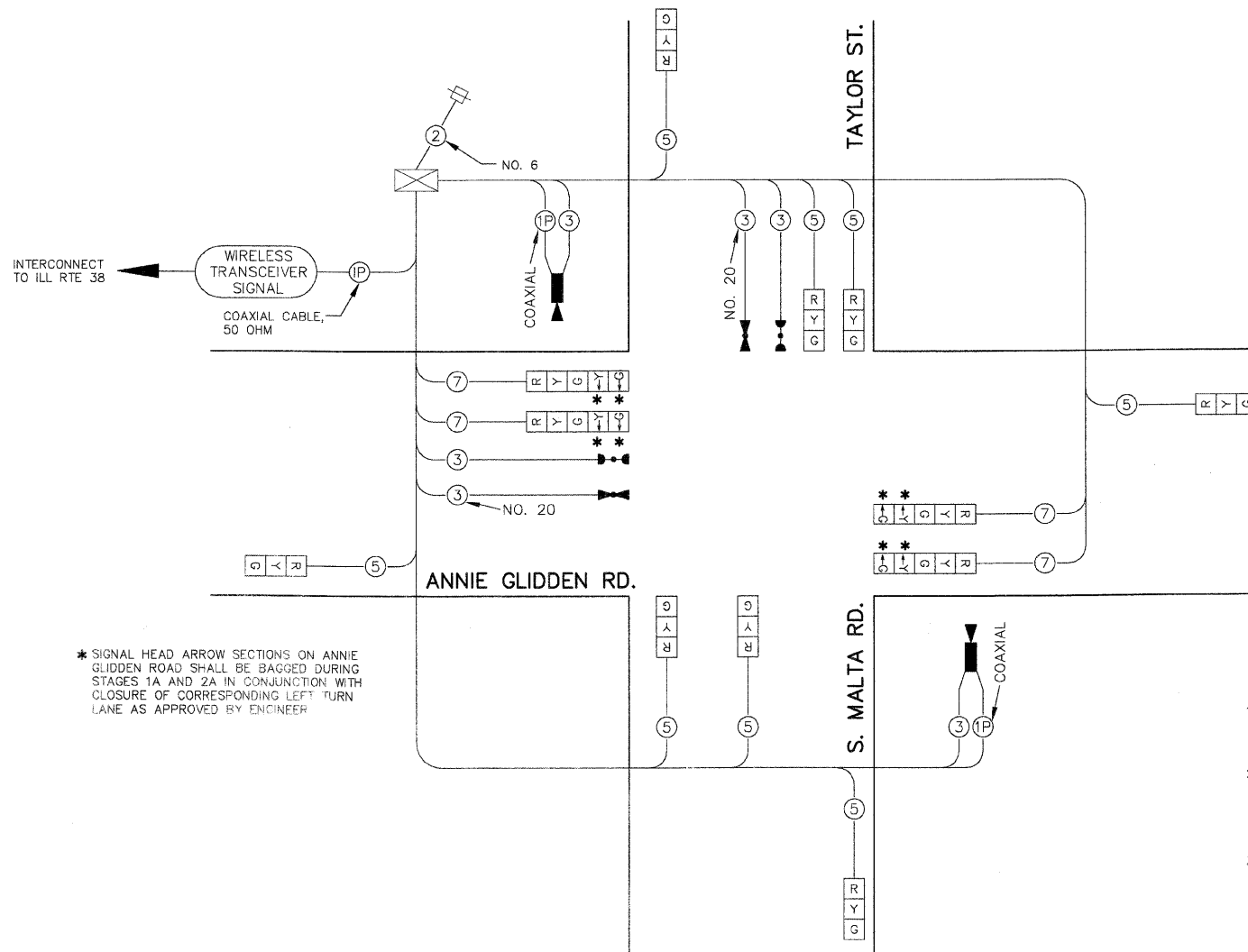
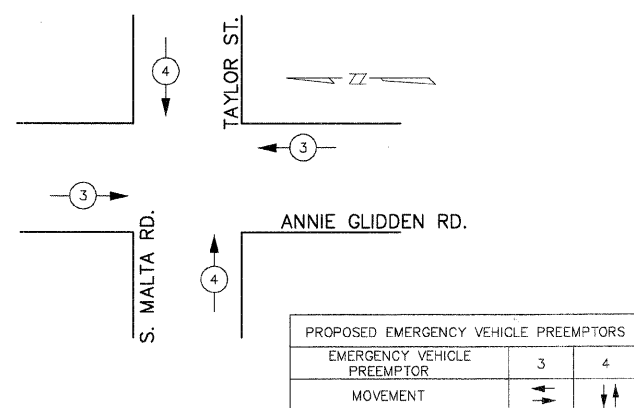

\* SIGNAL HEAD ARROW SECTIONS ON ANNIE GLIDDEN ROAD SHALL BE BAGGED DURING STAGES 1A AND 2A IN CONJUNCTION WITH CLOSURE OF CORRESPONDING LEFT TURN LANE AS APPROVED BY ENGINEER

ELECTRICAL POWER REQUIREMENT:  
220/240 V. SINGLE PHASE TO HANDLE  
1.5 KW DRAW (METERED SEPARATELY  
FROM TRAFFIC SIGNAL INSTALLATION)

**TEMPORARY TRAFFIC SIGNAL CABLE PLAN (TYPICAL ALL STAGES OF CONSTRUCTION)**

**TEMPORARY CABLE PLAN LEGEND**

- [R] TEMPORARY TRAFFIC SIGNAL SECTION 12"
- [X] TEMPORARY CONTROLLER CABINET
- [ ] TEMPORARY SERVICE INSTALLATION
- (5) INDICATES NUMBER OF CONDUCTORS IN CABLE. ALL CONDUCTORS TO BE NUMBER 14 AWG WIRE UNLESS OTHERWISE NOTED.
- (1P) COAXIAL CABLE, 75 ohm, U.N.O.
- [ ] EMERGENCY VEHICLE LIGHT DETECTOR
- [ ] CONFIRMATION BEACON
- [ ] VEHICLE DETECTOR, INDUCTION LOOP
- [ ] PEDESTRIAN PUSHBUTTON DETECTOR
- [ ] 12" PEDESTRIAN SIGNAL SECTION
- [ ] TEMPORARY VIDEO DETECTOR CAMERA

**NOTES FOR TEMPORARY TRAFFIC SIGNALS**

- ALL CONTROL EQUIPMENT INCLUDING EMERGENCY PRE-EMPTION AND TEMPORARY WIRELESS INTERCONNECT COMMUNICATION DEVICES FOR THE TEMPORARY TRAFFIC SIGNAL(S) SHALL BE FURNISHED BY THE CONTRACTOR.
- ONLY CONTROLLERS SUPPLIED BY MULTISONICS WILL BE APPROVED FOR USE AT TEMPORARY SIGNAL LOCATIONS. ALL CONTROLLERS USED FOR TEMPORARY TRAFFIC SIGNALS SHALL BE FULLY ACTUATED NEMA MICROPROCESSOR BASED, APPROVED BY THE CITY OF DEKALB AND INSTALLED IN A NEMA TS1 OR TS2 CABINET. ONLY THIS BRAND OF CONTROLLER WILL BE ACCEPTED FOR THIS CONTRACT.
- ALL TRAFFIC SIGNAL SECTIONS AND PEDESTRIAN SIGNAL SECTIONS SHALL BE 12" (300mm). HEADS SHALL BE PLACED AS INDICATED ON THE TEMPORARY TRAFFIC SIGNAL PLAN OR AS DIRECTED BY THE ENGINEER. THE CONTRACTOR SHALL FURNISH ENOUGH CABLE SLACK TO RELOCATE HEADS TO ANY POSITION ON THE SPAN WIRE OR AT LOCATIONS ILLUSTRATED ON THE PLANS FOR CONSTRUCTION STAGING. THE TEMPORARY TRAFFIC SIGNAL SHALL REMAIN IN OPERATION DURING ALL SIGNAL HEAD RELOCATIONS. EACH TEMPORARY TRAFFIC SIGNAL HEAD SHALL HAVE ITS OWN CABLE FROM THE CONTROLLER CABINET TO THE SIGNAL HEAD.
- ALL EXISTING STREET NAME AND INTERSECTION REGULATORY SIGNS SHALL BE REMOVED FROM EXISTING POLES, RELOCATED AND SECURELY FASTENED TO THE SIGNAL SPAN WIRE OR WOOD POLE AS DIRECTED BY THE ENGINEER.
- ANY TEMPORARY SIGNAL WITHIN AN EXISTING CLOSED LOOP TRAFFIC SIGNAL SYSTEM SHALL BE INTERCONNECTED TO THAT SYSTEM USING SIMILAR BRAND CONTROL EQUIPMENT.
- THE TEMPORARY TRAFFIC SIGNAL SHALL HAVE THE SIGNAL HEAD DISPLAYS, SIGNAL HEAD PLACEMENTS AND CONTROLLER PHASING MATCH THE EXISTING TRAFFIC SIGNAL, AT THE TIME OF THE TURN ON, IF NO TRAFFIC STAGING IS IN PLACE OR WILL NOT BE STAGED ON THE DAY OF THE TURN ON.
- PRIOR TO THE COMMENCEMENT OF ANY WORK, THE CONTRACTOR SHALL NOTIFY BOTH THE IDOT AREA TRAFFIC ENGINEER AT (815) 284-5468 AND THE CITY OF DEKALB PUBLIC WORKS DEPARTMENT AT (815) 748-2020 OF HIS INTENT TO PERFORM THIS WORK. THIS NOTIFICATION SHALL BE MADE A MINIMUM OF (72) HOURS PRIOR TO THE START OF CONSTRUCTION.
- PROPOSED TEMPORARY TRAFFIC SIGNALS SHALL PROVIDE A SEMI-ACTUATED CONTROLLER OPERATION WITH ANNIE GLIDDEN ROAD SET FOR MAXIMUM RECALL. THE CITY WILL PROVIDE TEMPORARY SIGNAL TIMINGS AND TIME-OF-DAY PROGRAMS.

I.D.O.T TRAFFIC SIGNAL INSTALLATION ELECTRICAL SERVICE REQUIREMENTS					TOTAL WATTAGE
TYPE	NO. LAMPS	x WATTAGE		% OPERATION	
		INCAND.	LED		
SIGNAL (RED)	12	135	75	0.50	810.0
(YELLOW)	12	135	25	0.25	405.0
(GREEN)	12	135	25	0.25	405.0
ARROW	8	135	75	0.10	108.0
PED. SIGNAL	-	90	25	1.00	-
CONTROLLER	1	100	100	1.00	100.0
ILLUM. SIGN	-	84	-	0.05	-
VIDEO CAMERA	2	23	-	1.00	46.0
FLASHER	-	-	-	0.50	-
ENERGY COSTS TO: (EXISTING SERVICE DROP)				TOTAL =	1874.0

CITY OF DEKALB  
223 S. FOURTH ST.  
DEKALB, IL 60115

ENERGY SUPPLY CONTACT: Judy Ross  
PHONE: (815) 490-2279  
COMPANY: COM-ED (ROCKFORD)

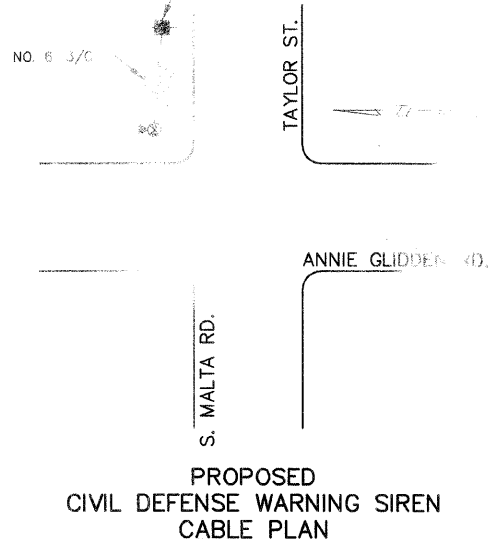

THE TRAFFIC SIGNAL CONTROL EQUIPMENT FOR THIS PROJECT SHALL BE "MULTISONIC" TO MATCH THE EXISTING SYSTEM.

DIVISION OF TRANSPORTATION	
TEMPORARY TRAFFIC SIGNALS CABLE PLAN	
PHASE DESIGNATION DIAGRAM NOTES	
ANNIE GLIDDEN RD AT TAYLOR ST. / S. MALTA RD.	
NAME	DATE
REVISIONS	
SCALE: NONE	DRAWN BY: AC
DATE: SEPTEMBER 10, 2005	CHECKED BY: JRL