

PLAN
Showing Dimensions
Not to Scale

STATION 97+50
BUILT 2006 BY
CITY OF DEKALB
F.A.U. ROUTE 5348
SEC. 05-00160-00-WR
F.A. PROJ. HPP-2295(001)
LOADING HS 20 STR. NO. 019-6006

NAME PLATE
See Std. 515001

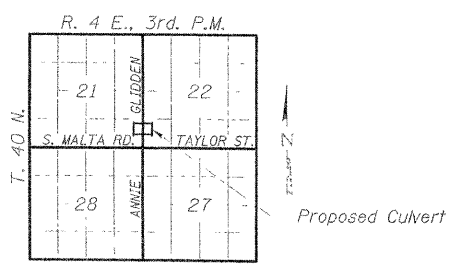

LOCATION SKETCH

DESIGN STRESSES

PRECAST UNITS
f'c = 5,000 psi (Precast Box)
fy = 65,000 psi (Welded Wire Fabric)

FIELD UNITS

f'c = 3,500 psi
fy = 60,000 psi (Reinf.)
Loading HS 20-44
Design Specifications: 2002 AASHTO & all applicable Interims.

WATERWAY DATA

Drainage Area	2.9 Sq. Mi.
Existing Opening (50 yr)	47.4 Sq. Ft.
Req'd Opening (50 yr)	116 Sq. Ft.
Proposed Opening (50 yr)	116 Sq. Ft.
Design Discharge (50 yr)	590 C.F.S.
Created Head (50 yr)	N/A
100 Yr. Discharge	754 C.F.S.
100 Yr. Created Head	0.5 Ft.

I certify that to the best of my knowledge, information and belief, this culvert design is structurally adequate for the design loading shown on the plans. The design is an economical one for the style of structure and complies with requirements of the current "AASHTO Standard Specifications for Highway Bridges"

Steven W. Mezzingon 12-21-05
ILLINOIS STRUCTURAL NO. 6064

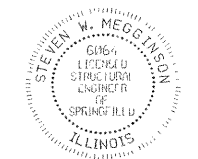

Expires 11-30-06

HLR
Rice, Berry and Associates
A Division of Hampton,
Enzlin and Hamrick, Inc.
Civil & Structural Engineers
3085 Stevenson Drive
Suite 201
Springfield, Illinois 62703
217-546-3400

Account Number
03-03-0167-x
Date: 12/29/05
DESIGNED BY: S.W.S. CHECKED BY: S.W.M. DRAWN BY: P.D.

CULVERT DETAILS
F.A.U. ROUTE 5348 / ANNIE GLIDDEN ROAD
SECTION 05-00160-00-WR
CITY OF DEKALB
STATION 97+50