

STATE OF ILLINOIS

DEPARTMENT OF TRANSPORTATION

DIVISION OF HIGHWAYS

PLANS FOR PROPOSED HIGHWAY BRIDGE PROGRAM

INDEX OF SHEETS

1. COVER SHEET
2. SUMMARY OF QUANTITIES AND GENERAL NOTES
3. TYPICAL CROSS SECTIONS AND QUANTITIES SCHEDULES
4. PLAN AND PROFILE
- 5.-6. DETOUR PLANS
- 7.-13. STATION CROSS SECTIONS
- 14.-20. BRIDGE PLANS
21. BORINGS

HIGHWAY STANDARDS

- | | |
|-----------|--|
| 000001-04 | STANDARD SYMBOLS, ABBREVIATIONS, AND PATTERNS |
| 515001-02 | NAME PLATE FOR BRIDGES |
| 630001-06 | STEEL PLATE BEAM GUARDRAIL |
| 630301-03 | SHOULDER WIDENING FOR TYPE 1, (SPECIAL) GUARDRAIL TERMINALS |
| 631026-02 | TRAFFIC BARRIER TERMINAL, TYPE 5A |
| 635006-02 | REFLECTOR AND TERMINAL MARKER PLACEMENT |
| 635011-01 | REFLECTOR MARKER AND MOUNTING DETAILS |
| 702001-06 | TRAFFIC CONTROL DEVICES |
| BLR 21-6 | TYPICAL APPLICATIONS OF TRAFFIC CONTROL DEVICES FOR CONSTRUCTION ON RURAL LOCAL HIGHWAYS |

UTILITIES

SOUTHWESTERN COOPERATIVE
525 US ROUTE 40
GREENVILLE, IL 62446
(618)664-1025

FRONTIER COMMUNICATION
801 WEST JACKSON
ALTAMONT, IL 62411

FAYETTE CO. WATER CO.
R.R.#1 BOX 714
BROWNSTOWN, IL 62418

DESIGN FUNCTIONAL CLASSIFICATION: MAJOR COLLECTOR
DESIGN TRAFFIC: 1550 ADT (2005) 2100 ADT (2025)
DESIGN POLICIES: 3R
DESIGN SPEED: 50 M.P.H.

CONTRACT NO. 95469

SCALES { PLAN 0' = 50'
PROFILE HORIZ. 0' = 50'
PROFILE VERT. 0' = 5'
CROSS SECTIONS 0' = 5'

PROJECT BRS-712(105)

SECTION 02-00104-00-BR

FAYETTE COUNTY

F.A.S. 712 / C.H. 24 OVER ASH CREEK

C-97-090-02

PROPOSED STRUCTURE NO. 026-3431

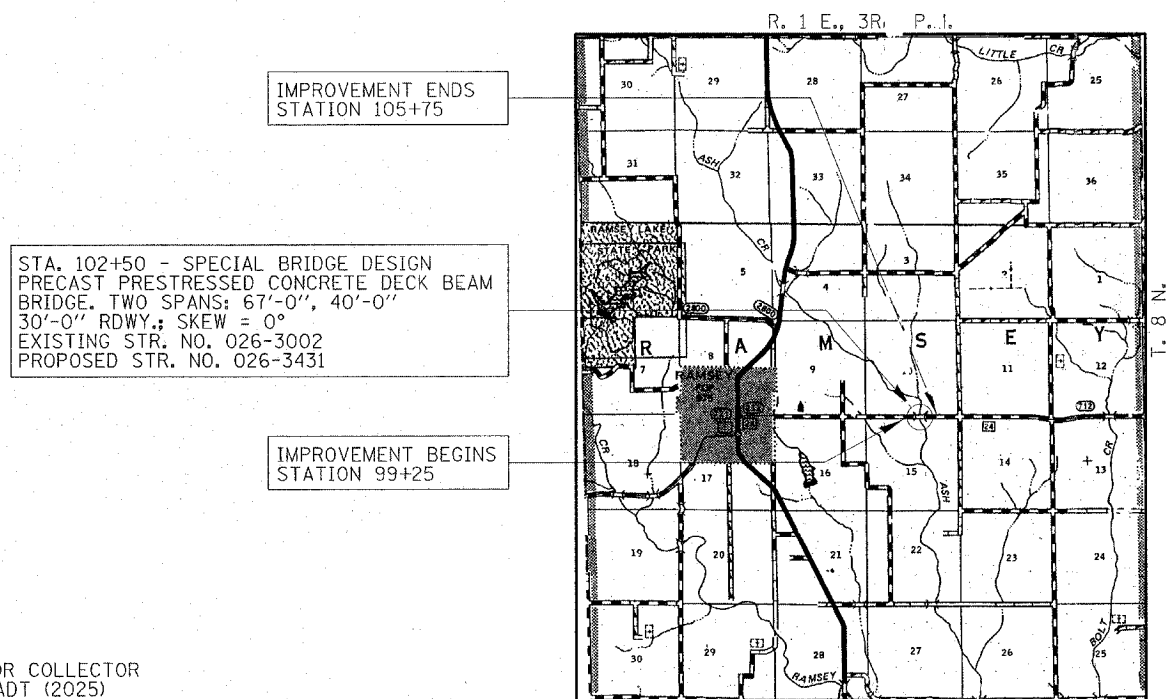
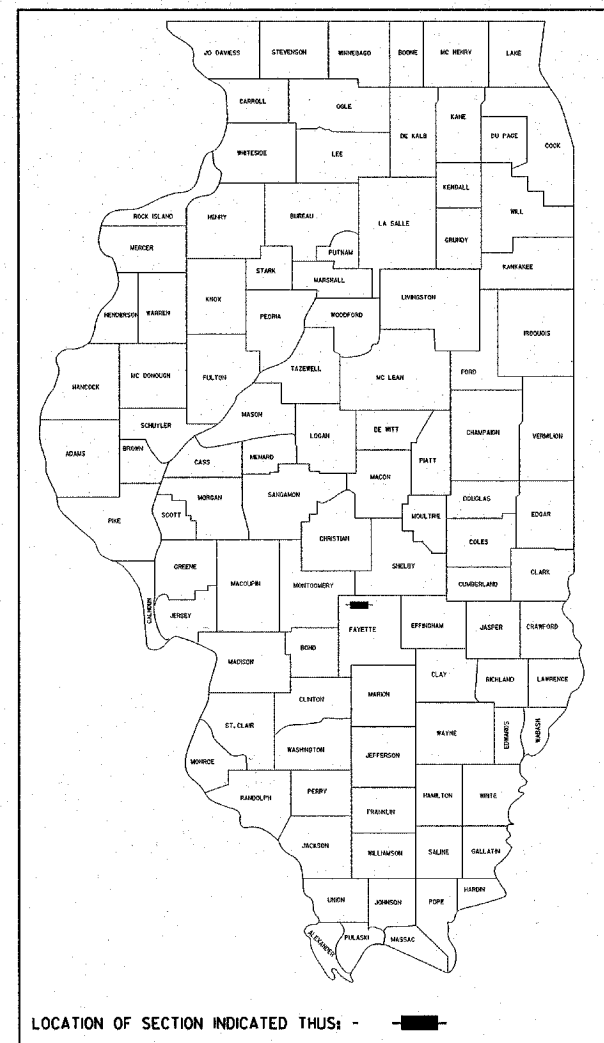

LAYOUT

APPROXIMATE SCALE: 0 1 MILE
NET LENGTH OF SECTION = 650 FEET = 0.123 MILES



APPROVED	3-21 20 06
	<i>Mitchell A. May</i> COUNTY ENGINEER
PASSED	4-7 20 06
	<i>Margaret E. Cook</i> DISTRICT SEVEN ENGINEER OF LOCAL ROADS & STREETS
Releasing For Bid Based on Limited Review	4-7 20 06
	<i>Christina M. Redrup</i> DEPUTY DIRECTOR OF HIGHWAYS, REGION FOUR ENGINEER
	STATE OF ILLINOIS DEPARTMENT OF TRANSPORTATION

DATE: *March 14 2006*

BY: *Steven Maggiano*

LICENSE EXPIRES: NOVEMBER 30, 2007

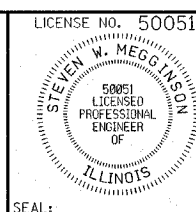

HLR
Rice, Berry and Associates
A Division of Hampton,
Lenzini and Renwick, Inc.
Civil & Structural Engineer
3085 Stevenson Drive
Suite 201
Springfield, Illinois 62703
217-546-3400
P.O. Box 1036
DuQuoin, Illinois 62832
618-790-4637