

PLAN
 SURVEYED
 PLOTTED
 CHECKED
 DATE
 NO. SHEETS
 NO. THIS SHEET

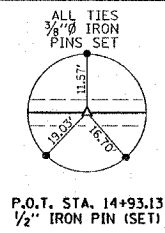
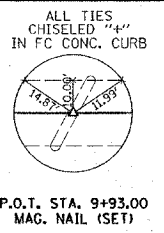
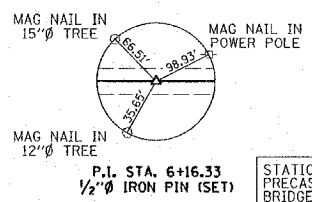
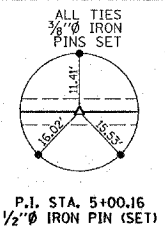

STEPHEN TINGLEY
 NE 1/4, NW 1/4, SEC 21, T. 10 N., R. 12 W., 3RD P.M.

FAS	SECTION	COUNTY	TOTAL SHEETS	SHEET NO.
690	05-00261-00-BR	CLARK	14	3

STA. 5+00.16 TO STA. 14+93.13
 FED. ROAD DIST. NO. ILLINOIS CONTRACT NO. 95480

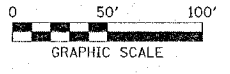
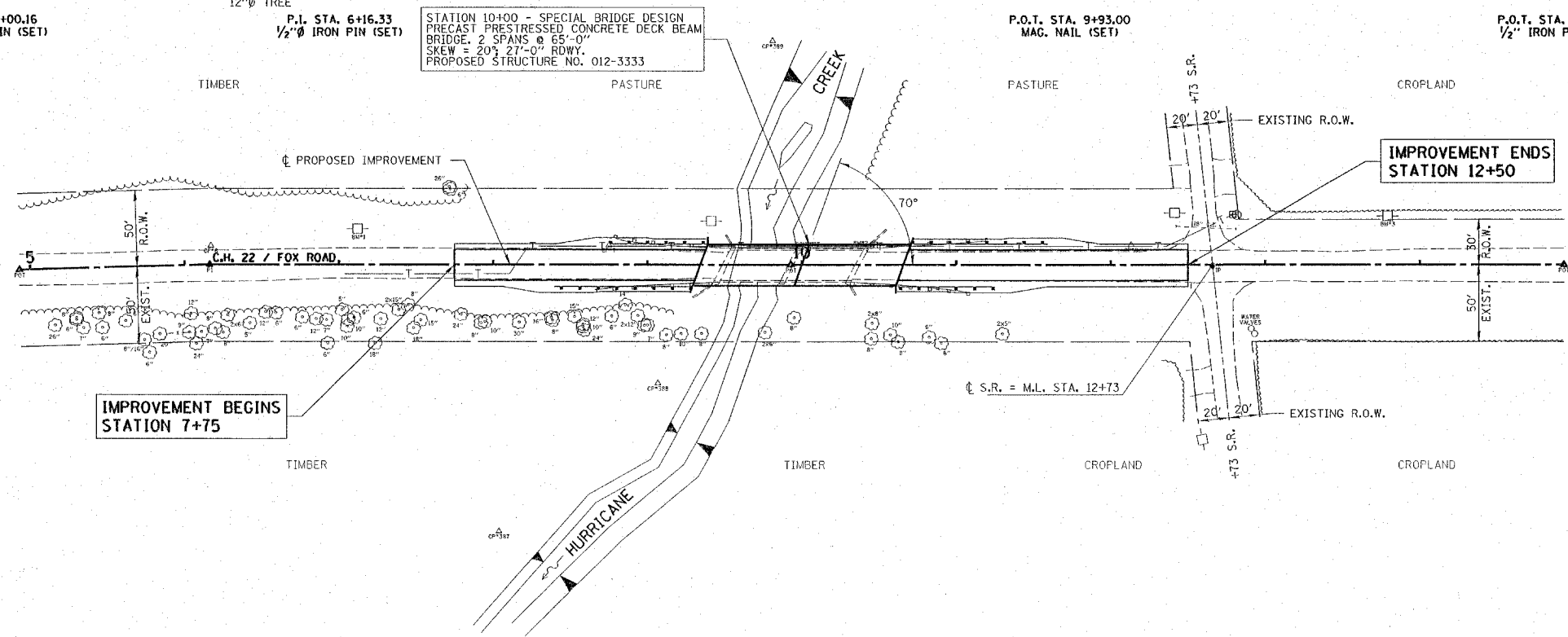

STEPHEN TINGLEY
 N 1/2, NE 1/4, SEC 21, T. 10 N., R. 12 W., 3RD P.M.

CHANNEL EXCAVATION
 THE CHANNEL SHALL BE EXCAVATED AS SHOWN WITH 2:1 SIDE SLOPES WITHIN THE LIMITS OF THE PROPOSED BRIDGE, THEN TAPER TO THE EXISTING CHANNEL AT THE R.O.W. LINES. SUITABLE EXCAVATED MATERIAL SHALL BE DEPOSITED ON THE JOB SITE FOR USE BY THE COUNTY IN THE EMBANKMENT. UNSUITABLE MATERIAL SHALL BE DISPOSED OF BY THE CONTRACTOR OFF THE JOB SITE.

EXISTING STRUCTURE NO. 012-3008
 STATION 9+93 - TWO SPAN STEEL I-BEAM BRIDGE WITH A CONCRETE DECK ON CLOSED CONCRETE ABUTS. AND A CONCRETE PIER.
 83.0' FC-FC. ABUTS; 22.0' O.-O. DECK
 REMOVAL OF EXISTING STRUCTURES = 1 EACH

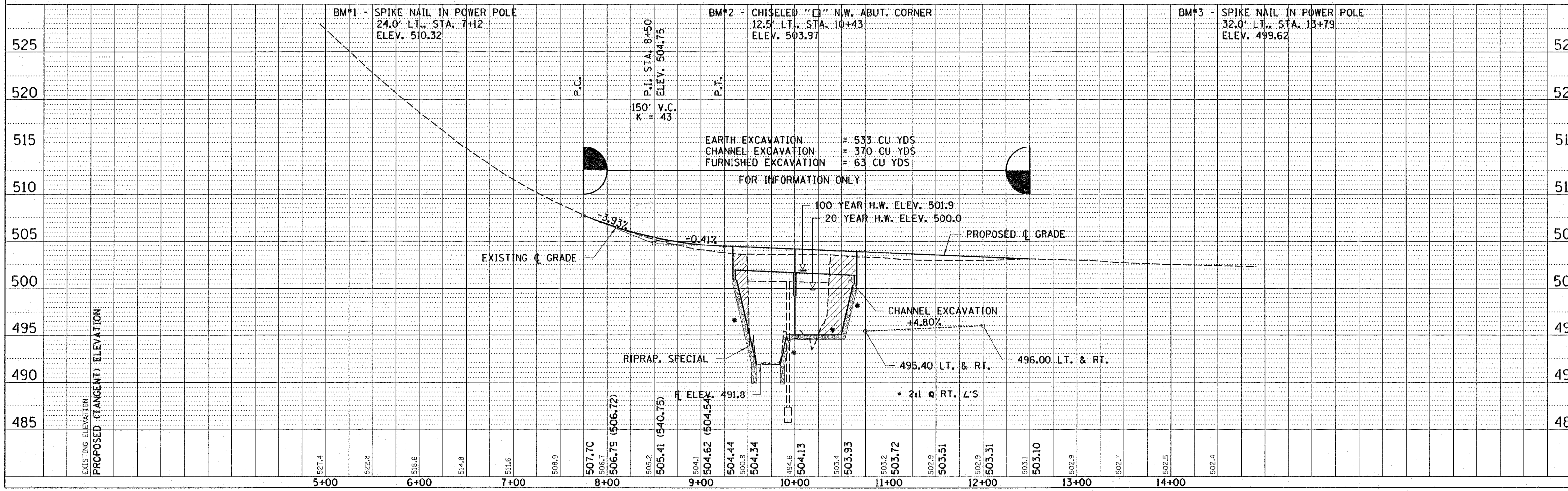

PROFILE
 SURVEYED
 PLOTTED
 CHECKED
 DATE
 NO. SHEETS
 NO. THIS SHEET

EXISTING ELEVATION
 PROPOSED (TANGENT) ELEVATION

5+00 6+00 7+00 8+00 9+00 10+00 11+00 12+00 13+00 14+00