

ROUTE NO.	SECTION	COUNTY	TOTAL SHEETS	SHEET NO.
T.R. 133	05-17117-00-BR	SHELBY	21	1
ROAD DIST.		ILLINOIS	RIDGE	

CONTRACT NO. 95484

STATE OF ILLINOIS DEPARTMENT OF TRANSPORTATION DIVISION OF HIGHWAYS PLANS FOR PROPOSED HIGHWAY BRIDGE PROGRAM

**RIDGE ROAD DISTRICT
SECTION 05-17117-00-BR
SHELBY COUNTY
PROJECT NO. BROS-173(143)
T.R. 133
JOB NO. : C-97-135-06**

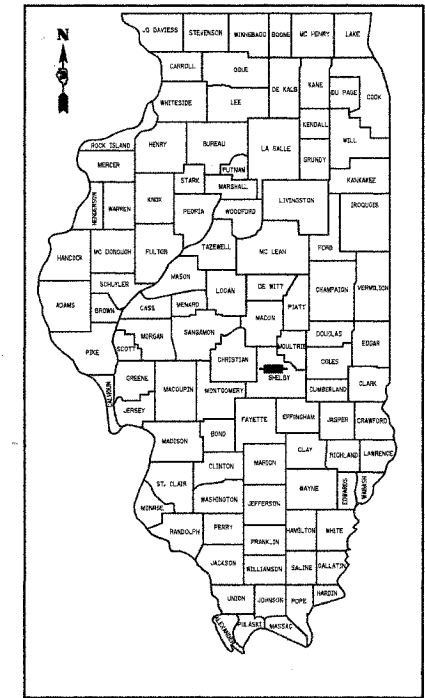

LOCATION OF SECTION INDICATED THUS:

CLASSIFICATION: RURAL TWO-LANE LOCAL ROAD
DESIGN VOLUME: UNDER 250 ADT
CURRENT ADT: 225
DESIGN SPEED: 30 MPH

TOLL FREE JOINT UTILITY LOCATING
INFORMATION FOR EXCAVATORS (J.U.L.I.E.)
TELEPHONE NUMBER 1-800-892-0123

SHEET NO.	TITLE
1.	COVER SHEET
2.	SUMMARY OF QUANTITIES, GENERAL NOTES & TYPICAL SECTIONS
3.	PLAN AND PROFILE SHEET
4.	SIDEROAD PLAN AND PROFILE SHEET
5.	PROPOSED ALIGNMENT AND CROSS TIES SHEET
6.	SHOULDER AND GUARDRAIL DETAILS
7.-12.	BRIDGE PLANS
13.-20.	STATION CROSS SECTIONS
21.	EROSION CONTROL PLAN

STANDARDS:

000001-04	STANDARD SYMBOLS, ABBREVIATIONS AND PATTERNS
280001-02	TEMPORARY EROSION CONTROL
515001-02	NAME PLATE FOR BRIDGES
630001-06	STEEL PLATE BEAM GUARDRAIL
630301-03	SHOULDER WIDENING FOR TYPE 1 (SPECIAL) GUARDRAIL TERMINALS
631026-02	TRAFFIC BARRIER TERMINAL TYPE 5 & 5A
635006-02	REFLECTOR AND TERMINAL MARKER PLACEMENT
702001-06	TRAFFIC CONTROL DEVICES
BLR 21-6	TYPICAL APPLICATION OF TRAFFIC CONTROL DEVICES FOR CONSTRUCTION ON RURAL LOCAL HIGHWAYS

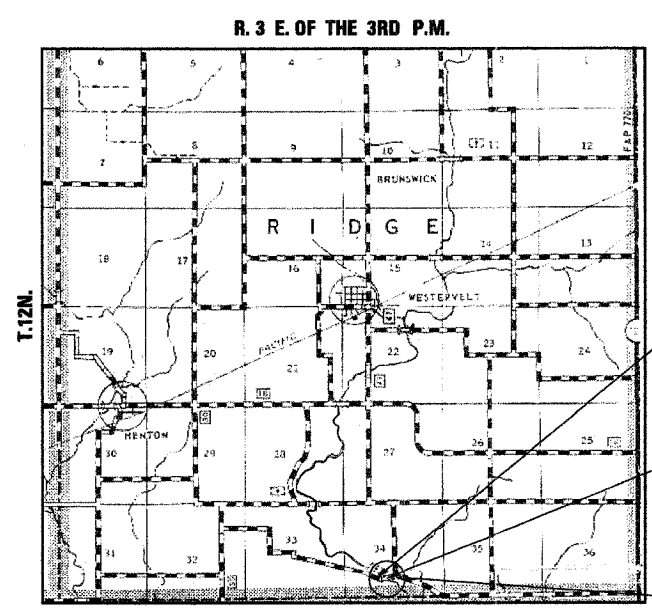

IMPROVEMENT BEGINS
STA. 11+50

STA. 15+02.38 - SPECIAL BRIDGE DESIGN
PRECAST PRESTRESSED CONCRETE DECK BEAM
BRIDGE, THREE SPANS @ 34'-0", 55'-0", 55'-0";
24'-0" ROADWAY, SKEW=0°
EXISTING S.N. 087-3122
PROPOSED S.N. 087-3548

IMPROVEMENT ENDS
STA. 19+50

LOCATION PLAN

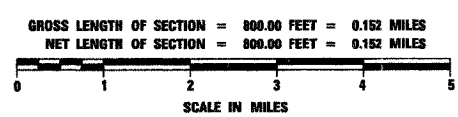

SCALES

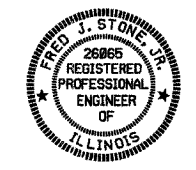
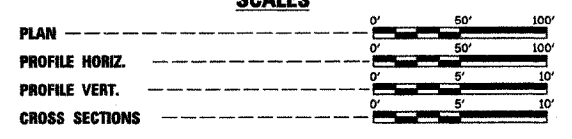

Fred J. Stone, Jr. (5-10-06)
ILLINOIS PROFESSIONAL NO. 26865
EXPIRES 11-30-07

4440 ASH GROVE
SPRINGFIELD, IL 62711
(217) 793-8600
oasinc@insightbb.com

OZYURT AND STONE, INC.
CONSULTING ENGINEERS

PASSED	05-15	20 06
	<i>Ben Smith</i>	
	ROAD DISTRICT COMMISSIONER	
APPROVED	15 MAY	20 06
	<i>S. De J...</i>	
	COUNTY ENGINEER	
PASSED	June 9	20 06
	<i>Maurice J. Coyle</i>	
	DISTRICT SEVEN ENGINEER OF LOCAL ROADS & STREETS	
RELEASED FOR BID BASED ON LIMITED REVIEW	June 9	20 06
	<i>Christy M. Reed</i>	
	DEPUTY DIRECTOR OF HIGHWAYS, REGION FOUR ENGINEER	
	STATE OF ILLINOIS DEPARTMENT OF TRANSPORTATION	