

RTE.	SECTION	COUNTY	TOTAL SHEETS	SHEET NO.
T.R. 137	*	JERSEY	9	1
FEDERAL AID PROJECT				
04-07118-00-BR				

STATE OF ILLINOIS
DEPARTMENT OF TRANSPORTATION

PLANS FOR PROPOSED
HIGHWAY BRIDGE REPLACEMENT
AND REHABILITATION PROGRAM
PROJECT NO. BROS-083 (038)
T.R. 137 OVER PIASA CREEK
SECTION 04-07118-00-BR
JERSEY COUNTY
C-98-310-06

CONTRACT NO. 97277

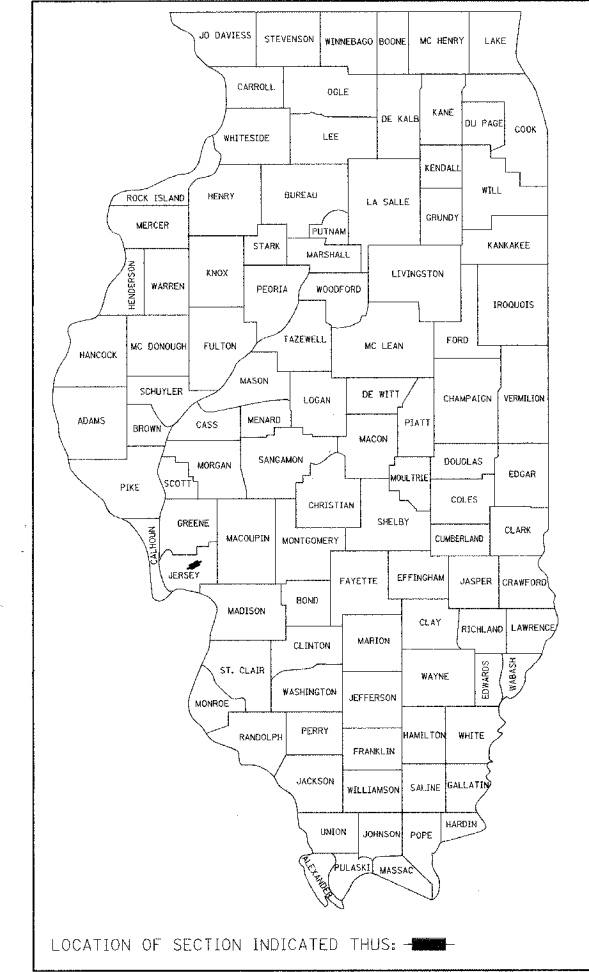

- INDEX OF SHEETS**
- 1 - TITLE SHEET
 - 2 - SUMMARY OF QUANTITIES, DETAILS, & TYPICAL SECTIONS
 - 3 - PLAN & PROFILE
 - 4 - GENERAL PLAN & ELEVATION
 - 5 - SUPERSTRUCTURE
 - 6 - RAILING
 - 7 - ABUTMENTS
 - 8 & 9 - CROSS SECTIONS

- STANDARDS**
- STANDARD 515001-02
 - STANDARD 701201-02
 - STANDARD 701301-02
 - STANDARD 702001-06
 - STANDARD BLR 21-6

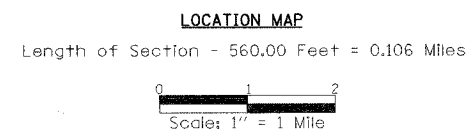
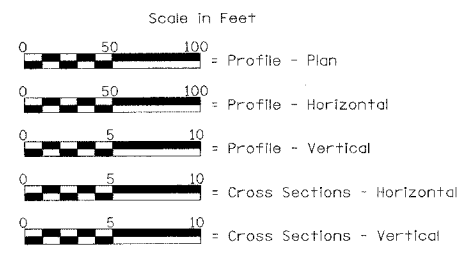
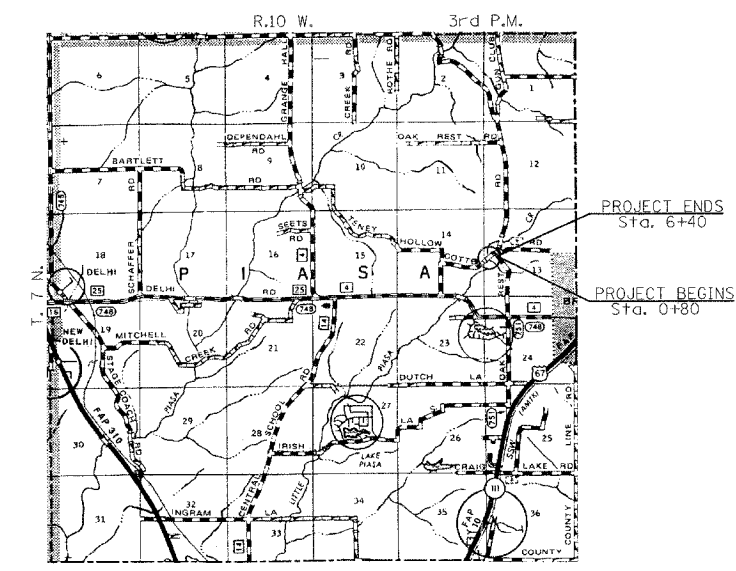

Land Section - 13
Land Quarter Section - S.W.
Political Township - Piase
DESIGN DESIGNATION
Design Speed = 30 m.p.h.
Functional Classification: Local Road
ADT: 175 (2006)
214 (2026)

EXISTING STRUCTURE: SINGLE SPAN CAST IN PLACE CONCRETE DECK, WINGWALLS AND RAIL, ±31'-0" BK.-BK. ABUTMENTS, ±16'-9" CLEAR DECK WIDTH, 0° SKEW.
EXISTING STRUCTURE NO. 042-3074

PROPOSED STRUCTURE: SINGLE SPAN PRECAST PRESTRESSED CONCRETE DECK BEAMS (27") ON OPEN CONCRETE ABUTMENTS, 24'-0" CLEAR DECK WIDTH, TYPE S1 RAILING, 10° SKEW LT. FORWARD.
PROPOSED STRUCTURE NO. 042-3139

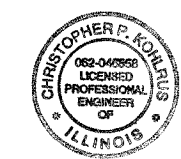

Christopher P. Kohlman 3/16/06
Expiration: 11/30/07

APPROVED 3/6 2006
Thomas E. Kames
COUNTY ENGINEER

APPROVED 3/6 2006
Jack E. Davel
ROAD COMMISSIONER

PASSED April 6 2006
Jeanette Oberthorn
DISTRICT EIGHT ENGINEER OF LOCAL ROADS & STREETS

April 6 2006
Mary C. Lewis
DEPUTY DIRECTOR OF HIGHWAYS
REGION FIVE ENGINEER
STATE OF ILLINOIS
DEPARTMENT OF TRANSPORTATION

TOLL FREE
"JOINT UTILITY LOCATION INFORMATION FOR EXCAVATORS"
(J.U.L.I.E.) TELEPHONE NUMBER
1-800-892-0123

CONTRACT NO. 97277

FILE NAME: JCLTTS (REV. 3/8/06)