

T.R.	SECTION	COUNTY	TOTAL SHEETS	SHEET NO.
229	01-06128-00-BR	HAMILTON	14	2
FED. ROAD DIST. NO. 9 ILLINOIS		FED. AID PROJECT		
PROJECT# BROS-065(37)		CONTRACT# 99251		
JOB NO. C-99-529-06		SULLIVAN BRANCH		
LEC JOB # H041010M				

323 W. 3RD ST.  
P.O. BOX 160  
MT. CARMEL, IL  
62863  
PHONE: (618)-262-8651  
FAX: (618)-263-3327

405 W. STATE ST  
SUITE 1  
PRINCETON, IN  
47670  
PHONE: (812)-386-7611  
FAX: (812)-386-2812

**GENERAL NOTES:**

THIS SECTION SHALL BE CONSTRUCTED IN ACCORDANCE WITH THE PLANS, SPECIAL PROVISIONS AND "STANDARD SPECIFICATIONS FOR ROAD AND BRIDGE CONSTRUCTION", ADOPTED JANUARY 1, 2002.

THE WORK INVOLVED ON THIS SECTION CONSISTS OF THE REMOVAL OF THE EXISTING STRUCTURE, THE CONSTRUCTION OF A 75 FOOT LONG TRIPLE SPAN (25', 25', 25') PRECAST, PRESTRESSED CONCRETE DECK BEAM BRIDGE, EARTH APPROACHES, AGGREGATE SURFACE COURSE AND OTHER MISCELLANEOUS ITEMS NECESSARY TO COMPLETE THIS SECTION.

ALL ELEVATIONS ARE BASED ON U.S.G.S. MEAN SEA LEVEL DATUM.

IT SHALL BE THE CONTRACTOR'S RESPONSIBILITY TO CONTACT ALL THE UTILITIES, AFFECTING THE PROJECT, PRIOR TO CONSTRUCTION.

NOTE: CONSTRUCTION TRANSITION  
STA. 1 + 55 TO STA 2 + 15

ALL QUANTITIES ARE INCLUDED IN THE PROPOSAL

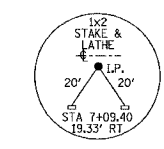
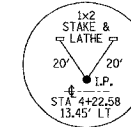
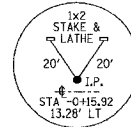

CURVE #1  
P.I. STA= 4+09.12  
ΔP LT. 7'28"11"  
D= 7'09'43"  
R= 800'  
T= 50.37'  
L= 100.61'  
E= 1.58'  
O= NONE  
T.R.= NONE  
S.E. RUN= NONE  
P.C. STA= 3+58.75  
P.T. STA= 4+59.36

CURVE #2  
P.I. STA= 6+54.35  
ΔP LT. 7'28"11"  
D= 7'26'28"  
R= 770'  
T= 50.26'  
L= 100.39'  
E= 1.64'  
O= NONE  
T.R.= NONE  
S.E. RUN= NONE  
P.C. STA= 6+04.09  
P.T. STA= 7+04.47

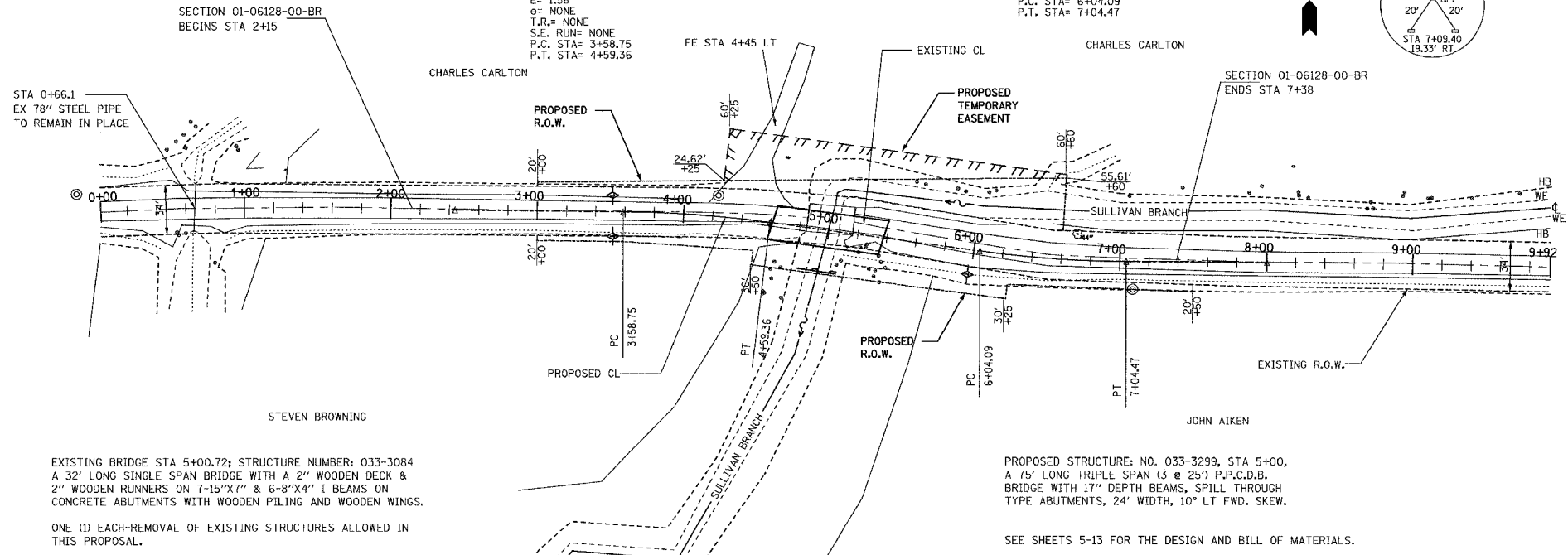

EXISTING BRIDGE STA 5+00.72; STRUCTURE NUMBER: 033-3084  
A 32' LONG SINGLE SPAN BRIDGE WITH A 2" WOODEN DECK & 2" WOODEN RUNNERS ON 7-15"x7" & 6-8"x4" I BEAMS ON CONCRETE ABUTMENTS WITH WOODEN PILING AND WOODEN WINGS.

ONE (1) EACH-REMOVAL OF EXISTING STRUCTURES ALLOWED IN THIS PROPOSAL.

PROPOSED STRUCTURE: NO. 033-3299, STA 5+00,  
A 75' LONG TRIPLE SPAN (3 @ 25') P.P.C.D.B. BRIDGE WITH 17" DEPTH BEAMS, SPILL THROUGH TYPE ABUTMENTS, 24' WIDTH, 10' LT FWD. SKEW.

SEE SHEETS 5-13 FOR THE DESIGN AND BILL OF MATERIALS.

NOTE: FILL NEXT TO BRIDGE TO BE AGGREGATE SURFACE COURSE

TEMPORARY DITCH CHECKS -  
AGGREGATE (EROSION CONTROL) -

194 UNITS-TREE REMOVAL (6 TO 15 UNITS DIAMETER)  
36 UNITS-TREE REMOVAL (OVER 15 UNITS DIAMETER)  
0.2 ACRES SEEDING, CLASS 2 SPECIAL REQUIRED

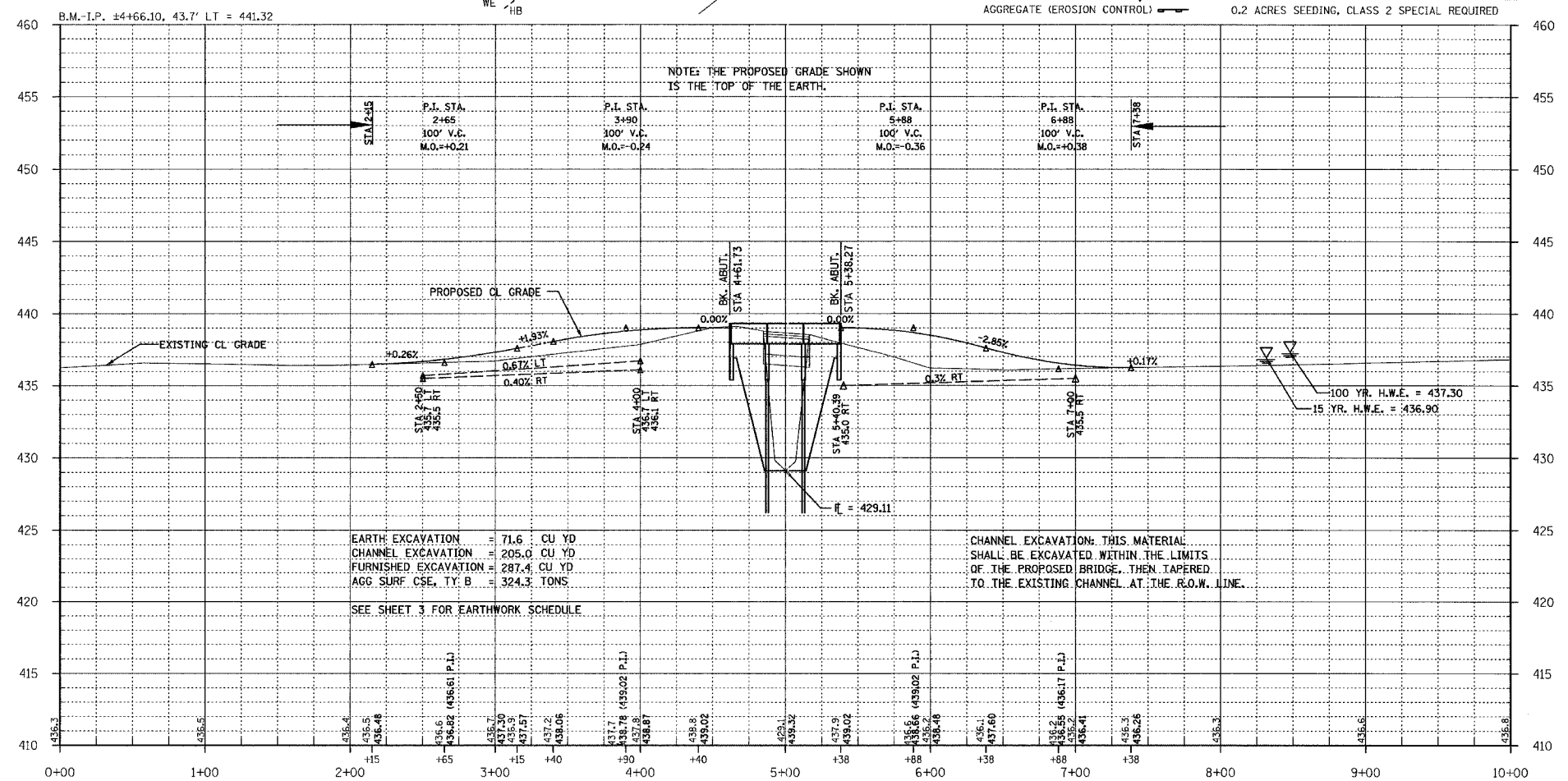

EARTH EXCAVATION = 71.6 CU YD  
CHANNEL EXCAVATION = 205.0 CU YD  
FURNISHED EXCAVATION = 287.4 CU YD  
AGG SURF CSE, TY B = 324.3 TONS

CHANNEL EXCAVATION: THIS MATERIAL SHALL BE EXCAVATED WITHIN THE LIMITS OF THE PROPOSED BRIDGE, THEN TAPERED TO THE EXISTING CHANNEL AT THE R.O.W. LINE.

SEE SHEET 3 FOR EARTHWORK SCHEDULE

TYPICAL CROSS SECTION PROPOSED

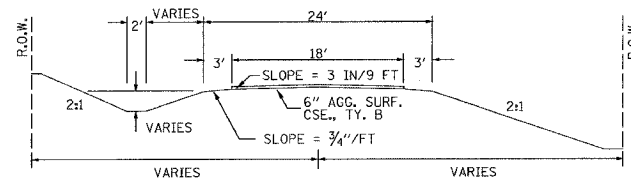

TYPICAL CROSS SECTION EXISTING

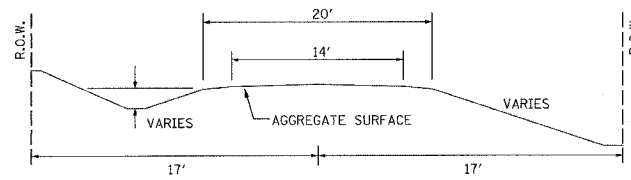

FIELD ENTRANCE DETAIL

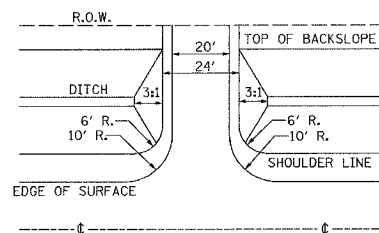

NOTE: PLACE AGGREGATE SURFACE COURSE, TYPE B ON FIELD ENTRANCE

NOTE: CONSTRUCT SPECIAL DITCH

STA 2+50 TO STA 4+00 LT  
STA 2+50 TO STA 4+00 RT  
STA 5+40.39 TO STA 7+00 RT

NOTE: CONSTRUCT STONE RIPRAP DITCH

STA 5+40 TO STA 5+50 RT (0.48 TON/LIN FT)  
5 TON STONE RIPRAP DITCH ALLOWED IN PROPOSAL.

SEE SHEET NO. 14 FOR STONE RIPRAP DITCH DETAIL.

NOTE: PLACE STONE DUMPED RIPRAP CLASS A4

STA 4+63 TO STA 6+35 NORTH BANK  
STA 5+45 TO STA 6+60 SOUTH BANK  
250 TON STONE DUMPED RIPRAP CLASS A4 ALLOWED IN PROPOSAL FOR DITCH AREA

SEE SHEET NO. 14 FOR TYPICAL DITCH CROSS SECTION

UTILITIES:  
J.U.L.I.E. 1-800-892-0123

WAYNE-WHITE COUNTY  
ELECTRIC  
618-842-2196



PROFESSIONAL DESIGN FIRM  
LAND SURVEY & PROFESSIONAL ENGINEERING CORPORATION  
184-000887  
(62-032435)(35-002769)



AARON M. MEFFORD  
NAME  
Signature  
05-16-06  
DATE  
11-30-07  
EXPIRES

TOWNSHIP ROUTE 229  
OVER SULLIVAN BRANCH  
HAMILTON COUNTY, ILLINOIS

SHEET TITLE:

PLAN & PROFILE

SCALE: VARIES  
BY: AMM  
DATE: 5/06  
REV:

2 OF 14 SHEETS

SHEET NO. 2