

F.A.S.	SECTION	COUNTY	TOTAL SHEETS	SHEET NO.
880	93-00076-00-RS	HAMILTON	8	1
FED. ROAD DIST. NO. 8		ILLINOIS	DAHLGREN ROAD (EAST)	
PROJECT RS-880(105)			CONTRACT # 99263	
LEC JOB # H051007HM				

INDEX OF SHEETS

SHEET NO.	DESCRIPTION
1	TITLE SHEET, SUMMARY OF QUANTITIES
2	TYPICAL SECTIONS, GENERAL NOTES, MISCELLANEOUS DETAILS
3	DETAILS OF INTERSECTIONS, AND SIDEROADS
4	SCHEDULES, AND LINE DIAGRAMS
5-6	LINE DIAGRAMS

STATE OF ILLINOIS

DEPARTMENT OF TRANSPORTATION

DIVISION OF HIGHWAYS

PLANS FOR PROPOSED FEDERAL-AID SECONDARY PROJECT

F.A.S. 880 (CH 8) SECTION 93-00076-00-RS HAMILTON COUNTY

PROJECT RS-880(105) JOB NO. C-99-572-06

THE FOLLOWING STANDARDS ARE A PART OF THESE PLANS AND ARE INCLUDED AFTER SHEET NO. 4

000001-04	STANDARD SYMBOLS, ABBREVIATIONS & PATTERNS
406201	MAILBOX TURNOUT
701006-02	OFF-RD OPERATIONS, 2-L, 2-W, 4.5 m (15') TO PAVEMENT EDGE FOR SPEEDS ≥ 45 MPH
701301-02	LANE CLOSURE, 2L, 2W, SHORT TIME OPERATIONS
701306-01	LANE CLOSURE, 2L, 2W, SLOW MOVING OPERATIONS DAY ONLY FOR SPEEDS ≥ 45 MPH
701311-02	LANE CLOSURE, 2L, 2W, MOVING DAY OPERATIONS
702001-06	TRAFFIC CONTROL DEVICES
780001-01	TYPICAL PAVEMENT MARKINGS

SUMMARY OF QUANTITIES

CODE NUMBER	ITEM	UNIT	QUANTITY
*X4066414	BITUMINOUS CONCRETE SURFACE COURSE, SUPERPAVE, MIX "C", N50	TON	5519.00
*X4066770	LEVELING BINDER (MACHINE METHOD), SUPERPAVE N70	TON	6270.00
40600100	BITUMINOUS MATERIALS (PRIME COAT)	GALLON	3200.00
40600300	AGGREGATE (PRIME COAT)	TON	64.00
40600980	BITUMINOUS SURFACE REMOVAL - BUTT JOINT	SQ YD	212.00
40600990	TEMPORARY RAMP	SQ YD	35.4
48101200	AGGREGATE SHOULDERS, TYPE B	TON	2092.00
60255500	MANHOLES TO BE ADJUSTED	EACH	1.00
*67100100	MOBILIZATION	L SUM	1.00
70100460	TRAFFIC CONTROL AND PROTECTION STANDARD 701306	L SUM	1.00
Δ 78001100	PAINT PAVEMENT MARKING-LETTERS AND SYMBOLS	SQ FT	123.00
Δ 78001110	PAINT PAVEMENT MARKING-LINE 4"	FOOT	62129.00
Δ 78001180	PAINT PAVEMENT MARKING-LINE 24"	FOOT	60.00
44300100	AREA REFLECTIVE CRACK CONTROL TREATMENT	SQ YD	2934.00

Δ SPECIALTY ITEMS

CONTRACT NO. 99263
DESIGN CLASS - MAJOR RURAL COLLECTOR
CURRENT A.D.T. = 710
DESIGN SPEED = 50 MPH

J.U.L.I.E.
JOINT UTILITY LOCATION INFORMATION FOR EXCAVATION
1-800-892-0123

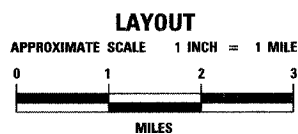
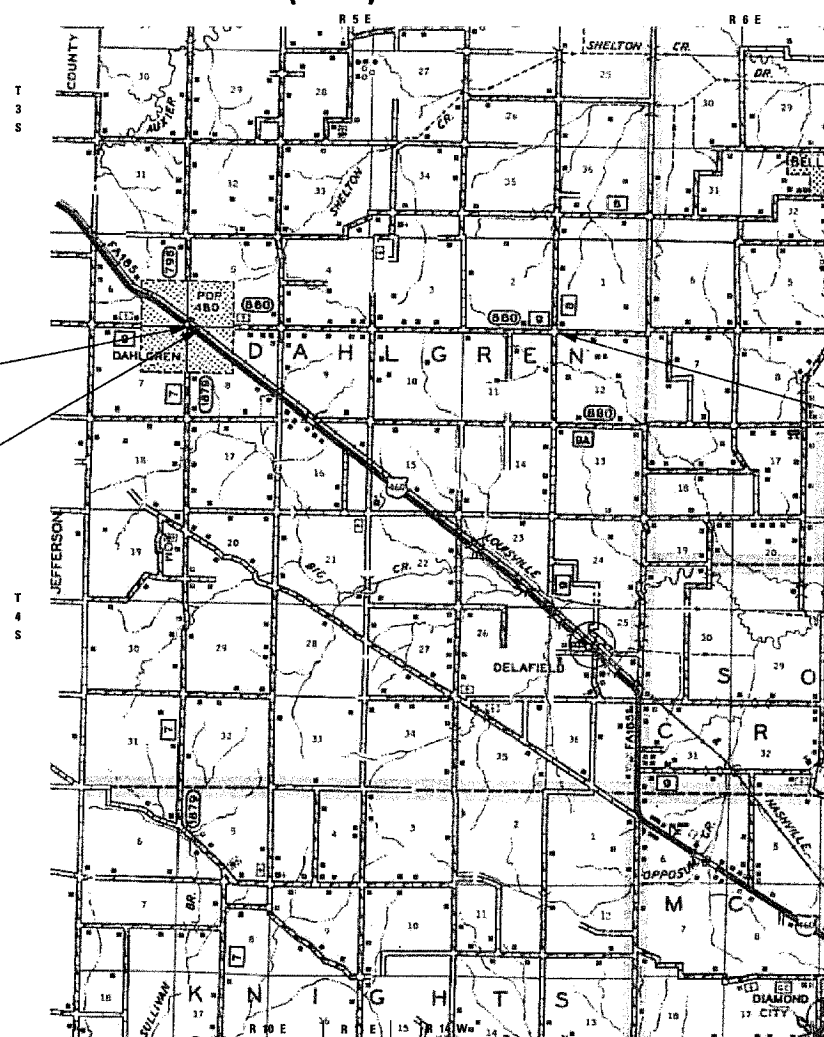

GROSS LENGTH	20670.00 FT	3.915 MILES
OMISSION	12.60 FT	0.003 MILES
NET LENGTH	20657.40 FT	3.912 MILES

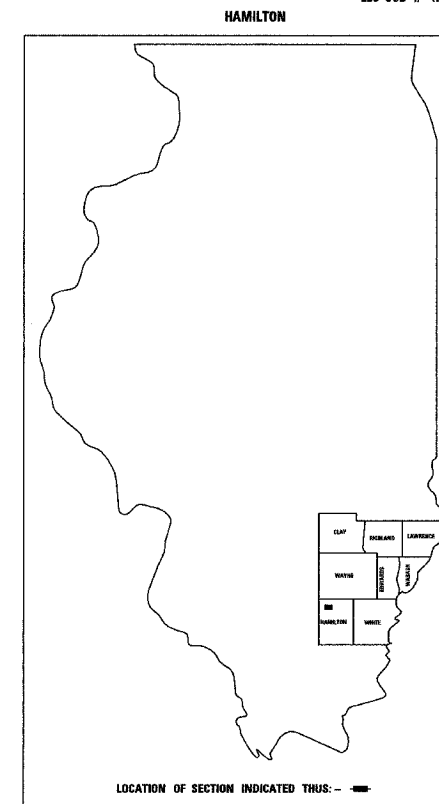

323 W. 3RD ST.
P.O. BOX 160
MT. CARMEL, IL
62863
PHONE:
(618)-262-9651
FAX:
(618)-263-3327

405 W. STATE ST.
SUITE 1
PRINCETON, IN
47670
PHONE:
(812)-386-7611
FAX:
(812)-385-2812

LAMAC
ENGINEERING CO.

PROFESSIONAL DESIGN FIRM
LAND SURVEY & PROFESSIONAL ENGINEERING CORPORATION
184-000887
(62-032435)(35-002769)

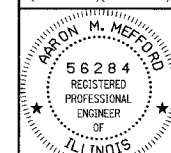

AARON M. MEFFORD
NAME
Aaron Mefford
SIGNATURE
05-16-06
DATE
11-30-07
EXPIRES

APPROVED May 16 20 06
Kevin D. Kelly
COUNTY ENGINEER

PASSED MAY 23 20 06
Dennis W. Hill
DISTRICT NINE ENGINEER OF LOCAL ROADS & STREETS

APPROVED May 23 20 06
Alan Morris
DEPUTY DIRECTOR OF HIGHWAYS,
REGION FIVE ENGINEER

STATE OF ILLINOIS
DEPARTMENT OF TRANSPORTATION