

REVISIONS		
NUMBER	BY	DATE

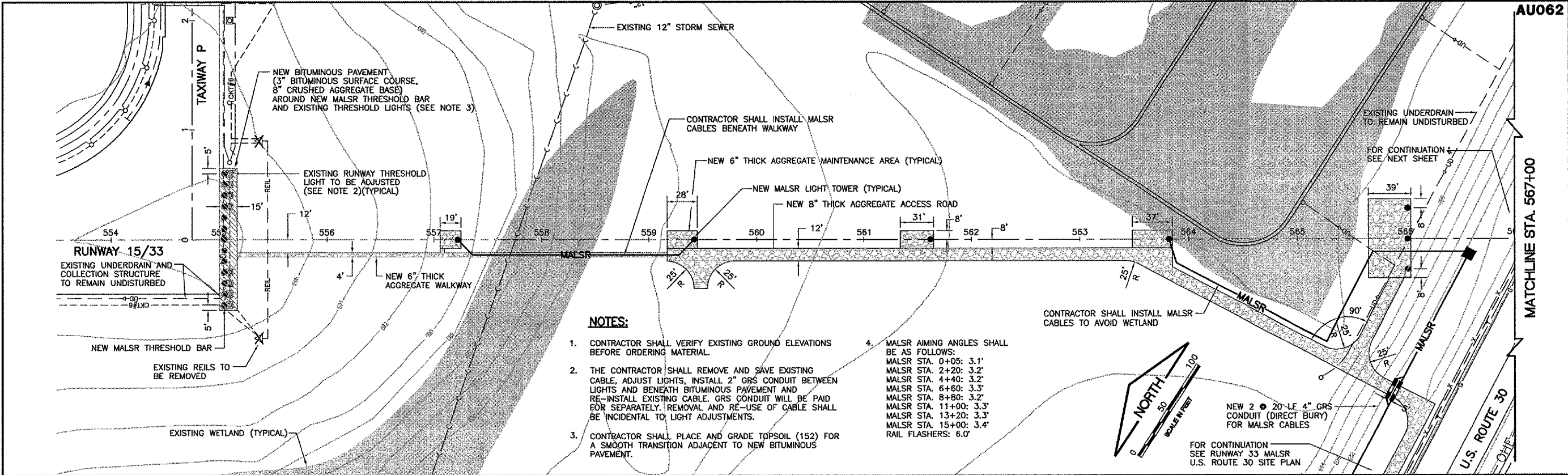

NOTES:

- CONTRACTOR SHALL VERIFY EXISTING GROUND ELEVATIONS BEFORE ORDERING MATERIAL.
- THE CONTRACTOR SHALL REMOVE AND SAVE EXISTING CABLE, ADJUST LIGHTS, INSTALL 2" GRS CONDUIT BETWEEN LIGHTS AND BENEATH BITUMINOUS PAVEMENT AND RE-INSTALL EXISTING CABLE. GRS CONDUIT WILL BE PAID FOR SEPARATELY. REMOVAL AND RE-USE OF CABLE SHALL BE INCIDENTAL TO LIGHT ADJUSTMENTS.
- CONTRACTOR SHALL PLACE AND GRADE TOPSOIL (152) FOR A SMOOTH TRANSITION ADJACENT TO NEW BITUMINOUS PAVEMENT.
- MALSRR AIMING ANGLES SHALL BE AS FOLLOWS:
 MALSRR STA. 0+05: 3.1'
 MALSRR STA. 2+20: 3.2'
 MALSRR STA. 4+40: 3.2'
 MALSRR STA. 6+60: 3.3'
 MALSRR STA. 8+80: 3.2'
 MALSRR STA. 11+00: 3.3'
 MALSRR STA. 13+20: 3.3'
 MALSRR STA. 15+00: 3.4'
 RAIL FLASHERS: 6.0'

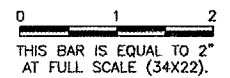
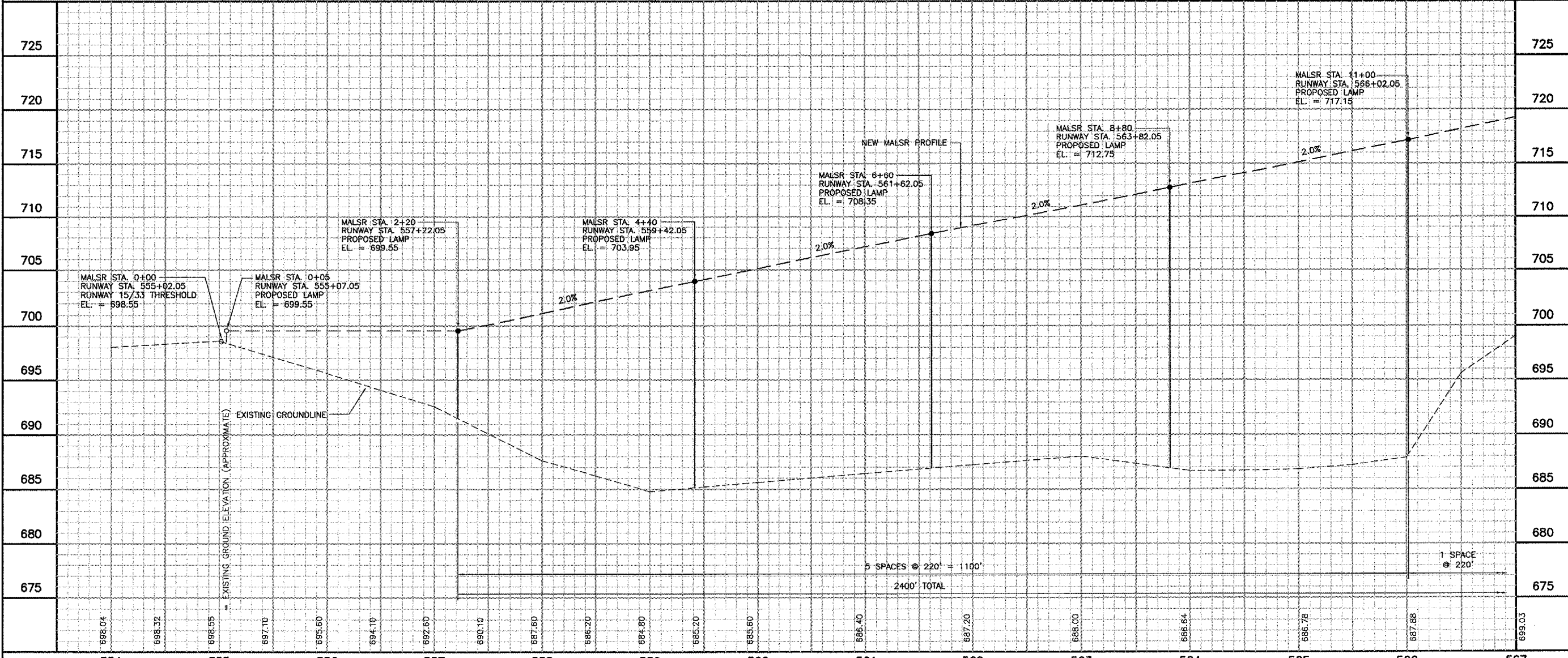
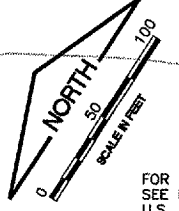

MATCHLINE STA. 567+00

**AURORA MUNICIPAL AIRPORT
 AURORA, ILLINOIS
 CONSTRUCT RUNWAY 33 ILS
 RELOCATE RUNWAY 9 LOCALIZER
 RUNWAY 33 MALSRR PLAN AND PROFILE
 MALSRR STATIONS 0+05 - 11+00
 ARR-D-MALSRR33-C01**

© Copyright CMT, Inc.
CMT
 CRAWFORD, MURPHY & TILLY, INC.
 CONSULTING ENGINEERS
 License No. 184-000613

DESIGN BY:	CAL
DRAWN BY:	JRO
CHECKED BY:	CAL
APPROVED BY:	
DATE:	05/12/06
JOB No:	04285-04
ILLINOIS PROJECT: ARR-3468 A.I.P. PROJECT: 3-17-0003-B31 FINAL SUBMITTAL	