

STORM SEWER SCHEDULE

STRUCTURE NO.	STATION/OFFSET TYPE	STRUCTURE TYPE	RIM	INVERTS
A8	7+45.06, 31' LT TAXIWAY O	ADJUST EXIST. A-6 MH W/ TYPE 1 FRAME AND OPEN LID	EXIST 642.2 PROP 643.33	EXIST 36" (W) = 631.28 36" (E) = 631.28
A9	8+14.57, 31' LT TAXIWAY O	TYPE A-7 MH W/ TYPE 1 FRAME AND OPEN LID	644.01	36" (W) = 631.41 36" (E) = 631.41 15" (N) = 637.65 12" (S) = 637.00
A9A	8+14.57, 41.5' RT TAXIWAY O	TYPE A INLET W/ TYPE 1 FRAME AND OPEN LID	640.72	12" (N) = 637.88
A10	8+84.07, 31' LT TAXIWAY O	TYPE A-6 MH W/ TYPE 1 FRAME AND OPEN LID	643.33	36" (W) = 631.54 36" (E) = 631.54
A11	9+53.57, 31' LT TAXIWAY O	TYPE A-7 MH W/ TYPE 1 FRAME AND OPEN LID	644.01	36" (W) = 631.66 30" (E) = 631.66 15" (N) = 637.65
A12	10+23.07, 31' LT TAXIWAY O	TYPE A-6 MH W/ TYPE 1 FRAME AND OPEN LID	643.33	30" (W) = 631.79 30" (E) = 631.79 12" (S) = 636.50
A12A	10+23.07, 41.5' RT TAXIWAY O	TYPE B INLET W/ TYPE 1 FRAME AND OPEN LID	640.72	12" (N) = 637.18
A12B	9+53.57, 41.5' RT TAXIWAY O	TYPE A INLET W/ TYPE 1 FRAME AND OPEN LID	640.72	12" (E) = 637.85
A13	10+92.57, 31' LT TAXIWAY O	TYPE A-6 MH W/ TYPE 1 FRAME AND OPEN LID	644.01	30" (W) = 631.91 30" (E) = 631.91 15" (N) = 637.65
A14	11+62.07, 31' LT TAXIWAY O	TYPE A-6 MH W/ TYPE 1 FRAME AND OPEN LID	643.33	30" (W) = 632.04 30" (E) = 632.04 12" (S) = 636.50
A14A	11+62.07, 41.5' RT TAXIWAY O	TYPE B INLET W/ TYPE 1 FRAME AND OPEN LID	640.00	12" (N) = 637.18
A14B	12+31.57, 41.5' RT TAXIWAY O	TYPE A INLET W/ TYPE 1 FRAME AND OPEN LID	640.00	12" (W) = 637.85
A15	12+31.57, 31' LT TAXIWAY O	TYPE A-6 MH W/ TYPE 1 FRAME AND OPEN LID	644.01	30" (W) = 632.16 30" (E) = 632.16 15" (N) = 637.65
A16	13+01.57, 31' LT TAXIWAY O	TYPE A-6 MH W/TYPE 1 FRAME AND OPEN LID	644.49	30" (W) = 632.29
D1	8+14.57, 84.5' LT TAXIWAY O	TYPE 1 INLET	644.01	15" (S) = 638.14 15" (N) = 638.14
D2	8+14.57, 179.25' LT TAXIWAY O	TYPE 1 INLET	644.01	15" (S) = 639.05 15" (N) = 639.05
D3	8+14.57, 274' LT TAXIWAY O	TYPE 1 INLET	644.01	15" (S) = 639.97 12" (E) = 639.97
D4	8+84.07, 274' LT TAXIWAY O	TYPE A INLET W/ TYPE 1 FRAME AND OPEN LID	643.40	12" (W) = 640.65
E1	9+53.57, 84.5' LT TAXIWAY O	TYPE 1 INLET	644.01	15" (S) = 638.14 15" (N) = 638.14
E2	9+53.57, 179.25' LT TAXIWAY O	TYPE 1 INLET	644.01	15" (S) = 639.05 15" (N) = 639.05
E3	9+53.57, 274' LT TAXIWAY O	TYPE 1 INLET	644.01	15" (S) = 639.97 12" (E) = 639.97
E4	10+23.07, 274' LT TAXIWAY O	TYPE A INLET W/ TYPE 1 FRAME AND OPEN LID	643.40	12" (W) = 640.65
E5	10+30.00, 325' LT TAXIWAY O	TYPE A4 MANHOLE W/ TYPE 1 FRAME AND CLOSED LID	644.23	12" (N) = 630± 12" (S) = 630±
F1	10+92.57, 84.5' LT TAXIWAY O	TYPE 1 INLET	644.01	15" (S) = 638.14 15" (N) = 638.14
F2	10+92.57, 179.25' LT TAXIWAY O	TYPE 1 INLET	644.01	15" (S) = 639.05 15" (N) = 639.05
F3	10+92.57, 274' LT TAXIWAY O	TYPE 1 INLET	644.01	15" (S) = 639.97 12" (E) = 639.97
F4	11+62.07, 274' LT TAXIWAY O	TYPE A INLET W/ TYPE 1 FRAME AND OPEN LID	643.40	12" (W) = 640.65
G1	12+31.57, 84.5' LT TAXIWAY O	TYPE 1 INLET	644.01	15" (S) = 638.14 15" (N) = 638.14
G2	12+31.57, 179.25' LT TAXIWAY O	TYPE 1 INLET	644.01	15" (S) = 639.05 15" (N) = 639.05
G3	12+31.57, 274' LT TAXIWAY O	TYPE 1 INLET	644.01	15" (S) = 639.97 12" (E) = 639.97
I1	402+86.15, 145' RT TAXIWAY L	REPLACE EXIST MH W/ TYPE A-7 MH W/ TYPE 1 FRAME AND OPEN LID	638.85	EXIST 30" (S) = 632.13 42" (W) = 632.30
I2	401+07.22, 124' LT TAXIWAY L	TYPE A-5 MH W/ TYPE 1 FRAME AND OPEN LID	639.11	42" (E) = 632.94
H1	414+57.82, 45' RT TAXIWAY L	RECONSTRUCT EXIST. A-5 MH	EXIST 642.13 PROP 639.30	EXIST 36" (N) = 632.66 EXIST 36" (S) = 632.78 EXIST 18" (E) = 632.89 18" (W) = 634.00 18" (E) = 636.80
H2	414+57.82, 75' LT TAXIWAY L	18" SLOPE BOX INLET	N/A	18" (E) = 636.80
H3	415+84, 45' RT TAXIWAY L	RECONSTRUCT EXIST MH	EXIST 637.52 PROP 639.35	
H4	411+85, 45' RT TAXIWAY L	ADJUST EXIST MH	EXIST 640.98 PROP 640.51	
H5	411+85, 45' LT TAXIWAY L	ADJUST EXIST MH	EXIST 641.60 PROP 640.41	
H6	410+50, 45' RT TAXIWAY L	ADJUST EXIST MH	EXIST 640.87 PROP 641.20	
H7	404+67, 45' RT TAXIWAY L	ADJUST EXIST MH	EXIST 641.68 PROP 640.78	
H8	405+62, 42' LT TAXIWAY L	TYPE A-4 MH W/ TYPE 1 FRAME AND OPEN LID	641.14	EXIST. 18" (W) = 635.4 EXIST 18" (E) = 635.4 18" (S) = 635.60 18" (N) = 637.95
H9	405+00.95, 95' LT TAXIWAY L	18" SLOPE BOX INLET	N/A	18" (N) = 637.95
H10	400+00, 120' RT TAXIWAY L	ADJUST EXIST MH	EXIST 641.61 PROP 640.19	

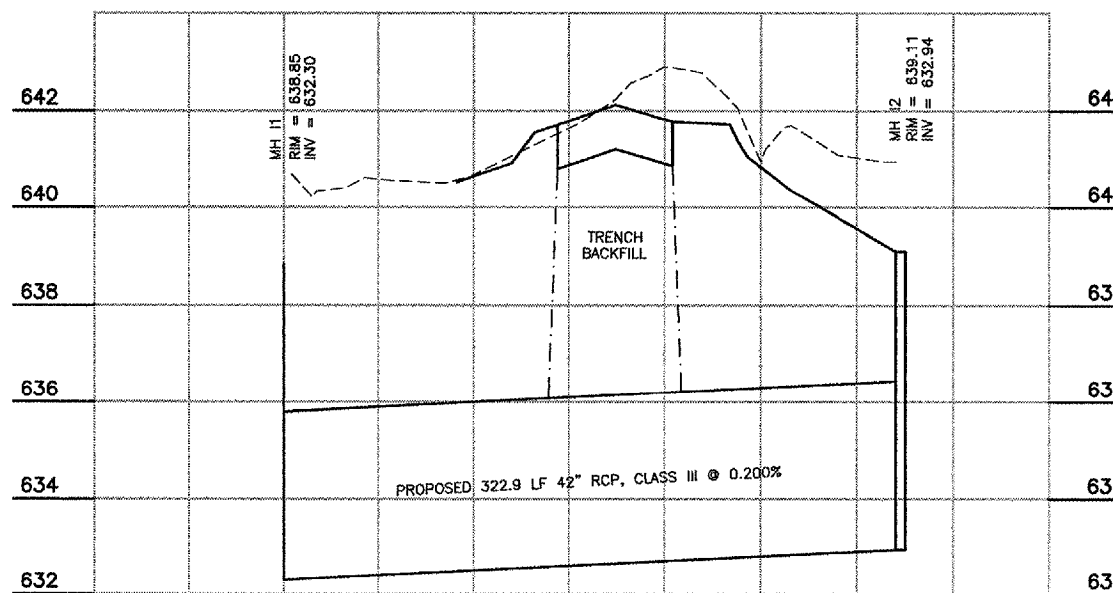

TRUNK I

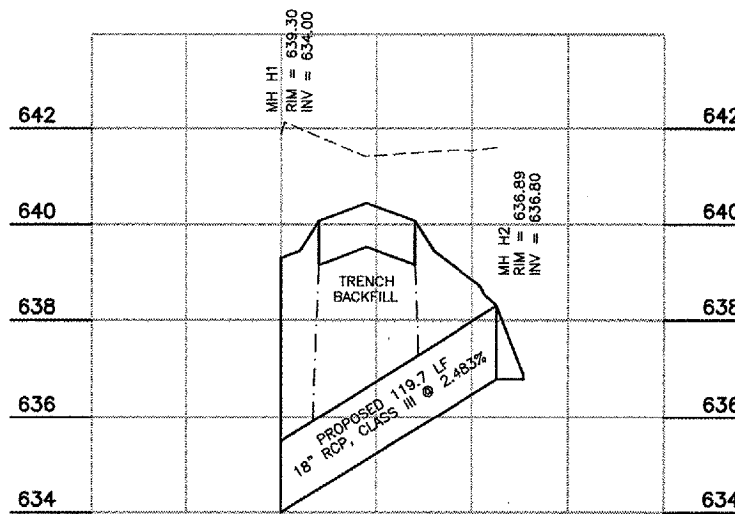

LATERAL H1

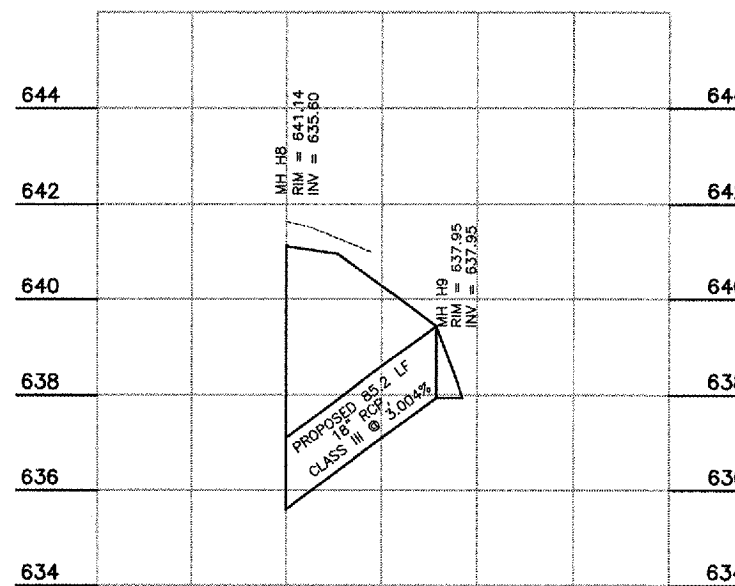

LATERAL H9

PA050

PATH: K:\0329702\draw\sheets\
FILE: ty-ssprofile1.dwg
UPDATE BY: johse
SURVEY BOOK #
XREF DWG:
XREF DWG:
DATE: Sun 3/28/04 9:02am

REVISIONS

NUMBER	BY	DATE

0 1 2
THIS BAR IS EQUAL TO 2"
AT FULL SCALE (34X22).

PALWAUKEE MUNICIPAL AIRPORT
WHEELING/PROSPECT HEIGHTS, ILLINOIS

STORM SEWER PROFILES
SHEET 1

© Copyright CMT, Inc.
CMT
CRAWFORD, MURPHY & TILLY, INC.
CONSULTING ENGINEERS
License No. 784-000613
Palwaukee Municipal Airport

DESIGN BY: ARM
DRAWN BY: JRO
CHECKED BY:
APPROVED BY:
DATE: 06/29/06
JOB No: 06290-07
ILLINOIS PROJECT: PWK-3613
A.I.P. PROJECT: 3-17-0018-B39
SHEET 19 OF 40 SHEETS