

NUMBER	BY	DATE

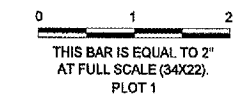

PHASE #2 NOTES

1. THE CONTRACTOR SHALL MOVE ALL WORKING OPERATIONS 115' AWAY FROM THE TEMPORARY CENTERLINE OF TXY T WHEN AN AIRCRAFT WITH A WINGSPAN GREATER THAN 100' IS PRESENT ON THE TAXIWAY. THE AIRPORT DIRECTOR HAS SOLE AUTHORITY TO DETERMINE WHEN SUCH GROUP IV AIRCRAFT MUST USE TXY T, AND WILL NOTIFY THE CONTRACTOR.
2. TEMPORARILY REMARK TAXIWAY T AS SHOWN IN DETAIL "A". ALL TEMPORARY PAVEMENT MARKING AND PAVEMENT MARKING REMOVAL WILL BE PAID AT THE CONTRACT UNIT PRICE FOR EACH ITEM.
3. SUBPHASE 2A AND SUBPHASE 2B SHALL NOT BE COMPLETED SIMULTANEOUSLY. WHEN WORKING IN SUBPHASE 2A, TAXIWAY D SHALL BE OPENED FOR APRON ACCESS TO AIRCRAFT TRAFFIC. WHEN WORKING IN SUBPHASE 2B, TAXIWAY T SHALL BE OPENED TO AIRCRAFT TRAFFIC.
4. THE BITUMINOUS PAVEMENT REMOVAL AND REPLACEMENT SHALL BE COORDINATED WITH THE AIRPORT AND THE FBO. THE INITIAL LIFT OF BITUMINOUS SHALL BE PLACED THE SAME DAY THE MILLING IS COMPLETED. THIS WORK SHALL NOT BE COMPLETED WHEN THE APRON ACCESS IS LIMITED UNDER PHASES 2A OR 2B.
5. REPAIRS TO APRON AND NECESSARY CLOSURES SHALL BE COORDINATED WITH AIRPORT AND FBO.
6. THE CONTRACTOR SHALL MAINTAIN ALL EDGE LIGHTING, NAVAID AND OTHER CIRCUITS WHEN INSTALLING NEW DUCT BANK ADJACENT TO TAXIWAY D. PRIOR TO STARTING WORK IN THESE AREAS THE CONTRACTOR SHALL LOCATE AND MARK EXISTING CABLES IN EACH MANHOLE, CONDUIT OF MULTI-BANK DUCT AND DIRECT BURY. WORK WITHIN 115' OF TAXIWAYS D & E WILL BE ALLOWED WITHOUT CLOSURE OF THE TAXIWAY, BUT THE CONTRACTOR SHALL CLEAR THE TAXIWAY SAFETY AREA FOR AIRCRAFT.
7. THE CONTRACTOR SHALL REMOVE TEMPORARY ACCESS ROADWAYS NOT NECESSARY FOR SUBSEQUENT PHASES FROM PHASE 2 AREA AT THE COMPLETION OF THIS PHASE.

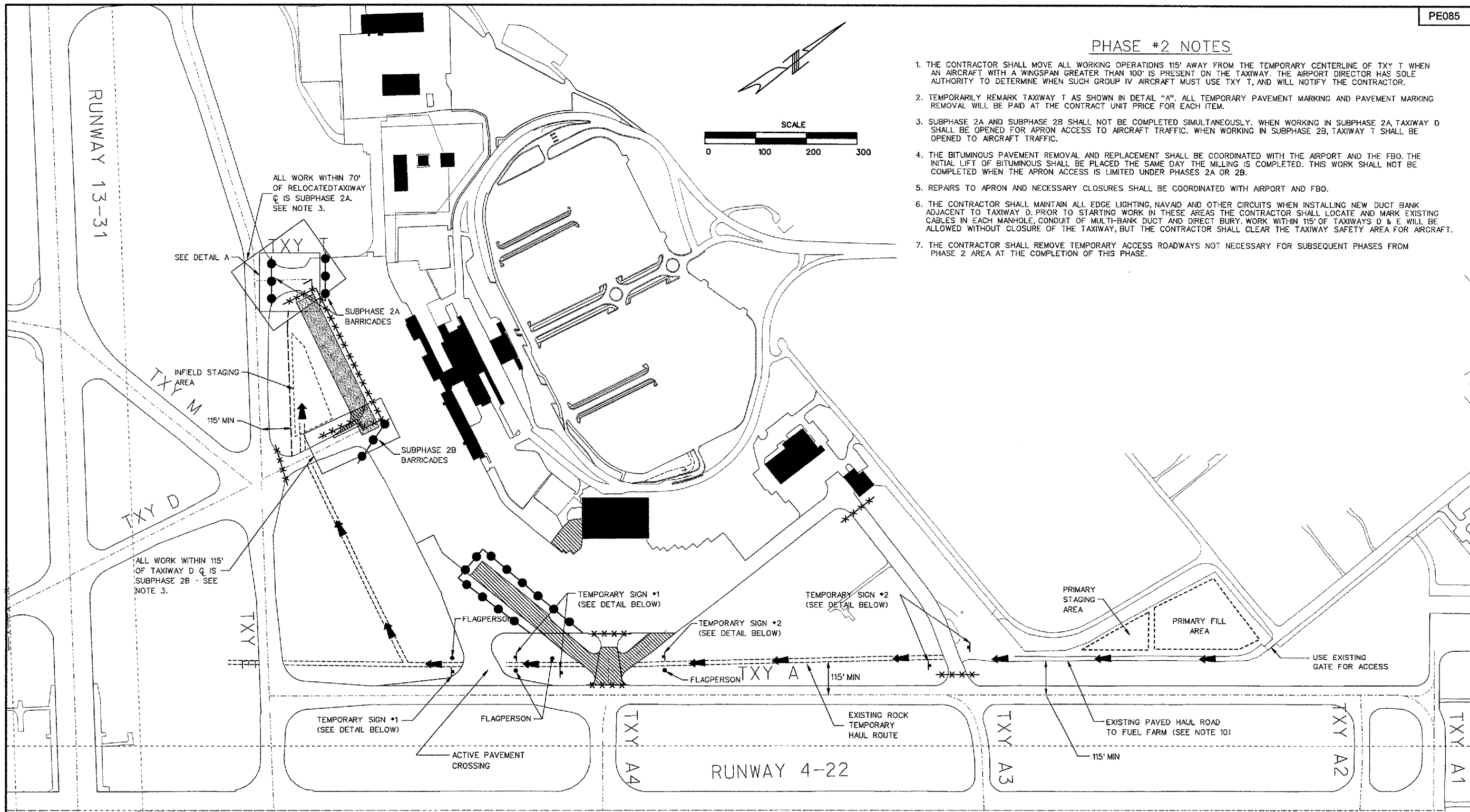
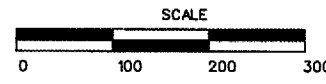

RELOCATE TAXIWAY A AND D FROM MID-FIELD INTERSECTION PHASE 2



CMT
CRAWFORD, MURPHY & TILLY, INC.
CONSULTING ENGINEERS



IL PROJECT: PIA-3616
AIP PROJ: 3-17-0080-XX

FILE: ...cap_2.dgn
DESIGN BY: EWS
DRAWN BY: CAG
CHECKED BY: TCS
APPROVED BY: CET
DATE: JUNE 30, 2006
JOB No: 04061-03-02

CONSTRUCTION ACTIVITY PLAN
PHASE 2 OF 5

DETAIL A TEMPORARY MARKING

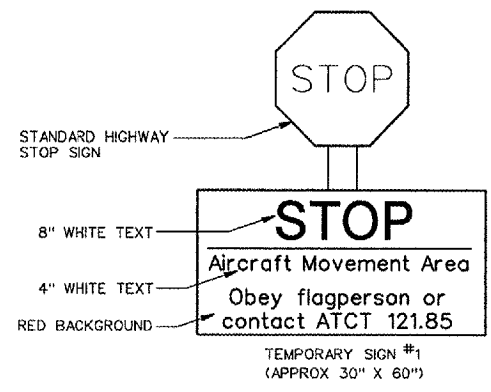
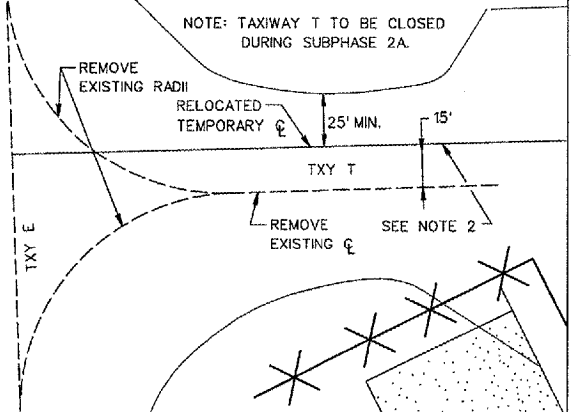

LEGEND

- PROPOSED PHASE 1 WORK AREA
- FLASHING BARRICADE LINE (WORKING HOURS ONLY SPACED AT 15' CENTER TO CENTER)
- FLASHING BARRICADE LINE (SPACED AT 15' CENTER TO CENTER)
- TEMPORARY HAUL ROUTE
- FLAGPERSON
- TEMPORARY SIGN
- LATHE LINE
- CONTRACTOR'S STAGING AREA
- CONTRACTOR'S ACCESS ROUTE

7/13/2006 k:\peoria\040610302\draw\models\cap_2.dgn