

NUMBER	BY	DATE

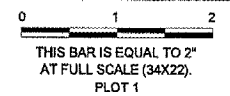

PHASE #3 NOTES

1. THE CONTRACTOR SHALL HAVE NO MORE THAN 18 CONSECUTIVE CALENDAR DAYS TO COMPLETE THE WORK THAT REQUIRES RUNWAY CLOSURE IN THIS PHASE.
2. ALL WORK WITHIN 250' OF THE RUNWAY 13-31 CENTERLINE, BUT OUTSIDE OF 250' FROM RUNWAY 4-22 SHALL BE ACCOMPLISHED UNDER SUBPHASE 3A. THE CONTRACTOR SHALL HAVE NO MORE THAN 12 CONSECUTIVE CALENDAR DAYS TO COMPLETE THE WORK IN SUBPHASE 3A. ALL WORK WITHIN SUBPHASE 3A WILL REQUIRE THE CLOSURE OF RUNWAY 13-31. PRIOR TO THE INITIATION OF WORK IN SUBPHASE 3A THE CONTRACTOR SHALL INSTALL THE LIGHTED RUNWAY CLOSURE MARKERS ON BOTH ENDS OF RUNWAY 13-31. THE CONTRACTOR SHALL ALSO INSTALL ALL LIGHTED BARRICADES AS SHOWN. THE CONTRACTOR SHALL REQUEST CLOSURE AT LEAST 48 HOURS PRIOR TO CLOSING THE RUNWAY AND TAXIWAYS.
3. ALL WORK WITHIN 250' OF RUNWAY 13-31 AND RUNWAY 4-22 SHALL BE ACCOMPLISHED DURING SUBPHASE 3B. BOTH RUNWAYS 13-31 AND 4-22 SHALL BE CLOSED WHILE THE CONTRACTOR IS WORKING WITHIN SUBPHASE 3B. PRIOR TO INITIATION OF WORKING SUBPHASE 3B, THE CONTRACTOR SHALL INSTALL RUNWAY CLOSURE MARKERS ON BOTH ENDS OF RUNWAYS 13-31 AND 4-22. THE CONTRACTOR SHALL HAVE NO MORE THAN 4 WORK PERIODS TO COMPLETE THE WORK BOTH IN THIS AREA. EACH WORK PERIOD SHALL CONSIST OF AN APPROXIMATE 5-HOUR PERIOD BETWEEN THE HOURS OF 11 P.M. AND 4 A.M., OR OTHER WORK HOURS AS SPECIFIED BY THE AIRPORT. THE CONTRACTOR SHALL COORDINATE WITH THE AIRPORT TO SCHEDULE THE WORK PERIODS AROUND AIR CARRIER AND AIR CARGO OPERATIONS. EACH WORK PERIOD SHALL BE COORDINATED WITH THE AIRPORT A MINIMUM OF 5 DAYS PRIOR TO INITIATION OF THE WORK. AT THE COMPLETION OF EACH WORK PERIOD THE CONTRACTOR SHALL THOROUGHLY CLEAN THE PAVEMENTS TO BE OPENED TO AIRPORT TRAFFIC. THE PAVEMENT SHALL BE INSPECTED AND APPROVED BY AIRPORT OPERATIONS PRIOR TO OPENING TO TRAFFIC. THERE SHALL BE NO DROP-OFFS GREATER THAN 3" AND NO SLOPES GREATER THAN 5% WITHIN 250' OF A RUNWAY CENTERLINE THAT IS TO BE OPENED TO AIRPORT TRAFFIC.
4. TAXIWAY E SHALL BE CLOSED ANY TIME MEN AND EQUIPMENT ARE OPERATING WITHIN 115' OF THE TAXIWAY E CENTERLINE. THE CONTRACTOR SHALL HAVE NO MORE THAN 21 CONSECUTIVE CALENDAR DAYS TO FINISH THE WORK REQUIRING THE CLOSURE OF TAXIWAY E. TAXIWAY E SHALL BE RE-OPENED AT THE CONCLUSION OF EACH WORK DAY.
5. WITH PRIOR APPROVAL FROM THE AIRPORT DIRECTOR THE CONTRACTOR MAY CLOSE RUNWAY 4-22 TO REMOVE AND REPLACE THE PAVEMENT MARKING RUNWAY THRESHOLD BARS. THIS WORK SHALL NOT EXCEED FOUR (4) ADDITIONAL DAYS OF RUNWAY CLOSURE CONSECUTIVE AND SHALL NOT BE ALLOWED WHEN RUNWAY 13-31 IS CLOSED.
6. INSTALLATION OF SUPPLEMENTAL WINDCONES FOR EACH OF THE RUNWAYS SHALL OCCUR DURING A PREVIOUS SCHEDULED RUNWAY CLOSURE.

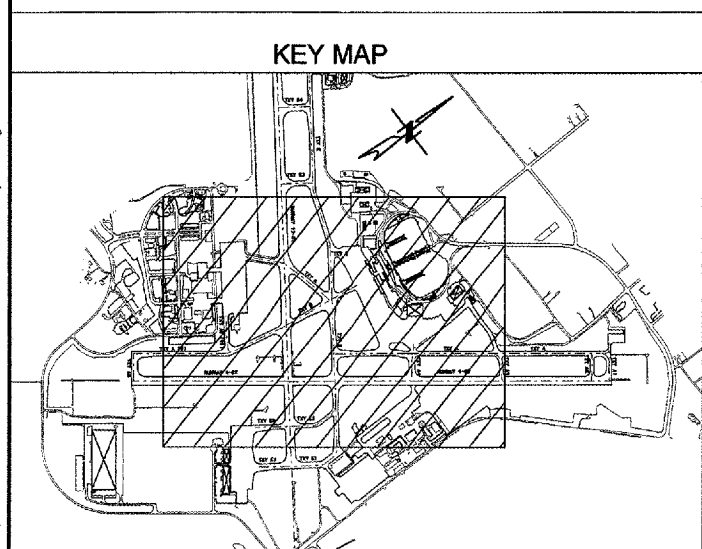
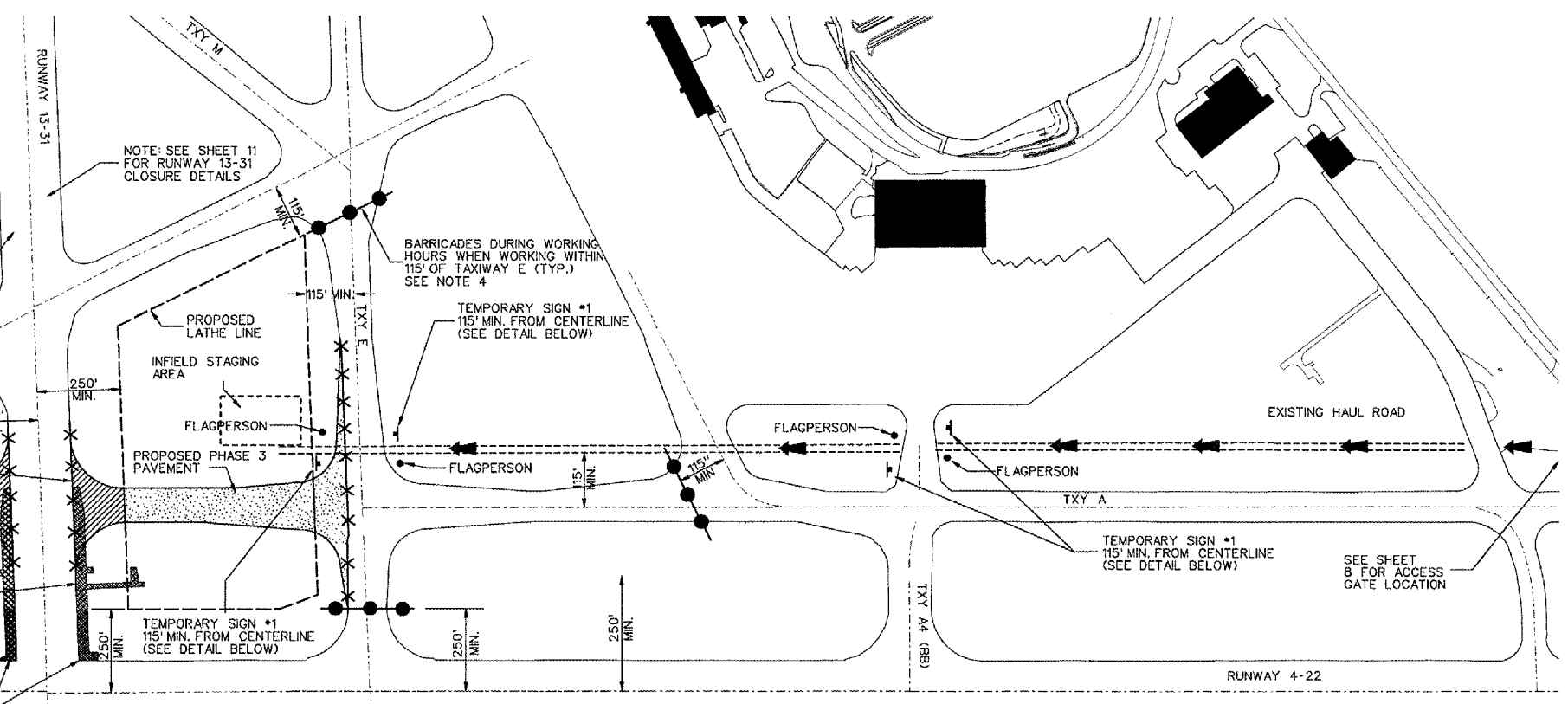
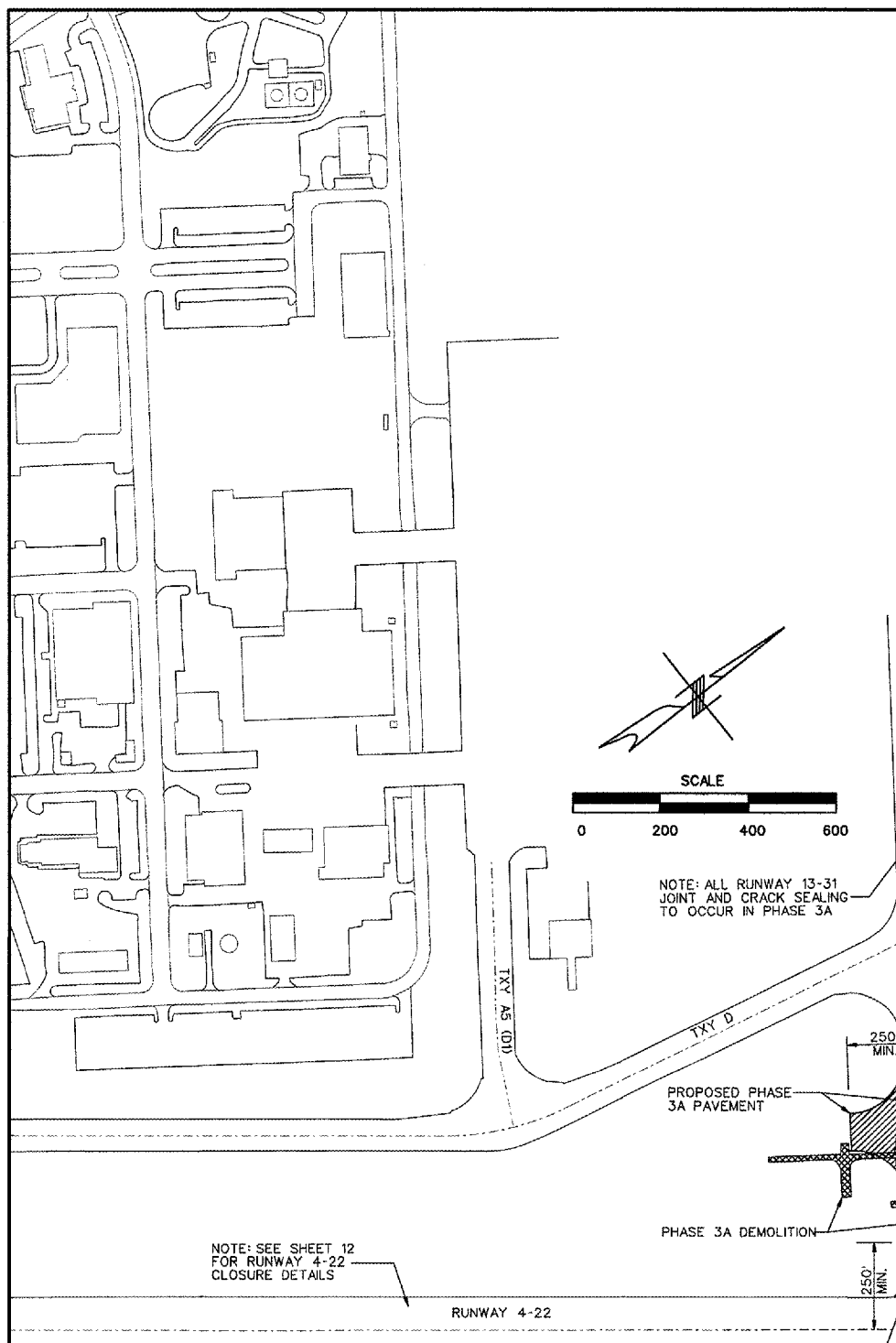

NOTE: BAK REMOVAL WITHIN 250' OF RUNWAY 4-22 RUNWAY CENTERLINE WILL REQUIRE CLOSURE OF BOTH RUNWAYS

LEGEND

- PROPOSED PHASE 3 WORK
- PROPOSED PHASE 3A WORK
- PROPOSED PHASE 3B WORK
- FLASHING BARRICADE LINE (WORKING HOURS ONLY SPACED AT 15' CENTER TO CENTER)
- FLASHING BARRICADE LINE (SPACED AT 15' CENTER TO CENTER)
- TEMPORARY HAUL ROUTE
- FLAGPERSON
- TEMPORARY SIGN
- LATHE LINE
- CONTRACTOR'S STAGING AREA
- CONTRACTOR'S ACCESS ROUTE

GREATER Peoria REGIONAL Airport

RELOCATE TAXIWAY A AND D FROM MID-FIELD INTERSECTION PHASE 2

CMT CRAWFORD, MURPHY & TILLY, INC. CONSULTING ENGINEERS

IL PROJECT: PIA-3616
AIP PROJ: 3-17-0080-XX

FILE: ...lcap_3.dgn

DESIGN BY:

DRAWN BY: CAG

CHECKED BY: TCS

APPROVED BY: CET

DATE: JUNE 30, 2006

JOB No: 04061-03-02

CONSTRUCTION ACTIVITY PLAN PHASE 3 OF 5

SHEET 8 OF 107 SHEETS

7/13/2006 k:\peoria\0406103_03\draw\models\cap_3.dgn