

7/13/2006 k:\peoria\040610302\draw\sheets\016_demo_plan_2.dgn

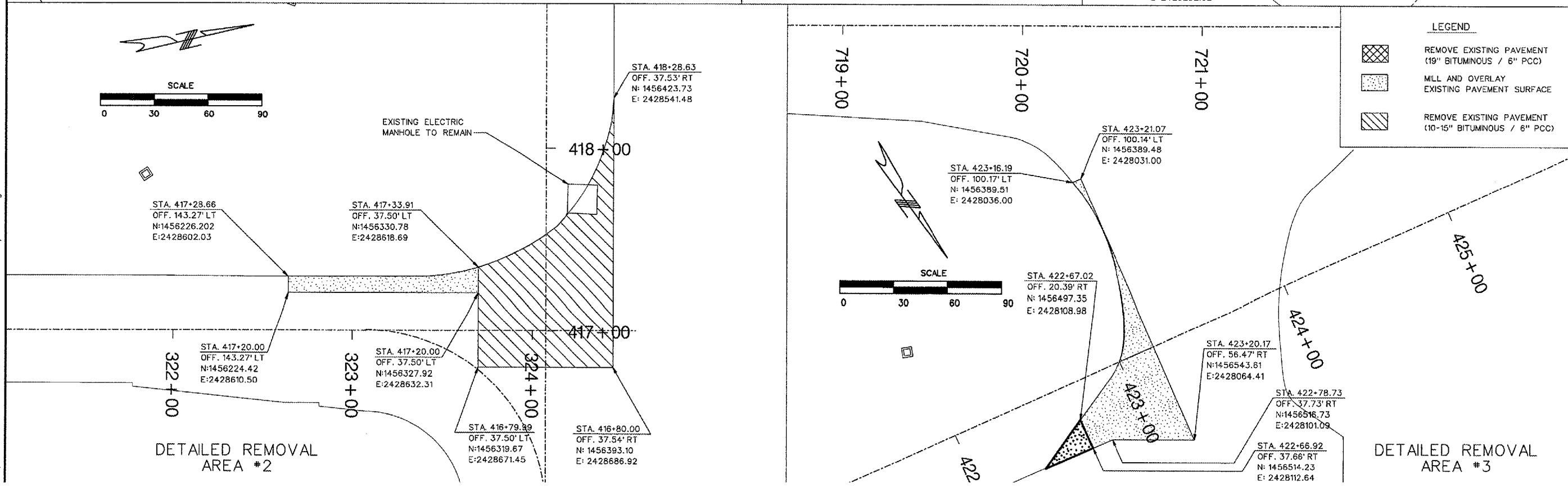
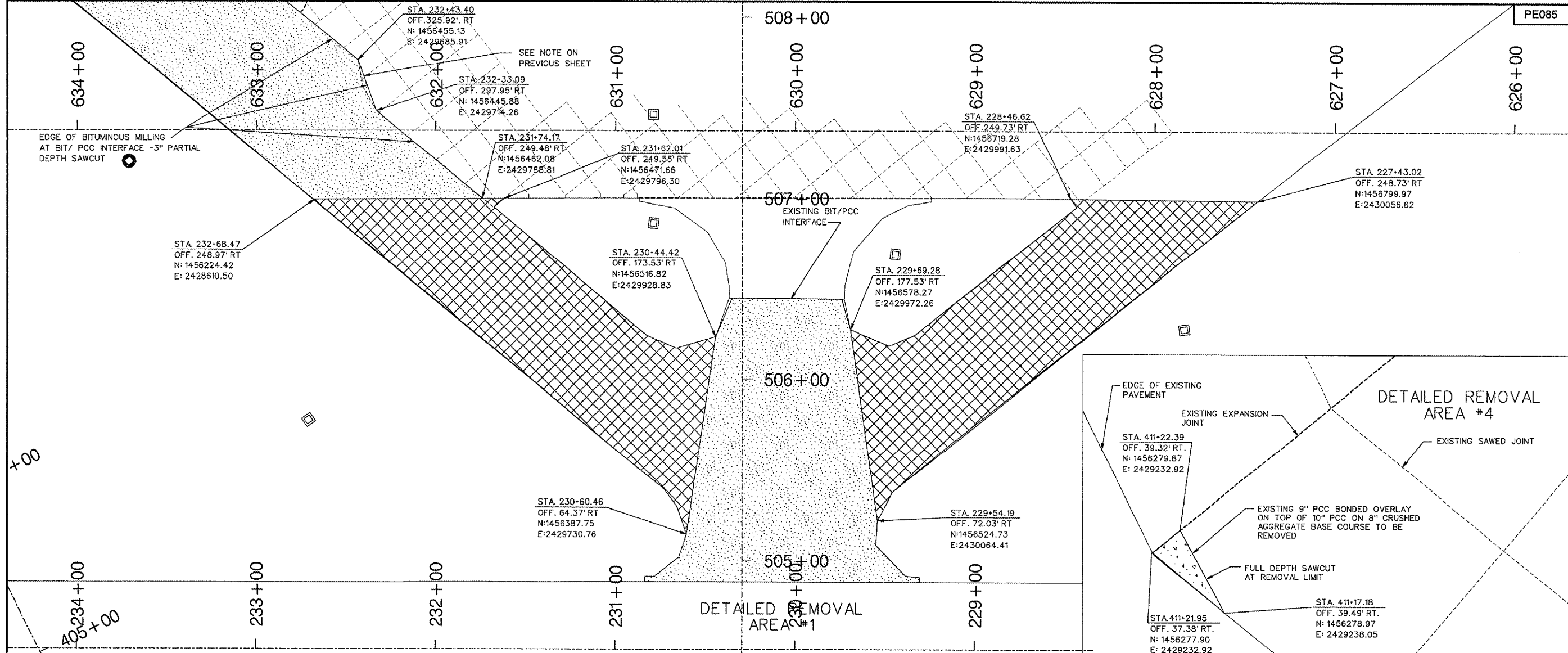

LEGEND

| | |
|--|---|
| | REMOVE EXISTING PAVEMENT (19" BITUMINOUS / 6" PCC) |
| | MILL AND OVERLAY EXISTING PAVEMENT SURFACE |
| | REMOVE EXISTING PAVEMENT (10-15" BITUMINOUS / 6" PCC) |

REVISIONS

| NUMBER | BY | DATE |
|--------|----|------|
| | | |
| | | |
| | | |

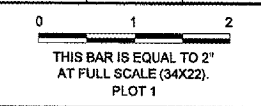

PE085

Greater Peoria Regional Airport

RELOCATE TAXIWAY A AND D FROM MID-FIELD INTERSECTION PHASE 2

CMT
CRAWFORD, MURPHY & TILLY, INC.
CONSULTING ENGINEERS

IL PROJECT: PIA-3616
AIP PROJ: 3-17-0080-XX

| |
|---|
| FILE: ...1016_demo_plan_2.dgn |
| DESIGN BY: TCS |
| DRAWN BY: CAG |
| CHECKED BY: TCS |
| APPROVED BY: CET |
| DATE: JUNE 30, 2006 |
| JOB No: 04061-03-02 |
| DEMOLITION PLAN DETAILS SHEET 1 OF 3 |
| SHEET 16 OF 107 SHEETS |