

REVISIONS		
NUMBER	BY	DATE

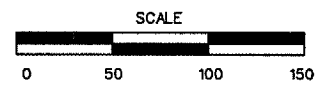

0 1 2
 THIS BAR IS EQUAL TO 2'
 AT FULL SCALE (34X22).
 PLOT 1

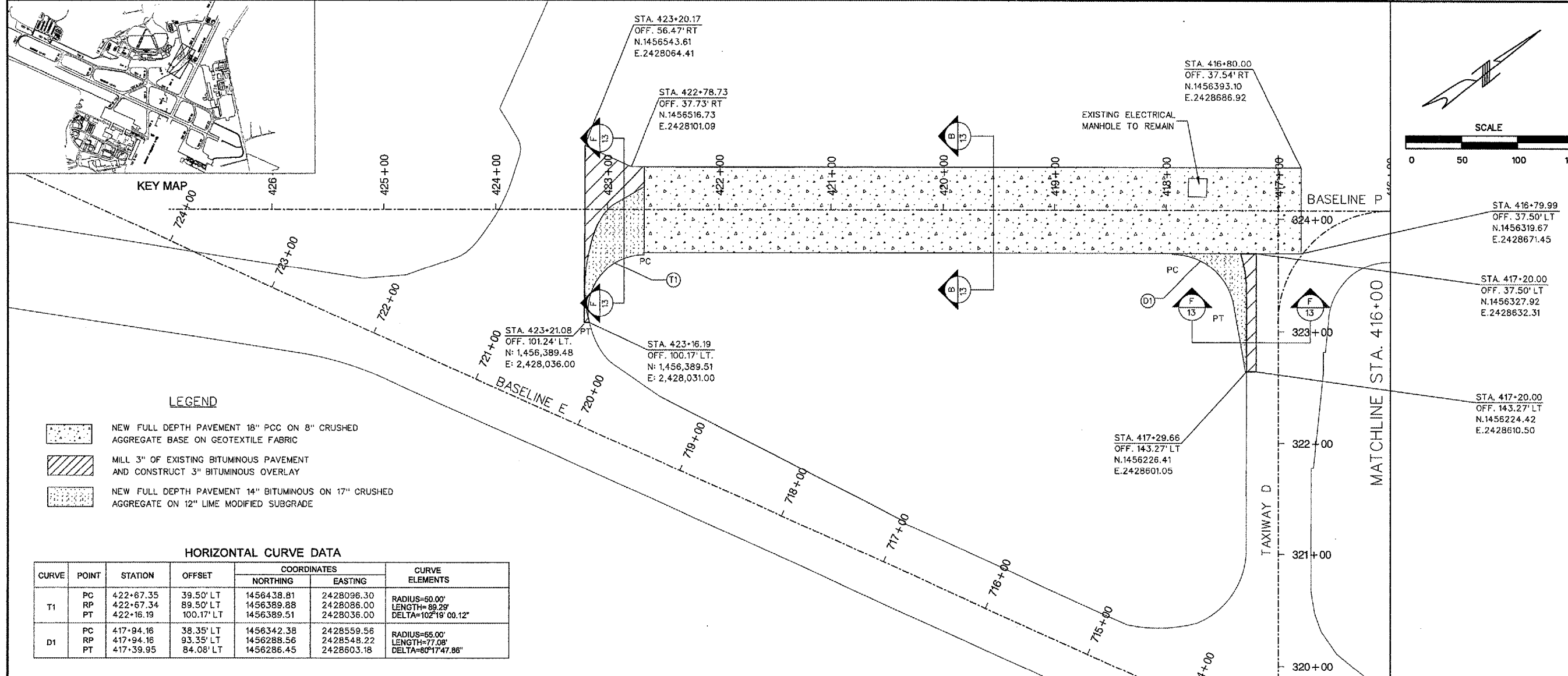

LEGEND

- NEW FULL DEPTH PAVEMENT 18" PCC ON 8" CRUSHED AGGREGATE BASE ON GEOTEXTILE FABRIC
- MILL 3" OF EXISTING BITUMINOUS PAVEMENT AND CONSTRUCT 3" BITUMINOUS OVERLAY
- NEW FULL DEPTH PAVEMENT 14" BITUMINOUS ON 17" CRUSHED AGGREGATE ON 12" LIME MODIFIED SUBGRADE

HORIZONTAL CURVE DATA

CURVE	POINT	STATION	OFFSET	COORDINATES		CURVE ELEMENTS
				NORTHING	EASTING	
T1	PC	422+67.35	39.50' LT	1456438.81	2428096.30	RADIUS=50.00' LENGTH=89.29' DELTA=102°19'00.12"
	RP	422+67.34	89.50' LT	1456389.88	2428086.00	
	PT	422+16.19	100.17' LT	1456389.51	2428036.00	
D1	PC	417+94.16	38.35' LT	1456342.38	2428559.56	RADIUS=65.00' LENGTH=77.08' DELTA=60°17'47.86"
	RP	417+94.16	93.35' LT	1456288.56	2428548.22	
	PT	417+39.95	84.08' LT	1456286.45	2428603.18	

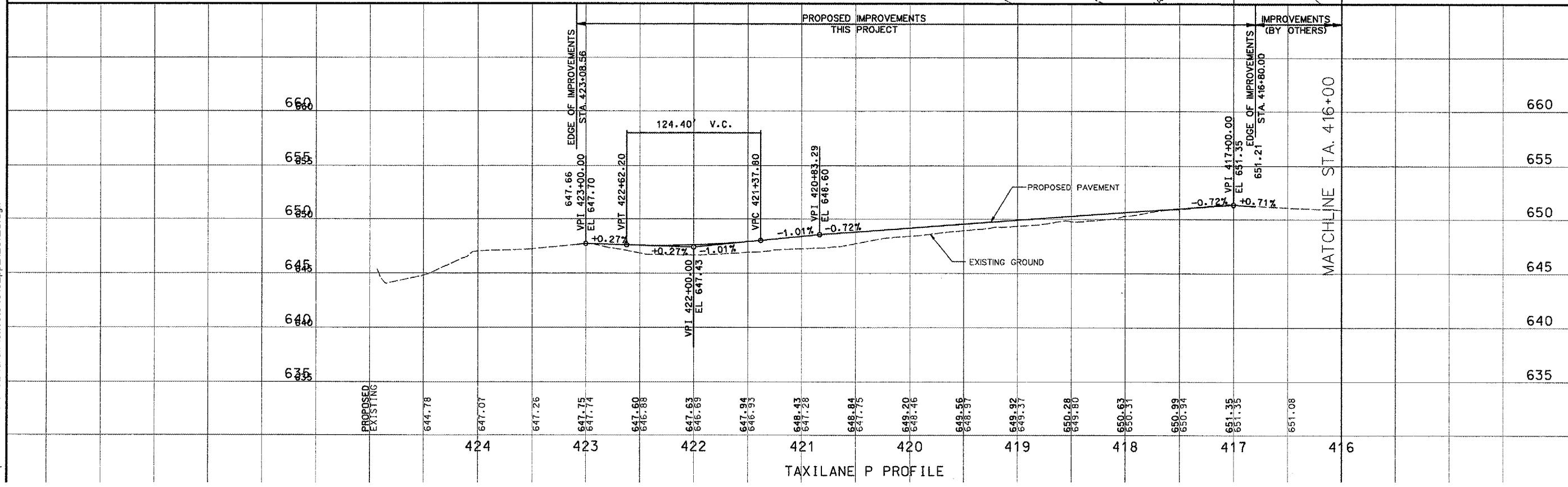

RELOCATE TAXIWAY A AND D FROM MID-FIELD INTERSECTION PHASE 2

Greater Peoria Regional Airport

CMT
 CRAWFORD, MURPHY & TILLY, INC.
 CONSULTING ENGINEERS

660	EDGE OF IMPROVEMENTS STA. 423+08.56	IMPROVEMENTS (BY OTHERS)	660
655			655
650			650
645			645
640			640
635			635

TAXIWAY P PROFILE

MATCHLINE STA. 416+00

IL PROJECT: PIA-3616
 AIP PROJ: 3-17-0080-XX

FILE: ...019_pp_1_of_3.dgn

DESIGN BY: BWG

DRAWN BY: CAG

CHECKED BY: TCS

APPROVED BY: CET

DATE: JUNE 30, 2006

JOB No: 04061-03-02

PLAN AND PROFILE SHEET 1 OF 5

SHEET 19 OF 107 SHEETS

7/13/2006 k:\peoria\040610302\draw\sheets\019_pp_1_of_3.dgn