

7/13/2006
 k:\peoria\040610302\draw\sheets\020_pp_2_of_3.dgn

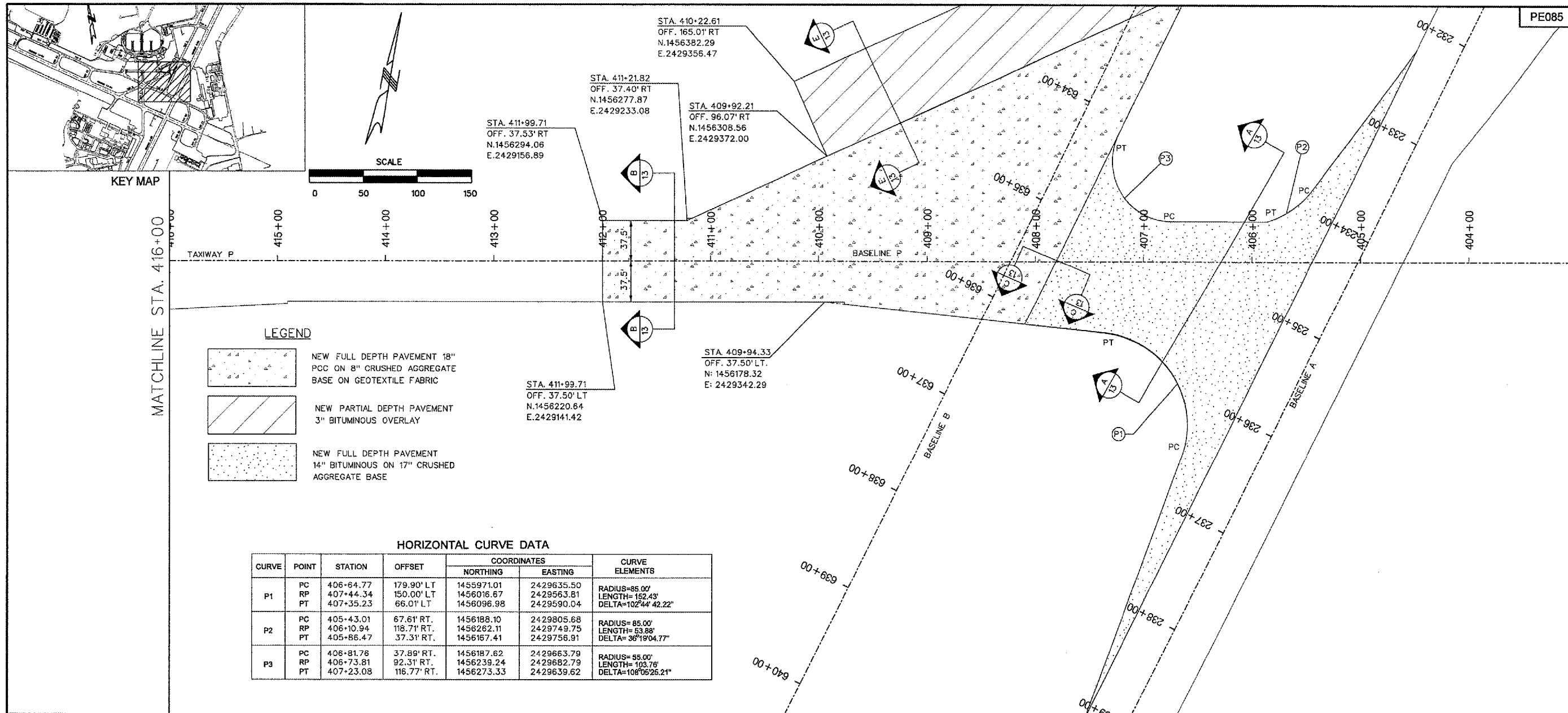

REVISIONS

NUMBER	BY	DATE

0 1 2

THIS BAR IS EQUAL TO 2" AT FULL SCALE (34X22). PLOT 1

PE085

GREATER Peoria REGIONAL Airport

RELOCATE TAXIWAY A AND D FROM MID-FIELD INTERSECTION PHASE 2

CMT CONSULTING ENGINEERS

CRAWFORD, MURPHY & TILLY, INC.

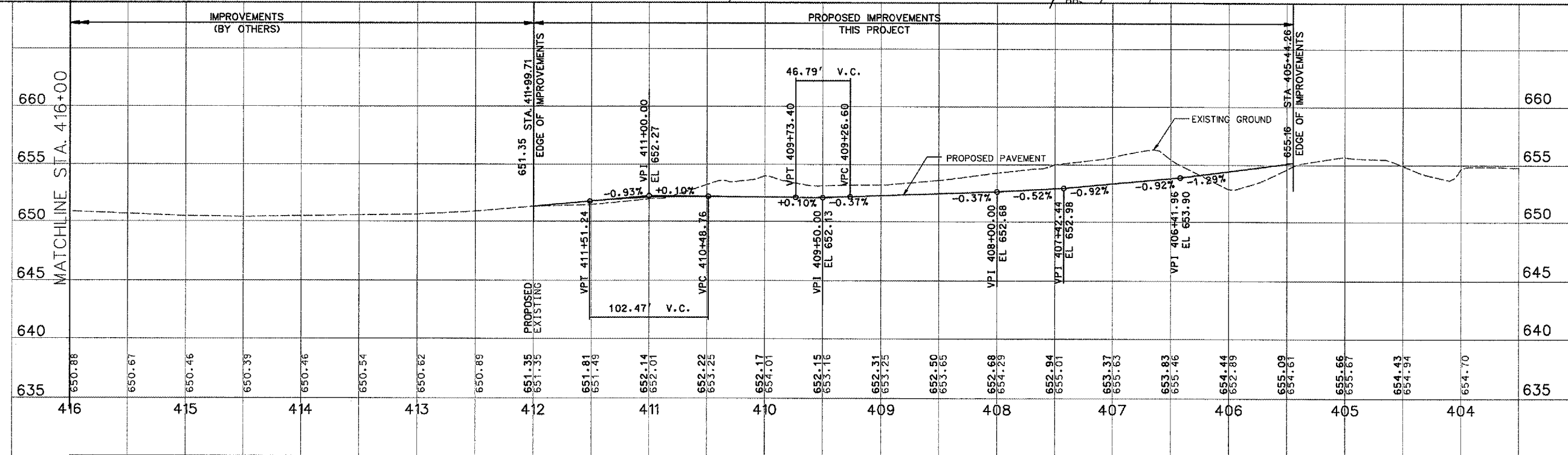

IL PROJECT: PIA-3616
 AIP PROJ: 3-17-0080-XX

FILE: ...020_pp_2_of_3.dgn

DESIGN BY: TCS

DRAWN BY: CAG

CHECKED BY: TCS

APPROVED BY: CET

DATE: JUNE 30, 2006

JOB No: 04061-03-02

PLAN AND PROFILE SHEET 2 OF 5

SHEET 20 OF 107 SHEETS