

PE085

REVISIONS

NUMBER	BY	DATE

0 1 2
 THIS BAR IS EQUAL TO 2"
 AT FULL SCALE (34X22).
 PLOT 1

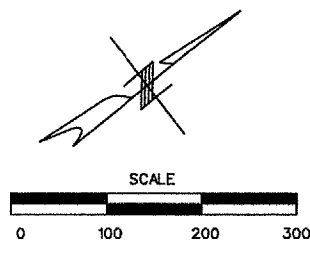
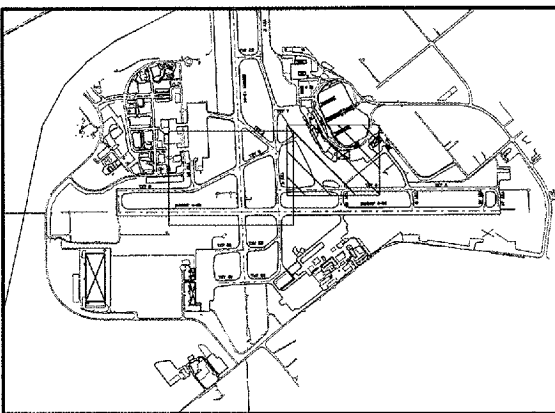

LEGEND

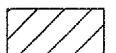
-  REMOVE APPROXIMATELY 3" OF EXISTING BITUMINOUS PAVEMENT (FROM TOP OF PROPOSED PAVEMENT) BY MILLING. ACTUAL MILLING DEPTH SHALL BE AS NECESSARY TO PROVIDE A MINIMUM 3" OVERLAY.
-  MISCELLANEOUS PAVEMENT REPAIRS TO INCLUDE SPALL REPAIR, CRACK ROUTE & SEAL AND PANEL REMOVAL & REPLACEMENT. ACTUAL IMPROVEMENTS TO BE DETERMINED BY RESIDENT ENGINEER IN THE FIELD.

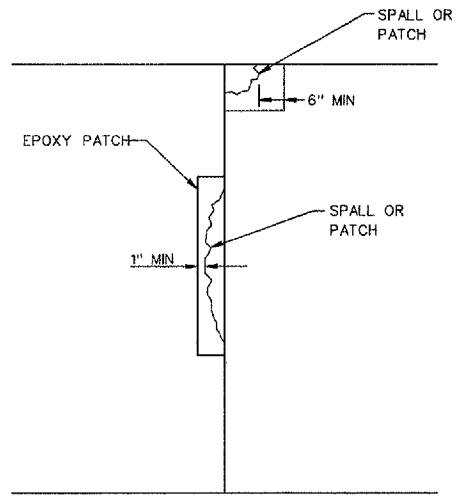

SPALL REPAIR DETAIL

N.T.S.

NOTES

1. SAWCUT SHALL BE AT LEAST 1" FROM EDGE OF SPALL.
2. DEPTH OF CUT SHALL BE AT LEAST 2".
3. CONTRACTOR SHALL NOT OVERSAW.
4. EXACT LOCATION OF SPALL/PATCHES TO BE REPLACED WILL BE DETERMINED IN THE FIELD BY RESIDENT ENGINEER.

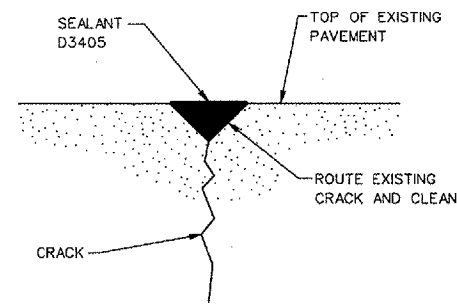

CRACK ROUTE & SEAL DETAIL

N.T.S.

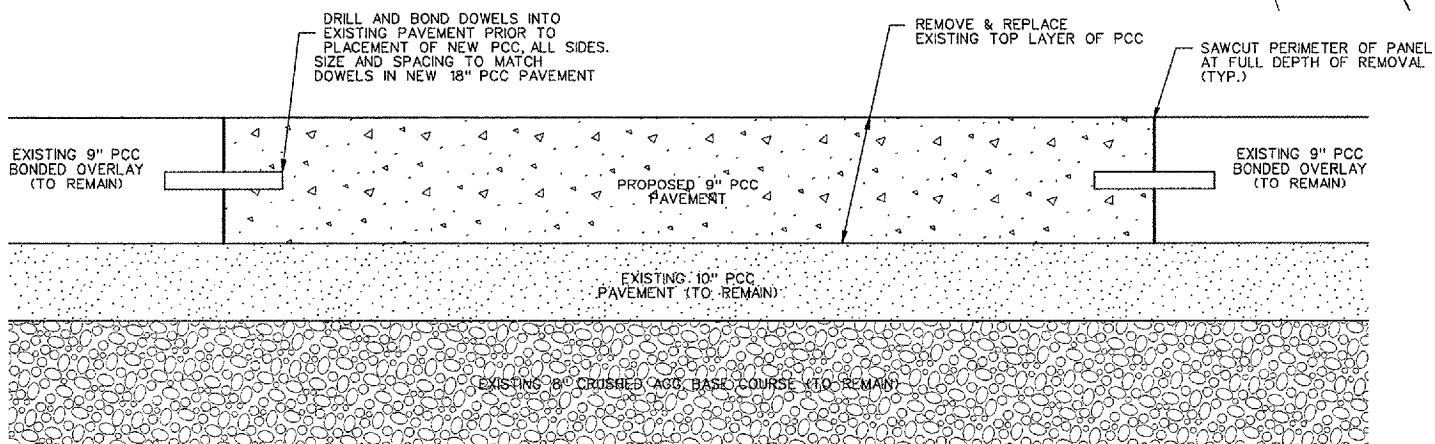

PANEL REMOVAL AND REPLACEMENT - TYPICAL SECTION

N.T.S.

NOTE:

1. PANEL REMOVAL & REPLACEMENT SHALL INCLUDE BOTH FULL AND PARTIAL PCC PANELS.
2. CONTRACTOR SHALL TAKE CARE TO AVOID DAMAGING EXISTING PAVEMENT TO REMAIN. ANY DAMAGE CAUSED BY THE CONTRACTOR'S OPERATIONS SHALL BE REPAIRED AT AN ADDITIONAL COST TO ITS OWNER.

7/13/2006 k:\p\p\p\0406103_03\draw\sheet\03\prop_apron_rehab.dgn

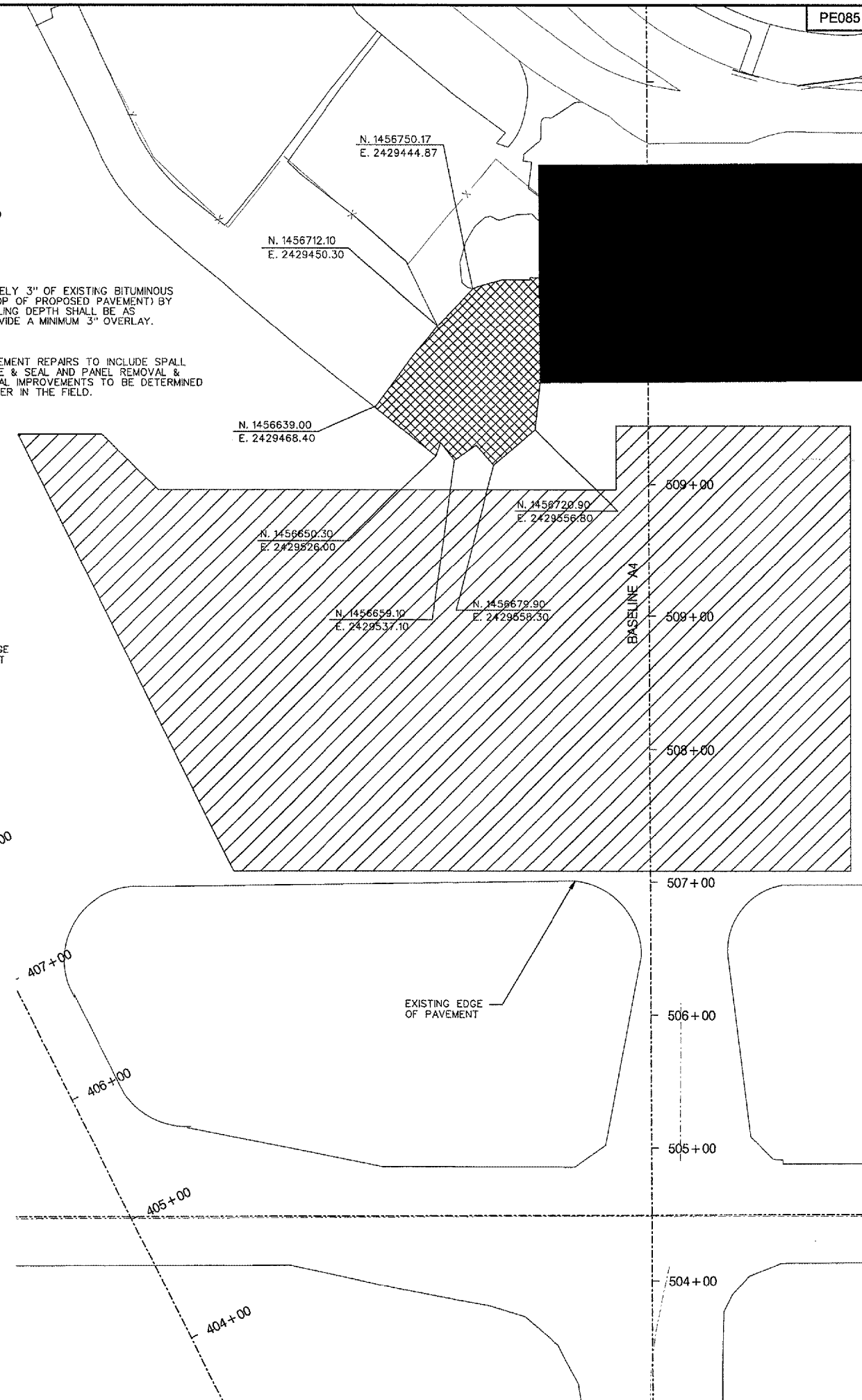

RELOCATE TAXIWAYS A AND D FROM MID-FIELD INTERSECTION PHASE 2



IL PROJECT: PIA-3616
 AIP PROJ: 3-17-0080-XX

FILE: ... \03\prop_apron_rehab.dgn
 DESIGN BY: EWS
 DRAWN BY: EWS
 CHECKED BY: TCS
 APPROVED BY: CET
 DATE: MAY 12, 2006
 JOB No: 04061-03-03

APRON / PARKING LOT REPAIRS

SHEET 24 OF 107 SHEETS