

7/13/2006
 k:\peoria\0406103_03\drawsheets\038-052_xsec_a_sheets.dgn

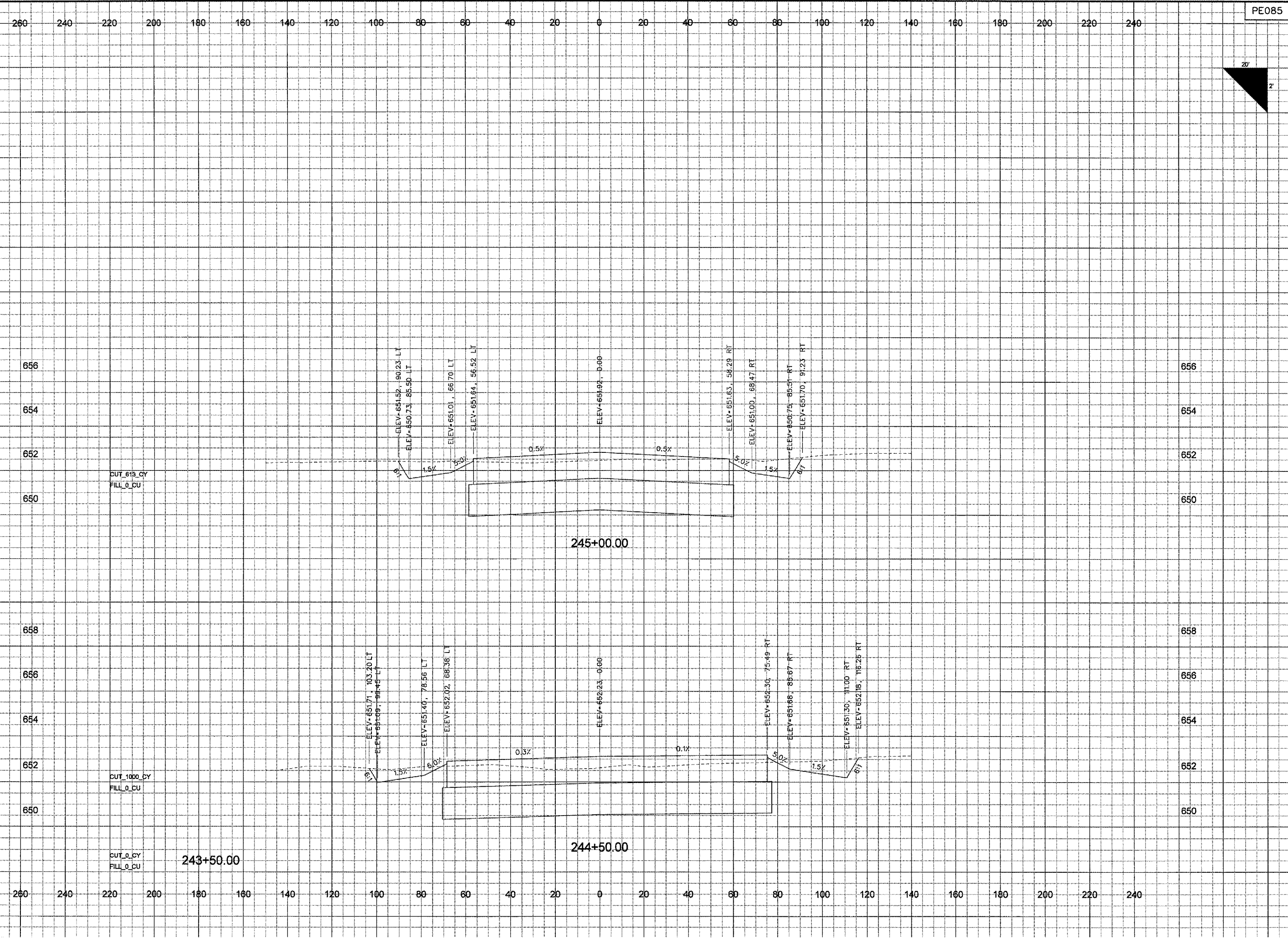

PE085

REVISIONS		
NUMBER	BY	DATE

20'
2'

0 1 2

THIS BAR IS EQUAL TO 2"
 AT FULL SCALE (34X22).
 PLOT 1

GREATER Peoria REGIONAL Airport

RELOCATE TAXIWAYS A AND D FROM MID-FIELD INTERSECTION PHASE 2

CMT
 CRAWFORD, MURPHY & TILLY, INC.
 CONSULTING ENGINEERS

© Copyright CMT, Inc.

IL PROJECT NUMBER PIA-3616
FILE:
DESIGN BY: BWG
DRAWN BY: JSP
CHECKED BY: TCS
APPROVED BY: CET
DATE: MAY 12, 2006
JOB No: 04061-03
CROSS SECTIONS TAXIWAY A SHEET 7 OF 18
SHEET 75 OF 107 SHEETS