

7/13/2006  
c:\peoria\0406103\_03\drawsheets\038-052\_xsec\_a\_sheets.dgn

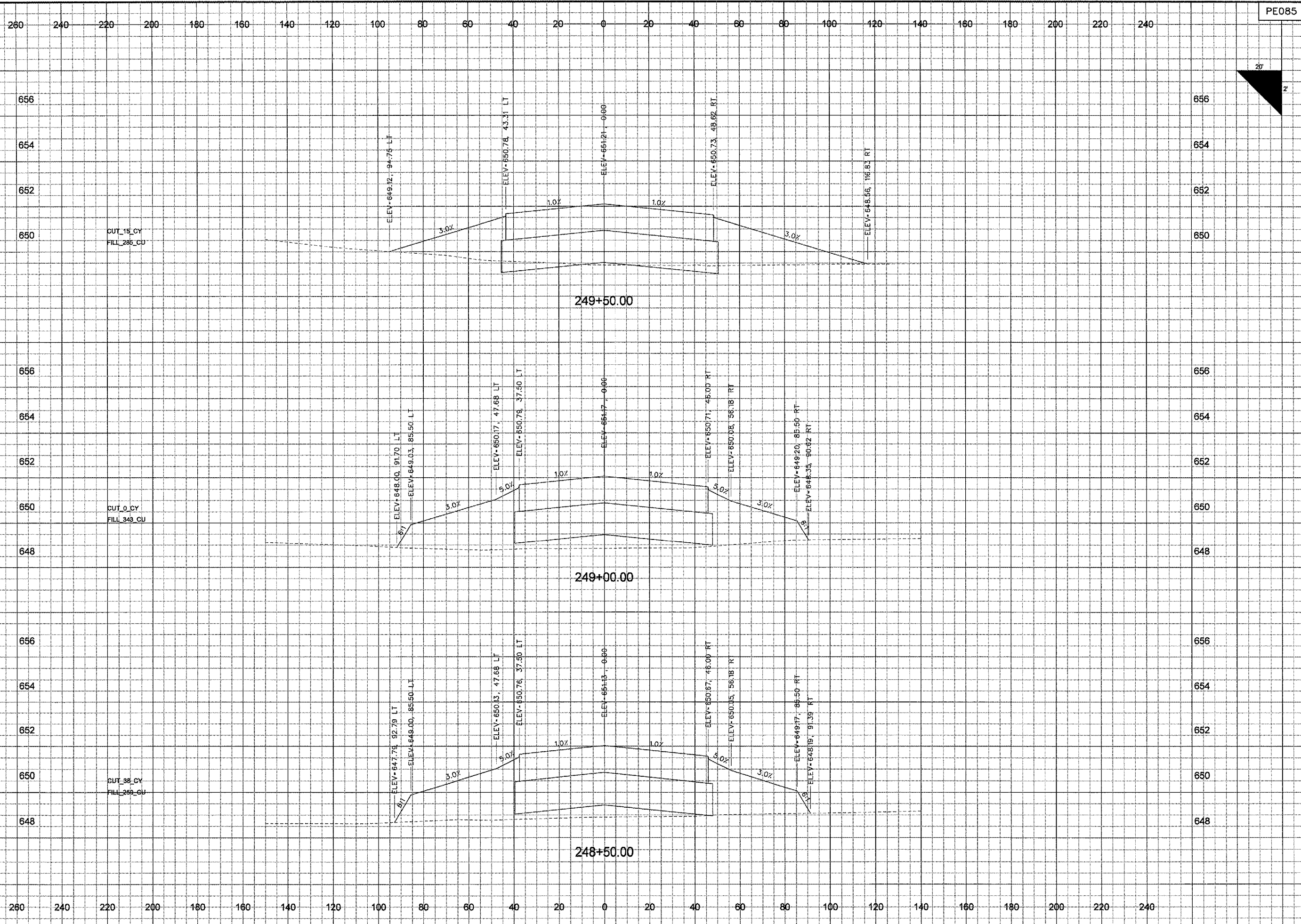

PE085

REVISIONS		
NUMBER	BY	DATE

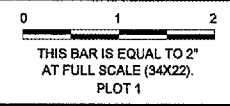

**GREATER Peoria REGIONAL Airport**

**CMT**  
CRAWFORD, MURPHY & TILLY, INC.  
CONSULTING ENGINEERS

**RELOCATE TAXIWAYS A AND D FROM MID-FIELD INTERSECTION PHASE 2**

IL PROJECT NUMBER PIA-3616
FILE:
DESIGN BY: BWG
DRAWN BY: JSP
CHECKED BY: TCS
APPROVED BY: CET
DATE: MAY 12, 2006
JOB No: 04061-03
CROSS SECTIONS TAXIWAY A SHEET 10 OF 18
SHEET 78 OF 107 SHEETS