

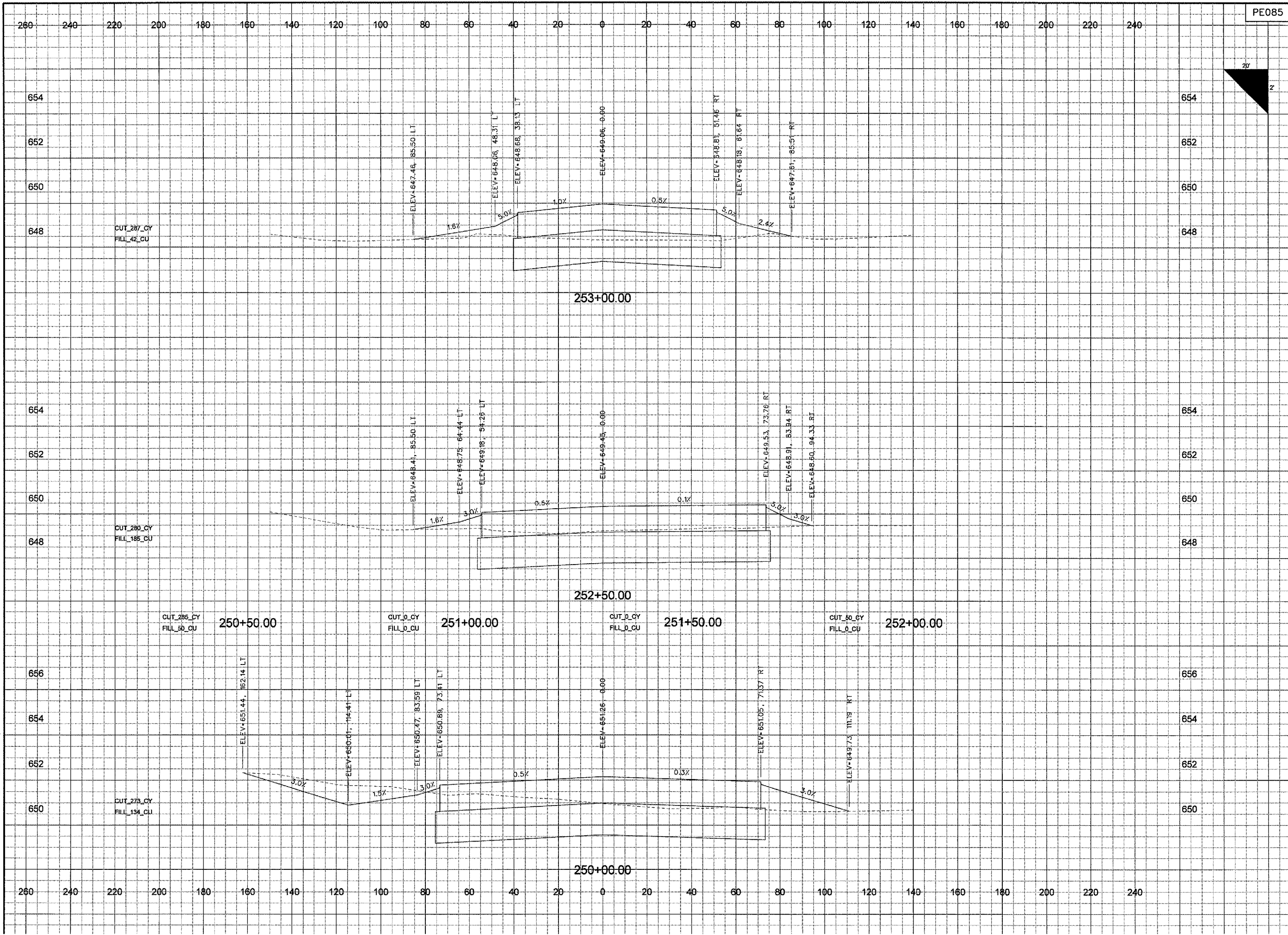

7/13/2006
k:\peoria\0406103_03\drawings\038-052_xsec_a_sheets.dgn

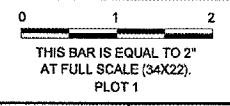

PE085

REVISIONS		
NUMBER	BY	DATE



Greater Peoria Regional Airport

RELOCATE TAXIWAYS A AND D FROM
 MID-FIELD INTERSECTION PHASE 2

CMT
 CRAWFORD, MURPHY & TILLY, INC.
 CONSULTING ENGINEERS
©Copyright CMT, Inc.

IL PROJECT NUMBER PIA-3616
FILE:
DESIGN BY: BWG
DRAWN BY: JSP
CHECKED BY: TCS
APPROVED BY: CET
DATE: MAY 12, 2006
JOB No: 04061-03
CROSS SECTIONS TAXIWAY A SHEET 11 OF 18
SHEET 79 OF 107 SHEETS