

7/13/2006
 k:\peoria\0405103_03\drawsheets\038-052_xsec_a_sheets.dgn

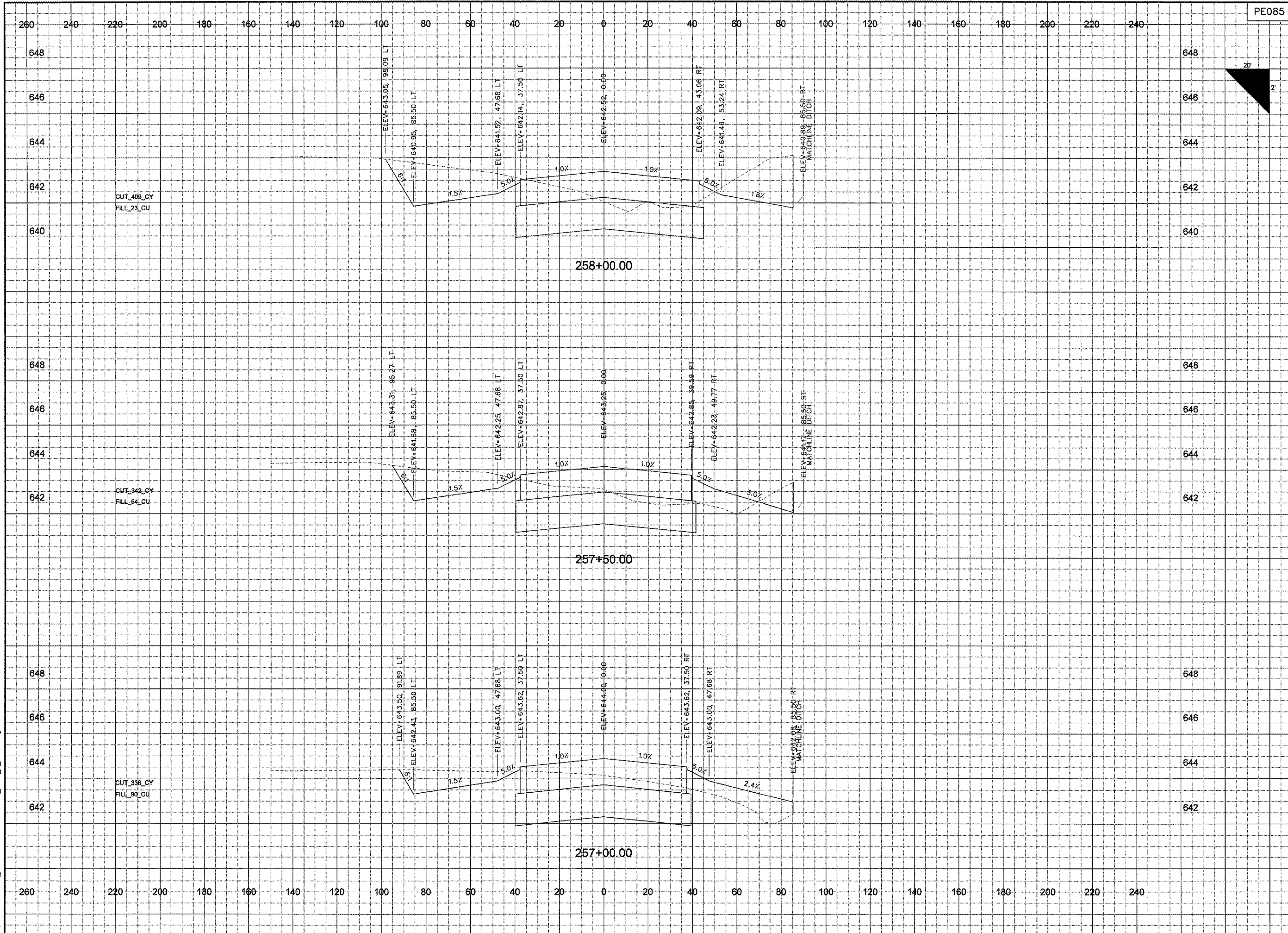

PE085

| REVISIONS | | |
|-----------|----|------|
| NUMBER | BY | DATE |
| | | |
| | | |

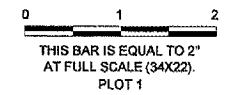

GREATER Peoria REGIONAL Airport

RELOCATE TAXIWAYS A AND D FROM MID-FIELD INTERSECTION PHASE 2

CMT
 CRAWFORD, MURPHY & TILLY, INC.
 CONSULTING ENGINEERS

© Copyright CMT, Inc.

| |
|---|
| IL PROJECT NUMBER PIA-3616 |
| FILE: |
| DESIGN BY: BWG |
| DRAWN BY: JSP |
| CHECKED BY: TCS |
| APPROVED BY: CET |
| DATE: MAY 12, 2006 |
| JOB No: 04061-03 |
| CROSS SECTIONS TAXIWAY A SHEET 15 OF 18 |
| SHEET 83 OF 107 SHEETS |