

7/13/2006  
 k:\perria\040610302\draw\sheets\049\_053\_xsec\_p\_sheets.dgn

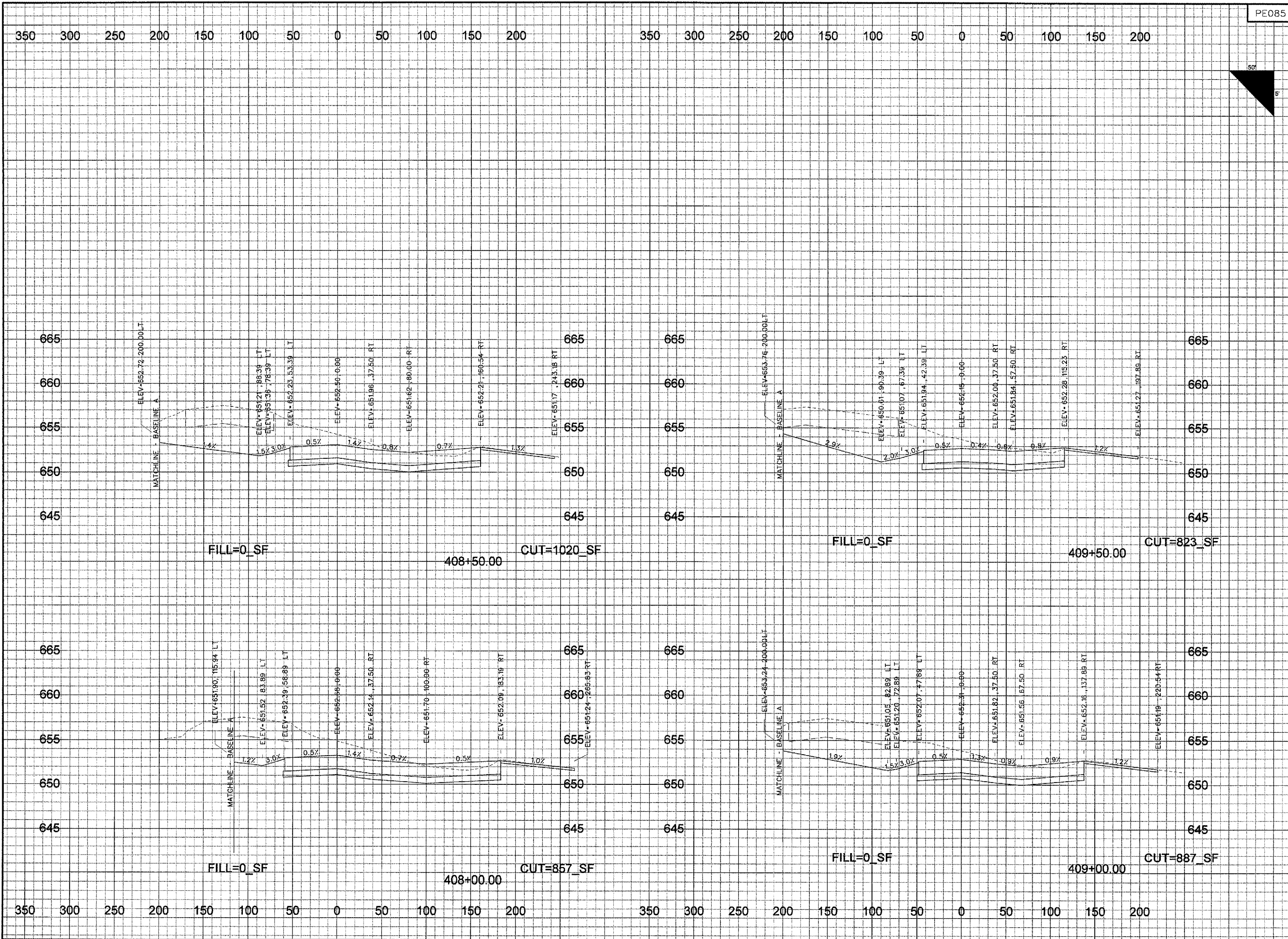

PE085

REVISIONS		
NUMBER	BY	DATE

0 1 2  
 THIS BAR IS EQUAL TO 2'  
 AT FULL SCALE (34X22).  
 PLOT 1

GREATER  
**Peria**  
 REGIONAL  
 Airport

RELOCATE TAXIWAYS A AND D FROM  
 MID-FIELD INTERSECTION PHASE 2

**CMT**  
 CRAWFORD, MURPHY & TILLY, INC.  
 CONSULTING ENGINEERS

IL PROJECT: PIA-3616  
 AIP PROJ: 3-17-0080-XX

FILE: ...1049_053_xsec_p_sheets.dgn
DESIGN BY: BWG
DRAWN BY: CAG
CHECKED BY: TCS
APPROVED BY: CET
DATE: JUNE 30, 2006
JOB No: 04061-03-02
CROSS SECTIONS TAXIWAY P SHEET 1 OF 5
SHEET 91 OF 107 SHEETS