

NOTE TO THE CONTRACTOR

TO EXPEDITE THE CLOSURE OF RUNWAY 17-35 THE CONTRACTOR WILL NOT LIME MODIFY THE SUBGRADE BETWEEN STATION 158+00 AND STATION 163+00.

BETWEEN THESE TWO STATIONS THE CONTRACTOR WILL FURNISH AND INSTALL A SEPARATION FABRIC THAT MEETS THE REQUIREMENTS AS STATED IN THE SPECIAL PROVISIONS.

THE SEPARATION FABRIC WILL BE PAID FOR UNDER ITEM:

AR156513 'SEPARATION FABRIC' _ _ _ 1,202 SQ. YDS.

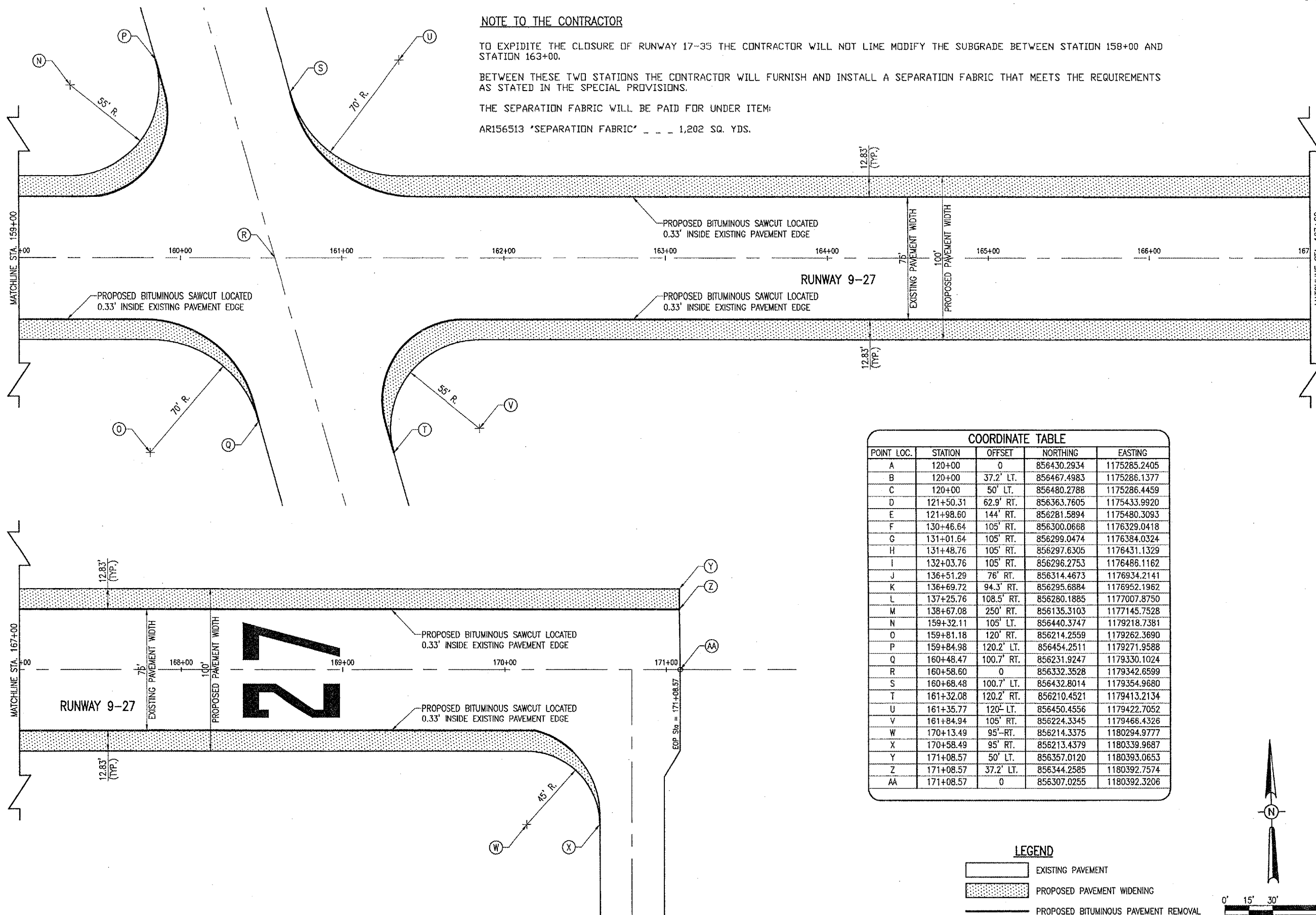

COORDINATE TABLE

POINT LOC.	STATION	OFFSET	NORTHING	EASTING
A	120+00	0	856430.2934	1175285.2405
B	120+00	37.2' LT.	856467.4983	1175286.1377
C	120+00	50' LT.	856480.2788	1175286.4459
D	121+50.31	62.9' RT.	856363.7605	1175433.9920
E	121+98.60	144' RT.	856281.5894	1175480.3093
F	130+46.64	105' RT.	856300.0668	1176329.0418
G	131+01.64	105' RT.	856299.0474	1176384.0324
H	131+48.76	105' RT.	856297.6305	1176431.1329
I	132+03.76	105' RT.	856296.2753	1176486.1162
J	136+51.29	76' RT.	856314.4673	1176934.2141
K	136+69.72	94.3' RT.	856295.6884	1176952.1962
L	137+25.76	108.5' RT.	856280.1885	1177007.8750
M	138+67.08	250' RT.	856135.3103	1177145.7528
N	159+32.11	105' LT.	856440.3747	1179218.7381
O	159+81.18	120' RT.	856214.2559	1179262.3690
P	159+84.98	120.2' LT.	856454.2511	1179271.9588
Q	160+48.47	100.7' RT.	856231.9247	1179330.1024
R	160+58.60	0	856332.3528	1179342.6599
S	160+68.48	100.7' LT.	856432.8014	1179354.9680
T	161+32.08	120.2' RT.	856210.4521	1179413.2134
U	161+35.77	120' LT.	856450.4556	1179422.7052
V	161+84.94	105' RT.	856224.3345	1179466.4326
W	170+13.49	95' RT.	856214.3375	1180294.9777
X	170+58.49	95' RT.	856213.4379	1180339.9687
Y	171+08.57	50' LT.	856357.0120	1180393.0653
Z	171+08.57	37.2' LT.	856344.2585	1180392.7574
AA	171+08.57	0	856307.0255	1180392.3206

LEGEND

- EXISTING PAVEMENT
- PROPOSED PAVEMENT WIDENING
- PROPOSED BITUMINOUS PAVEMENT REMOVAL

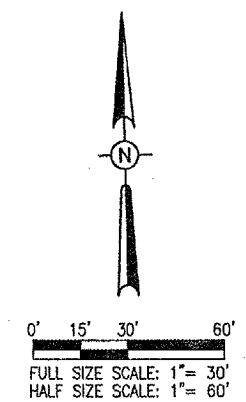

JUN 29, 2006 8:32 AM CAH I:\AIRPORTS\ROBINSON\838-04RWY_AIRPORT_SHEETS\R-121CON.DWG - 159+00 TO 171+00

DATE	REVISION				
<p>ROBINSON MUNICIPAL AIRPORT ROBINSON CRAWFORD COUNTY, ILLINOIS</p>					
<p>IL. PROJ.: RSV-3490 A.I.P. PROJ.: 3-17-0086-B10</p>					
<p>HB Project No. 838-04RWY Diagram R-121CON.DWG Scale 1" = 30' Date 01/13/04</p>		<p>LAYOUT CCC 01/13/04 DRAWN CCC 01/13/04 REVIEWED CAH 03/05/04</p>	<p>Hanson Professional Services Inc. 1525 South Sixth Street Springfield, Illinois 62703-2886 Offices Nationwide</p>		
<p>RUNWAY 9-27 WIDENING PROPOSED CONSTRUCTION PLAN STA. 159+00 TO STA. 171+00</p>					
<p style="font-size: 2em; font-weight: bold;">7</p>					
<p>7 of 75 sheets</p>					