

JUN 29, 2006 8:34 AM CAH
 I:\AIRPORTS\ROBINSON\B38-04RWY\AIRPORT\SHETS\R-13\DRN.DWG - 159+00 to 171+09

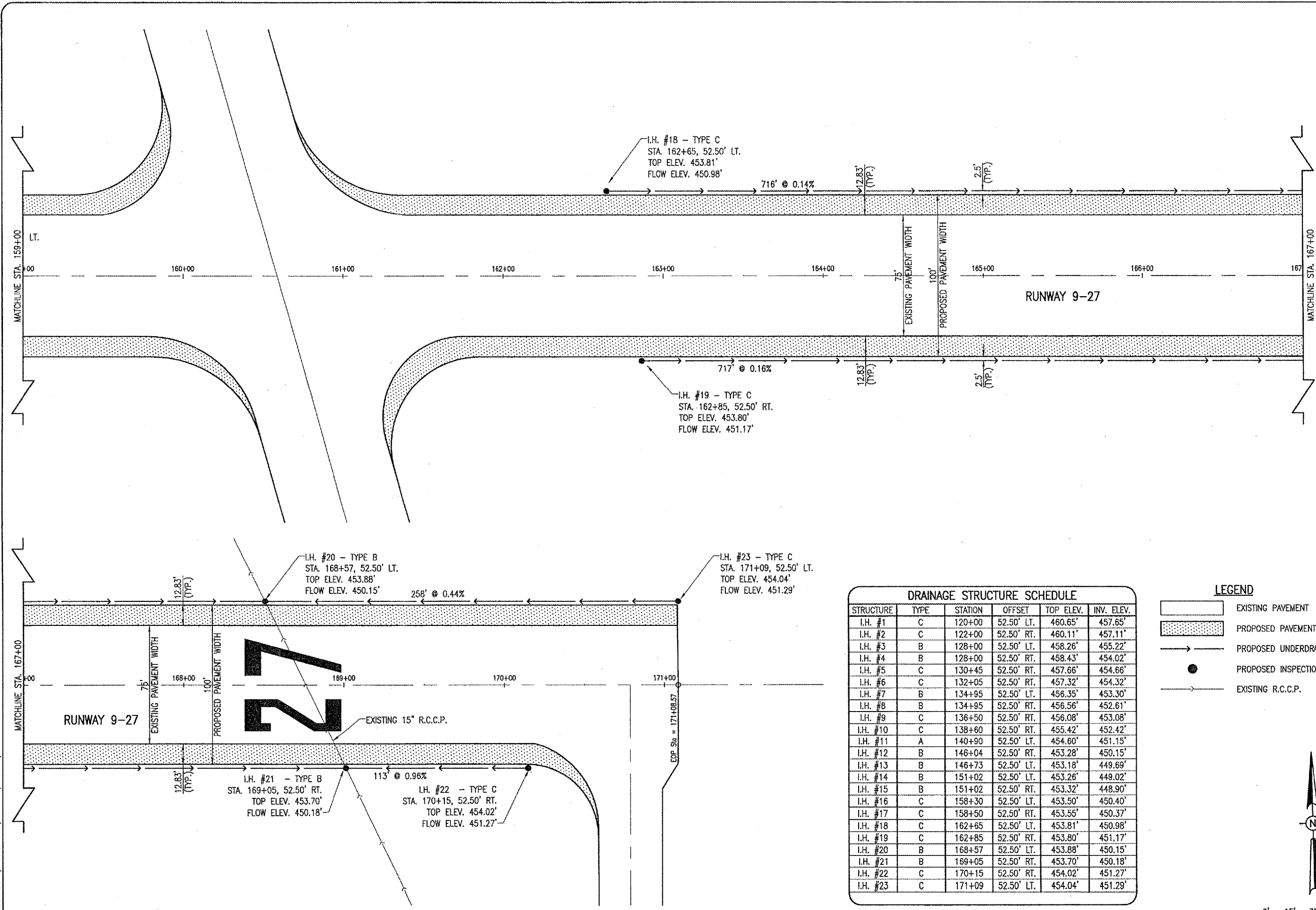

| DRAINAGE STRUCTURE SCHEDULE | | | | | | |
|-----------------------------|------|---------|------------|-----------|------------|--|
| STRUCTURE | TYPE | STATION | OFFSET | TOP ELEV. | INV. ELEV. | |
| I.H. #1 | C | 120+00 | 52.50' LT. | 460.65' | 457.65' | |
| I.H. #2 | C | 122+00 | 52.50' RT. | 460.11' | 457.11' | |
| I.H. #3 | B | 128+00 | 52.50' LT. | 458.26' | 455.22' | |
| I.H. #4 | B | 128+00 | 52.50' RT. | 458.43' | 454.02' | |
| I.H. #5 | C | 130+45 | 52.50' RT. | 457.66' | 454.66' | |
| I.H. #6 | C | 132+05 | 52.50' RT. | 457.32' | 454.32' | |
| I.H. #7 | B | 134+95 | 52.50' LT. | 456.35' | 453.30' | |
| I.H. #8 | B | 134+95 | 52.50' RT. | 456.56' | 452.61' | |
| I.H. #9 | C | 136+50 | 52.50' RT. | 456.08' | 453.08' | |
| I.H. #10 | C | 138+60 | 52.50' RT. | 455.42' | 452.42' | |
| I.H. #11 | A | 140+90 | 52.50' LT. | 454.60' | 451.15' | |
| I.H. #12 | B | 146+04 | 52.50' RT. | 453.28' | 450.15' | |
| I.H. #13 | B | 146+73 | 52.50' LT. | 453.18' | 449.69' | |
| I.H. #14 | B | 151+02 | 52.50' LT. | 453.28' | 449.02' | |
| I.H. #15 | B | 151+02 | 52.50' RT. | 453.32' | 448.90' | |
| I.H. #16 | C | 158+30 | 52.50' LT. | 453.50' | 450.40' | |
| I.H. #17 | C | 158+50 | 52.50' RT. | 453.55' | 450.37' | |
| I.H. #18 | C | 162+65 | 52.50' LT. | 453.81' | 450.98' | |
| I.H. #19 | C | 162+85 | 52.50' RT. | 453.80' | 451.17' | |
| I.H. #20 | B | 168+57 | 52.50' LT. | 453.88' | 450.15' | |
| I.H. #21 | B | 169+05 | 52.50' RT. | 453.70' | 450.18' | |
| I.H. #22 | C | 170+15 | 52.50' RT. | 454.02' | 451.27' | |
| I.H. #23 | C | 171+09 | 52.50' LT. | 454.04' | 451.29' | |

- LEGEND**
- EXISTING PAVEMENT
 - PROPOSED PAVEMENT WIDENING
 - PROPOSED UNDERDRAINS
 - PROPOSED INSPECTION HOLE
 - EXISTING R.C.C.P.

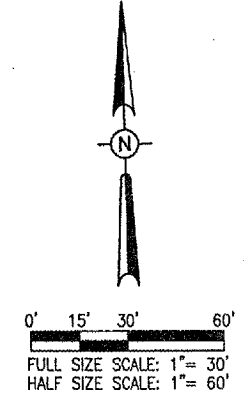

| DATE | REVISION | BY |
|------|----------|----|
| | | |
| | | |
| | | |

ROBINSON MUNICIPAL AIRPORT
 ROBINSON
 CRAWFORD COUNTY, ILLINOIS
 I.L. PROJ.: RSV-3490 A.I.P. PROJ.: 3-17-0086-B10

| REVISION | DATE | BY |
|----------|----------|-----|
| LAYOUT | 01/13/04 | CCC |
| DRAWN | 01/13/04 | CCC |
| REVIEWED | 03/05/04 | CAH |

HANSON
 Hanson Professional Services Inc.
 1625 South Sixth Street
 Springfield, Illinois 62705-2886
 Offices Nationwide

RUNWAY 9-27 WIDENING
 PROPOSED DRAINAGE PLAN
 STA. 159+00 TO STA. 171+09