

JUN 29, 2006 1:31 PM CAH
 I:\AIRPORTS\STLOUIS\B37-08APND\AIRPORT\SHEETS\R-111PRP.DWG - PAVEPREP

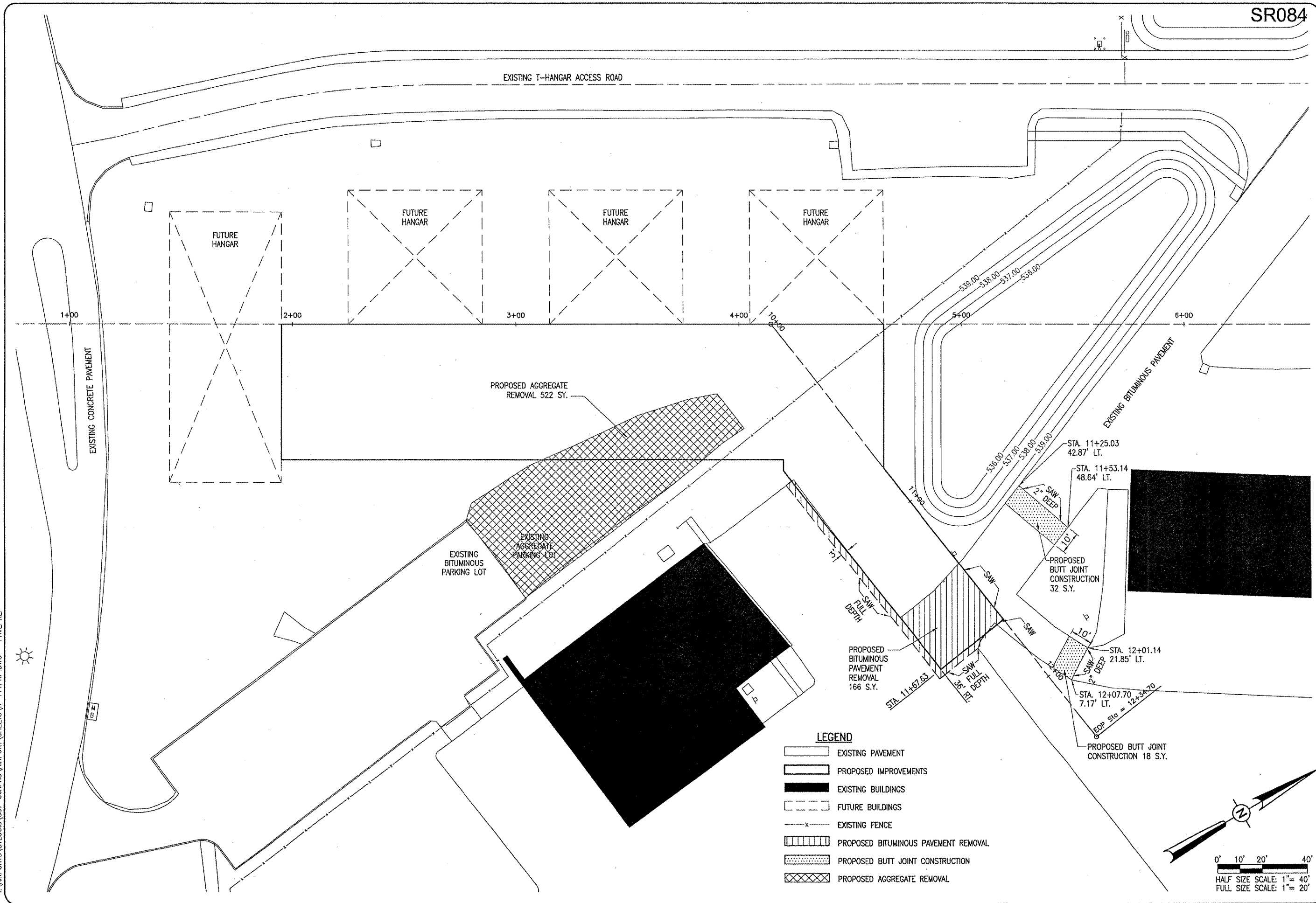

SR084

EXISTING T-HANGAR ACCESS ROAD

FUTURE HANGAR

FUTURE HANGAR

FUTURE HANGAR

FUTURE HANGAR

1+00

2+00

3+00

4+00

5+00

6+00

EXISTING CONCRETE PAVEMENT

PROPOSED AGGREGATE REMOVAL 522 S.Y.

EXISTING BITUMINOUS PARKING LOT

EXISTING AGGREGATE PARKING LOT

PROPOSED BITUMINOUS PAVEMENT REMOVAL 166 S.Y.

PROPOSED BUTT JOINT CONSTRUCTION 32 S.Y.

PROPOSED BUTT JOINT CONSTRUCTION 18 S.Y.

LEGEND

- EXISTING PAVEMENT
- PROPOSED IMPROVEMENTS
- EXISTING BUILDINGS
- FUTURE BUILDINGS
- EXISTING FENCE
- PROPOSED BITUMINOUS PAVEMENT REMOVAL
- PROPOSED BUTT JOINT CONSTRUCTION
- PROPOSED AGGREGATE REMOVAL

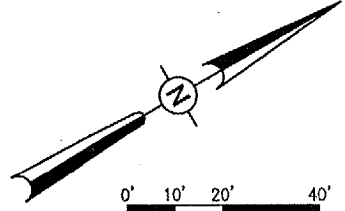

	REVISION	DATE	BY
ST. LOUIS REGIONAL AIRPORT		EAST ALTON, ILLINOIS	
IL. PROJ.: ALN-3348			
I.E. Project No. 83708APND-0240 Estimate R-111PRP.DWG Scale 1"=20' Date 04/14/06			
LAYOUT	JAC	04/14/06	
DRAWN	BAK	04/14/06	
REVIEWED	CAH	05/17/06	
Hanson Professional Services Inc. 11501 South Main Street, Suite 200 Springfield, Illinois 62703-2886 Offices Nationwide			
CONSTRUCT AIRCRAFT PARKING APRON		PROPOSED PAVEMENT PREPARATION PLAN	
<div style="font-size: 2em; font-weight: bold;">5</div>			
5 of 28 sheets			