

JUN 29, 2006 1:33 PM CAH
 I:\AIRPORTS\STLOUIS\837-06APND\AIRPORT SHEETS\R-16\JNT.DWG - JOINTING

SR084

EXISTING T-HANGAR ACCESS ROAD

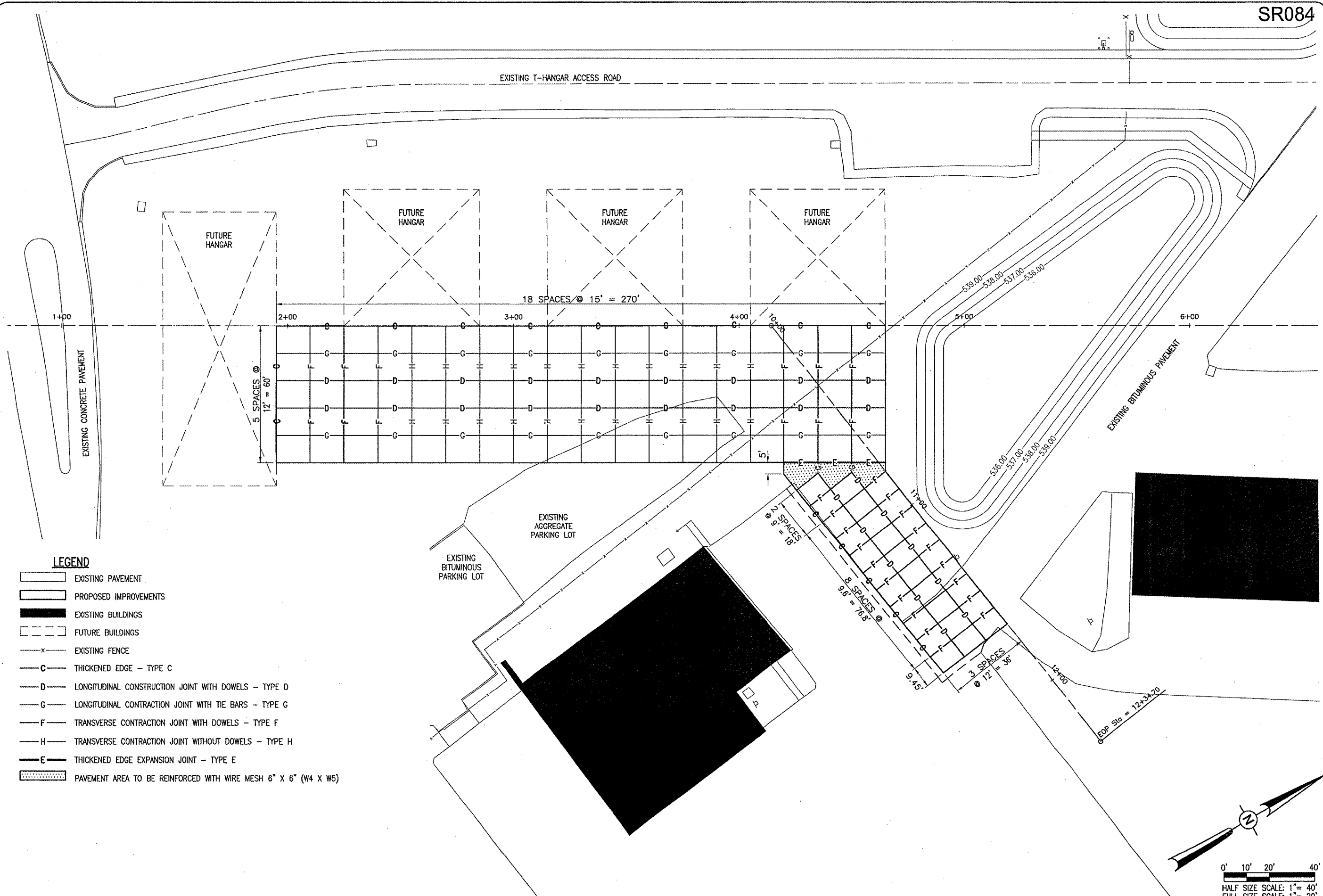

LEGEND

- EXISTING PAVEMENT
- PROPOSED IMPROVEMENTS
- EXISTING BUILDINGS
- FUTURE BUILDINGS
- EXISTING FENCE
- THICKENED EDGE - TYPE C
- LONGITUDINAL CONSTRUCTION JOINT WITH DOWELS - TYPE D
- LONGITUDINAL CONTRACTION JOINT WITH TIE BARS - TYPE G
- TRANSVERSE CONTRACTION JOINT WITH DOWELS - TYPE F
- TRANSVERSE CONTRACTION JOINT WITHOUT DOWELS - TYPE H
- THICKENED EDGE EXPANSION JOINT - TYPE E
- PAVEMENT AREA TO BE REINFORCED WITH WIRE MESH 6" X 6" (W4 X W5)

DATE	REVISION	BY

ST. LOUIS REGIONAL AIRPORT

 EAST ALTON, ILLINOIS
 IL. PROJ.: ALN-3348

HB Project No. 83706APND_0240 Filename: R-16\JNT.DWG Scale: 1"=20' Date: 04/14/06	LAYOUT JAC 04/14/06 DRAWN BAK 04/14/06 REVIEWED CAH 05/17/06
--	--

HANSON
 Hanson Professional Services Inc.
 1525 South Sixth Street
 Springfield, Illinois 62703-2886
 Offices Nationwide

CONSTRUCT AIRCRAFT
 PARKING APRON
 PROPOSED
 JOINTING
 PLAN