







REVISIONS		
NUMBER	BY	DATE

0 1 2
THIS BAR IS EQUAL TO 2"
AT FULL SCALE (34X22).

LEGEND

-  EXISTING PAVEMENT - TO BE MILLED
-  EXISTING APRON LIGHT TO BE REMOVED
-  EXISTING FENCE POST FOUNDATIONS TO BE REMOVED
-  EXISTING FENCE
-  EXISTING MANHOLE
-  EXISTING JUNCTION BOX
-  EXISTING INLET

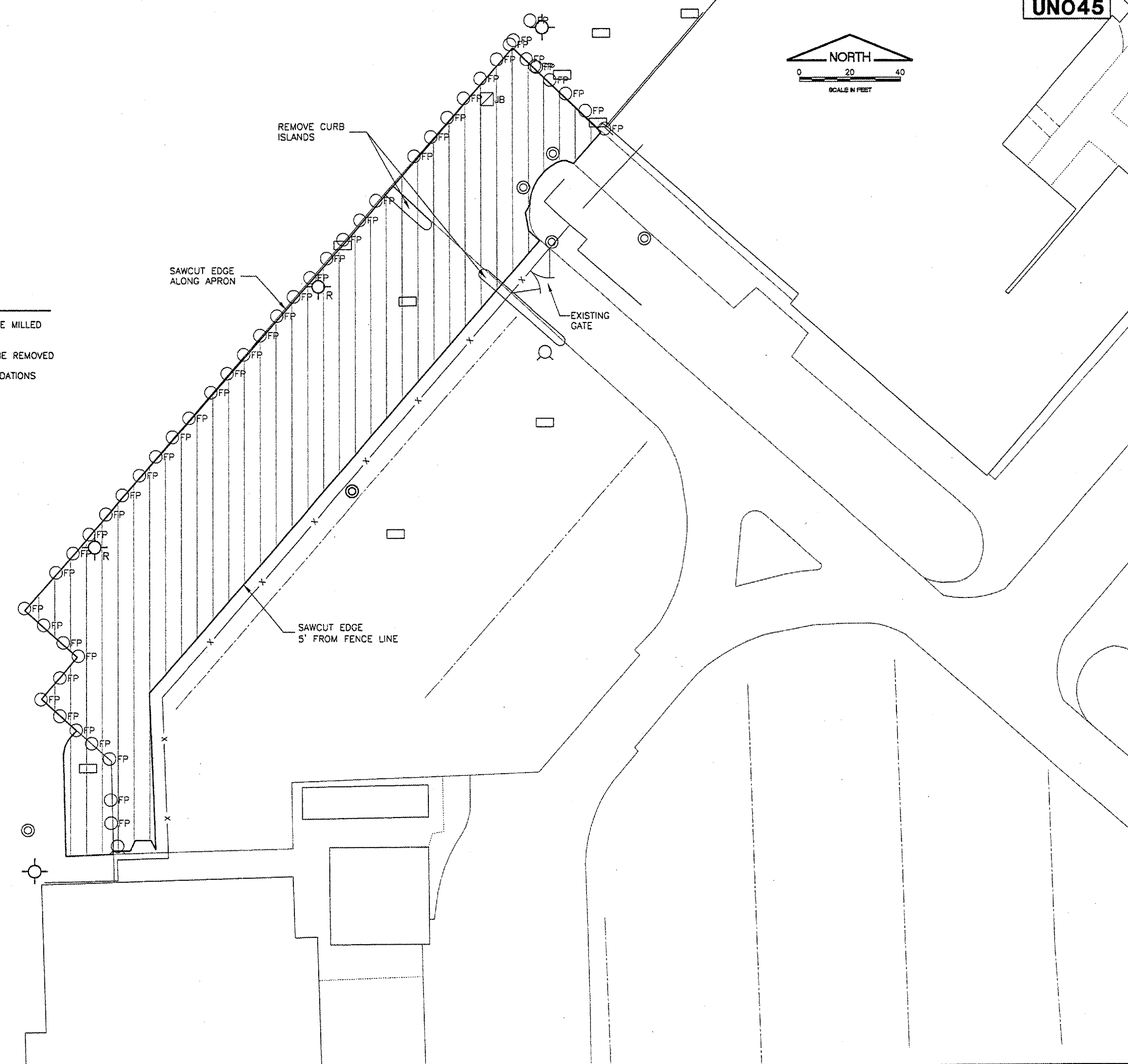

**WILLARD AIRPORT
UNIVERSITY OF ILLINOIS
REHABILITATE GA/SCHOOL APRON
EXISTING CONDITIONS**

© Copyright CMT, Inc.
CMT
CRAWFORD, MURPHY & TILLY, INC.
CONSULTING ENGINEERS
License No. 184-000513

DESIGN BY:	JEF
DRAWN BY:	CMT
CHECKED BY:	SMH
APPROVED BY:	JEF
DATE:	06/09/2006
JOB No:	0605902
IL. PROJ. NO. CMI-3589	
AIP PROJ. NO. 3-17-00XX-XX	
SHEET 6 OF 16 SHEETS	