

STATE OF ILLINOIS
DEPARTMENT OF TRANSPORTATION
DIVISION OF HIGHWAYS
PROPOSED
HIGHWAY PLANS

| F.A.P. RTE. | SECTION | COUNTY | TOTAL SHEETS | SHEET NO. |
|-------------|----------------|----------|--------------------|-----------|
| 370 | FAP 0370 22 RS | COOK | 19 | 1 |
| | | ILLINOIS | CONTRACT NO. 62T93 | |

FOR INDEX OF SHEET, SEE SHEET NO.2

THE PROJECT IS LOCATED IN THE CITY OF CHICAGO AND VILLAGE OF EVERGREEN PARK

**F.A.P. 370: WESTERN AVE.
 87TH ST. TO 91ST ST.
 SECTION: FAP 0370 22 RS
 PROJECT: NHPP-NDZY(524)
 SMART OVERLAY
 COOK COUNTY**

D-91-269-22



TRAFFIC DATA

WESTERN AVE.: 2021 ADT = 29700
 POSTED SPEED LIMIT = 35 MPH

IMPROVEMENT BEGINS
 STA 14+20

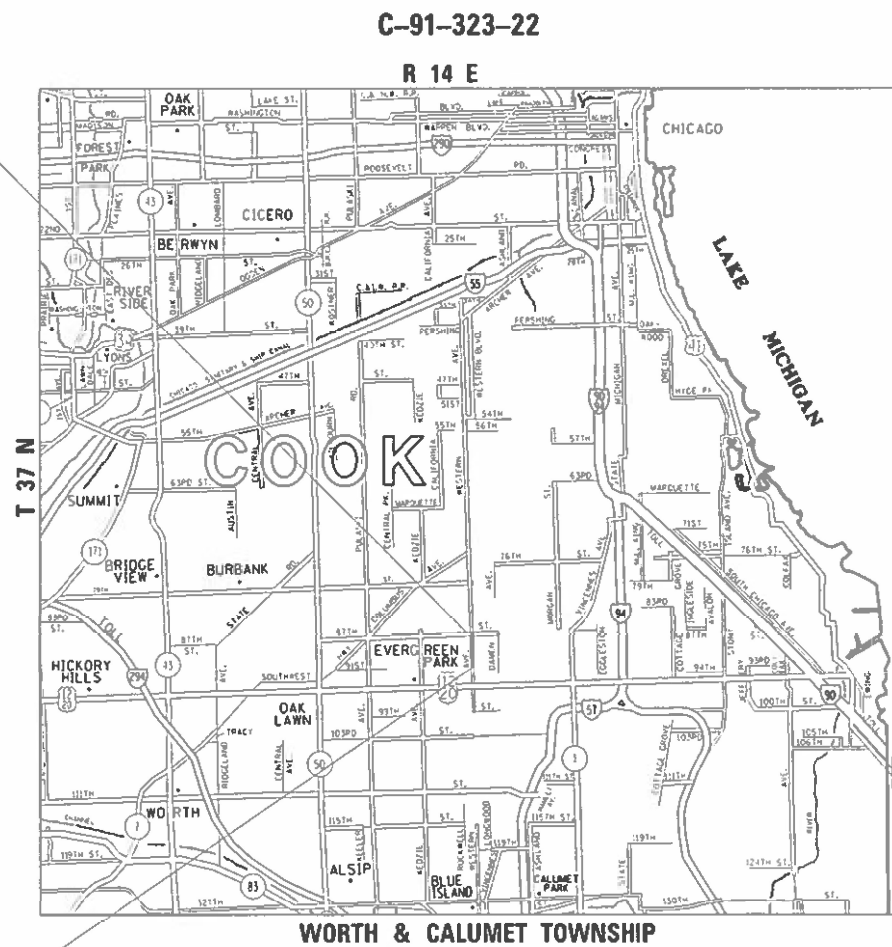

IMPROVEMENT BEGINS
 STA 42+38

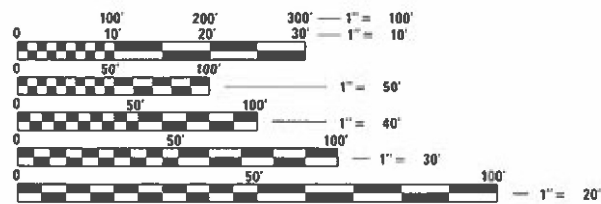

FULL SIZE PLANS HAVE BEEN PREPARED USING STANDARD ENGINEERING SCALES. REDUCED SIZED PLANS WILL NOT CONFORM TO STANDARD SCALES. IN MAKING MEASUREMENTS ON REDUCED PLANS, THE ABOVE SCALES MAY BE USED.

J.U.L.I.E.
 JOINT UTILITY LOCATION INFORMATION FOR EXCAVATION
 1-800-892-0123
 OR 811

PROJECT MANAGER: ALAIN MIDY (847) 221-3056
 PROJECT ENGINEER: RODRIGO LEDEZMA (847) 705-4580
 CONTRACT NO. 62T93

GROSS & NET LENGTH = 2818 FT. = .53 MILE

STATE OF ILLINOIS
 DEPARTMENT OF TRANSPORTATION
 DIVISION OF HIGHWAYS

SUBMITTED March 17 20 23
Jose Rios REGIONAL ENGINEER
 June 30, 2023 *J. A. Etk*
 ENGINEER OF DESIGN AND ENVIRONMENT
 June 30, 2023 *Stephen M. ...*
 DIRECTOR OF HIGHWAYS PROJECT IMPLEMENTATION

**PRINTED BY THE AUTHORITY
 OF THE STATE OF ILLINOIS**

STATE STANDARDS

INDEX OF SHEETS

| | |
|-----|---|
| 1 | COVER SHEET |
| 2 | INDEX OF SHEETS, STATE STANDARDS & GENERAL NOTES |
| 3-4 | SUMMARY OF QUANTITIES |
| 5 | EXISTING AND PROPOSED TYPICAL SECTIONS |
| 6-7 | ROADWAY PLAN |
| 8 | DETECTOR LOOP REPLACEMENT PLANS |
| 9 | DETAILS FOR FRAMES AND LIDS ADJUSTMENT WITH MILLING (BD-08) |
| 10 | PAVEMENT PATCHING FOR HMA SURFACED PAVEMENT (BD-22) |
| 11 | CURB OR CURB AND GUTTER REMOVAL AND REPLACEMENT (BD-24) |
| 12 | BUTT JOINT AND HMA TAPER DETAILS (BD-32) |
| 13 | TRAFFIC CONTROL AND PROTECTION FOR SIDE ROADS, INTERSECTIONS, AND DRIVEWAYS (TC-10) |
| 14 | TYPICAL APPLICATIONS RAISED REFLECTIVE PAVEMENT MARKERS (SNOW PLOW RESISTANT) (TC-11) |
| 14A | DISTRICT ONE TYPICAL PAVEMENT MARKINGS (TC-13) |
| 15 | TRAFFIC CONTROL AND PROTECTION AT TURN BAYS (TO REMAIN OPEN TO TRAFFIC) (TC-14) |
| 16 | SHORT TERM PAVEMENT MARKING LETTERS AND SYMBOLS (TC-16) |
| 17 | ARTERIAL ROAD INFORMATION SIGN (TC-22) |
| 18 | CITY OF CHICAGO TYPICAL PAVEMENT MARKINGS (TC-24) |

STANDARD NO.

DESCRIPTION

| | |
|-----------|--|
| 000001-08 | STANDARD SYMBOLS, ABBREVIATIONS AND PATTERNS |
| 442201-03 | CLASS C AND D PATCHES |
| 606001-08 | CONCRETE CURB TYPE B AND COMBINATION CONCRETE CURB AND GUTTER |
| 701101-05 | OFF-ROAD OPERATIONS, MULTILANE, 15' (4.5 M) TO 24" (600 MM) FROM PAVEMENT EDGE |
| 701427-05 | LANE CLOSURE, MULTILANE, INTERMITTEN OR MOVING OPERATION, FOR SPEEDS < 40 MPH |
| 701601-09 | URBAN LANE CLOSURE, MULTILANE, 1W OR 2W WITH NONTRAVERSABLE MEDIAN |
| 701701-10 | URBAN LANE CLOSURE, MULTILANE INTERSECTION |
| 701801-06 | SIDEWALK, CORNER OR CROSSWALK CLOSURE |
| 701901-08 | TRAFFIC CONTROL DEVICES |

GENERAL NOTES

1. BEFORE STARTING ANY EXCAVATION, THE CONTRACTOR SHALL CALL "C.U.A.N." AT (312) 744-7000, J.U.L.I.E. AT 1-800-892-0123, OR 811 FOR FIELD LOCATIONS OF BURIED ELECTRIC, TELEPHONE AND GAS UTILITIES. 48 HOUR NOTIFICATION IS REQUIRED.
2. TEN (10) FOOT TRANSITIONS SHALL BE USED TO MATCH PROPOSED CURB AND GUTTER AND MEDIAN ITEMS OF WORK TO EXISTING CURBS AND GUTTER AND MEDIANS IN THE FIELD, UNLESS OTHERWISE SHOWN. THE TRANSITIONS SHALL BE PAID FOR AT THE CONTRACT UNIT PRICE FOR THE PROPOSED ITEMS OF WORK SPECIFIED.
3. THE CONTRACTOR SHALL COORDINATE CONSTRUCTION ACTIVITIES WITH UTILITY COMPANIES, AND THE CITY OF CHICAGO AND VILLAGE OF EVERGREEN PARK
4. THE CONTRACTOR WILL NOT BE ALLOWED TO SET UP A YARD OR FIELD OFFICE ON STATE PROPERTY WITHOUT WRITTEN PERMISSION FROM THE DEPARTMENT.
5. ANY PAVEMENT MARKINGS AND RAISED REFLECTIVE PAVEMENT MARKERS OBLITERATED BY MILLING AND RESURFACING OPERATIONS ON SIDE STREETS AND ENTRANCES SHALL BE REPLACED AND PAID FOR IN KIND.
6. ALL DAMAGE TO EXISTING PAVEMENT MARKINGS OR RAISED REFLECTIVE PAVEMENT MARKERS OUTSIDE THE REMOVAL LINE SHOWN ON THE PLANS SHALL BE REPLACED AT NO ADDITIONAL COST TO THE DEPARTMENT.
7. BEFORE BEGINNING ANY WORK, THE CONTRACTOR SHALL RETAIN AND RECORD FOR FUTURE REFERENCE, ALL EXISTING PAVEMENT MARKING LINES (AND RAISED REFLECTIVE PAVEMENT MARKERS) IN ORDER THAT THESE LOCATIONS CAN BE RE-ESTABLISHED FOR STRIPING, EXACT LOCATIONS OF ALL PAVEMENT MARKINGS SHALL BE AS SHOWN ON THE PLANS OR AS DIRECTED BY THE ENGINEER.
8. ALL PAVEMENT PATCHING LOCATIONS WILL BE DETERMINED IN THE FIELD BY THE ENGINEER.
9. LOCATION OF COMBINATION CONCRETE CURB AND GUTTER REMOVAL AND REPLACEMENT (OR COMBINATION CURB AND GUTTER), WILL BE DETERMINED IN THE FIELD BY THE ENGINEER.
10. DRAINAGE ADJUSTMENT OR RECONSTRUCTION LOCATIONS WILL BE DETERMINED IN THE FIELD BY THE ENGINEER.
11. IT SHALL BE THE CONTRACTOR'S RESPONSIBILITY TO VERIFY ALL DIMENSIONS AND CONDITIONS EXISTING IN THE FIELD PRIOR TO CONSTRUCTION AND ORDERING OF MATERIALS.
12. FRAMES AND GRATES ADJUSTMENT OF PRIVATE UTILITIES WITHIN THE LIMITS OF THE IMPROVEMENTS SHALL BE DONE BY THEIR RESPECTIVE OWNERS AND ARE NOT PART OF THIS CONTRACT.
13. THE CONTRACTOR SHALL CONTACT THE DISTRICT ONE TRAFFIC CONTROL SUPERVISOR AT KALPANA.KANNAN-HOSADURGA@ILLINOIS.GOV A MINIMUM OF 72 HOURS IN ADVANCE OF BEGINNING WORK.
14. THE ENGINEER SHALL CONTACT PATRICE HARRIS, AREA TRAFFIC FIELD ENGINEER, AT PATRICE.HARRIS@ILLINOIS.GOV A MINIMUM OF TWO (2) WEEKS PRIOR TO THE PLACEMENT OF PERMANENT PAVEMENT MARKINGS.
15. THESE PLANS HAVE BEEN PREPARED FROM NOTES RECEIVED FROM THE BUREAU OF CONSTRUCTION.
16. THE THICKNESS OF THE HMA MIXTURE SHOWN ON THE PLANS IS THE NOMINAL THICKNESS. DEVIATIONS FROM THE NOMINAL THICKNESS WILL BE PERMITTED WHEN SUCH DEVIATIONS OCCUR DUE TO IRREGULARITIES IN THE EXISTING SURFACE OR BASE ON WHICH THE HMA MIXTURE IS PLACED.
17. THE CONTRACTOR SHALL BE REQUIRED TO PROVIDE ACCESS TO ABUTTING PROPERTY AT ALL TIMES DURING THE CONSTRUCTION OF THIS PROJECT.
18. THE CONTRACTOR WILL BE REQUIRED TO KEEP A RECORD OF THE LOCATIONS OF PLATED STRUCTURES BY STATION AND OFFSET LEFT OR RIGHT OF THE CENTERLINE OF PAVEMENT.
19. EXISTING BROKEN FRAMES AND LIDS SHALL BE REMOVED AND DISPOSED OF BY THE CONTRACTOR AND SHALL BE REPLACED AS DIRECTED BY THE ENGINEER. REPLACEMENT FRAMES AND LIDS WILL BE PAID FOR ACCORDING TO ARTICLE 109.04 OF THE STANDARD SPECIFICATIONS UNLESS A SEPARATE PAY ITEM HAS BEEN PROVIDED.
20. FOR FRAMES AND LIDS ADJUSTMENT WITHOUT MILLING, REUSE EXISTING FRAME AND LID UNLESS OTHERWISE SPECIFIED IN THE PLANS.
21. DO NOT SCALE PLANS FOR CONSTRUCTION DIMENSIONS.
22. DOUBLE LANE MARKERS ARE TO BE USED AS SHOWN ON THE DISTRICT ONE DETAIL "TYPICAL APPLICATIONS RAISED REFLECTIVE PAVEMENT MARKERS (SNOW-PLOW RESISTANT)" SHOWN IN THE PLANS.
23. PAVEMENT MARKING TAPE, TYPE III SHALL BE USED FOR SHORT TERM PAVEMENT MARKINGS ON ALL FINAL SURFACES.
24. WHEN THE MILLED PAVEMENT IS OPEN TO TRAFFIC THE MAXIMUM GRADE DIFFERENTIAL BETWEEN PASSES OF THE MILLING MACHINE SHALL NOT EXCEED 1 1/2 INCHES (40 mm) WHERE THE SPEED LIMIT IS 40 MPH (80 km/h) OR LESS AND 1 INCH (25 mm) WHERE THE SPEED LIMIT IS GREATER THAN 40 MPH (80 km/h). WITH WRITTEN APPROVAL OF THE ENGINEER, A MAXIMUM GRADE DIFFERENTIAL OF 3 INCHES (75 mm) MAY BE ALLOWED IF THE EDGE OF THE MILLING IS SLOPED A MINIMUM 1:3 (V:H) OR A NOTCHED LONGITUDINAL WEDGE IS USED.
25. BUTT JOINTS WILL BE INSTALLED AT THE ENDS OF ALL RESURFACING (WHERE RESURFACING MEETS EXISTING PAVEMENT) ACCORDING TO THE "BUTT JOINT AND HOT-MIX ASPHALT TAPER DETAILS" SHEET INCLUDED IN THE PLANS, UNLESS OTHERWISE SPECIFIED.
26. OVERNIGHT LANE CLOSURES SHALL NOT BE ALLOWED FOR REHABILITATION PROJECTS INVOLVING DAYTIME MILLING AND RESURFACING OPERATIONS AND CLASS D PATCHING UNLESS OTHER CONDITIONS WARRANT EXTENDED LANE CLOSURES AS DETERMINED AND APPROVED IN WRITING BY THE ENGINEER OR AS PROVIDED FOR IN THE CONTRACT SPECIFICATIONS.
27. CITY OF CHICAGO CASTINGS ARE THE PROPERTY OF THE CITY OF CHICAGO AND THE CONTRACTOR SHALL NOTIFY THE CITY FOR REMOVAL AND DISPOSITION OF THE CASTING.
28. PAVEMENT MARKING TAPE TYPR III SHALL BE USED FOR SHORT TERM PAVEMENT MARKINGS ON FINAL SURFACES.
29. ALL MILLED SURFACES SHALL BE A UNIFORM CROSS SLOPE PER LANE AND FREE OF RIDGES BETWEEN PASSES. ANY DEVIATIONS SHALL BE CORRECTED AT NO COST TO THE DEPARTMENT.

MODEL: Default
FILE NAME: p:\ulldot-pw-bentley.com\p\ulldot\Documents\DOT Offices\District 1\Project\126922\CaddData\Design\126922-ent-sbim.dgn

| | | | | | | | | | | | | |
|------------------------------|------------|------------|---|---|-------|----|--------|---------------------------|---------|--------|-----------------|--------------|
| USER NAME = addis.abebaw | DESIGNED - | REVISED - | STATE OF ILLINOIS DEPARTMENT OF TRANSPORTATION | INDEX OF SHEETS, STATE STANDARDS AND GENERAL NOTES | | | | F.A.P. RTE. | SECTION | COUNTY | TOTAL SHEETS | SHEET NO. |
| DRAWN - | REVISIED - | 370 | | | | | | FAP 0370 22 RS | COOK | 18 | 2 | |
| PLOT SCALE = 100.0000' / in. | CHECKED - | REVISIED - | | CONTRACT NO. 62T93 | | | | ILLINOIS FED. AID PROJECT | | | | |
| PLOT DATE = 5/10/2023 | DATE - | REVISIED - | | SCALE: | SHEET | OF | SHEETS | STA. | TO | STA. | | |

| SUMMARY OF QUANTITIES | | | TOTAL QUANTITIES URBAN | CONSTRUCTION TYPE CODE | | | | |
|-----------------------|--|-------|------------------------|--------------------------------|-------------------------|--|--|--|
| CODE NO | ITEM | UNIT | | 0005 OVERLAY 80% FED 20% STATE | 0005 OVERLAY 100% STATE | | | |
| 25200110 | SODDING, SALT TOLERANT | SO YD | 82 | 82 | | | | |
| 40600290 | BITUMINOUS MATERIALS (TACK COAT) | POUND | 9570 | 9570 | | | | |
| 40600370 | LONGITUDINAL JOINT SEALANT | FOOT | 7796 | 7796 | | | | |
| 40600400 | MIXTURE FOR CRACKS, JOINTS, AND FLANGEWAYS | TON | 32 | 32 | | | | |
| 40600982 | HOT-MIX ASPHALT SURFACE REMOVAL - BUTT JOINT | SO YD | 216 | 216 | | | | |
| 40604172 | POLYMERIZED HOT-MIX ASPHALT SURFACE COURSE, IL-9.5, MIX "E", N70 | TON | 2084 | 2084 | | | | |
| 42001300 | PROTECTIVE COAT | SO YD | 164 | 164 | | | | |
| 44000156 | HOT-MIX ASPHALT SURFACE REMOVAL, 1 3/4" | SO YD | 21266 | 21266 | | | | |
| 44201789 | CLASS D PATCHES, TYPE II, 12 INCH | SO YD | 118 | 118 | | | | |
| 44201794 | CLASS D PATCHES, TYPE III, 12 INCH | SO YD | 48 | 48 | | | | |
| 44201796 | CLASS D PATCHES, TYPE IV, 12 INCH | SO YD | 521 | 521 | | | | |
| 60300305 | FRAMES AND LIDS TO BE ADJUSTED | EACH | 1 | 1 | | | | |
| 67100100 | MOBILIZATION | L SUM | 1 | 1 | | | | |

| SUMMARY OF QUANTITIES | | | | TOTAL QUANTITIES URBAN | CONSTRUCTION TYPE CODE | | | | |
|-----------------------|--|-------|--------------------------------|------------------------|-------------------------|--|--|--|--|
| CODE NO | ITEM | UNIT | 0005 OVERLAY 80% FED 20% STATE | | 0005 OVERLAY 100% STATE | | | | |
| 70102630 | TRAFFIC CONTROL AND PROTECTION, STANDARD 701601 | L SUM | 1 | 1 | | | | | |
| 70102635 | TRAFFIC CONTROL AND PROTECTION, STANDARD 701701 | L SUM | 1 | 1 | | | | | |
| 70102640 | TRAFFIC CONTROL AND PROTECTION, STANDARD 701801 | L SUM | 1 | 1 | | | | | |
| 70300100 | SHORT TERM PAVEMENT MARKING | FOOT | 5052 | 5052 | | | | | |
| 70300150 | SHORT TERM PAVEMENT MARKING REMOVAL | SO FT | 1268 | 1268 | | | | | |
| 70300211 | TEMPORARY PAVEMENT MARKING LETTERS AND SYMBOLS - PAINT | SO FT | 184.5 | 184.5 | | | | | |
| 70300221 | TEMPORARY PAVEMENT MARKING - LINE 4"- PAINT | FOOT | 3937 | 3937 | | | | | |
| 70300241 | TEMPORARY PAVEMENT MARKING - LINE 6"- PAINT | FOOT | 1001 | 1001 | | | | | |
| 70300261 | TEMPORARY PAVEMENT MARKING - LINE 12"- PAINT | FOOT | 50 | 50 | | | | | |
| 70300281 | TEMPORARY PAVEMENT MARKING - LINE 24"- PAINT | FOOT | 1387 | 1387 | | | | | |
| 70306120 | TEMPORARY PAVEMENT MARKING - LINE 4" - TYPE III TAPE | FOOT | 6325 | 6325 | | | | | |

| | | | | | | | | | | | |
|--|---|------------|-----------|---|---|---|----------------|--------|--------------|-----------|--|
| FILE NAME = | USER NAME = odd15a0ebaw | DESIGNED - | REVISED - | STATE OF ILLINOIS DEPARTMENT OF TRANSPORTATION | WESTERN AVE. (87th ST. - 91st ST.) SUMMARY OF QUANTITIES | F.A.P. RTE. | SECTION | COUNTY | TOTAL SHEETS | SHEET NO. | |
| pw\N1dot-pw.bentley.com\PIWIDOT\Documents\WDOT | Office\101str\101\Projects\DI26922\CADData\Design\DI26922-sht | DRAWN - | REVISED - | | | 370 | FAP 0370 22 RS | COOK | 18 | 3 | |
| | PLOT SCALE = 100.0409 ' / In. | CHECKED - | REVISED - | | | CONTRACT NO. 62193 | | | | | |
| | PLOT DATE = 5/11/2023 | DATE - | REVISED - | | | SCALE: SHEET NO. OF SHEETS STA. TO STA. FED. ROAD DIST. NO. 1 ILLINOIS FED. AID PROJECT | | | | | |

| SUMMARY OF QUANTITIES | | | CONSTRUCTION TYPE CODE | | | | | | |
|-----------------------|---|-------|------------------------|--------------------------------|-------------------------|--|--|--|--|
| CODE NO | ITEM | UNIT | TOTAL QUANTITIES URBAN | 0005 OVERLAY 80% FED 20% STATE | 0005 OVERLAY 100% STATE | | | | |
| * 78000100 | THERMOPLASTIC PAVEMENT MARKING - LETTERS AND SYMBOLS | SO FT | 184.5 | 184.5 | | | | | |
| * 78000200 | THERMOPLASTIC PAVEMENT MARKING - LINE 4" | FOOT | 3937 | 3937 | | | | | |
| * 78000400 | THERMOPLASTIC PAVEMENT MARKING - LINE 6" | FOOT | 1001 | 1001 | | | | | |
| * 78000600 | THERMOPLASTIC PAVEMENT MARKING - LINE 12" | FOOT | 50 | 50 | | | | | |
| * 78000650 | THERMOPLASTIC PAVEMENT MARKING - LINE 24" | FOOT | 1384 | 1384 | | | | | |
| * 78100100 | RAISED REFLECTIVE PAVEMENT MARKER | EACH | 205 | 205 | | | | | |
| 78300200 | RAISED REFLECTIVE PAVEMENT MARKER REMOVAL | EACH | 164 | 164 | | | | | |
| 78300202 | PAVEMENT MARKING REMOVAL - WATER BLASTING | SO FT | 5411 | 5411 | | | | | |
| * 88600600 | DETECTOR LOOP REPLACEMENT | FOOT | 892 | 892 | | | | | |
| X4400501 | COMBINATION CURB AND GUTTER REMOVAL AND REPLACEMENT LESS THAN OR EQUAL TO 10 FEET | FOOT | 91 | 91 | | | | | |
| X5537800 | STORM SEWERS TO BE CLEANED 12" | FOOT | 25 | 25 | | | | | |

| SUMMARY OF QUANTITIES | | | CONSTRUCTION TYPE CODE | | | | | | |
|-----------------------|--|--------|------------------------|--------------------------------|-------------------------|--|--|--|--|
| CODE NO | ITEM | UNIT | TOTAL QUANTITIES URBAN | 0005 OVERLAY 80% FED 20% STATE | 0005 OVERLAY 100% STATE | | | | |
| X6030310 | FRAMES AND LIDS TO BE ADJUSTED (SPECIAL) | EACH | 17 | 17 | | | | | |
| X6700407 | ENGINEER'S FIELD OFFICE, TYPE A (D1) | CAL MO | 12 | 12 | | | | | |
| X4400503 | COMBINATION CURB AND GUTTER REMOVAL AND REPLACEMENT GREATER THAN 10 FEET | FOOT | 400 | 400 | | | | | |
| Z0018500 | DRAINAGE STRUCTURES TO BE CLEANED | EACH | 1 | | 1 | | | | |
| Z0018600 | DRAINAGE STRUCTURES TO BE RECONSTRUCTED | EACH | 1 | 1 | | | | | |
| * SPECIALTY ITEMS | | | | | | | | | |

| | | | | | | | | | | |
|--|--------------|------------|---|---|---|-------------|----------------|--------|--------------|--------------------|
| FILE NAME = | USER NAME = | DESIGNED - | REVISED - | STATE OF ILLINOIS DEPARTMENT OF TRANSPORTATION | WESTERN AVE. (87th ST. - 91st ST.) SUMMARY OF QUANTITIES | F.A.P. RTE. | SECTION | COUNTY | TOTAL SHEETS | SHEET NO. |
| pw\N\dot-pw\benley.com\PI\DOT\Documents\DOT - Office\District\Projects\DI26922\CADData\Design\DI26922-st-1.dwg | adrls@bebbow | DRAWN - | REVISED - | | | 370 | FAP 0370 22 RS | COOK | 18 | 4 |
| PLOT SCALE = 100.0357' / 1in. | CHECKED - | REVISED - | SCALE: | | | SHEET NO. | OF SHEETS | STA. | TO STA. | CONTRACT NO. 62T93 |
| PLOT DATE = 5/11/2023 | DATE - | REVISED - | FED. ROAD DIST. NO. 1 ILLINOIS FED. AID PROJECT | | | | | | | |

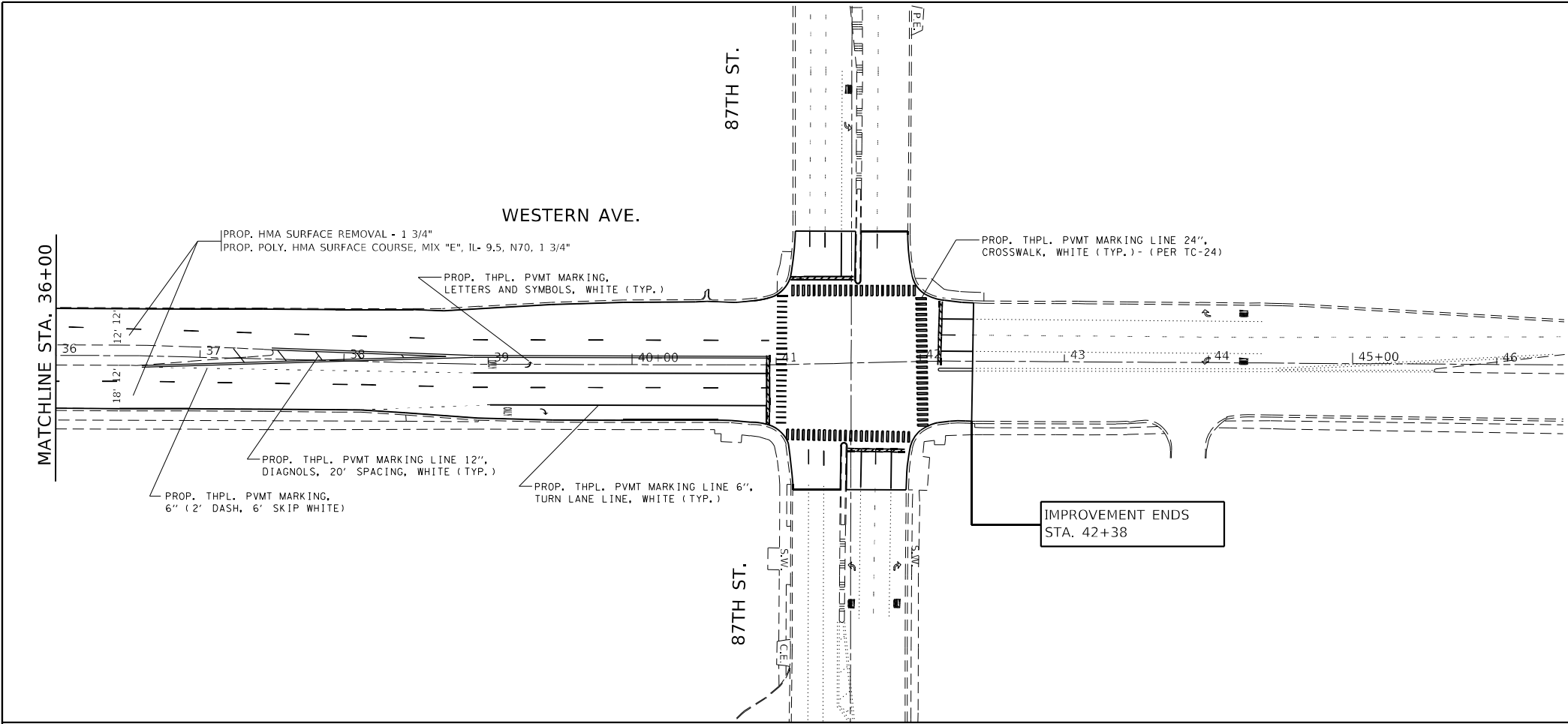

MODEL PATH: \\n:\public\ew\benlley.com\PI\DOT\Documents\DOT_Offices\District_1\Projects\ID126922\CAD\Drawings\Drawings\ID126922-ah-p\plan.dwg
 FILE NAME: \\n:\public\ew\benlley.com\PI\DOT\Documents\DOT_Offices\District_1\Projects\ID126922\CAD\Drawings\Drawings\ID126922-ah-p\plan.dwg

| | | |
|------------------------------|------------|-----------|
| USER NAME = addis,abebeaw | DESIGNED - | REVISED - |
| PLOT SCALE = 99.9866 * / in. | DRAWN - | REVISED - |
| PLOT DATE = 5/9/2023 | CHECKED - | REVISED - |
| | DATE - | REVISED - |

STATE OF ILLINOIS
DEPARTMENT OF TRANSPORTATION

| | | | |
|---|-------|----|--------|
| ROADWAY & PAVEMENT MARKING PLAN WESTERN AVE. (87th ST. - 91st ST.) | | | |
| SCALE: 1"=50' | SHEET | OF | SHEETS |
| | STA. | TO | STA. |

| | | | | |
|---------------------------|----------------|--------|--------------|-----------|
| F.A.P. RTE. | SECTION | COUNTY | TOTAL SHEETS | SHEET NO. |
| 370 | FAP 0370 22 RS | COOK | 18 | 7 |
| CONTRACT NO. 62T93 | | | | |
| ILLINOIS FED. AID PROJECT | | | | |

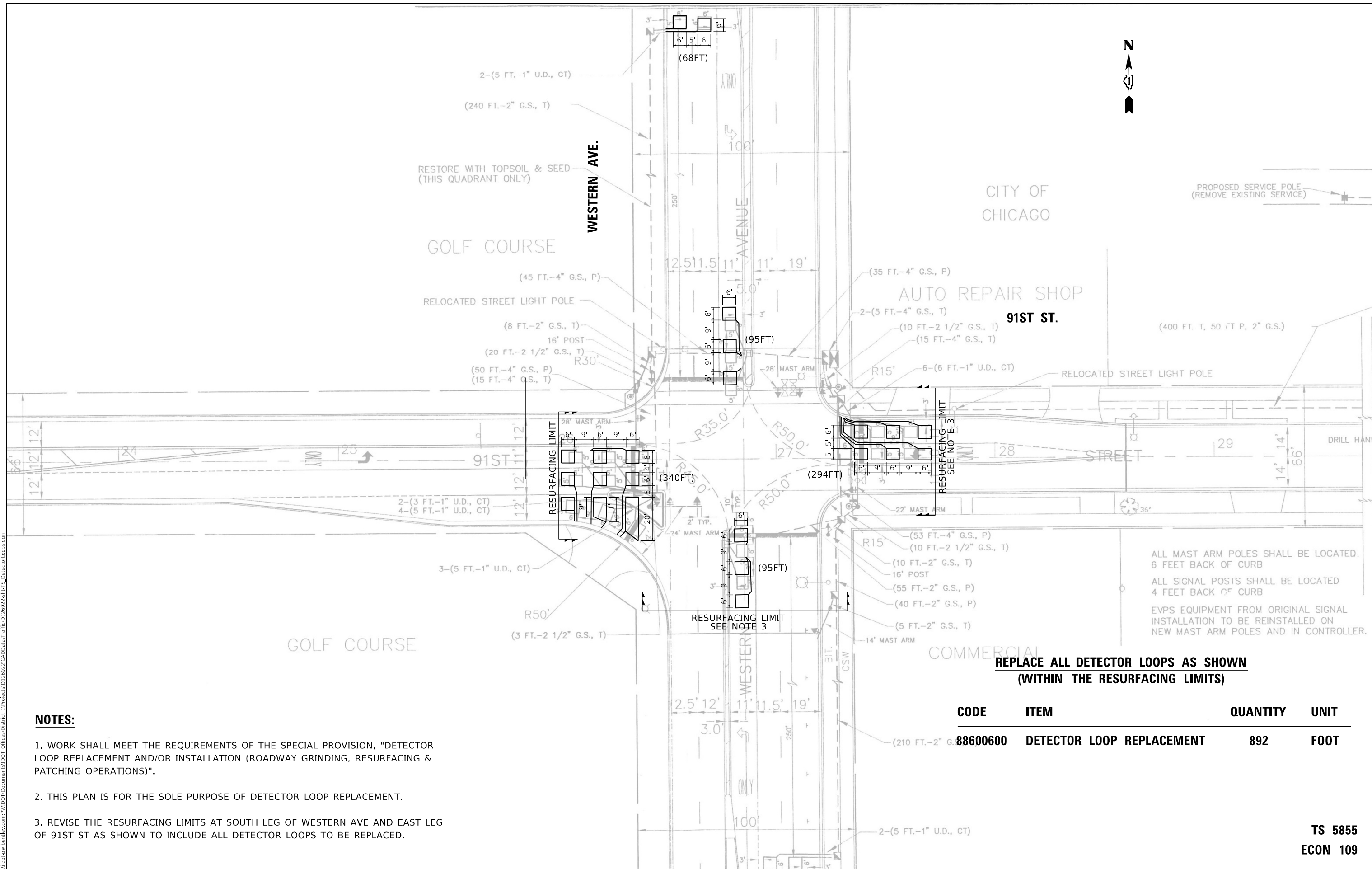

NOTES:

1. WORK SHALL MEET THE REQUIREMENTS OF THE SPECIAL PROVISION, "DETECTOR LOOP REPLACEMENT AND/OR INSTALLATION (ROADWAY GRINDING, RESURFACING & PATCHING OPERATIONS)".
2. THIS PLAN IS FOR THE SOLE PURPOSE OF DETECTOR LOOP REPLACEMENT.
3. REVISE THE RESURFACING LIMITS AT SOUTH LEG OF WESTERN AVE AND EAST LEG OF 91ST ST AS SHOWN TO INCLUDE ALL DETECTOR LOOPS TO BE REPLACED.

**REPLACE ALL DETECTOR LOOPS AS SHOWN
(WITHIN THE RESURFACING LIMITS)**

| CODE | ITEM | QUANTITY | UNIT |
|----------|---------------------------|----------|------|
| 88600600 | DETECTOR LOOP REPLACEMENT | 892 | FOOT |

ALL MAST ARM POLES SHALL BE LOCATED 6 FEET BACK OF CURB
 ALL SIGNAL POSTS SHALL BE LOCATED 4 FEET BACK OF CURB
 EVPS EQUIPMENT FROM ORIGINAL SIGNAL INSTALLATION TO BE REINSTALLED ON NEW MAST ARM POLES AND IN CONTROLLER.

MODEL: Default
 FILE: \\bluest-pw-bentley.com\P\W\DOT\Documents\1\DOT\Office\Traffic\1\Project\1\126922\CADD\DATA\Traffic\1\26922-sh-TS_Detector Loop.dgn

| | | |
|-----------------------------|-----------------|-----------|
| USER NAME = eddie.choi | DESIGNED - EEC | REVISED - |
| | DRAWN - EEC | REVISED - |
| PLOT SCALE = 40,0000 */ in. | CHECKED - KK | REVISED - |
| PLOT DATE = 10/11/2022 | DATE - 10/11/22 | REVISED - |

**STATE OF ILLINOIS
DEPARTMENT OF TRANSPORTATION**

**DETECTOR LOOP REPLACEMENT PLAN
WESTERN AVE. AT 91ST ST.**

SCALE: 1"=20' SHEET OF SHEETS STA. TO STA.

| | | | | |
|---------------------------|----------------|--------|--------------|-----------|
| F.A. RTE. | SECTION | COUNTY | TOTAL SHEETS | SHEET NO. |
| | FAP 0370 22 RS | COOK | | |
| CONTRACT NO. 62T93 | | | | |
| ILLINOIS FED. AID PROJECT | | | | |

**TS 5855
ECON 109**

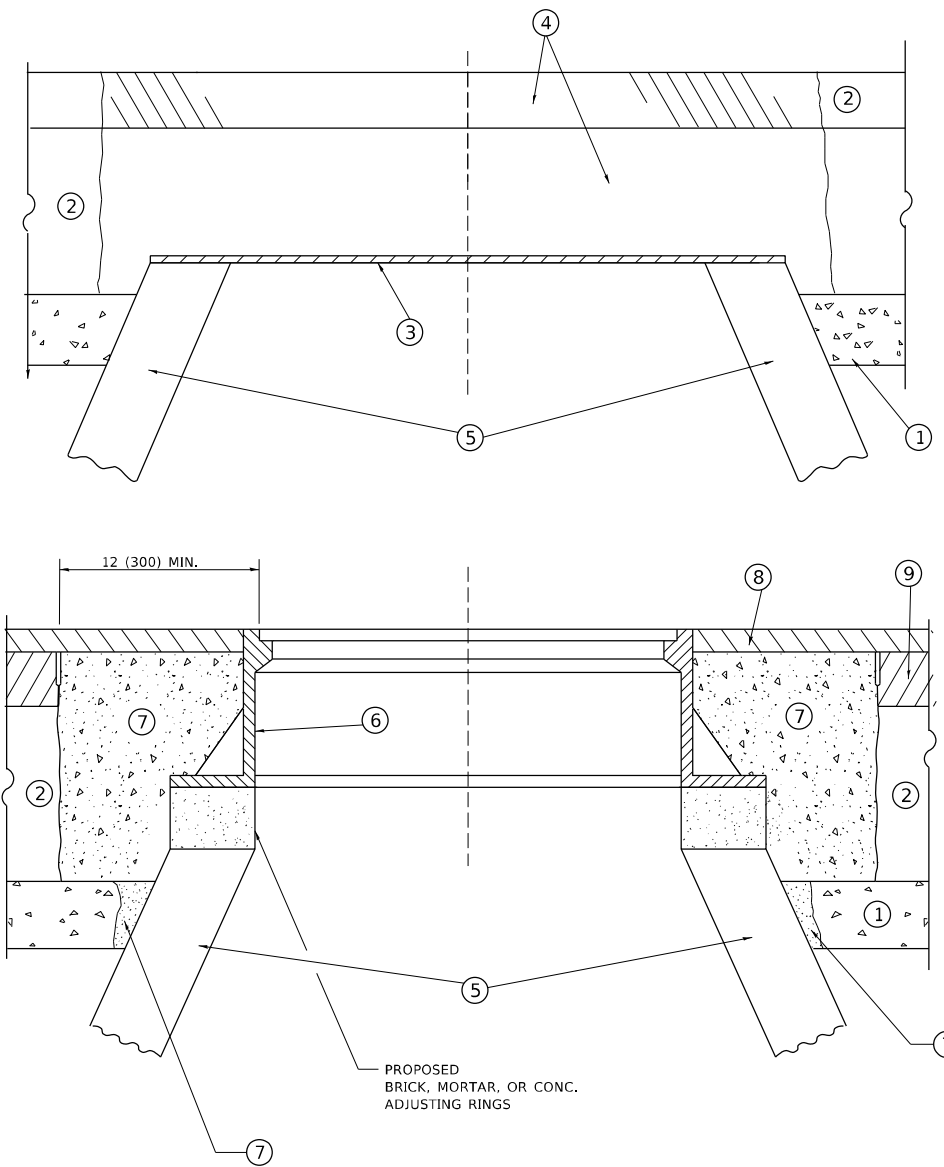

**DETAILS FOR FRAMES AND LIDS ADJUSTMENT
WITH MILLING**

NOTES

1. EXISTING BROKEN FRAMES AND LIDS SHALL BE REMOVED AND DISPOSED OF BY THE CONTRACTOR AND SHALL BE REPLACED AS DIRECTED BY THE ENGINEER. REPLACEMENT FRAMES AND LIDS WILL BE PAID FOR IN ACCORDANCE WITH ARTICLE 109.04 OF THE STANDARD SPECIFICATIONS UNLESS A SEPARATE PAY ITEM HAS BEEN PROVIDED.
2. IF THE EXISTING LIDS ARE OPEN, THE FRAME WILL BE ADJUSTED TO THE ELEVATION OF THE MILLED PAVEMENT SURFACE PRIOR TO THE MILLING OPERATION. THE FRAME WILL NOT BE REMOVED AND COVERED BY THE METAL PLATE.
3. CITY OF CHICAGO CASTINGS ARE THE PROPERTY OF THE CITY AND THE CONTRACTOR SHALL NOTIFY THE CITY FOR REMOVAL AND DISPOSITION OF THE CASTINGS.
4. THE METAL PLATE USED TO COVER THE STRUCTURE SHALL REMAIN THE PROPERTY OF THE CONTRACTOR.

CONSTRUCTION PROCEDURES

STAGE 1 (BEFORE PAVEMENT MILLING)

- A) REMOVE A MINIMUM OF 12 (300) OF THE PAVEMENT FROM AROUND THE STRUCTURE.
- B) REMOVE THE EXISTING FRAME AND LID FROM THE STRUCTURE.
- C) COVER THE STRUCTURE OPENING WITH A 36 (900) DIAMETER METAL PLATE.
- D) BACKFILL WITH CRUSHED STONE AND HMA SURFACE MIX APPROVED BY THE ENGINEER. (MIN. 1 1/2 (40) HMA TO REMAIN AFTER MILLING).

STAGE 2 (AFTER PAVEMENT MILLING)

- A) REMOVE THE HMA SURFACE MIX AND CRUSHED STONE.
- B) INSTALL THE FRAME AND LID; ADJUST THE FRAME TO ITS FINAL SURFACE ELEVATION.
- C) THE SURROUNDING SPACE SHALL BE FILLED WITH CLASS*PP-1 CONCRETE TO THE ELEVATION OF THE SURFACE OF THE EXISTING BASE COURSE OR THE BINDER COURSE.

* UNLESS OTHERWISE SPECIFIED IN THE PLANS.

THE PROCEDURE EXPLAINED ABOVE SHALL CONFORM TO THE APPLICABLE PORTIONS OF SECTIONS 353, 406, 602, AND 603 OF THE STANDARD SPECIFICATIONS EXCEPT THAT "THE CONTRACTOR SHALL ADJUST THE STRUCTURES TO THE FINISHED PAVEMENT ELEVATION NO MORE THAN 5 CALENDAR DAYS PRIOR TO PLACEMENT OF THE FINAL LIFT OF SURFACE UNLESS APPROVED BY THE ENGINEER."

LEGEND

- | | |
|--|-------------------------------|
| ① SUB-BASE GRANULAR MATERIAL | ⑥ FRAME AND LID (SEE NOTES) |
| ② EXISTING PAVEMENT | ⑦ CLASS*PP-1 CONCRETE |
| ③ 36 (900) DIAMETER METAL PLATE | ⑧ PROPOSED HMA SURFACE COURSE |
| ④ PROPOSED CRUSHED STONE AND HMA SURFACE MIX | ⑨ PROPOSED HMA BINDER COURSE |
| ⑤ EXISTING STRUCTURE | |

LOCATION OF STRUCTURES

THE CONTRACTOR WILL BE REQUIRED TO KEEP A RECORD OF THE LOCATIONS OF THE BURIED STRUCTURES ACCORDING TO THE STATION AND DISTANCE LEFT OR RIGHT OF THE CENTERLINE OF PAVEMENT. UPON COMPLETION OF THE WORK, THE CONTRACTOR WILL DELIVER THE RECORD TO THE ENGINEER.

BASIS OF PAYMENT

1. REMOVING FRAMES AND LIDS ON DRAINAGE AND UTILITY STRUCTURES IN THE PAVEMENT PRIOR TO MILLING, AND ADJUSTING TO FINAL GRADE PRIOR TO PLACING THE SURFACE COURSE, WILL BE PAID FOR AT THE CONTRACT UNIT PRICE EACH FOR "FRAMES AND LIDS TO BE ADJUSTED (SPECIAL)."
2. THIS WORK WILL NOT BE PAID FOR WHEN DRAINAGE AND UTILITY STRUCTURES ARE SPECIFIED FOR PAYMENT AS STRUCTURE RECONSTRUCTION.
3. NEW FRAMES AND LIDS, WHEN SPECIFIED, WILL BE PAID FOR SEPARATELY.
4. WHEN STRUCTURES ARE TO BE ADJUSTED OR RECONSTRUCTED, THE LOWERING AND RAISING OF THE FRAMES AND LIDS WILL NOT BE PAID FOR SEPARATELY BUT WILL BE INCLUDED IN THE COST OF THE CORRESPONDING PAY ITEM.

ALL DIMENSIONS ARE IN INCHES (MILLIMETERS) UNLESS OTHERWISE SHOWN

MODEL: D:\info\... FILE: I:\data\... PROJECT: 11\Project\3D1268221\CAD\DATA\Design\BdfStg.dgn

| | | |
|-------------------------------|--------------------|-----------------------------|
| USER NAME = adcis.abebaw | DESIGNED - R. SHAH | REVISED - R. BORO 01-01-07 |
| | DRAWN - | REVISED - R. BORO 03-09-11 |
| PLOT SCALE = 100.0194 ' / in. | CHECKED - | REVISED - R. BORO 12-06-11 |
| PLOT DATE = 5/9/2023 | DATE - 10-25-94 | REVISED - K. SMITH 11-18-22 |

**STATE OF ILLINOIS
DEPARTMENT OF TRANSPORTATION**

**DETAILS FOR
FRAMES AND LIDS ADJUSTMENT WITH MILLING**

SCALE: NONE SHEET 1 OF 1 SHEETS STA. TO STA.

| | | | | |
|---------------------------|----------------|--------|--------------------|-----------|
| F.A.P. RTE. | SECTION | COUNTY | TOTAL SHEETS | SHEET NO. |
| 370 | FAP 0370 22 RS | COOK | 18 | 9 |
| BD600-03 (BD-08) | | | CONTRACT NO. 62T93 | |
| ILLINOIS FED. AID PROJECT | | | | |

METHOD OF MEASUREMENT

REFER TO SECTION 442 OF THE STANDARD SPECIFICATIONS FOR ROAD AND BRIDGE CONSTRUCTION AND THE RECURRING SPECIAL PROVISION "PATCHING WITH HOT-MIX ASPHALT OVERLAY REMOVAL."

BASIS OF PAYMENT

1. REFER TO SECTION 442 OF THE STANDARD SPECIFICATIONS FOR ROAD AND BRIDGE CONSTRUCTION AND THE RECURRING SPECIAL PROVISION "PATCHING WITH HOT-MIX ASPHALT OVERLAY REMOVAL."
2. SAW CUT/SCORING OF EXISTING HMA OVERLAY IS INCLUDED IN THE COST OF PAVEMENT PATCHING.
3. SAW CUT/SCORING OF EXISTING PAVEMENT IS INCLUDED IN THE COST OF PAVEMENT PATCHING.

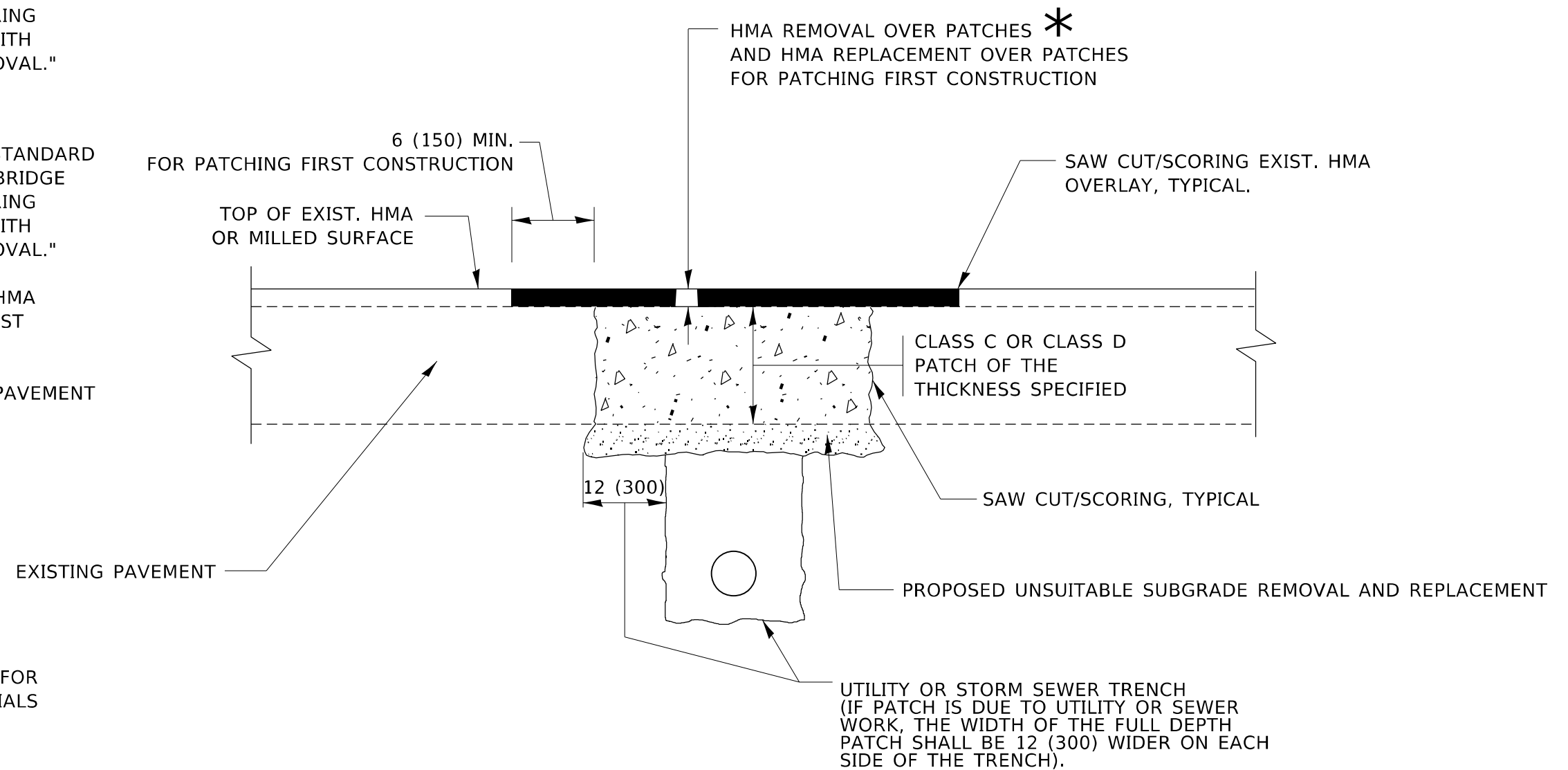

* SEE TYPICAL SECTIONS FOR THICKNESS AND MATERIALS

SEQUENCE OF CONSTRUCTION (PATCHING FIRST)

1. REMOVE THE EXISTING HMA MATERIAL OVER THE AREA TO BE PATCHED.
2. REMOVE AND REPLACE WITH CLASS C OR D PATCH.
3. REPLACE HMA MATERIAL OVER THE AREA TO BE PATCHED.

SEQUENCE OF CONSTRUCTION (MILLING FIRST)

1. MILL HMA FIRST IF THERE IS AT LEAST 4½ INCHES OR MORE OF HMA MATERIAL ON TOP OF THE EXISTING PAVEMENT OR IF THE PAVEMENT IS FULL DEPTH HMA. A MINIMUM OF 2 INCHES OF HMA MATERIAL SHALL BE IN PLACE AFTER MILLING.
2. REMOVE AND REPLACE WITH FULL DEPTH CLASS D PATCHES TO TOP OF MILLED SURFACE.

ALL DIMENSIONS ARE IN INCHES (MILLIMETERS) UNLESS OTHERWISE SHOWN.

MODEL: Defaul... FILE: hame... \p\slide\paw\beniley.com\PM\1001\Documents\DOT_Offices\District_1\Projects\10126822\CADD\Asa\Design\Bk5\Std.dgn

| | | |
|------------------------------|--------------------|-----------------------------|
| USER NAME = aadis.abebaw | DESIGNED - R. SHAH | REVISED - R. BORO 01-01-07 |
| | DRAWN - | REVISED - R. BORO 09-04-07 |
| PLOT SCALE = 99.9877 ' / in. | CHECKED - | REVISED - K. ENG 10-27-08 |
| PLOT DATE = 5/9/2023 | DATE - 10-25-94 | REVISED - K. SMITH 11-18-22 |

STATE OF ILLINOIS
DEPARTMENT OF TRANSPORTATION

PAVEMENT PATCHING FOR
HMA SURFACED PAVEMENT

SCALE: NONE SHEET 1 OF 1 SHEETS STA. TO STA.

| F.A.P. RTE. | SECTION | COUNTY | TOTAL SHEETS | SHEET NO. |
|---------------------------|----------------|--------|--------------------|-----------|
| 370 | FAP 0370 22 RS | COOK | 18 | 10 |
| BD400-04 (BD-22) | | | CONTRACT NO. 62T93 | |
| ILLINOIS FED. AID PROJECT | | | | |

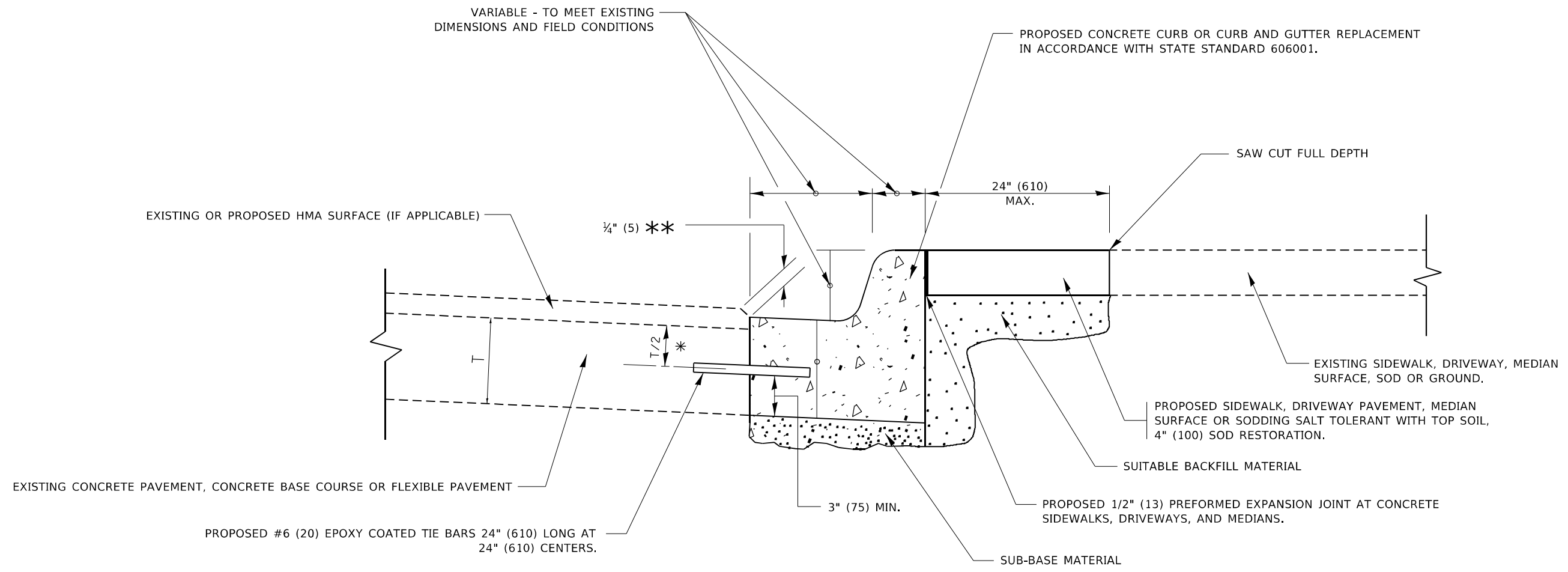

- * 3" (75) MINIMUM FROM TOP AND BOTTOM OF THE CONCRETE PAVEMENT OR BASE COURSE.
- ** IF THE FINAL SURFACE OF THE PAVEMENT IS CONCRETE, THE GUTTER IS TO BE FLUSH WITH THE PAVEMENT.

CURB OR CURB AND GUTTER REMOVAL AND REPLACEMENT

ALL DIMENSIONS ARE IN INCHES (MILLIMETERS) UNLESS OTHERWISE SHOWN.

MODEL: Default
FILE NAME: g:\slide-show\berkeley.com\PI\DOT\Documents\DOT Offices\Bridget_1\Projects\126922\CAD\data\Drawn\BstS.dgn

| | | |
|------------------------------|----------------------|-----------------------------|
| USER NAME = addis.abebaw | DESIGNED - A. HOUSEH | REVISED - A. ABBAS 03-21-97 |
| | DRAWN - | REVISED - M. GOMEZ 01-22-01 |
| PLOT SCALE = 100.0342' / in. | CHECKED - | REVISED - R. BORO 12-15-09 |
| PLOT DATE = 5/9/2023 | DATE - 03-11-94 | REVISED - K. SMITH 07-11-19 |

**STATE OF ILLINOIS
DEPARTMENT OF TRANSPORTATION**

**CURB OR CURB AND GUTTER
REMOVAL AND REPLACEMENT**

SCALE: NONE SHEET 1 OF 1 SHEETS STA. TO STA.

| F.A.P. RTE. | SECTION | COUNTY | TOTAL SHEETS | SHEET NO. |
|---------------------------|----------------|--------|--------------------|-----------|
| 370 | FAP 0370 22 RS | COOK | 18 | 11 |
| BD600-06 (BD-24) | | | CONTRACT NO. 62T93 | |
| ILLINOIS FED. AID PROJECT | | | | |

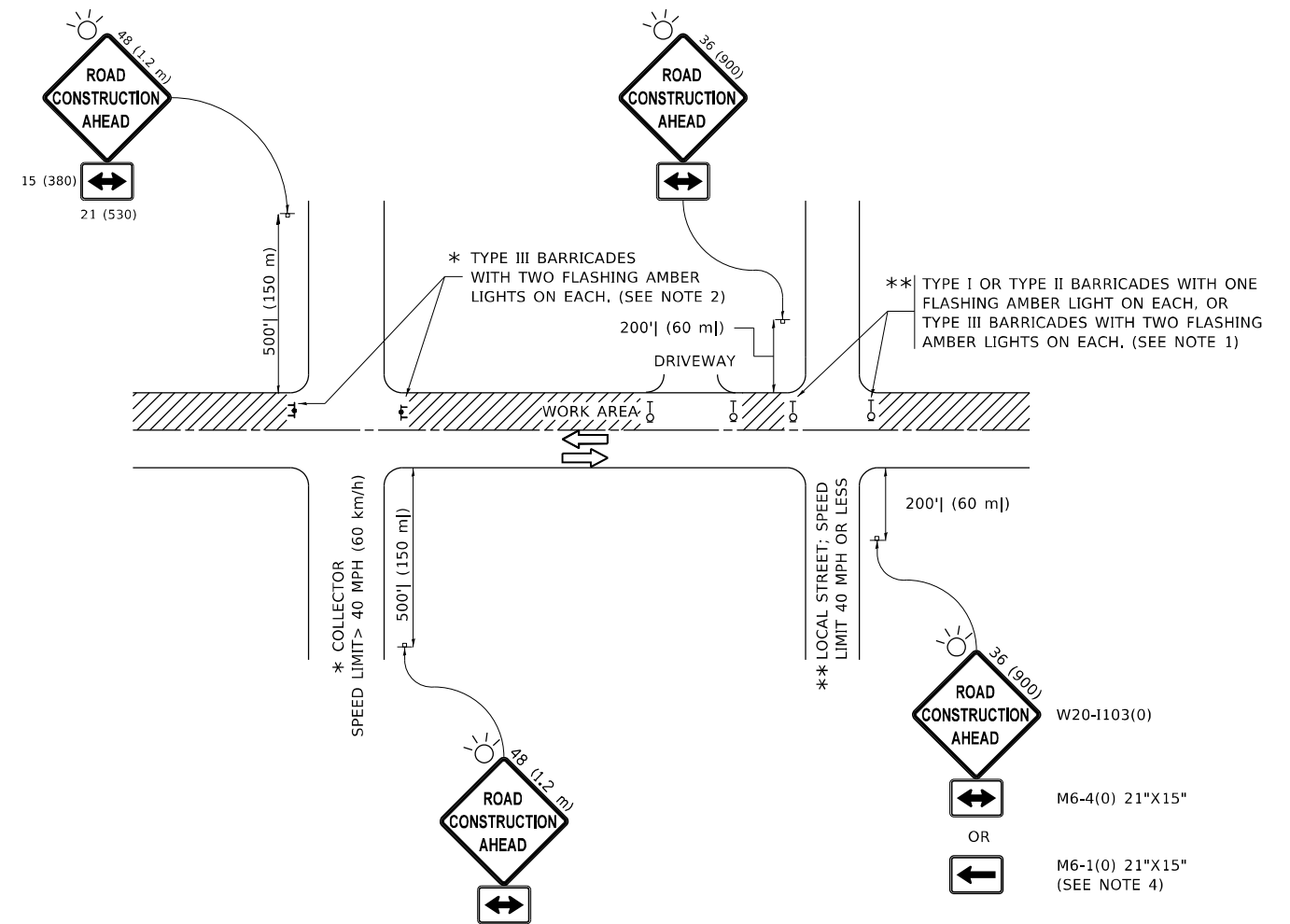

NOTES:

- SIDE ROAD WITH A SPEED LIMIT OF 40 MPH (60 km/h) OR LESS AS SHOWN ON THE DRAWING AND AS DIRECTED BY THE ENGINEER:
 - ONE "ROAD CONSTRUCTION AHEAD" SIGN 36 x 36 (900x900) WITH A FLASHER MOUNTED ON IT APPROXIMATELY 200' (60 m) IN ADVANCE OF THE MAIN ROUTE.
 - THE CLOSED PORTION OF THE MAIN ROUTE SHALL BE PROTECTED BY BLOCKING WITH TYPE I, TYPE II OR TYPE III BARRICADES, 1/3 OF THE CROSS SECTION OF THE CLOSED PORTION.
- SIDE ROAD WITH A SPEED LIMIT GREATER THAN 40 MPH (60 km/h) AS SHOWN ON THE DRAWING AND AS DIRECTED BY THE ENGINEER:
 - ONE "ROAD CONSTRUCTION AHEAD" SIGN 48 x 48 (1.2 m x 1.2 m) WITH A FLASHER MOUNTED ON IT APPROXIMATELY 500' (150 m) IN ADVANCE OF THE MAIN ROUTE.
 - THE CLOSED PORTION OF THE MAIN ROUTE SHALL BE PROTECTED BY BLOCKING WITH TYPE III BARRICADES, 1/2 OF THE CROSS SECTION OF THE CLOSED PORTION.
- CONES MAY BE SUBSTITUTED FOR BARRICADES OR DRUMS AT HALF THE SPACING DURING DAY OPERATIONS. CONES SHALL BE A MINIMUM OF 28 (710) IN HEIGHT.
- WHEN THE SIDE ROAD LIES BETWEEN THE BEGINNING OF THE MAINLINE SIGNING AND THE WORK ZONE, A SINGLE HEADED ARROW (M6-1) SHALL BE USED IN LIEU OF THE DOUBLE HEADED ARROW (M6-4).
- WHEN WORK IS BEING PERFORMED ON A SIDE ROAD OR DRIVEWAY, FOLLOW THE APPLICABLE STANDARD(S). THE DIRECTIONAL ARROW (M6-1 OR M6-4) SHALL BE COVERED OR REMOVED WHEN NO LONGER CONSISTENT WITH THE TRAFFIC CONTROL SET-UP.
- ADVANCE WARNING SIGNS ARE TO BE OMITTED ON DRIVEWAYS UNLESS OTHERWISE SPECIFIED IN THE PLANS OR BY THE ENGINEER.
- THE TRAFFIC CONTROL AND PROTECTION FOR SIDE ROADS, INTERSECTIONS, AND DRIVEWAYS SHALL BE INCLUDED IN THE COST OF SPECIFIED TRAFFIC CONTROL STANDARDS OR ITEMS.

All dimensions are in inches (millimeters) unless otherwise shown.

MODEL: Default
FILE NAME: c:\w\geocpaw\ben\paw.com\paw\DOT\Documents\DOT Office\District_1\Projects\ID126922\CADD\Drawn\Drawn\Drawn\Drawn.dgn

| | | |
|-----------------------------|-------------------|---------------------------------|
| USER NAME = addis.abebaw | DESIGNED - L.H.A. | REVISED - A. HOUSEH 10-15-96 |
| | DRAWN - | REVISED - T. RAMMACHER 01-06-00 |
| PLOT SCALE = 99.8857' / in. | CHECKED - | REVISED - A. SCHUETZE 07-01-13 |
| PLOT DATE = 5/9/2023 | DATE - 06-89 | REVISED - A. SCHUETZE 09-15-16 |

**STATE OF ILLINOIS
DEPARTMENT OF TRANSPORTATION**

**TRAFFIC CONTROL AND PROTECTION FOR
SIDE ROADS, INTERSECTIONS, AND DRIVEWAYS**

SCALE: NONE SHEET 1 OF 1 SHEETS STA. TO STA.

| | | | | |
|---------------------------|----------------|--------|--------------------|-----------|
| F.A.P. RTE. | SECTION | COUNTY | TOTAL SHEETS | SHEET NO. |
| 370 | FAP 0370 22 RS | COOK | 18 | 13 |
| TC-10 | | | CONTRACT NO. 62193 | |
| ILLINOIS FED. AID PROJECT | | | | |

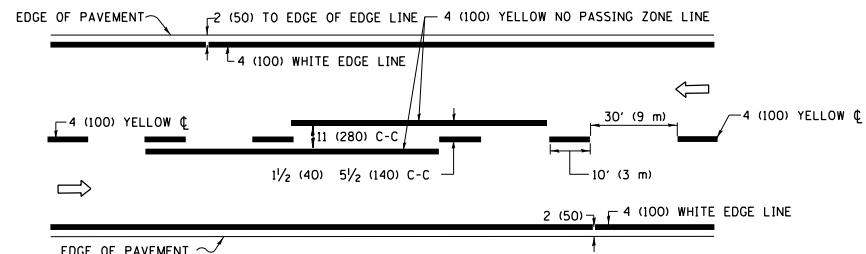

2-LANE ROADWAY

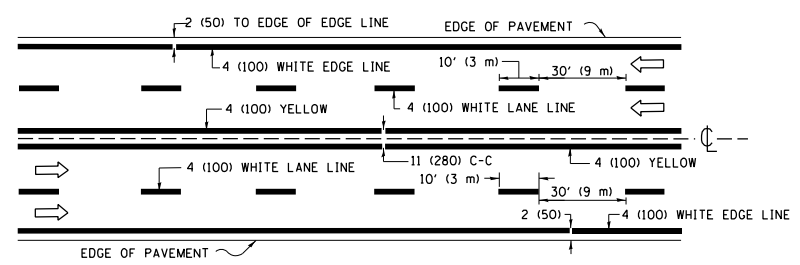

MULTI-LANE UNDIVIDED

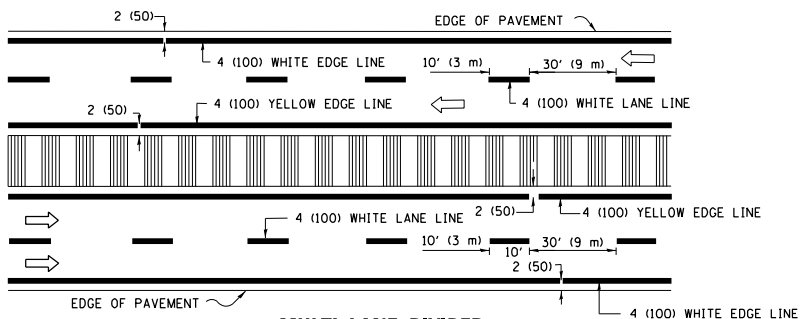

MULTI-LANE DIVIDED WITH MEDIAN

TYPICAL LANE AND EDGE LINE MARKING

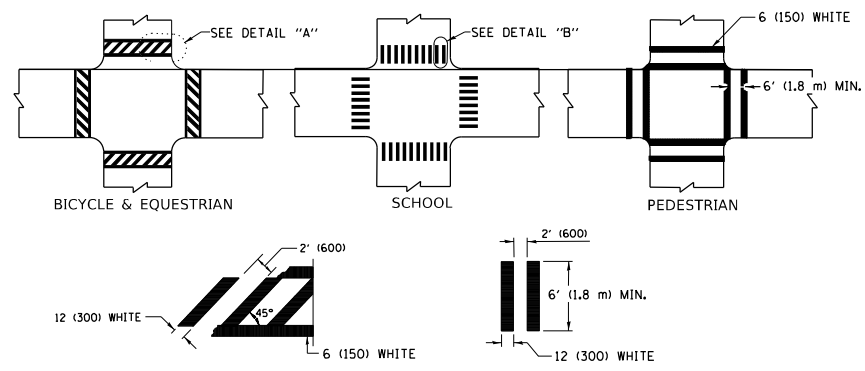

TYPICAL CROSSWALK MARKING

* MARKINGS SHALL BE INSTALLED PARALLEL TO THE CENTERLINE OF THE ROAD WHICH IT CROSSES

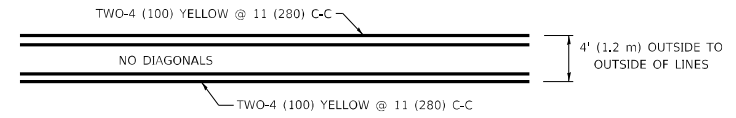

4' (1.2 m) WIDE MEDIANS ONLY

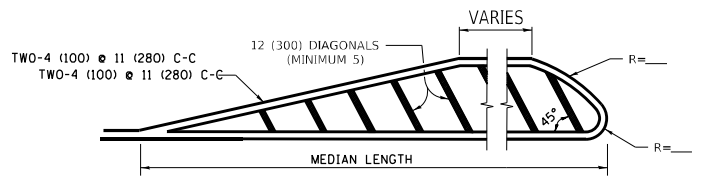

MEDIANS OVER 4' (1.2 m) WIDE

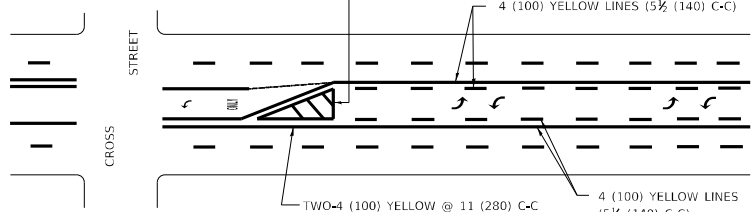

MEDIAN WITH TWO-WAY LEFT TURN LANE TYPICAL PAINTED MEDIAN MARKING

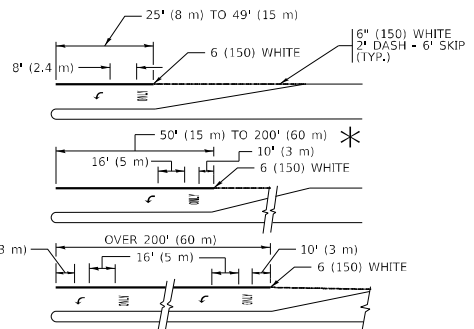

TYPICAL LEFT (OR RIGHT) TURN LANE TYPICAL TURN LANE MARKING

FULL SIZE LETTERS 8" (2.4 m) AND ARROWS SHALL BE USED. AREA = 15.6 SQ. FT. (1.5 m²) ONLY AREA = 20.8 SQ. FT. (1.9 m²)

* TURN LANES IN EXCESS OF 400' (120 m) IN LENGTH MAY HAVE AN ADDITIONAL SET OF ARROW - "ONLY" INSTALLED MIDWAY BETWEEN THE OTHER TWO SETS OF ARROW - "ONLY".

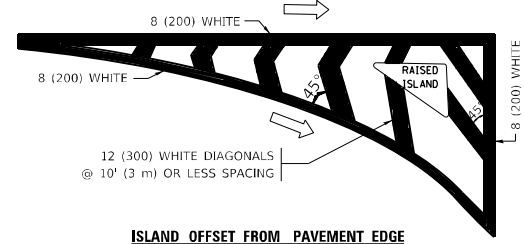

ISLAND OFFSET FROM PAVEMENT EDGE

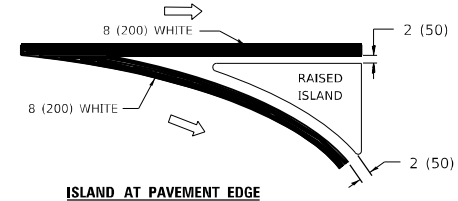

ISLAND AT PAVEMENT EDGE TYPICAL ISLAND MARKING

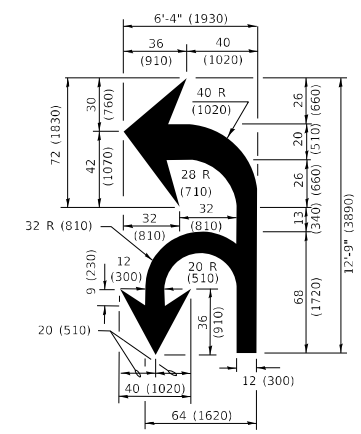

COMBINATION LEFT AND U-TURN

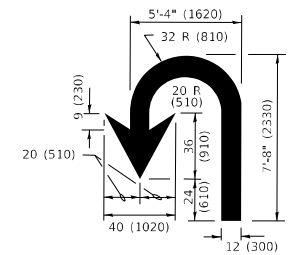

U-TURN

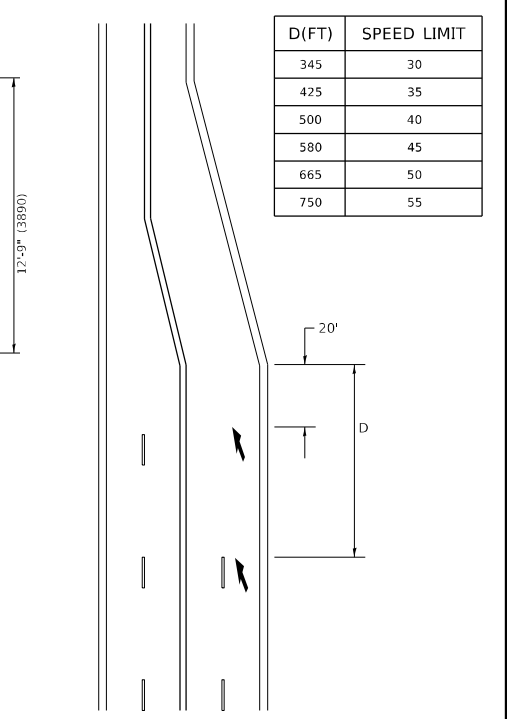

LANE REDUCTION TRANSITION
* LANE REDUCTION ARROWS REQUIRED AT SPEEDS OF 45 MPH OR GREATER OR WHEN SPECIFIED IN PLANS.

| TYPE OF MARKING | WIDTH OF LINE | PATTERN | COLOR | SPACING / REMARKS |
|--|--|------------------------------|---|--|
| CENTERLINE ON 2 LANE PAVEMENT | 4 (100) | SKIP-DASH | YELLOW | 10' (3 m) LINE WITH 30' (9 m) SPACE |
| CENTERLINE ON MULTI-LANE UNDIVIDED PAVEMENT | 2 @ 4 (100) | SOLID | YELLOW | 11 (280) C-C |
| NO PASSING ZONE LINES: FOR ONE DIRECTION FOR BOTH DIRECTIONS | 4 (100) 2 @ 4 (100) | SOLID SOLID | YELLOW YELLOW | 5 1/2 (140) C-C FROM SKIP-DASH CENTERLINE 11 (280) C-C OMIT SKIP-DASH CENTERLINE BETWEEN |
| LANE LINES | 4 (100) 5 (125) ON FREEWAYS | SKIP-DASH SKIP-DASH | WHITE WHITE | 10' (3 m) LINE WITH 30' (9 m) SPACE |
| DOTTED LINES (EXTENSIONS OF CENTER, LANE OR TURN LANE MARKINGS) | SAME AS LINE BEING EXTENDED | SKIP-DASH | SAME AS LINE BEING EXTENDED | 2' (600) LINE WITH 6' (1.8 m) SPACE |
| EDGE LINES | 4 (100) | SOLID | YELLOW-LEFT WHITE-RIGHT | OUTLINE MEDIANS IN YELLOW |
| TURN LANE MARKINGS | 6 (150) LINE: FULL SIZE LETTERS & SYMBOLS (8" (2.4m)) | SOLID | WHITE | SEE TYPICAL TURN LANE MARKING DETAIL |
| TWO WAY LEFT TURN MARKING | 2 @ 4 (100) EACH DIRECTION 8' (2.4m) LEFT ARROW | SKIP-DASH AND SOLID IN PAIRS | YELLOW WHITE | 10' (3 m) LINE WITH 30' (9 m) SPACE FOR SKIP-DASH; 5 1/2 (140) C-C BETWEEN SOLID LINE AND SKIP-DASH LINE SEE TYPICAL TWO-WAY LEFT TURN MARKING DETAIL |
| CROSSWALK LINES (PEDESTRIAN) A. DIAGONALS (BIKE & EQUESTRIAN) B. LONGTUDINAL BARS (SCHOOL) | 2 @ 6 (150) 12 (300) @ 45° 12 (300) @ 90° | SOLID SOLID SOLID | WHITE WHITE WHITE | NOT LESS THAN 6' (1.8 m) APART 2' (600) APART SEE TYPICAL CROSSWALK MARKING DETAILS. |
| STOP LINES | 24 (600) | SOLID | WHITE | PLACE 4' (1.2 m) IN ADVANCE OF AND PARALLEL TO CROSSWALK, IF PRESENT, OTHERWISE, PLACE AT DESIRED STOPPING POINT, PARALLEL TO CROSSROAD CENTERLINE, WHERE POSSIBLE |
| PAINTED MEDIANS | 2 @ 4 (100) WITH 12 (300) DIAGONALS @ 45° NO DIAGONALS USED FOR 4' (1.2 m) WIDE MEDIANS | SOLID | YELLOW: TWO WAY TRAFFIC WHITE: ONE WAY TRAFFIC | 11 (280) C-C FOR THE DOUBLE LINE SEE TYPICAL PAINTED MEDIAN MARKING. |
| GORE MARKING AND CHANNELIZING LINES | 8 (200) WITH 12 (300) DIAGONALS @ 45° | SOLID | WHITE | DIAGONALS: 15' (4.5 m) C-C (LESS THAN 30MPH (50 km/h)) 20' (6 m) C-C (30MPH (50 km/h) TO 45MPH (70 km/h)) 30' (9 m) C-C (OVER 45MPH (70 km/h)) |
| RAILROAD CROSSING | 24 (600) TRANSVERSE LINES; "RR" IS 6' (1.8 m) LETTERS; 16 (400) LINE FOR "X" | SOLID | WHITE | SEE STATE STANDARD 780001 AREA OF: "R"=3.6 SQ. FT. (0.33 m ²) EACH "X"=54.0 SQ. FT. (5.0 m ²) |
| SHOULDER DIAGONALS (REQUIRED FOR SHOULDERS ≥ 8') | 12 (300) @ 45° | SOLID | WHITE - RIGHT YELLOW - LEFT | 50' (15 m) C-C (LESS THAN 30MPH (50 km/h)) 75' (25 m) C-C (30 MPH (50 km/h) TO 45MPH (70 km/h)) 150' (45 m) C-C (OVER 45MPH (70 km/h)) |
| U TURN ARROW | SEE DETAIL | SOLID | WHITE | 16.3 SF |
| 2 ARROW COMBINATION LEFT AND U TURN | SEE DETAIL | SOLID | WHITE | 30.4 SF |

FOR FURTHER DETAILS ON PAVEMENT MARKING REFER TO STANDARD SPECIFICATIONS FOR ROAD AND BRIDGE CONSTRUCTION AND STATE STANDARD 780001.

All dimensions are in inches (millimeters) unless otherwise shown.

MODEL: Default; FILE: \\ibpaw-bamfpc.com\PI\DOT\Documents\DOT - Offices\Dist\et 1\Projects\126927\CAD\Plan\Design\Bk5\c.dwg

| | | |
|------------------------------|------------------------------|------------------------------|
| USER NAME = addis,abebaw | DESIGNED - EVERS | REVISED - C. JUCIUS 09-09-09 |
| DRAWN - | REVISED - C. JUCIUS 07-01-13 | |
| PLOT SCALE = 100,1074' / in. | CHECKED - | REVISED - C. JUCIUS 12-21-15 |
| PLOT DATE = 5/9/2023 | DATE - 03-19-90 | REVISED - C. JUCIUS 04-12-16 |

STATE OF ILLINOIS DEPARTMENT OF TRANSPORTATION

DISTRICT ONE TYPICAL PAVEMENT MARKINGS

SCALE: NONE SHEET 1 OF 2 SHEETS STA. TO STA.

| | | | | |
|---------------------------|------------------------|-------------|--------------------|---------------|
| F.A.P RTE. 370 | SECTION FAP 0370 22 RS | COUNTY COOK | TOTAL SHEETS 18 | SHEET NO. 14A |
| TC-13 | | | CONTRACT NO. 62T93 | |
| ILLINOIS FED. AID PROJECT | | | | |

TURN BAY ENTRANCE AT START OF LANE CLOSURE TAPER

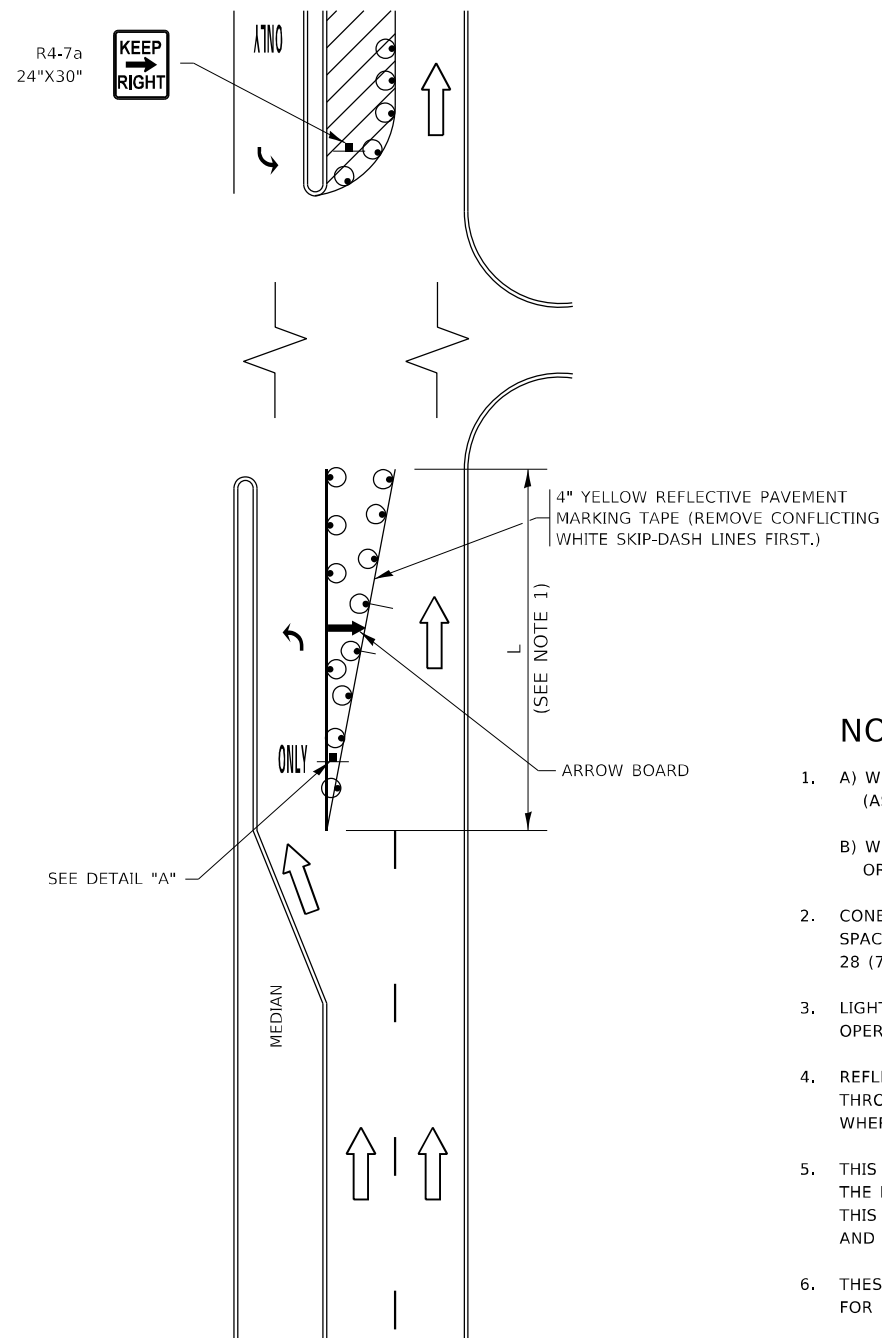

FIGURE 1

TURN BAY ENTRANCE WITHIN A LANE CLOSURE

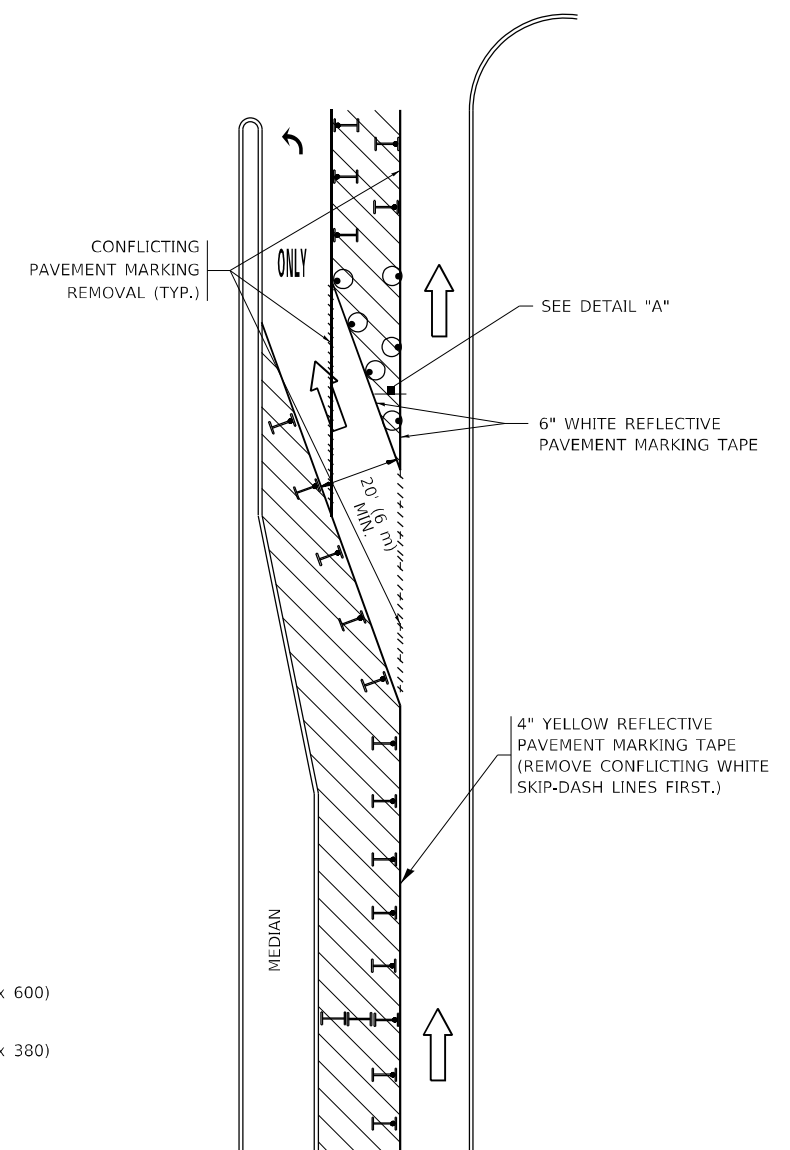

FIGURE 2

LEGEND

- WORK AREA
- LANE OPEN TO TRAFFIC
- ARROW BOARD
- TYPE I OR II BARRICADE OR DRUM WITH STEADY BURN LIGHT
- DRUM WITH STEADY BURN LIGHT
- SIGN ASSEMBLY
- TYPE I OR II CHECK BARRICADE WITH FLASHING LIGHT

NOTES:

1. A) WHEN "L" IS \leq THE STORAGE LENGTH OF THE TURN LANE (AS SHOWN IN FIG. 1), USE FIGURE 1.
B) WHEN "L" IS $>$ THE STORAGE LENGTH OF THE TURN LANE OR THE TURN LANE IS WITHIN THE LANE CLOSURE, USE FIGURE 2.
2. CONES MAY BE SUBSTITUTED FOR BARRICADES OR DRUMS AT HALF THE SPACING DURING DAY OPERATIONS. CONES SHALL BE A MINIMUM OF 28 (710) IN HEIGHT.
3. LIGHTS WILL NOT BE REQUIRED ON BARRICADES OR DRUMS FOR DAY OPERATIONS. ALL LIGHTS SHALL BE MONODIRECTIONAL.
4. REFLECTIVE TEMPORARY PAVEMENT MARKINGS SHALL BE PLACED THROUGHOUT THE BARRICADED AREAS OF EACH TURN BAY AS SHOWN WHERE THE CLOSURE TIME IS GREATER THAN FOURTEEN (14) DAYS.
5. THIS APPLICATION ALSO APPLIES WHEN WORK IS BEING PERFORMED IN THE RIGHT LANE(S) AND THE RIGHT TURN BAY IS TO REMAIN OPEN. UNDER THIS CONDITION, "RIGHT TURN LANE" R3-1100R 24 x 24 (600 x 600) AND M6-2R 21 x 15 (530 x 380) SHALL BE USED.
6. THESE CONTROLS SHALL SUPPLEMENT MAINLINE TRAFFIC CONTROL FOR LANE CLOSURES.
7. THE SIGNS SHALL BE MOUNTED ABOVE THE BARRICADES/DRUMS ON SEPARATE SIGN SUPPORTS THAT MEET NCHRP 350 OR MASH REQUIREMENTS.
8. TRAFFIC CONTROL AND PROTECTION AT TURN BAYS (TO REMAIN OPEN TO TRAFFIC) SHALL BE INCLUDED IN THE COST OF SPECIFIED TRAFFIC CONTROL STANDARDS OR ITEMS.

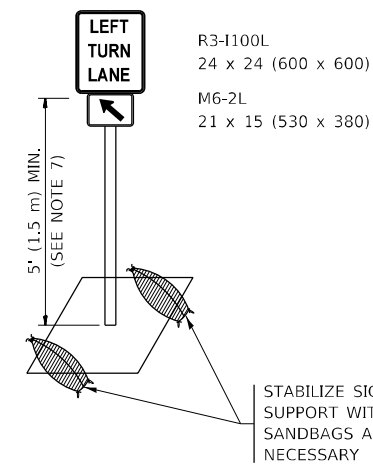

DETAIL A

All dimensions are in inches (millimeters) unless otherwise shown.

MODEL: Default
FILE NAME: I:\Illinois\dot\dot\Documents\DOT_Offices\District 1\Projects\0126922\CADD\AutoDesign\B6556.dgn

| | | |
|------------------------------|----------------------------------|--------------------------------|
| USER NAME = addis.abebeaw | DESIGNED - T. RAMMACHER 09-08-94 | REVISED - R. BORO 09-14-09 |
| DRAWN - A. HOUSEH 11-07-95 | REVISOR - A. SCHUETZE 07-01-13 | |
| PLOT SCALE = 100,0295' / in. | CHECKED - A. HOUSEH 10-12-96 | REVISED - A. SCHUETZE 09-15-16 |
| PLOT DATE = 5/9/2023 | DATE - T. RAMMACHER 01-06-00 | REVISED - |

**STATE OF ILLINOIS
DEPARTMENT OF TRANSPORTATION**

**TRAFFIC CONTROL AND PROTECTION AT TURN BAYS
(TO REMAIN OPEN TO TRAFFIC)**

SCALE: NONE SHEET 1 OF 1 SHEETS STA. TO STA.

| | | | | |
|---------------------------|------------------------|--------------------|-----------------|--------------|
| F.A.P. RTE. 370 | SECTION FAP 0370 22 RS | COUNTY COOK | TOTAL SHEETS 18 | SHEET NO. 15 |
| TC-14 | | CONTRACT NO. 62T93 | | |
| ILLINOIS FED. AID PROJECT | | | | |

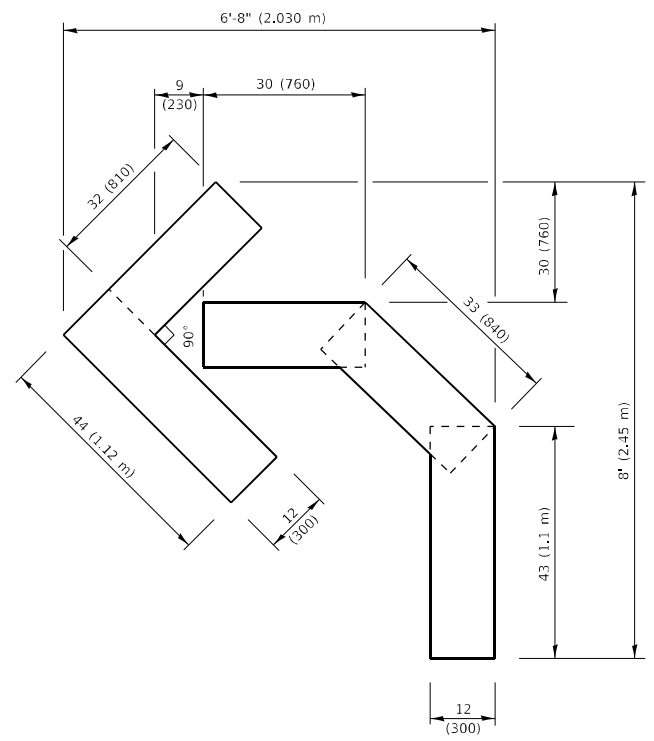

QUANTITY
 4 (100) LINE = 45.5 ft. (13.9 m)
 15.2 sq. ft. (1.41 sq. m)

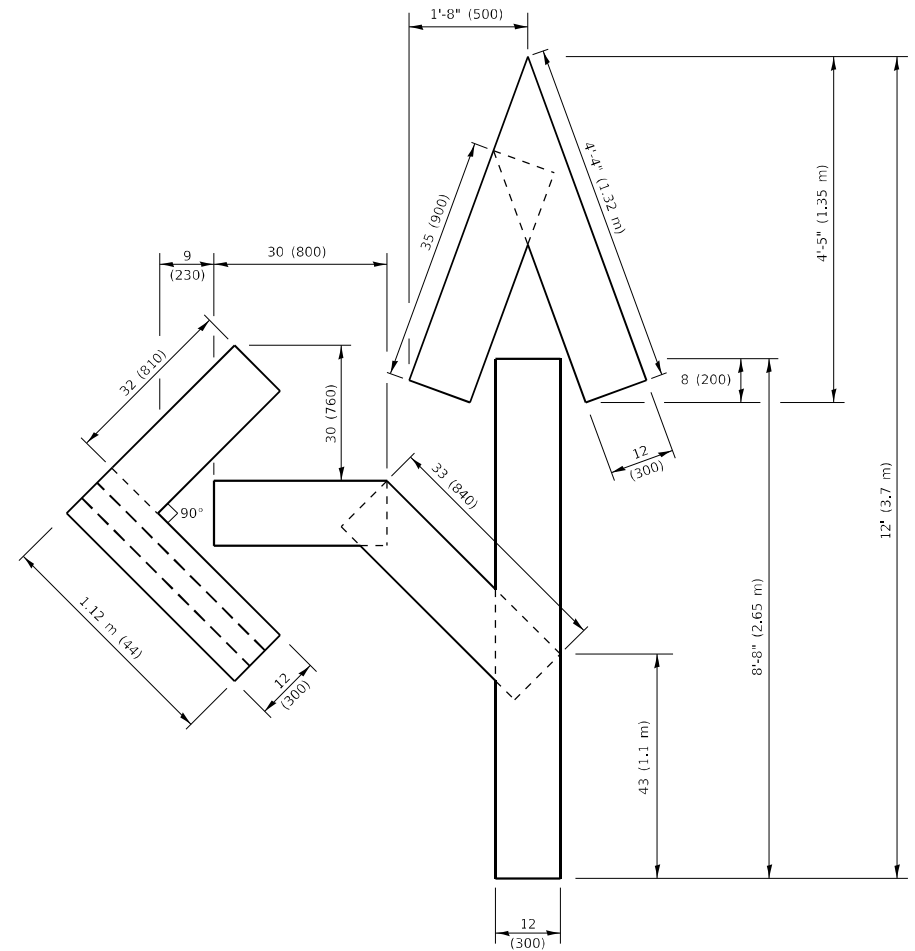

QUANTITY
 4 (100) LINE = 82.5 ft. (25.1 m)
 27.5 sq. ft. (2.53 sq. m)

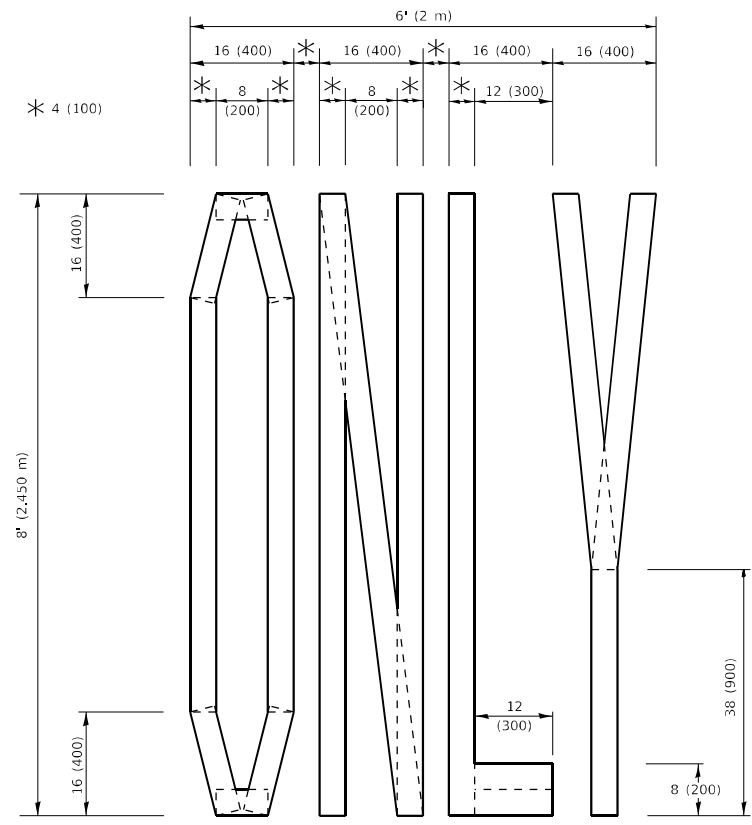

QUANTITY
 4 (100) LINE = 64.1 ft. (19.5 m)
 21.4 sq. ft. (1.99 sq. m)

NOTE:
 ALL QUANTITIES OF PLACEMENT ARE REPRESENTED IN LINEAR FEET OF 4" LINES TO MATCH THE 4" TEMPORARY TAPE PAY ITEM AND REPRESENTS THE TOTAL QUANTITY OF 4" TAPE REQUIRED.

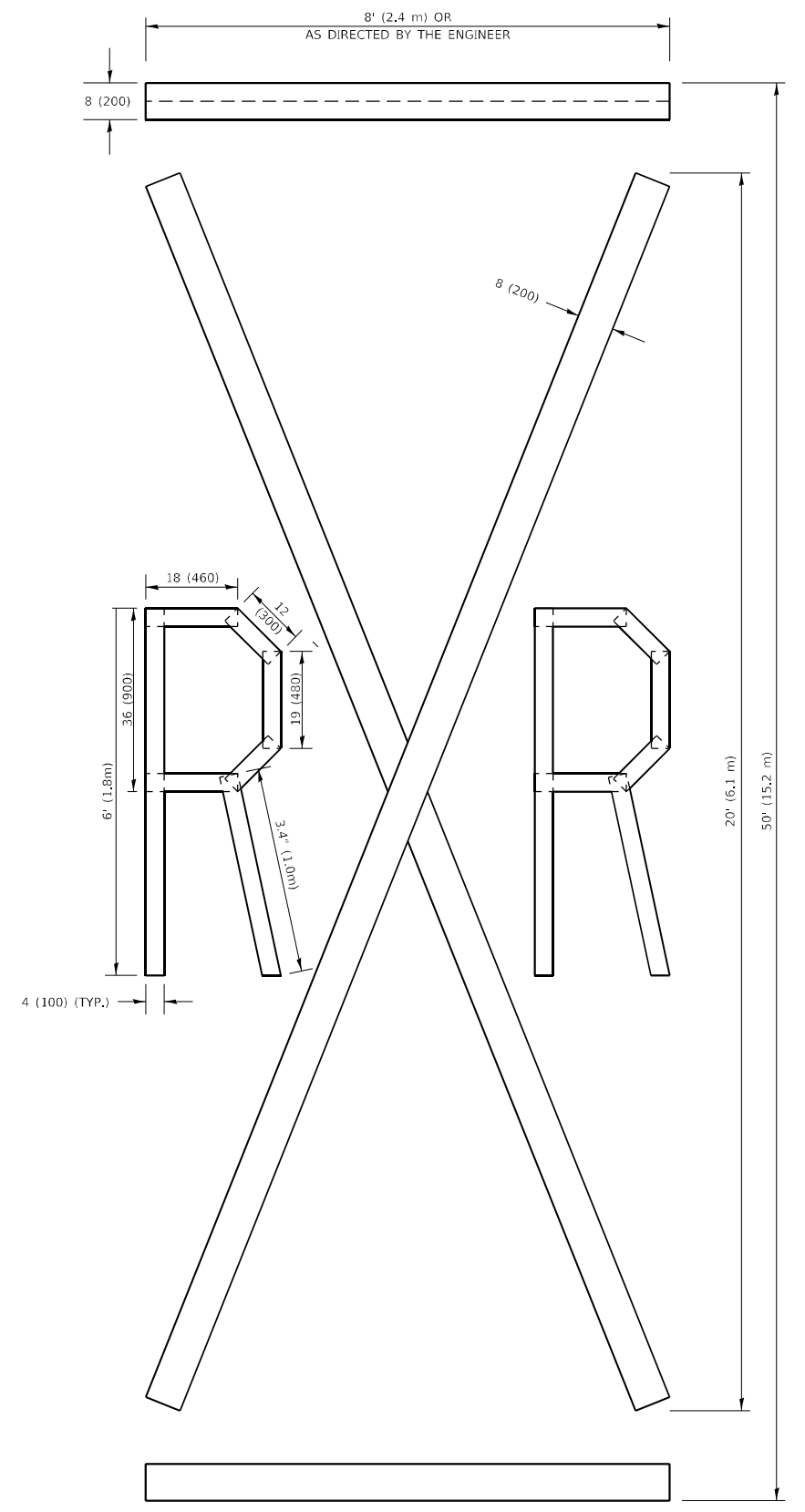

QUANTITY
 4 (100) LINE = 225.9 ft. (68.9 m)
 75.3 sq. ft. (6.99 sq. m)

All dimensions are in inches (millimeters) unless otherwise shown.

MODEL: Default
 FILE: Model: pwwilldscwzbenitfy.com\PI\DOT\Documents\DOT Offices\District 3\Projects\ID126922\CD\Draws\Design\Dist\Std.dgn

| | | |
|------------------------------|-----------------|---------------------------------|
| USER NAME = addis.abebaw | DESIGNED - | REVISED - T. RAMMACHER 03-02-98 |
| PLOT SCALE = 100.0350' / in. | DRAWN - | REVISED - E. GOMEZ 08-28-00 |
| PLOT DATE = 5/9/2023 | CHECKED - | REVISED - E. GOMEZ 08-28-00 |
| | DATE - 09-18-94 | REVISED - A. SCHUETZE 09-15-16 |

**STATE OF ILLINOIS
 DEPARTMENT OF TRANSPORTATION**

SHORT TERM PAVEMENT MARKING LETTERS AND SYMBOLS

| | | | | |
|---------------------------|------------------------|--------------------|-----------------|--------------|
| F.A.P. RTE. 370 | SECTION FAP 0370 22 RS | COUNTY COOK | TOTAL SHEETS 18 | SHEET NO. 16 |
| TC-16 | | CONTRACT NO. 62T93 | | |
| ILLINOIS FED. AID PROJECT | | | | |

SCALE: NONE SHEET 1 OF 1 SHEETS STA. TO STA.

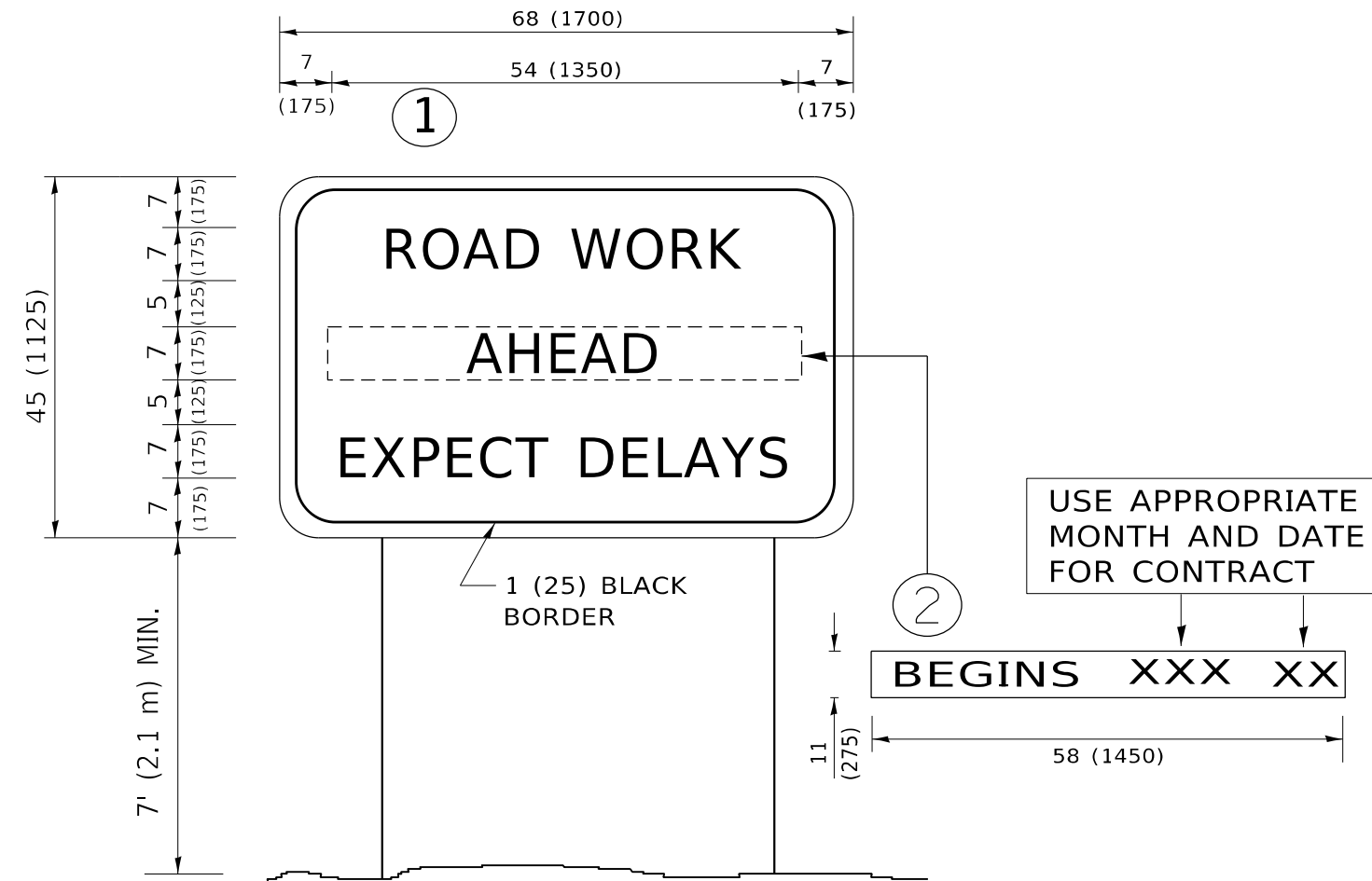

NOTES:

1. USE BLACK LETTERING ON ORANGE BACKGROUND.
2. ERECT SIGNS IN ADVANCE OF THE LOCATION FOR THE "ROAD CONSTRUCTION AHEAD" SIGN AT LOCATIONS AS DIRECTED BY THE ENGINEER.
3. ERECT SIGN ① WITH INSTALLED PANEL ② ONE WEEK PRIOR TO THE START OF CONSTRUCTION.
4. REMOVE PANEL ② SOON AFTER THE START OF CONSTRUCTION.
5. SEE SPECIAL PROVISION FOR "TEMPORARY INFORMATION SIGNING" FOR ADDITIONAL INFORMATION.
6. ONE SIGN ASSEMBLY EQUALS 25.70 SQ. FT. (2.3 SQ. M.)
7. SHALL BE PAID FOR AS TEMPORARY INFORMATION SIGNING.

ALL DIMENSIONS ARE IN INCHES (MILLIMETERS) UNLESS OTHERWISE SHOWN.

MODEL: I:\default
 FILE: \\s:\public\pww\henn\pww.com\PIV\DOT\Documents\DOT_Offices\Dist\ctc_1\Project\ID176927_CadData\Design\DS\SM.dgn

| | | | | | | | | | | | |
|------------------------------|------------|---------------------------------|---|---|---------|-------------|-----------------|------------------------|---------------------------|--------------------|--------------|
| USER NAME = addis.abebaw | DESIGNED - | REVISED - R. MIRS 09-15-97 | STATE OF ILLINOIS DEPARTMENT OF TRANSPORTATION | ARTERIAL ROAD INFORMATION SIGN | | | F.A.P. RTE. 370 | SECTION FAP 0370 22 RS | COUNTY COOK | TOTAL SHEETS 18 | SHEET NO. 17 |
| PLOT SCALE = 100.0396' / in. | CHECKED - | REVISED - T. RAMMACHER 02-02-99 | | | | | TC-22 | | | CONTRACT NO. 62T93 | |
| PLOT DATE = 5/9/2023 | DATE - | REVISED - C. JUCIUS 01-31-07 | | SCALE: NONE | SHEET 1 | OF 1 SHEETS | STA. | TO STA. | ILLINOIS FED. AID PROJECT | | |

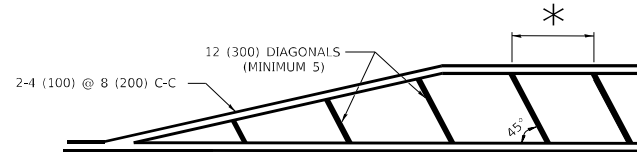
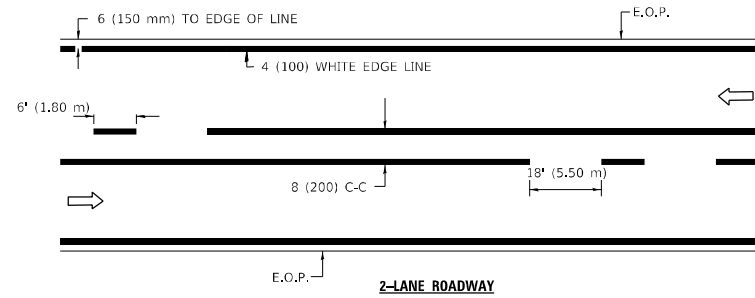

* FOR MEDIAN LENGTHS WHERE DIAGONAL SPACING CANNOT BE ATTAINED, USE 5 (FIVE) EQUALLY SPACED DIAGONAL LINES.
 * DIAGONAL LINE SPACING: 20' (6.1 m) C-C

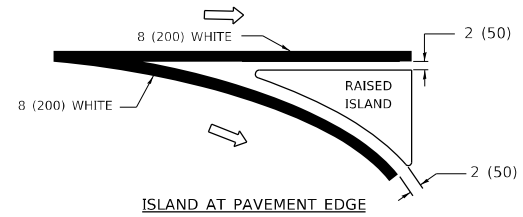
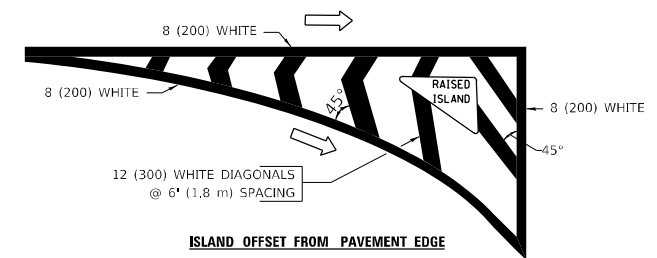

TYPICAL ISLAND MARKING

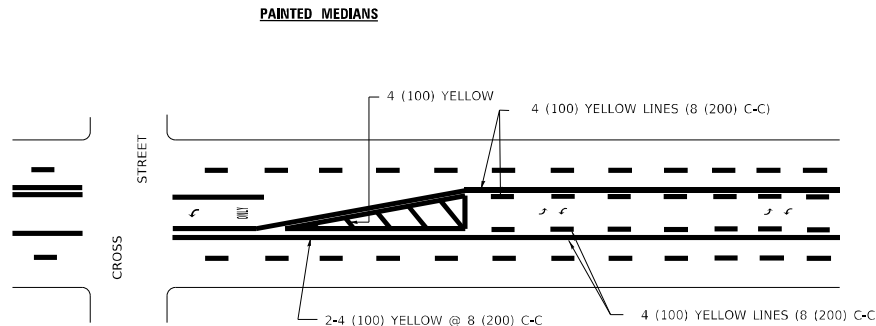
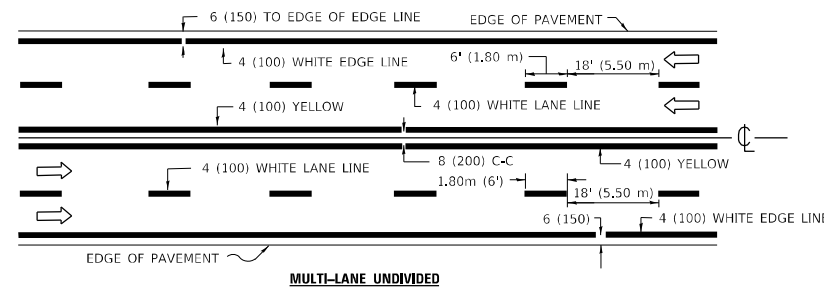

A MINIMUM OF TWO PAIRS OF TURN ARROWS SHALL BE USED, WHITE IN COLOR. ADDITIONAL PAIRS SHALL BE PLACED AT 200' (60 m) TO 300' (90 m) INTERVALS.

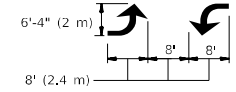

TYPICAL PAINTED MEDIAN MARKING

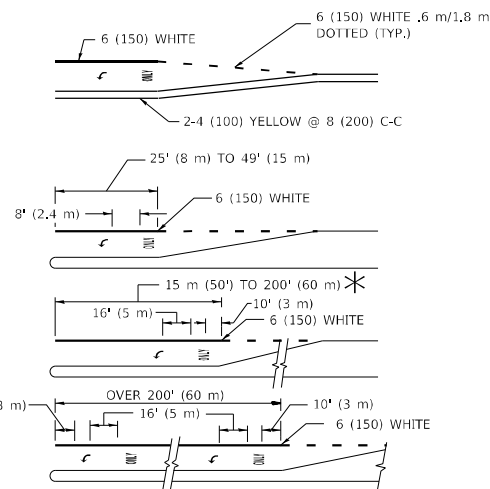

FULL SIZE LETTERS 8" (2.4 m) AND ARROWS SHALL BE USED.
 AREA = 15.8 SQ. FT. (1.47 m²) ONLY AREA = 22.9 SQ. FT. (2.13 m²)
 * TURN LANES IN EXCESS OF 400' (120 m) IN LENGTH MAY HAVE AN ADDITIONAL SET OF ARROW - "ONLY" INSTALLED MIDWAY BETWEEN THE OTHER TWO SETS OF ARROW - "ONLY".

TYPICAL LEFT (OR RIGHT) TURN LANE

| TYPE OF MARKING | WIDTH OF LINE | PATTERN | COLOR | SPACING / REMARKS |
|---|--|---------------------------------|---|--|
| CENTERLINE ON 2 LANE PAVEMENT | 4 (100) | SKIP-DASH | YELLOW | 6' (1.80 m) LINE WITH 18' (5.50 m) SPACE |
| CENTERLINE ON MULTI-LANE UNDIVIDED PAVEMENT | 2 @ 4 (100) | SOLID | YELLOW | 8 (200) C-C |
| NO PASSING ZONE LINES: FOR ONE DIRECTION FOR BOTH DIRECTIONS | 4 (100) 2 @ 4 (100) | SOLID SOLID | YELLOW YELLOW | 8 (200) C-C |
| LANE LINES | 4 (100) 5 (125) ON FREEWAYS | SKIP-DASH SKIP-DASH | WHITE WHITE | 6' (1.80 m) LINE WITH 18' (5.50 m) SPACE |
| DOTTED LINES (EXTENSIONS OF CENTER, LANE OR TURN LANE MARKINGS) | SAME AS LINE BEING EXTENDED | SKIP-DASH | SAME AS LINE BEING EXTENDED | 2' (600) LINE WITH 6' (1.8) SPACE |
| EDGE LINES | 4 (100) | SOLID | YELLOW-LEFT WHITE-RIGHT | OUTLINE MOUNTABLE MEDIANS IN YELLOW; EDGE LINES ARE NOT USED NEXT TO BARRIER CURB |
| TURN LANE MARKINGS | 6 (150) LINE: FULL SIZE LETTERS & SYMBOLS (8" (2.4 m)) | SOLID | WHITE | SEE TYPICAL TURN LANE MARKING DETAIL |
| TWO WAY LEFT TURN MARKING | 2 @ 4 (100) EACH DIRECTION 8' (2.4 m) LEFT ARROW | SKIP-DASH AND SOLID IN PAIRS | YELLOW WHITE | 6' (1.8 m) LINE WITH 18' (5.50 m) SPACE FOR SKIP-DASH; 8 (200) C-C BETWEEN SOLID LINE AND SKIP-DASH LINE SEE TYPICAL TWO-WAY LEFT TURN MARKING DETAIL |
| CROSSWALK LINES A. DIAGONALS (BIKE & EQUESTRIAN) B. LONGITUDINAL BARS (SCHOOL & PEDESTRIAN) | 12 (300) @ 45° 24 (600) @ 90° | SOLID SOLID | WHITE WHITE | 2' (600) APART SEE TYPICAL CROSSWALK MARKING DETAILS. |
| STOP LINES | 24 (600) | SOLID | WHITE | PLACE 4' (1.2 m) IN ADVANCE OF AND PARALLEL TO CROSSWALK, IF PRESENT, OTHERWISE, PLACE AT DESIRED STOPPING POINT. PARALLEL TO CROSSROAD CENTERLINE, WHERE POSSIBLE |
| PAINTED MEDIANS | 2 @ 4 (100) WITH 12 (300) DIAGONALS @ 45° | SOLID | YELLOW: TWO WAY TRAFFIC WHITE: ONE WAY TRAFFIC | 8 (200) C-C FOR THE DOUBLE LINE SEE TYPICAL PAINTED MEDIAN MARKING. |
| GORE MARKING AND CHANNELIZING LINES | 8 (200) WITH 12 (300) DIAGONALS @ 45° | SOLID | WHITE | DIAGONALS: 20' (6.1 m) (LESS THAN 30 MPH (50 km/h)) |
| RAILROAD CROSSING | 24 (600) TRANSVERSE LINES: "RR" IS 6' (1.8 m) LETTERS: 16 (400) LINE FOR "X" | SOLID | WHITE | SEE STATE STANDARD 780001 AREA OF: "R"=3.6 SQ. FT. (0.33m ²) EACH "X"=54.0 SQ. FT. (5.0 m ²) |

FOR FURTHER DETAILS ON PAVEMENT MARKING REFER TO STREET MARKING STANDARDS, PRINTED BY CITY OF CHICAGO, DEPARTMENT OF TRANSPORTATION, BUREAU OF TRAFFIC.

ALL DIMENSIONS ARE IN INCHES (MILLIMETERS) UNLESS OTHERWISE SHOWN.

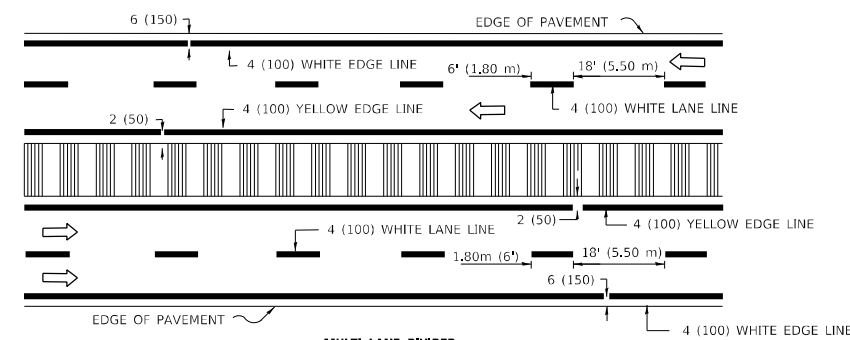

NOTE: MEDIANS WITH BARRIER CURB DO NOT REQUIRE AN EDGE LINE

TYPICAL LANE AND EDGE LINE MARKING

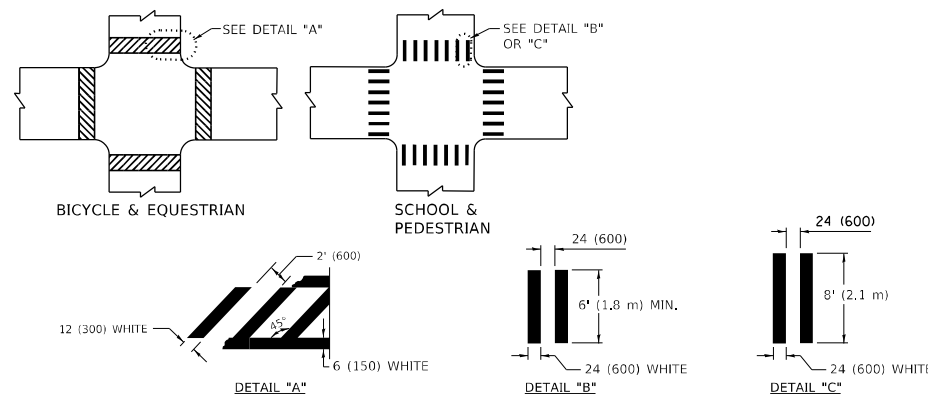

TYPICAL CROSSWALK MARKING

| | | |
|-------------------------------|------------|---------------------------------|
| USER NAME = aedfs.abeoaw | DESIGNED - | REVISED - T. RAMMACHER 12-07-00 |
| DRAWN - | CHECKED - | REVISED - K. ENG 02-28-12 |
| PLOT SCALE = 100.0777 ' / in. | DATE - | REVISED - |
| PLOT DATE = 5/9/2023 | | |

STATE OF ILLINOIS
DEPARTMENT OF TRANSPORTATION

CITY OF CHICAGO
TYPICAL PAVEMENT MARKINGS

SCALE: NONE SHEET 1 OF 3 SHEETS STA. TO STA.

| | | | | |
|---------------------------|------------------------|--------------------|-----------------|--------------|
| F.A.P. RTE. 370 | SECTION FAP 0370 22 RS | COUNTY COOK | TOTAL SHEETS 18 | SHEET NO. 18 |
| TC-24 | | CONTRACT NO. 62T93 | | |
| ILLINOIS FED. AID PROJECT | | | | |

MODEL: Default
FILE NAME: \\millie-cov.bentley.com\PROJECTS\176922\CADD\Drawings\Design\05h156.dgn