

STATE OF ILLINOIS
DEPARTMENT OF TRANSPORTATION

F.A.P. RTE.	SECTION	COUNTY	TOTAL SHEETS	SHEET NO.
317	(25,26)PP	LIVINGSTON	9	1
		ILLINOIS	CONTRACT NO. 66N49	

INDEX OF SHEETS

1. COVER SHEET
2. GENERAL NOTES
3. SUMMARY OF QUANTITIES
4. TYPICAL SECTIONS
- 5 - 6. SCHEDULES
- 7 - 8. CLASS B PATCHING DETAILS
9. TEMPORARY INFORMATION SIGNING

HIGHWAY STANDARDS

000001-08	STANDARD SYMBOLS, ABBREVIATIONS AND PATTERNS
001001-02	AREAS OF REINFORCEMENT BARS
001006	DECIMAL OF AN INCH AND OF A FOOT
701001-02	OFF-ROAD OPERATIONS 2L, 2W, MORE THAN 15' AWAY
701006-05	OFF-ROAD OPERATIONS 2L, 2W, 15' TO 24" FROM PAVEMENT EDGE
701301-04	LANE CLOSURE, 2L, 2W, SHORT TIME OPERATIONS
701336-07	LANE CLOSURE, 2L, 2W, WORK AREAS IN SERIES, FOR SPEEDS ≥ 45 MPH
701501-06	URBAN LANE CLOSURE, 2L, 2W, UNDIVIDED
701901-08	TRAFFIC CONTROL DEVICES

**PROPOSED
HIGHWAY PLANS**

**F.A.P. ROUTE 317 (US 24)
SECTION (25,26)PP
PAVEMENT PATCHING
LIVINGSTON COUNTY**

C-93-085-23

**END IMPROVEMENT
END OF CURB & GUTTER
EAST OF 10TH STREET
STA. 591+60**

**BEGIN IMPROVEMENT
INTERSECTION OF
US 24 AND N. 2000E RD
STA. 470+76**

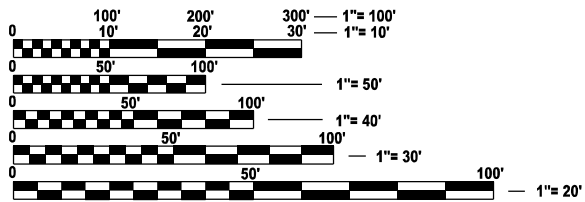

FULL SIZE PLANS HAVE BEEN PREPARED USING STANDARD ENGINEERING SCALES. REDUCED SIZED PLANS WILL NOT CONFORM TO STANDARD SCALES. IN MAKING MEASUREMENTS ON REDUCED PLANS, THE ABOVE SCALES MAY BE USED.

J.U.L.I.E.
JOINT UTILITY LOCATION INFORMATION FOR EXCAVATION
1-800-892-0123
OR 811

**PROJECT ENGINEER: YOGESH PATEL P.E.
UNIT CHIEF: RON WOODSHANK
DISTRICT NO. 3 (815) 434-6131
CONTRACT NO. 66N49**



GROSS LENGTH = 12,084 FT. = 2.3 MILES
NET LENGTH - 903 FT. = 0.17 MILES

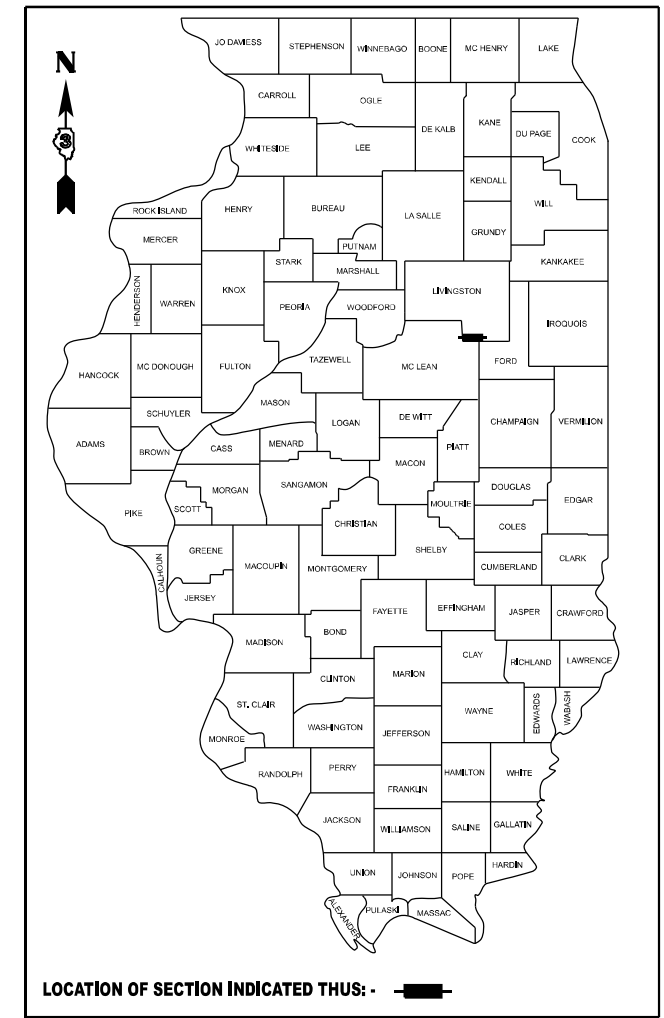

LOCATION OF SECTION INDICATED THUS: - [thick black line] -

FUNCTIONAL CLASSIFICATION
OTHER PRINCIPAL ARTERIAL
F.A.P. ROUTE 317 (US 24)
2021 ADT = 7300
P.V. 80.1 % S.U. 11 % M.U. 8.6 %

STATE OF ILLINOIS
DEPARTMENT OF TRANSPORTATION

SUBMITTED May 18 2023

[Signature] REGIONAL ENGINEER

June 30, 2023 *[Signature]*
ENGINEER OF DESIGN AND ENVIRONMENT

June 30, 2023 *[Signature]*
DIRECTOR OF HIGHWAYS PROJECT IMPLEMENTATION

**PRINTED BY THE AUTHORITY
OF THE STATE OF ILLINOIS**

GENERAL NOTES

ALL EXCAVATED MATERIAL, WHICH INCLUDES DIGGING OR GRADING OF ANY SOIL OR FILL MATERIAL, WITH THE EXCEPTION OF AGGREGATE FILLS, MUST BE INCORPORATED WITHIN THE IDOT RIGHT OF WAY.

COMMITMENTS

NONE

**STATE OF ILLINOIS
DEPARTMENT OF TRANSPORTATION
DISTRICT THREE
AS BUILT INFORMATION**

SUPERVISING CONSTRUCTION FIELD ENGINEER

RESIDENT ENGINEER / TECHNICIAN

**START & END DATES
OF CONSTRUCTION:**

INSPECTORS:

MODEL: Default
FILE NAME: \\p01bpcrva01\jerry.com\FM\DOT\Documents\IDOT Office\District 3\ORD Projects\238N49\CAD\Draws\CADD Sheets\66N49.dgn

USER NAME = ronald.woodshank	DESIGNED - RW	REVISED - ____
	DRAWN - RW	REVISED - ____
PLOT SCALE = 100,000' / 1in.	CHECKED - YP	REVISED - ____
PLOT DATE = 5/12/2023	DATE - 5/3/2023	REVISED - ____

**STATE OF ILLINOIS
DEPARTMENT OF TRANSPORTATION**

GENERAL NOTES

SCALE: ____ SHEET 1 OF 1 SHEETS STA. ____ TO STA. ____

F.A.P. RTE.	SECTION	COUNTY	TOTAL SHEETS	SHEET NO.
317	(25,26)PP	LIVINGSTON	9	2
CONTRACT NO. 66N49				
ILLINOIS		FED. AID PROJECT		

MODEL: D:\infuit...
 FILE NAME: D:\infuit...
 PROJECT: 30RD Project\30RD\30RD\30RD\CADD\Sheet66N49.dgn

CODE NO.	ITEM	UNIT	TOTAL QUANTITY	CONSTRUCTION CODE	
				CONTRACT MAINTENANCE	100% STATE ROADWAY
				0006	RURAL
4200060	WELDED WIRE REINFORCEMENT	SQ YD	1112		1112
4420107	CLASS B PATCHES, TYPE II, 13 INCH	SQ YD	294		294
44201011	CLASS B PATCHES, TYPE III, 13 INCH	SQ YD	142		142
44201031	CLASS B PATCHES, TYPE II, 15 INCH	SQ YD	235		235
44201035	CLASS B PATCHES, TYPE III, 15 INCH	SQ YD	32		32
44201037	CLASS B PATCHES, TYPE IV, 15 INCH	SQ YD	938		938
44201299	DOWEL BARS 1 1/2"	EACH	2122		2122
44213200	SAW CUTS	FOOT	5323		5323
44213204	TIE BARS 3/4"	EACH	462		462
67100100	MOBILIZATION	L SUM	1		1
70100600	TRAFFIC CONTROL AND PROTECTION, STANDARD 701336	L SUM	1		1
70102620	TRAFFIC CONTROL AND PROTECTION, STANDARD 701501	L SUM	1		1
Z0017099	DOWEL BAR ASSEMBLY	EACH	36		36
Z0030850	TEMPORARY INFORMATION SIGNING	SQ FT	42		42

USER NAME = ronald.woodshank	DESIGNED - RW	REVISED - _____
	DRAWN - RW	REVISED - _____
PLOT SCALE = 100,000' / in.	CHECKED - YP	REVISED - _____
PLOT DATE = 5/12/2023	DATE - 5/3/2023	REVISED - _____

**STATE OF ILLINOIS
 DEPARTMENT OF TRANSPORTATION**

SUMMARY OF QUANTITIES

SCALE: _____ SHEET 1 OF 1 SHEETS STA. _____ TO STA. _____

F.A.P. RTE.	SECTION	COUNTY	TOTAL SHEETS	SHEET NO.
317	(25,26)PP	LIVINGSTON	9	3
			CONTRACT NO. 66N49	
		ILLINOIS FED. AID PROJECT		

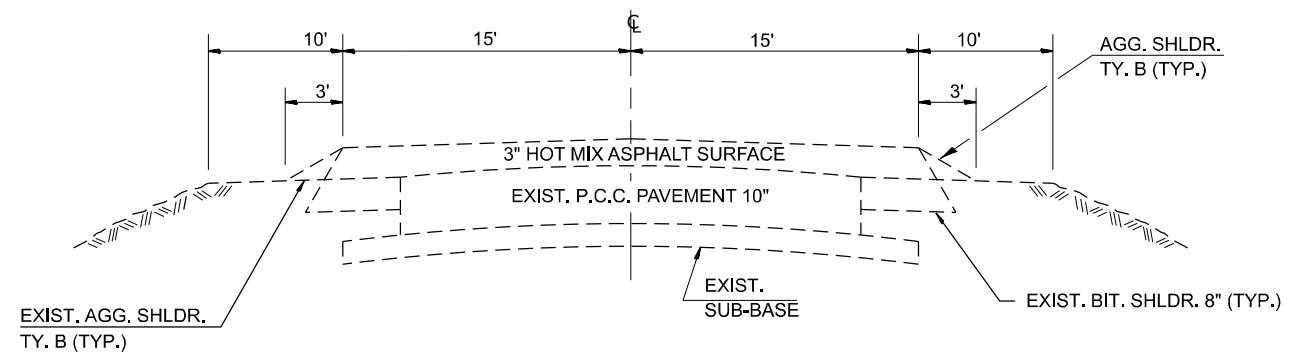

TYPICAL SECTION 1
STA. 470+76 (N. 2000E RD.) TO STA. 537+67 (CLAY STREET)

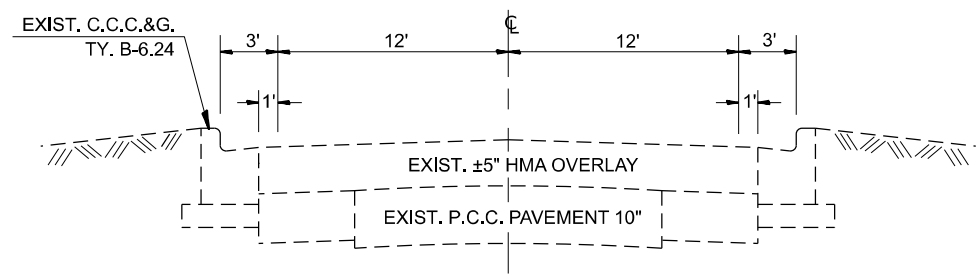

TYPICAL SECTION 2
STA. 537+67 (CLAY ST.) TO STA. 591+60 (END OF CURB & GUTTER EAST OF TENTH STREET)

MODEL: D:\infuit...
 FILE NAME: p:\work\p\m\dot\Documents\DOT Office\District 3\ORD Projects\238N98\CAD\Drawings\CADD_Sheets\66N49.dgn

USER NAME = ronald.woodshank	DESIGNED - RW	REVISED - _____
	DRAWN - RW	REVISED - _____
PLOT SCALE = 100,000' / 1in.	CHECKED - YP	REVISED - _____
PLOT DATE = 5/12/2023	DATE - 5/3/2023	REVISED - _____

STATE OF ILLINOIS
DEPARTMENT OF TRANSPORTATION

TYPICAL SECTIONS

SCALE: _____ SHEET 1 OF 1 SHEETS STA. _____ TO STA. _____

F.A.P. RTE.	SECTION	COUNTY	TOTAL SHEETS	SHEET NO.
317	(25,26)PP	LIVINGSTON	9	4
CONTRACT NO. 66N49			ILLINOIS FED. AID PROJECT	

SCHEDULE - CLASS B PATCHING

LOCATION WESTBOUND				PATCH LENGTH (FT)	CLASS B TYPE		DOWEL BARS 1 1/2" EACH	DOWEL BAR ASSEMBLY EACH	SAW CUTS FOOT	WELDED WIRE REINF. SQ YD	TIE BARS 3/4" EACH	LOCATION EASTBOUND				PATCH LENGTH (FT)	CLASS B TYPE		DOWEL BARS 1 1/2" EACH	DOWEL BAR ASSEMBLY EACH	SAW CUTS FOOT	WELDED WIRE REINF. SQ YD	TIE BARS 3/4" EACH			
STA.	TO	STA.	ROADWAY		II 13" SQ YD	III 13" SQ YD						II 13" SQ YD	III 13" SQ YD	II 13" SQ YD	III 13" SQ YD											
470+76			N. 2000 E. RD.									470+76			N. 2000 E. RD.											
472+26				6			26		57			472+26				6			26		57					
479+76				6			26		57			479+76				6			26		57					
480+53				10			26		65	17		480+53				10			26		65	17				
484+49				10			26		65	17		484+49				10			26		65	17				
485+38				6			26		57			485+38				6			26		57					
495+94				6			26		57			495+94				6			26		57					
497+77				6			26		57			497+77				6			26		57					
501+55				6			26		57			501+55				6			26		57					
502+19				6			26		57			502+19				6			26		57					
506+46				7			26		59			506+46				7			26		59					
510+63				6			26		57			510+63				6			26		57					
517+05			CRYSTAL LANE																							
518+20												518+20			JAN LANE											
518+46				6			26		57																	
519+29				12			26		69	20		519+29				12			26		69	20				
520+39				6			26		57			520+39				6			26		57					
522+17			CRYSTAL LANE																							
522+65												522+65			METZ LANE											
522+90			WALCREST DR.																							
525+72				10			26		65	17		525+72				10			26		65	17				
529+72				6			26		57			529+72				6			26		57					
530+46				6			26		57			530+46				6			26		57					
529+10			ASPEN COURT																							
533+50			CALHOUN STREET																							
534+48				6			26		57			534+48				6			26		57					
537+67			CLAY STREET									537+67			CLAY STREET											
SUBTOTALS				127	142	71	468		1064	71		TOTALS				133	152	71	494		1121	71				
TOTALS				260	294	142	962		2185	142																

MODEL: D:\inf\... FILE NAME: ...

USER NAME = ronald.woodshank	DESIGNED - RW	REVISED - _____
DRAWN - RW	CHECKED - YP	REVISED - _____
PLOT SCALE = 100,000' / 1" = 5/12/2023	DATE - 5/3/2023	REVISED - _____

**STATE OF ILLINOIS
DEPARTMENT OF TRANSPORTATION**

SCHEDULES

SCALE: _____ SHEET 1 OF 2 SHEETS STA. _____ TO STA. _____

F.A.P. RTE. 317	SECTION (25,26)PP	COUNTY LIVINGSTON	TOTAL SHEETS 9	SHEET NO. 5
			CONTRACT NO. 66N49	
		ILLINOIS FED. AID PROJECT		

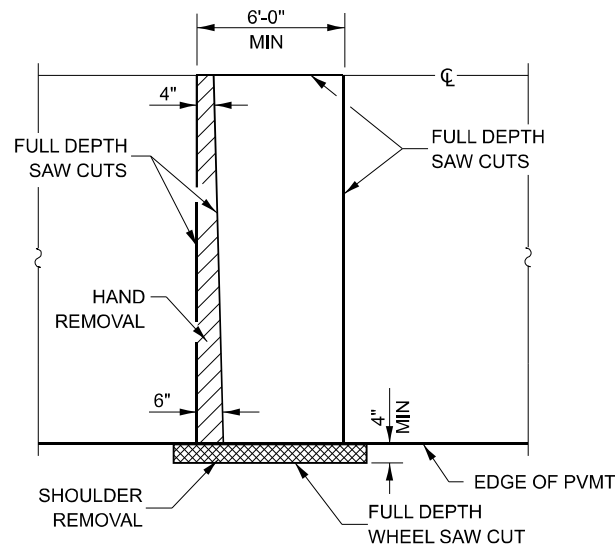

PAVEMENT SAWING DETAIL
(HMA SHOULDER)

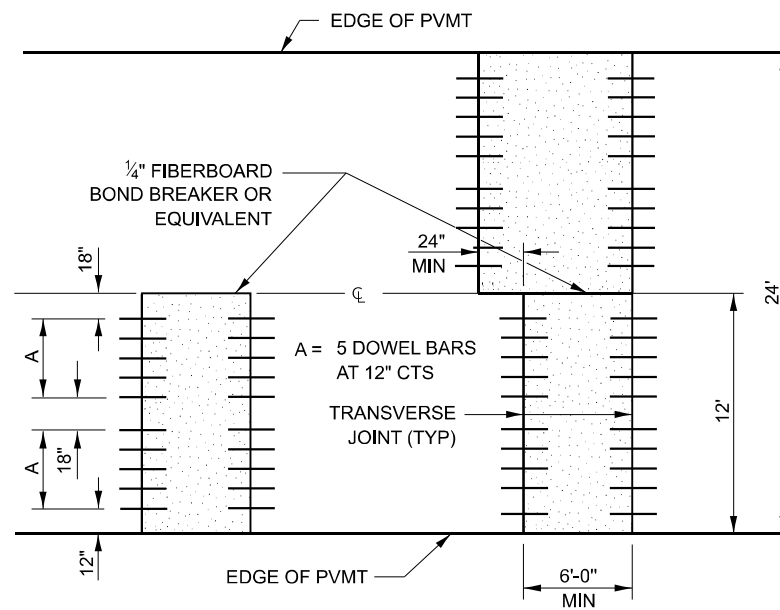

12' WIDE LANES

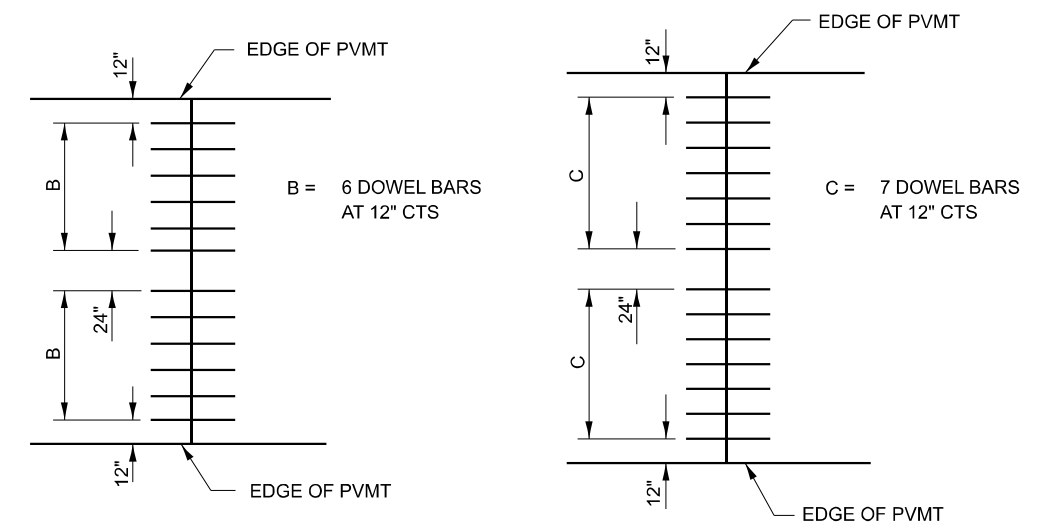

14' WIDE RAMP

16' WIDE RAMP

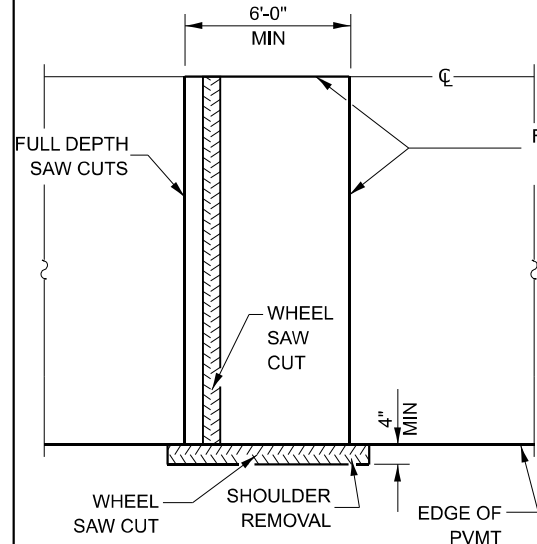

ALTERNATE SAWING DETAIL
(HMA SHOULDER)

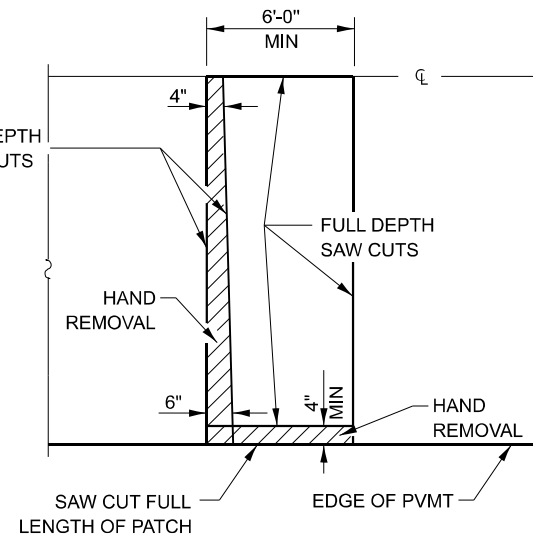

PAVEMENT SAWING DETAIL
(PCC SHOULDER)

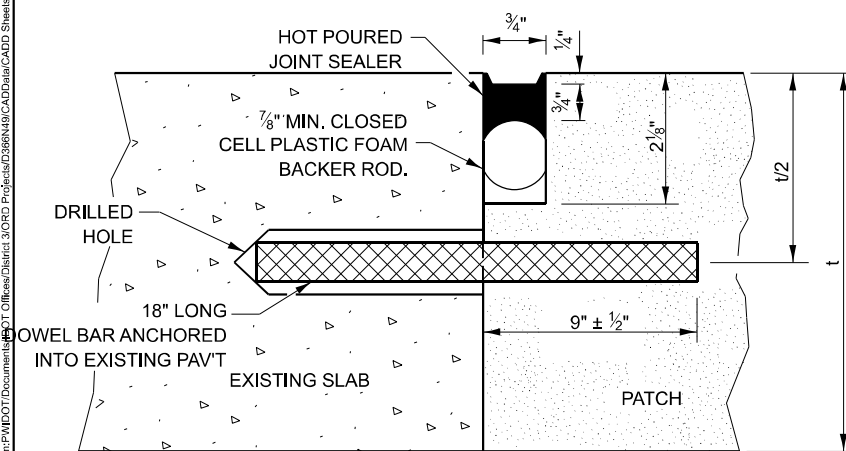

TRANSVERSE JOINT

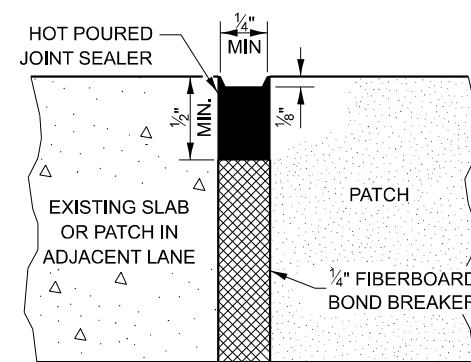

CENTERLINE JOINT

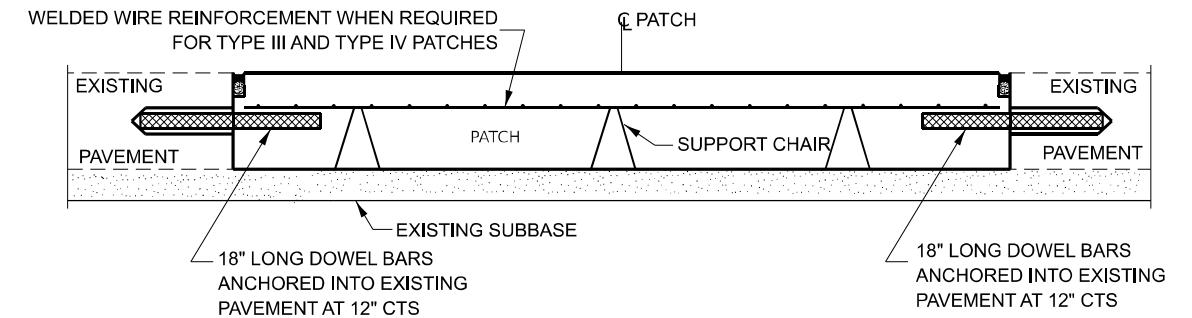

PATCHING WITHOUT HMA OVERLAY

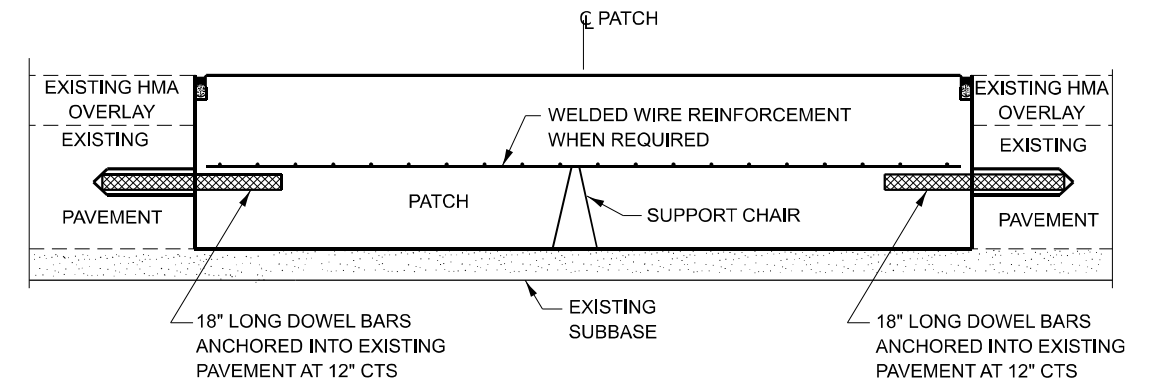

PATCHING WITH HMA OVERLAY

DOWEL BAR TABLE		
PAVEMENT THICKNESS	DOWEL BAR DIAMETER	HOLE DIAMETER
8" OR GREATER	1 1/2"	1 5/8"
7" THRU 7.99"	1 1/4"	1 3/8"
LESS THAN 7"	1"	1 1/8"

GENERAL NOTES

THE TRANSVERSE JOINTS FOR CLASS B PATCHES SHALL ALIGN WITH JOINTS OR CRACKS IN THE ADJACENT LANE WHENEVER POSSIBLE.
SEE STANDARD 420701 FOR DETAILS OF PAVEMENT WELDED WIRE REINFORCEMENT.

MODEL: D:\inf\... FILE NAME: ...

USER NAME = ronald.woodshank	DESIGNED - RW	REVISED -
PLOT SCALE = 100,000' / 1in.	DRAWN - RW	REVISED -
PLOT DATE = 5/12/2023	CHECKED - YP	REVISED -
	DATE - 5/3/2023	REVISED -

**STATE OF ILLINOIS
DEPARTMENT OF TRANSPORTATION**

CLASS B PATCHING DETAILS

SCALE: _____ SHEET 1 OF 1 SHEETS STA. _____ TO STA. _____

F.A.P. RTE. 317	SECTION (25,26)PP	COUNTY LIVINGSTON	TOTAL SHEETS 9	SHEET NO. 7
ILLINOIS FED. AID PROJECT			CONTRACT NO. 66N49	

TRANSVERSE EXPANSION JOINTS

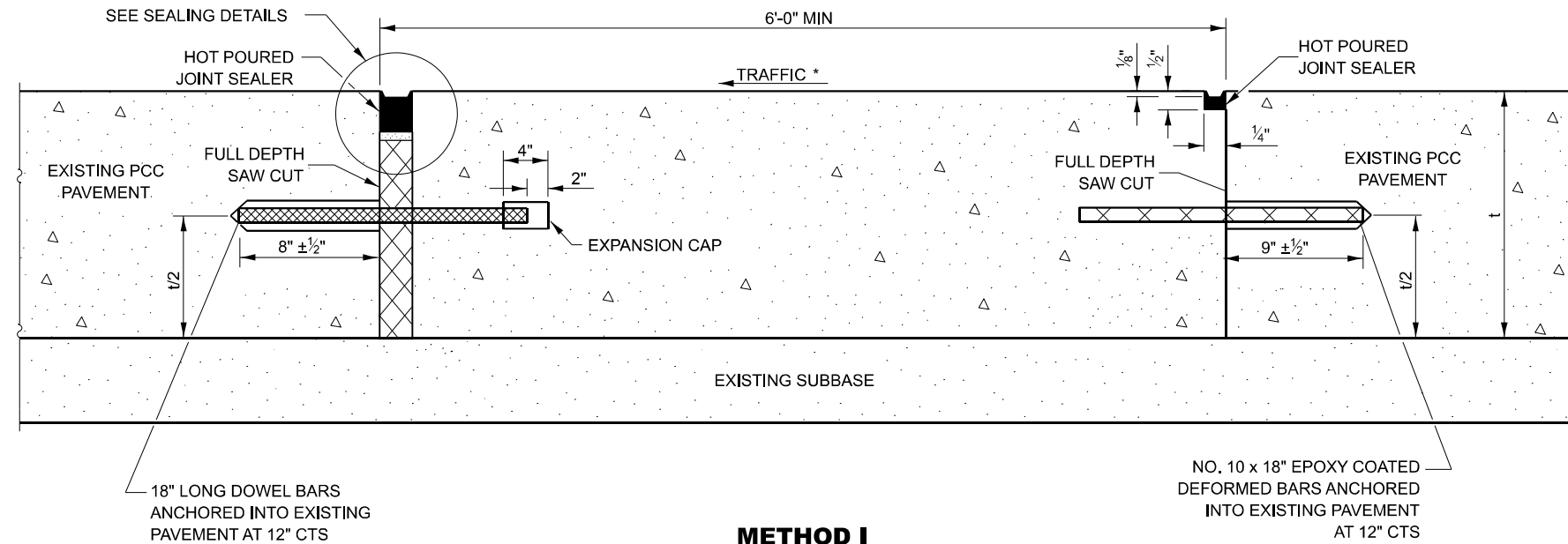

METHOD I
(WITHOUT HMA OVERLAY)

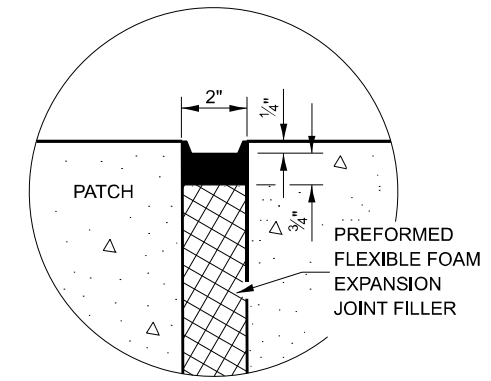

SEALING DETAIL

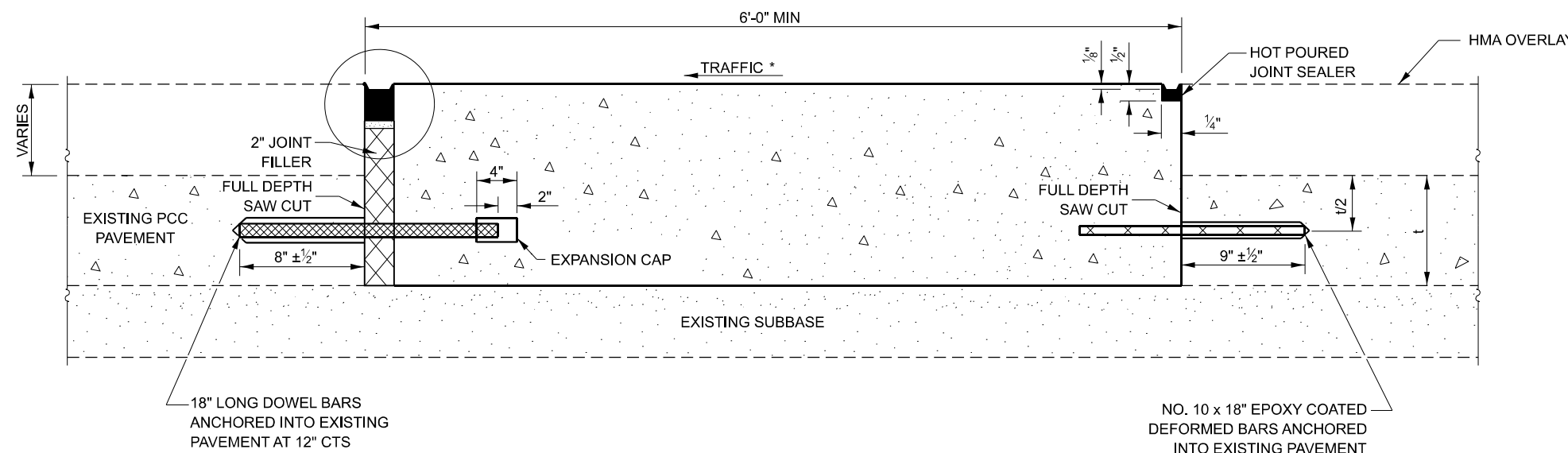

METHOD II
(WITH HMA OVERLAY)

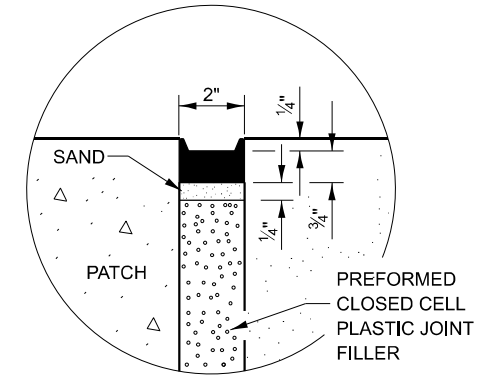

SEALING DETAIL

NOTE

* WHEN RE-ESTABLISHING A TRANSVERSE EXPANSION JOINT ON A TWO-WAY ROAD, REVERSE THE ORIENTATION OF THE DOWEL BARS WITH RESPECT TO TRAFFIC FOR ONE OF THE PATCHES SUCH THAT THE JOINT WILL BE CONTINUOUS ACROSS BOTH LANES.

MODEL: D:\in\... FILE NAME: ...

USER NAME = ronald.woodshank	DESIGNED - RW	REVISED -
DRAWN - RW	REVISIONS -	
PLOT SCALE = 100,000' / 1in.	CHECKED - YP	REVISED -
PLOT DATE = 5/12/2023	DATE - 5/3/2023	REVISED -

**STATE OF ILLINOIS
DEPARTMENT OF TRANSPORTATION**

CLASS B PATCHING DETAILS

SCALE: _____ SHEET 1 OF 1 SHEETS STA. _____ TO STA. _____

F.A.P. RTE.	SECTION	COUNTY	TOTAL SHEETS	SHEET NO.
317	(25,26)PP	LIVINGSTON	9	8
CONTRACT NO. 66N49				
ILLINOIS FED. AID PROJECT				

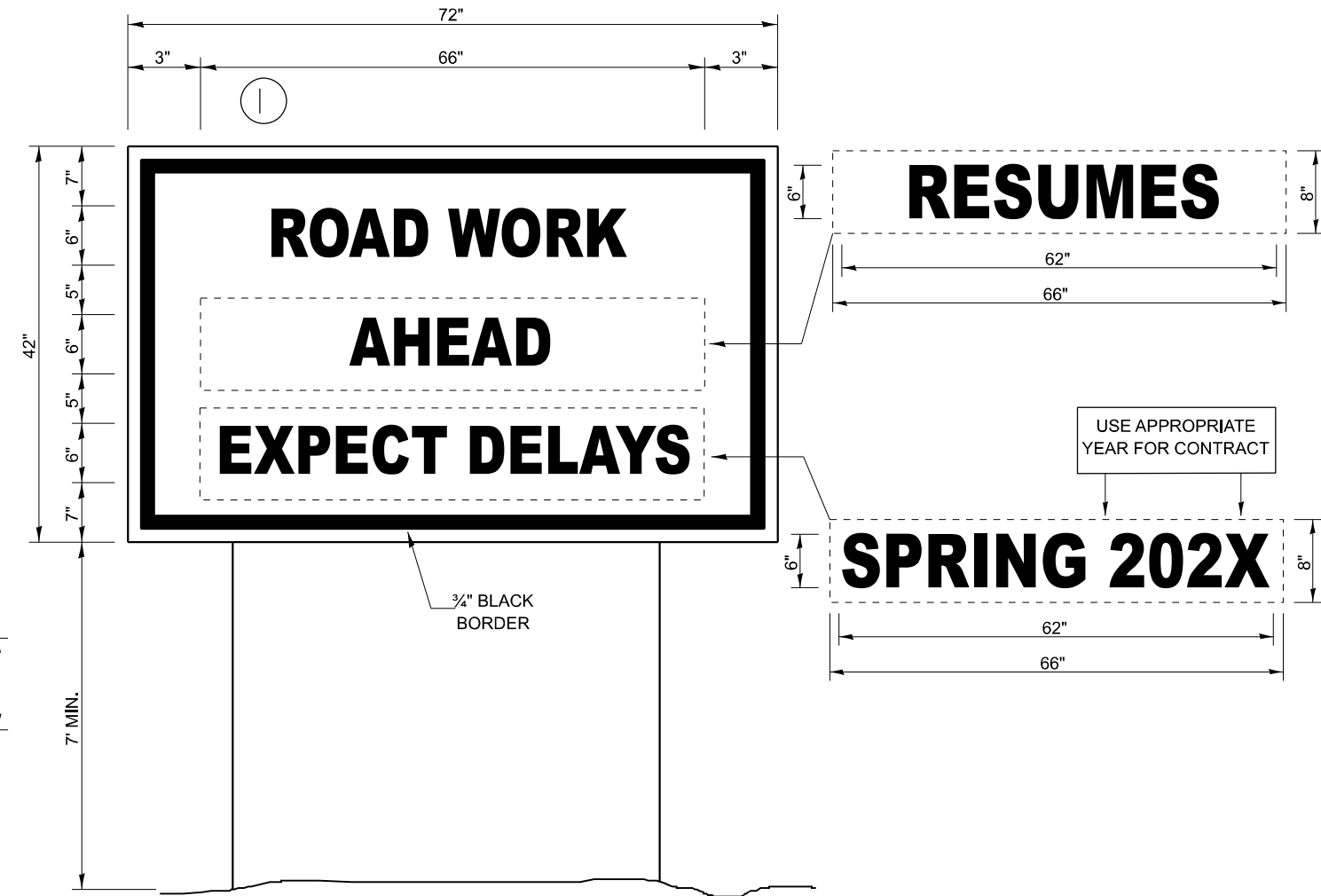
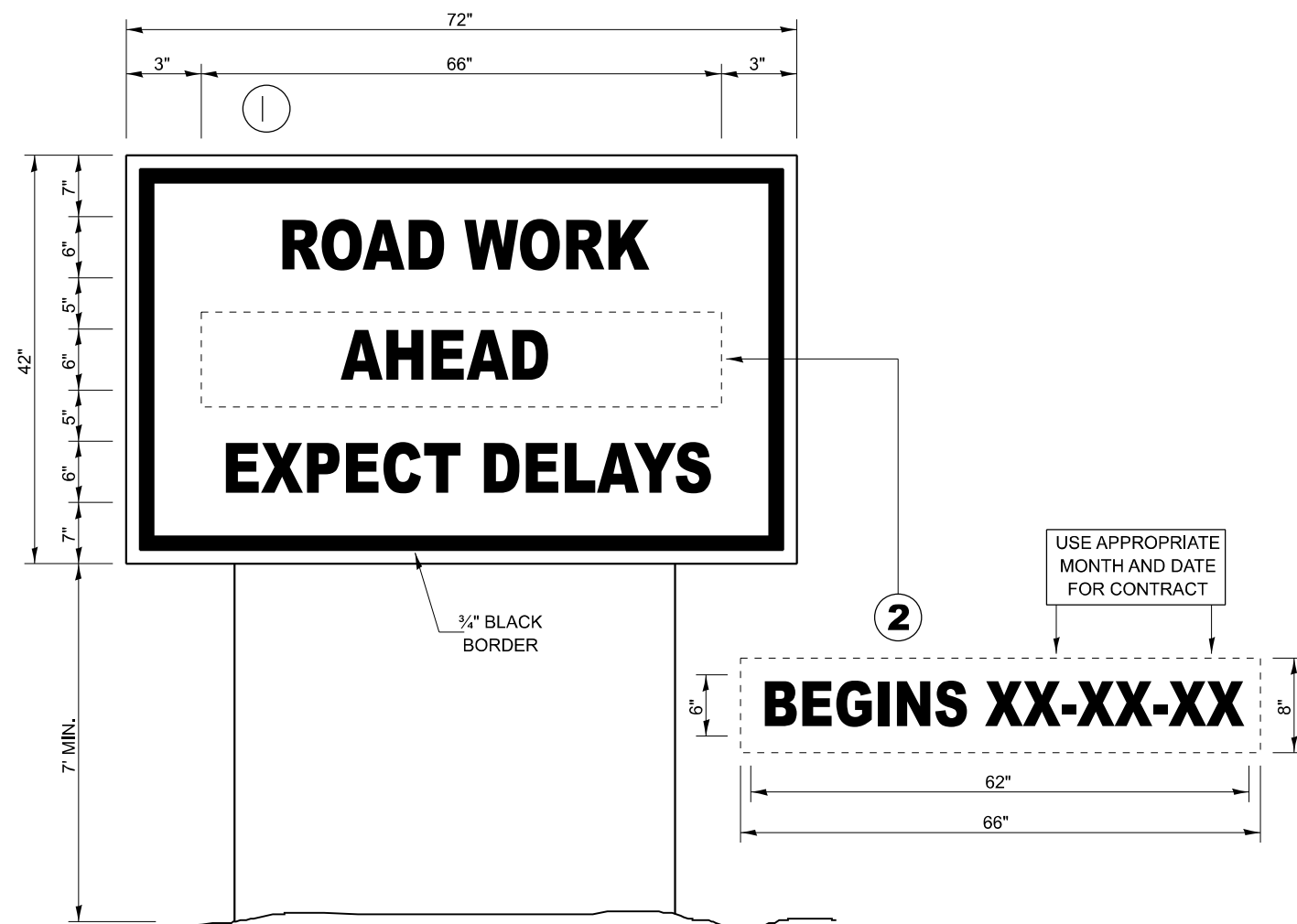

TEMPORARY INFORMATION SIGNING

WINTER SHUT DOWN SIGNING

NOTES:

1. USE 6" D BLACK LETTERING ON FLOURESENT ORANGE BACKGROUND.
2. ERECT SIGNS AT LOCATIONS IN ADVANCE OF THE "ROAD CONSTRUCTION AHEAD" SIGNS AS DIRECTED BY THE ENGINEER.
3. ERECT SIGN ① WITH INSTALLED PANEL ② A MINIMUM OF ONE WEEK PRIOR TO THE START OF THE LANE CLOSURE.
4. REMOVE PANEL ② ON THAT DATE.
5. SEE SPECIAL PROVISION "TEMPORARY INFORMATION SIGNING" FOR ADDITIONAL INFORMATION.
6. WILL BE PAID FOR PER SQ FT AS "TEMPORARY INFORMATION SIGNING". EACH SIGN = 21 SQ FT AND THE DATE PANEL ② WILL NOT BE MEASURED SEPARATELY FOR PAYMENT.

MODEL: D:\in\it\...
FILE NAME: ...

USER NAME = ronald.woodshank	DESIGNED - RW	REVISED - _____
DRAWN - RW	CHECKED - YP	REVISED - _____
PLOT SCALE = 100,000 / 1in.	DATE - 5/3/2023	REVISED - _____
PLOT DATE = 5/12/2023		

**STATE OF ILLINOIS
DEPARTMENT OF TRANSPORTATION**

TEMPORARY INFORMATION SIGNING

SCALE: _____ SHEET 1 OF 1 SHEETS STA. _____ TO STA. _____

F.A.P. RTE.	SECTION	COUNTY	TOTAL SHEETS	SHEET NO.
317	(25,26)PP	LIVINGSTON	9	9
CONTRACT NO. 66N49			ILLINOIS FED. AID PROJECT	