

F.A. RTE.	SECTION	COUNTY	TOTAL SHEETS	SHEET NO.
		ROCK ISLAND	9	3
STA.	TO STA.			
FED. ROAD DIST. NO.	ILLINOIS	FED. AID PROJECT		

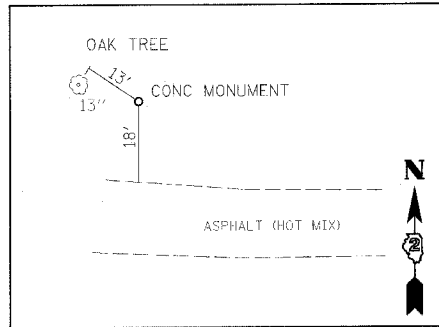

CONTROL PT #10
(CONCRETE MONUMENT)
N9585.688
E21211.821
ELEV=678.90

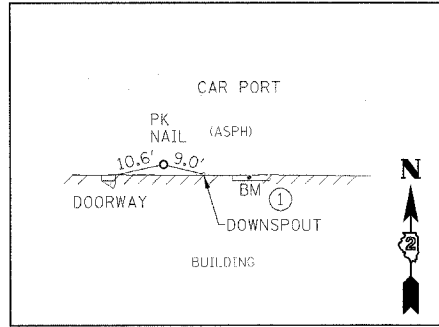

CONTROL PT #15
(PK NAIL)
N9554.352
E21363.993
ELEV=670.77

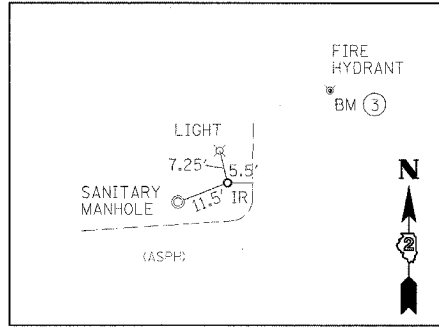

CONTROL PT #14
(IRON ROD)
N9580.111
E21470.252
ELEV=670.82

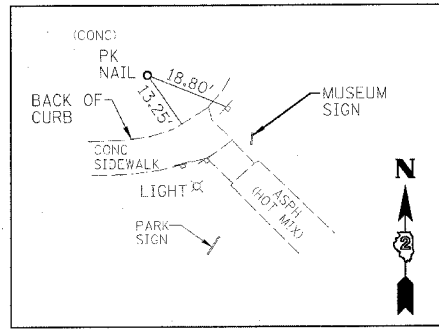

CONTROL PT #25
(PK NAIL)
N9573.150
E20920.995
ELEV=669.71

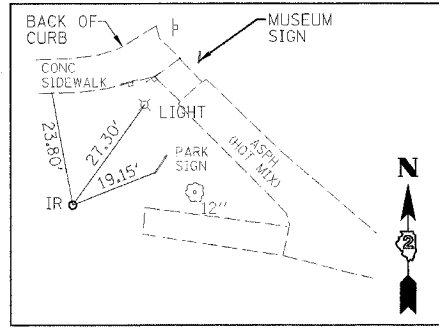

CONTROL PT #26
(IRON ROD)
N9527.091
E20916.095
ELEV=668.85

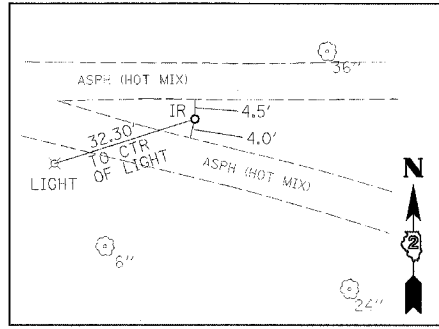

CONTROL PT #21
(IRON ROD)
N9489.221
E21133.410
ELEV=674.46

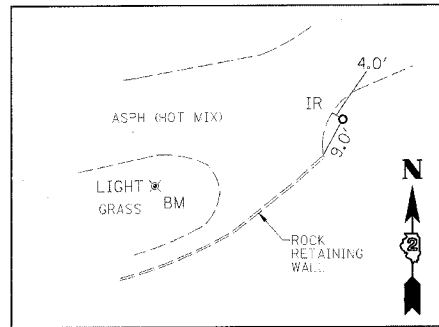

CONTROL PT #16
(IRON ROD)
N9439.223
E21417.567
ELEV=682.25

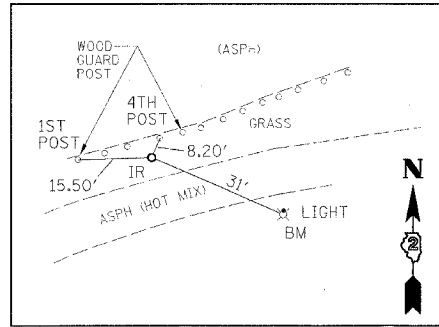

CONTROL PT #3
(IRON ROD)
N9560.813
E21631.199
ELEV=673.78

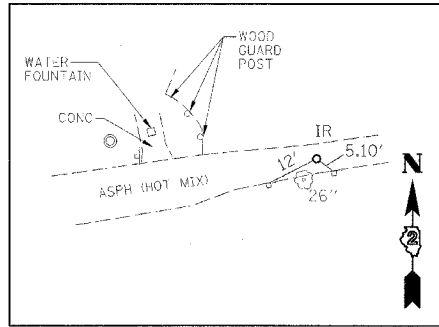

CONTROL PT #13
(IRON ROD)
N9567.722
E21723.689
ELEV=674.35

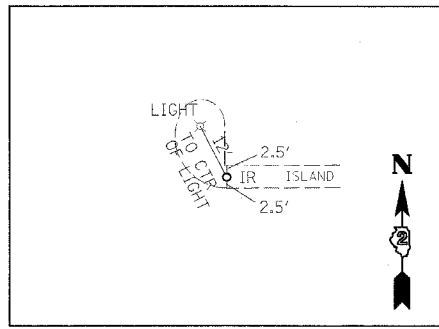

CONTROL PT #12
(IRON ROD)
N9613.873
E21711.762
ELEV=674.50

GENERAL NOTES

- G.N. 4
THE FINAL TOP 100mm (FOUR INCHES) OF SOIL IN ANY AREA DISTURBED BY THE CONTRACTOR MUST BE CAPABLE OF SUPPORTING VEGETATION. THE SOIL MUST BE FROM A HORIZON (ZERO TO 2' DEEP) OF SOIL PROFILES OF LOCAL SOILS.
- G.N. 67
THE COST OF MAKING SEWER CONNECTIONS TO EXISTING DRAINAGE STRUCTURES SHALL BE INCLUDED IN THE VARIOUS CONTRACT UNIT PRICES FOR STORM SEWER.
- G.N. 73
THE CONTRACTOR SHALL DETERMINE FLOWLINES OF EXISTING SEWER LINES WHICH ARE SHOWN ON THE PLANS AS ESTIMATED OR UNKNOWN. THIS INFORMATION IS NECESSARY BEFORE ORDERING INLETS AND MANHOLES.
- G.N. 74
WHERE FIELD TILE IS ENCOUNTERED, STORM SEWER OR PIPE DRAIN WILL BE USED IN ACCORDANCE WITH SECTION 611. THE MINIMUM SIZE FOR REPLACEMENT WILL BE 150mm (6") FOR PIPE DRAINS AND 200mm (8") FOR STORM SEWER, BUT THE SIZE MUST BE AT LEAST 50mm (2") LARGER THAN THE ADJOINING TILE. A FIELD TILE JUNCTION VAULT WILL BE CONSTRUCTED AT THE RIGHT OF WAY TO CONNECT THE TILE AND STORM.
- G.N. 102
THE CONTRACTOR SHALL BE RESPONSIBLE FOR PROTECTING UTILITY PROPERTY DURING CONSTRUCTION OPERATIONS AS OUTLINED IN ARTICLE 107.31 OF THE STANDARD SPECIFICATIONS. A MINIMUM OF 48 HOURS ADVANCE NOTICE IS REQUIRED FOR NON-EMERGENCY WORK. THE J.U.L.I.E. NUMBER IS 800-892-0123
- G.N. 105
CADD DATA WILL BE AVAILABLE TO CONTRACTORS AND CONSULTANTS WORKING ON THIS PROJECT. THIS INFORMATION WILL BE PROVIDED UPON REQUEST AS MICROSTATION CADD FILES AND COORDINATE GEOMETRY FILES ONLY. IF DATA IS REQUIRED IN OTHER FORMATS IT WILL BE THE USER'S RESPONSIBILITY TO MAKE THESE CONVERSIONS. IF ANY DISCREPANCY OR INCONSISTENCY ARISES BETWEEN THE ELECTRONIC DATA AND THE INFORMATION ON THE HARD COPY, THE INFORMATION ON THE HARD COPY SHOULD BE USED. CONTACT THE DISTRICT'S PROJECT ENGINEER TO REQUEST THESE FILES.

COMMITMENTS

- THE CONTRACTOR IS TO CONTACT BLACK HAWK STATE HISTORIC SITE MANAGER, SCOTT ROMAN, (309) 788-0177 TO COORDINATE CONSTRUCTION SCHEDULE.

APPLICATION RATES	
BITUMINOUS MATERIALS (PRIME COAT) MC-30	0.40 GAL/SY
BITUMINOUS MATERIALS (PRIME COAT) RC-70	0.10 GAL/SY
BITUMINOUS CONCRETE BINDER COURSE	112 LB/IN/SY
BITUMINOUS CONCRETE SURFACE COURSE	112 LB/IN/SY
GRANULAR MATERIALS	2.05 TONS/CY
NITROGEN FERTILIZER NUTRIENT	90 LB/ACRE
PHOSPHERUS FERTILIZER NUTRIENT	90 LB/ACRE
POTASSIUM FERTILIZER NUTRIENT	90 LB/ACRE
MULCH METHOD 1	2 TONS/ACRE

BITUMINOUS TABLE			
MIXTURE USE (S):	SURFACE	LEVELING BINDER	BINDER
PG	58-22	58-22	58-22
RAP % (MAX)	30	30	30
DESIGN AIR VOIDS	4.2	4.2	4.2
MIXTURE COMPOSITION (GRADATION MIXTURE)	IL 9.5	IL 9.5	IL 19.0
FRICTION AGGREGATE	MIX C	N/A	N/A
20 YEAR ESAL	N30	N30	N30

BENCHMARK LOCATIONS

NUMBER	DESCRIPTION	ELEVATION
①	ON FLOOR AT LODGE IN MAIN ENTRANCE TO BUILDING	670.83
②	TOP FIRE HYDRANT ON N SIDE OF LODGE IN FRONT OF PARKING LOT FOR LODGE EMPLOYEE'S	673.25
③	CUT " " ON CONC BASE FOR LIGHT SW OF EAST PARKING LOT, 2ND LIGHT E OF THE END OF LODGE	673.79
④	CUT " " ON N SIDE OF LIGHT BASE S OF MAIN FLOOR ENTRANCE TO LODGE	684.08
⑤	TOP FIRE HYDRANT W OF W END OF LODGE ± 100' (TOP OF OPERATING NUT)	675.17
⑥	PK NAIL SET IN 6"x6" POST ON SW CORNER OF STAIR DECK ON S SIDE OF TRAIL ± 100 SE OF PARKING LOT	668.31

REVISIONS	
NAME	DATE

ILLINOIS DEPARTMENT OF TRANSPORTATION
SURVEY TIES, BENCHMARKS,
AND GENERAL NOTES
IDOT / IHPA
BLACK HAWK STATE HISTORIC SITE

SCALE: VERT.
HORIZ.
DATE

DRAWN BY
CHECKED BY

PLOT DATE = #DATE#
FILE NAME = #FILE#
PLOT NUMBER = #PLOT#
USER NAME = #USER#

DESIGNED BY LAW	<p>Farnsworth GROUP 2709 McGraw Drive Bloomington, Illinois 61704 309/899-8496, 309/693-1571 fax</p>	FILE NO. 24-7524
DRAWN BY DRR		DATE 5/02/05
CHECKED BY PJM		SHEET NO. 3 OF 9