

F.A.P. RTE.	SECTION	COUNTY	TOTAL SHEETS	SHEET NO.
575	(B&14) R-3	WILL	390	39
STA.		TO STA.		
FED. ROAD DIST. NO.		ILLINOIS FED. AID PROJECT		
CONTRACT NO. 60961				

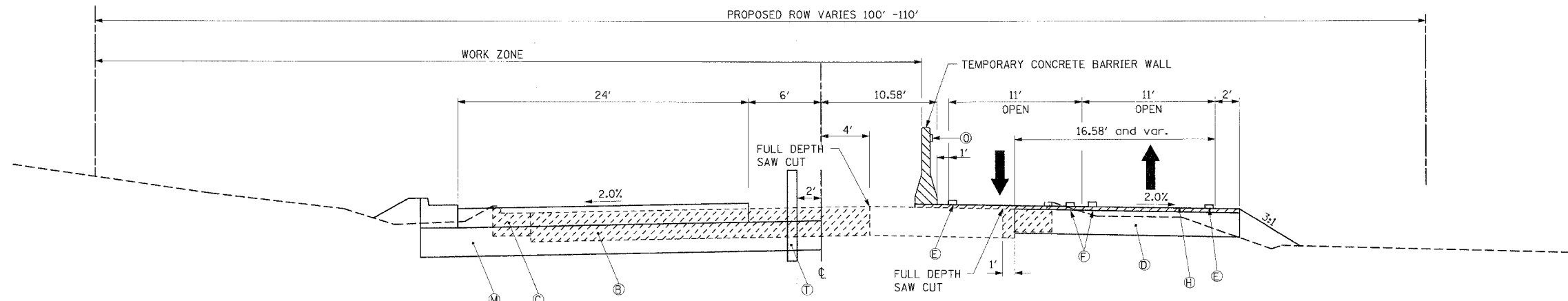

**STAGE 1B - PROPOSED ROCK RUN CREEK BOX CULVERT AT US ROUTE 30**

STA. 718+30.25 TO STA. 723+59.39

SEE SUGGESTED MAINTENANCE OF TRAFFIC PLAN FOR EXACT LOCATION OF TEMPORARY BARRIER WALL

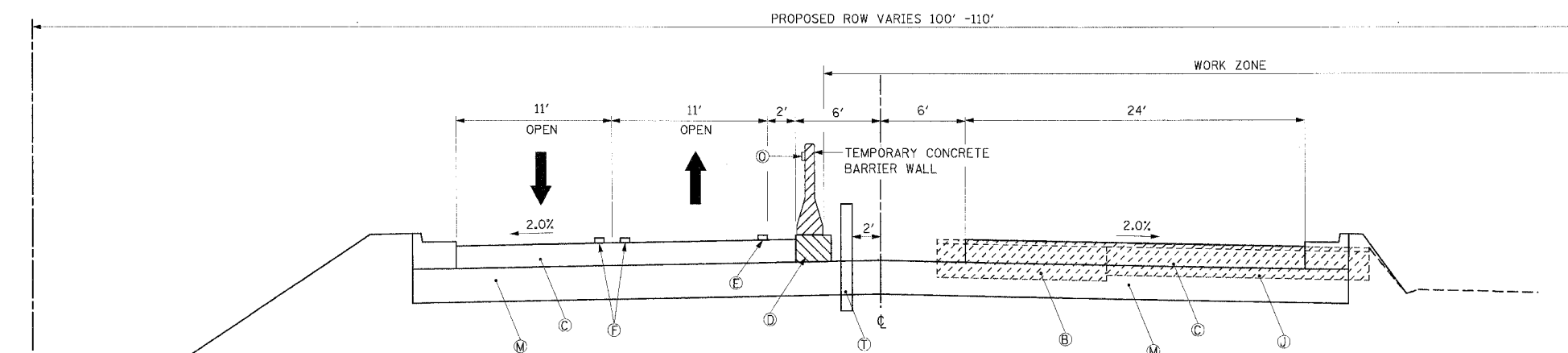

**STAGE 2 - PROPOSED ROCK RUN CREEK BOX CULVERT AT US ROUTE 30**

STA. 718+30.25 TO STA. 723+59.39

SEE SUGGESTED MAINTENANCE OF TRAFFIC PLAN FOR EXACT LOCATION OF TEMPORARY BARRIER WALL

NOTE: FOR CONSTRUCTION OF THE FLUSH MEDIAN PAVEMENT SECTION, SEE TYPICAL SECTION FOR STAGE 3 CONSTRUCTION.

**LEGEND:**

- (A) EXISTING BITUMINOUS CONCRETE PAVEMENT
- (B) PAVEMENT, MEDIAN AND/OR CURB REMOVAL
- (C) PROPOSED BITUMINOUS CONCRETE BINDER COURSE, SUPERPAVE, IL 19.0 N90 - 10 3/4"
- (D) PROPOSED TEMPORARY PAVEMENT
- (E) TEMPORARY EDGE LINE - 4" WHITE SOLID LINE
- (F) TEMPORARY CENTERLINE - 2-4" YELLOW SOLID LINE ON 11" CENTERS
- (G) TEMPORARY SHORT TERM PAVEMENT MARKINGS - 4" WHITE
- (H) POLYMERIZED LEVELING BINDER (MACHINE METHOD), SUPERPAVE IL 4.75, N50 - 1"
- (I) PROPOSED TEMPORARY EMBANKMENT
- (J) TEMPORARY PAVEMENT AND/OR CURB REMOVAL
- (K) PROPOSED 2 1/4" PAVEMENT MILLING W/ PROPOSED 2 1/4" BITUMINOUS OVERLAY
- (L) PROPOSED TEMPORARY PAVEMENT CROSS-OVER (TO BE PAID AS TEMPORARY PAVEMENT)
- (M) PROPOSED AGGREGATE SUBGRADE, 12" (CONSTRUCT PERMANENT SUBGRADE TO CENTERLINE)
- (N) REMOVE TEMPORARY EMBANKMENT (EARTH EXCAVATION)
- (O) PROPOSED BARRIER WALL REFLECTORS
- (P) PROPOSED TEMPORARY AGGREGATE SHOULDER (TO BE PAID AS AGGREGATE SHOULDER, SPECIAL)
- (Q) TEMPORARY AGGREGATE SHOULDER REMOVAL (INCIDENTAL TO AGGREGATE SHOULDER, SPECIAL)
- (R) DRUMS WITH MONODIRECTIONAL STEADY BURN LIGHTS
- (S) PROPOSED TEMPORARY CONCRETE CURB AND GUTTER, B-6.18
- (T) TEMPORARY SOIL RETENTION SYSTEM (SEE SHEET 226-229)
- (U) TEMPORARY EDGE LINE - 4" YELLOW SOLID LINE
- (V) TEMPORARY SHEET PILING
- (W) PROPOSED RETAINING WALL

REVISIONS	
NAME	DATE

ILLINOIS DEPARTMENT OF TRANSPORTATION  
**SUGGESTED MAINTENANCE OF TRAFFIC PLAN**  
**STAGE 1B & STAGE 2**  
**AT ROCK RUN CREEK BOX CULVERT**  
**US ROUTE 30**  
 SHEET 5 OF 26

SCALE: VERT. NONE  
 HORIZ. NONE  
 DATE: 3/1/05  
 DRAWN BY: SNH  
 CHECKED BY: SBP



I:\not\0006602\draw\bid\sheet\mcttp04.dgn